

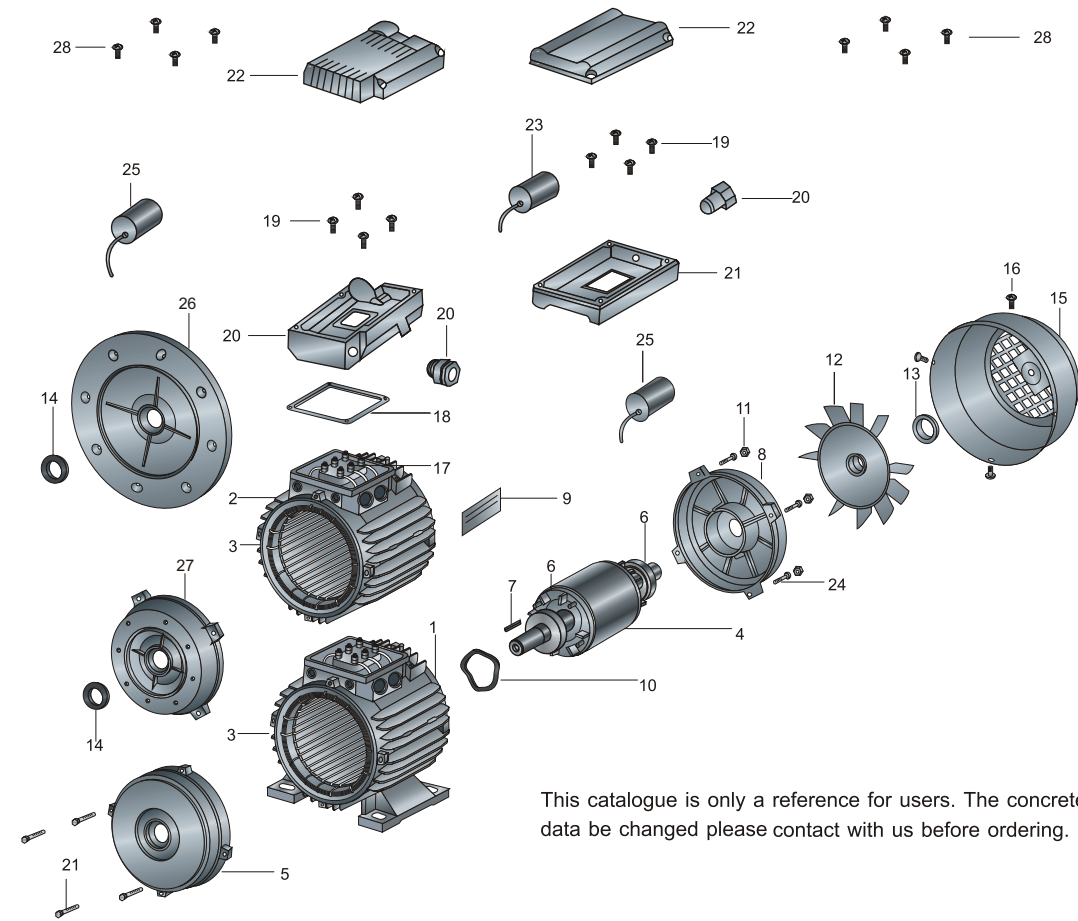

## Motor spare part list/drawing



1. Frame B3
2. Frame B5
3. Wound Stator
4. Rotor with shaft
5. Front shield
6. Bearings
7. Key
8. Back shield
9. Name plate
10. Compensation ring
11. Bolts and nuts
12. Cooling fan
13. Fan clamping bushing
14. Rubber seal ring
15. Fan cover
16. Self-threading screws for fan cover fixing
17. Terminal board complete with components
18. Terminal seal IP55
19. Screws for terminal box fixing IP56
20. Cable press
21. Terminal box IP65(base)
22. Terminal box IP65(cover)
23. Run capacitor
24. Mounting studs screws
25. Start capacitor
26. Flange B5
27. Flange B14
28. Screws for terminal box fixing Ip55

This catalogue is only a reference for users. The concrete data be changed please contact with us before ordering.

## Mountings and positions

Mountings and positions for standard motors, according to IEC 60034-7, are defined by the codes mentioned in the following table.

	STANDARDS		FRAME SIZES	
	CEI 2-14	IEC 60034-7	56-132	
		Code I	Code II	
	B3	IM B3	IM 1001	Standard
	B3/B5	IM B35	IM 2001	Standard
	B5	IM B5	IM 3001	Standard
	B14	IM B14	IM 4001	Standard
	B8	IM B8	IM 1071	Upon request
	B6	IM B6	IM 1051	Upon request
	B7	IM B7	IM 1061	Upon request

	STANDARDS		FRAME SIZES	
	CEI 2-14	IEC 60034-7	56-132	
		Code I	Code II	
	V1	IM V1	IM 3011	Standard
	V3	IM V3	IM 3031	Upon request
	V5	IM V5	IM 1011	Upon request
	V6	IM V6	IM 1031	Upon request
	V1/V5	IM V15	IM 2011	Upon request

## Aluminum Housing Electric Motors Bearings& oilseals

Frame	Bearings		Oilseals		☆ Thread of Cable Gland
	Drive end	Non-drive end	Drive end	Non-drive end	
56	6201	6201	12x22x5	12x22x5	M16
63	6201	6201	12x24x7	12x24x7	M16
71	6202	6202	15x25x7	15x25x7	M20
80	6204	6204	20x34x7	20x34x7	M20
90S	6205	6205(6204)☆☆	25x37x7	25x37x7(20x34x7)☆☆	M25
90L	6205	6205(6204)☆☆	25x37x7	25x37x7(20x34x7)☆☆	M25
100L	6206	6206	30x42x7	30x42x7	M25
112M	6306	6206	30x42x7	30x42x7	M25
132S	6308	6208	40x58x8	40x58x8	M32
132M	6308	6208	40x58x8	40x58x8	M32
160M	6309	6309	45x65x8	45x65x8	M32
160L	6309	6309	45x65x8	45x65x8	M32

☆ Other standard is also available as per request.

☆☆ The figures in bracket “ ( ) ” is for the MC/ML single phase motors.



