

RADIAL FANS



KMS - KTS

AC CENTRIFUGAL FANS Single Inlet

Due to motor location is out of airflow, higher temperature air can be transferred. Direct coupled motor structure (Single Phase / Three Phase)

Technical Drawings

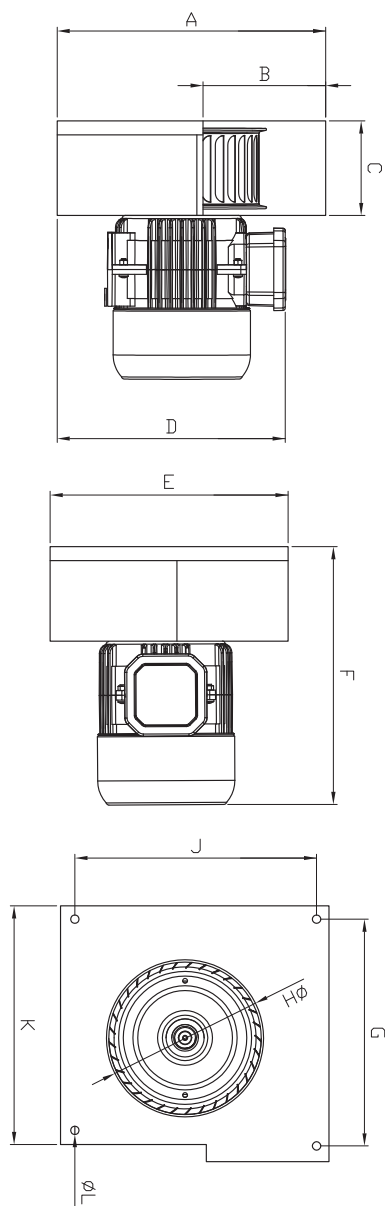

- MATERIAL** : Housing is made of electrostatic powder coated sheet steel, forward curved impeller is galvanized sheet metal.
- INSULATION CLASS** : Class B
- DIRECTIVE** : EN 60335-1, EN 60335-2-80
- SPEED CONTROL** : Speed can be adjusted using an optional controller.
- APPLICATION AREAS** : Factories, steam optioned iron machines, packaging machines, olive election machines, ventilation of small areas etc.

TYPE	VOLTAGE	FREQUENCY	POWER	CURRENT	CAPACITOR	SPEED	AIR FLOW	SOUND PRESSURE LEVEL	WEIGHT
	V	Hz	W	(A)	(μ F)	d/d	m ³ /h	dB(A)	kg
KMS	230	50	460	2,6	8	2750	1500	-	7,5
KTS	380	50	460	1,1	-	2870	1500	75	7,5

TYPE	A	B	C	D	E	F	G	H	J	K	L
KMS-KTS	278	114	106	231	248	282	198	178	235	238	8

Dimensions are in (mm)

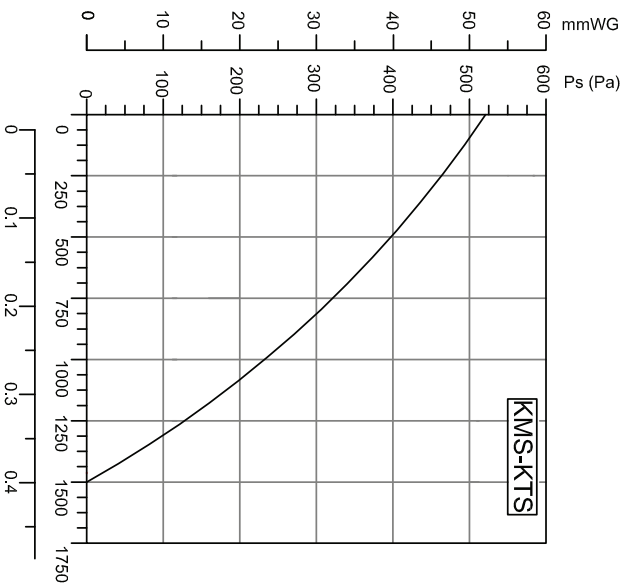

Accessories



BSC

