

Sauna equipment 2015/2016  
know-how for your well-being



## JUST RELAX.

Bathe in comforting warmth. Surround the body with gentle herbal steam and let your spirit inhale its mild aromas. To take a sophisticated sauna is not a short-lived trend but part of a life philosophy that enhances the body's ability to remain healthy and well-balanced.

## FULFIL INDIVIDUAL WISHES

For decades, EOS has been designing its sauna equipment with the individual desires of sauna enthusiasts in mind. Regardless of whether it is the classic Finnish sauna, the theme sauna, the herbal or the soft steam bath: We know what kind of demands the modern sauna must meet. Therefore, it is no wonder that EOS is the Europe's leader in the commercial as well as in the private sector, when it comes to innovation, design and quality.

## RELY ON OUR COMPETENCE.

On the following pages you will find everything you need to know about the current range of EOS sauna and steam equipment, interesting information about new trends, features and functions. The technical details will help you to quickly find the right models for your customers. Make your customers' dreams come true - by taking it the easy EOS way.

:: INNOVATIVE TECHNOLOGY AND  
MARKET LEADING QUALITY

# CONTENTS

04	Overview - dry (Finnish) heaters
06	Overview - Bi-O type heaters with vaporizer and accessories
08	Overview - sauna control units
10	Dry (Finnish) sauna heaters
32	Bi-O sauna heaters with vaporizer
48	Watermill Sauna heater
54	ECON sauna control units
62	EMOTEC® sauna control units
64	EMOTOUCH sauna control units
66	Power extension units (LSG)
68	S-Guard and other safety systems
72	Extension modules
76	Steam generators and accessories
86	Steam room doors
90	Infrared radiators and equipment
96	Flake ice machines E-Cool
98	SunSky / InfraSky systems
100	Essence dosing for sauna and steam rooms, salt inhalation
104	Sauna accessories
118	Important notes

# :: FINNISH SAUNA HEATERS



**M3**  
Page 12-13 >



**Mini**  
Page 12-13 >



**Filius / Filius Control**  
Page 18-19 >



**Cubo+**  
Page 20-21 >



**Finnrock**  
Page 22-23 >



**P1**  
Page 20-21 >



**34G**  
Page 26-27 >



**Goliath 34.GII**  
Page 26-27 >



**Thermat**  
Page 14-15 >



**Thermo-Tec (S)**  
Page 16-17 >



**43FN**  
Page 14-15 >



**Euro**  
Page 20-21 >



**Cubo**  
Page 20-21 >



**Euro-Max**  
Page 24-25 >



**Germanius**  
Page 24-25 >

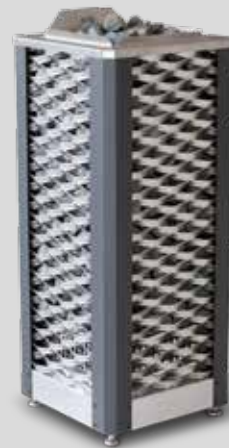

**Saunadome II**  
Page 22-23 >



**46.U and 46.U Compact**  
Page 30-31 >



**Invisio Midi**  
Page 28-29 >



**Invisio Mini**  
Page 28-29 >



**Invisio XL**  
Page 28-29 >

# :: BI-O SAUNA HEATERS



**Bi-O Mini**  
Page 34-35 >



**Bi-O Filius**  
Page 34-35 >



**Bi-O Thermat**  
Page 36-37 >



**Bi-O Tec**  
Page 36-37 >



**Bi-O Max**  
Page 38-39 >



**Bi-O Germanius**  
Page 40-41 >



**Bi-O Mat U**  
Page 42-43 >



**Bi-O Cubo**  
Page 38-39 >



**Bi-O Star**  
Page 42-43 >



**Watermill Sauna**  
Page 48 >



# :: SAUNA CONTROL UNITS



**Econ D1**  
finnish  
Page 54 >



**Econ H1**  
Bi-O  
Page 54 >

**Econ D2**  
finnish  
Page 56 >

**Econ H2**  
Bi-O  
Page 56 >



**Emotec D**  
finnish  
Page 62 >



**EmoTouch II+**  
Bi-O  
Page 64 >





**Econ D3**  
finnish  
Page 58 >



**Econ H3**  
Bi-O  
Page 58 >

**Econ D4**  
finnish  
Page 60 >

**Econ H4**  
Bi-O  
Page 60 >



**Emotec H**  
Bi-O  
Page 62 >



**EmoTouch II+ Steam**  
For steam rooms  
Page 64 / 82 >

# :: FINNISH SAUNA HEATERS

The image shows the interior of a Finnish sauna. The walls are covered in horizontal wooden slats. In the foreground, there is a large, rectangular, light-colored stone or concrete heater filled with dark grey rocks. A metal firebox is visible within the heater. To the left, there is a wooden bucket with a handle. In the background, there are wooden benches and a doorway leading to another part of the sauna. The lighting is warm and natural.

## WHY AN EOS SAUNA HEATER

- :: Know-how of the Europe's leading premium class manufacturer.
- :: Comprehensive model range from 3 to 36 kW.
- :: Large design variety in many price categories.
- :: Well-thought construction in every detail.
- :: Long-lasting products, robust and reliable.
- :: Extensive product support and service.
- :: Continuous quality control and product testing for safety and norm compliance.
- :: „Made in Germany“ quality.



FOR TRADITIONAL FINNISH SAUNA



3,0

## Mini wall-mounting

- :: Compact size sauna heater for saunas up to 5 m<sup>3</sup>.
- :: Very slim, place-saving design - only 20 cm depth.
- :: Polished chrome steel external shell.
- :: 3,0 kW power, single-phase power supply 230V 1N.
- :: 8 kg rock store, stones included in delivery.



3,0

## M3 wall-mounting

- :: Built-in control unit for quick and easy settings.
- :: Temperature control range 40 - 110 °C.
- :: Recommended for saunas up to 5 m<sup>3</sup>.
- :: Very slim design - only 20 cm depth.
- :: Durable triple-shell stainless steel construction.
- :: 3,0 kW power, single-phase power supply 230V 1N.
- :: 8 kg rock store, stones included in delivery.

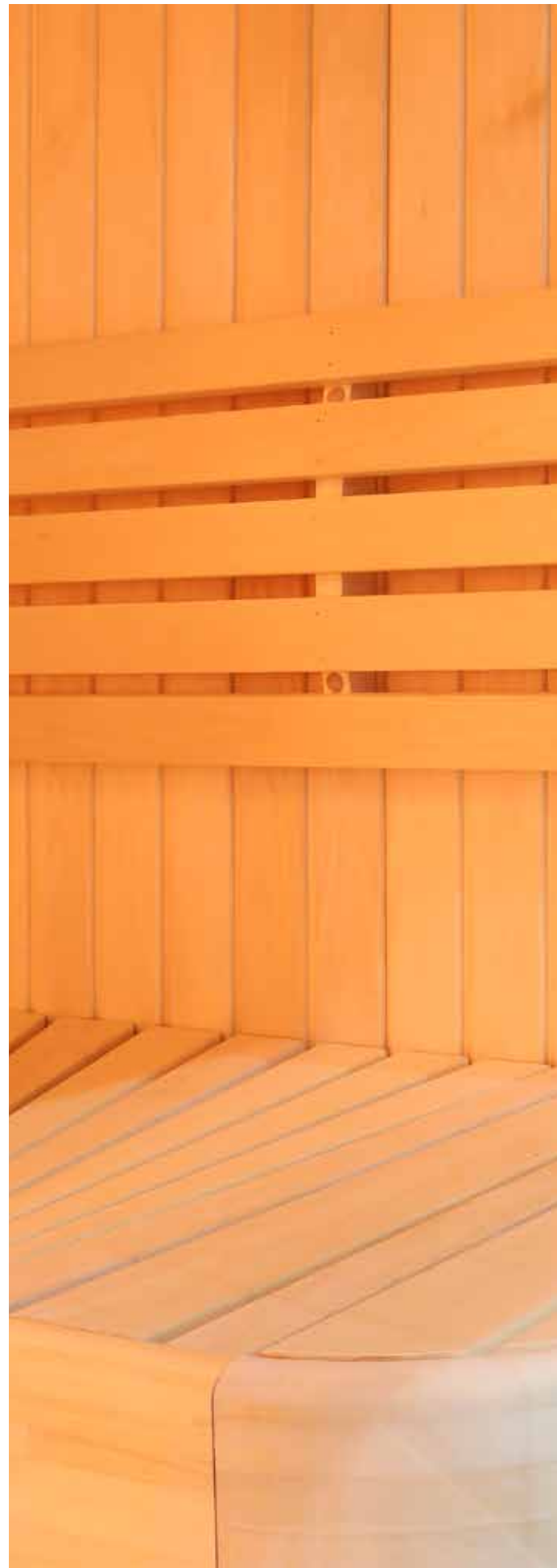

# :: FINNISH SAUNA HEATERS

Be it an icy cold winter's day or a mild summer's night - a bath in the sauna is always relaxing. With an EOS heater it is easy to be comfortable in a rustic sauna made of solid wood or in an element sauna of a stylish design.

Already the Basic range offers a large variety of Finnish or vaporizer heaters available as floor-standing or wall-mounting heaters in various designs.

EOS sauna heaters stand out through their well-thought construction, choice of top quality materials and meticulous attention to every detail.

The excellent convection of the EOS heaters provides optimum air circulation in the cabin and thus creates a pleasant sauna climate. All sauna heaters from EOS are of course supplied with the special olivine diabase sauna stones

Model	Item no.	Size (H x W x D)	Power
MINI	94.5650	500 x 300 x 200 mm	3,0 kW
M3	94.1921	600 x 300 x 200 mm	3,0 kW

# :: FINNISH SAUNA HEATERS

## QUALITY IS ATTENTION TO EVERY DETAIL

For our sauna heaters we use a special high quality powder coating with anthracite pearl effect finish. This powder coating is applied on the sauna heater shell in a complex process and then literally baked on it under very high temperatures. The result is a smooth, slightly shimmering surface with anthracite-grey colour.

Powder coated surfaces are considerably more scratch resistant in comparison to the wet pain and provide sauna heaters an attractive, contemporary design.

Model	Item no.	Size (H x W x D)	Power
Thermat	94.5479	600 x 375 x 360 mm	4,5 kW
	94.5480	600 x 375 x 360 mm	6,0 kW
	94.5481	600 x 375 x 360 mm	7,5 kW
	94.5482	600 x 375 x 360 mm	9,0 kW
43FN	94.2234	710 x 420 x 360 mm	6,0 kW
	94.2235	710 x 420 x 360 mm	7,5 kW
	94.2236	710 x 420 x 360 mm	9,0 kW



4,5

6,0

7,5

9,0

## Thermat wall-mounting

- :: Wall-mounting heater for domestic saunas 5 to 14 m<sup>3</sup>.
- :: Elegant die-cast aluminium top.
- :: Anthracite pearl effect finish.
- :: 15 kg rock store, stones included in delivery.

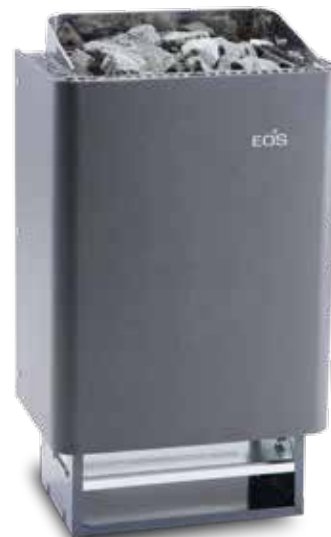

6,0

7,5

9,0

## 43FN floor-standing

- :: Floor-standing heater for domestic saunas from 6 to 14 m<sup>3</sup>.
- :: Anthracite pearl effect finish.
- :: Reinforced construction. Stainless steel top cover and deflector.
- :: 15 kg rock store, stones included in delivery.



- 6,0
- 7,5
- 9,0

## Thermo-Tec wall-mounting

- :: Wall-mounting sauna heater for domestic saunas from 5 to 14 m<sup>3</sup>.
- :: With an elegant, curved die-cast aluminium top cover with integrated holders for optional essence cup holder or aroma tray.
- :: Stainless steel inner shell, reinforced construction.
- :: 15 kg rock store, stones included in delivery.

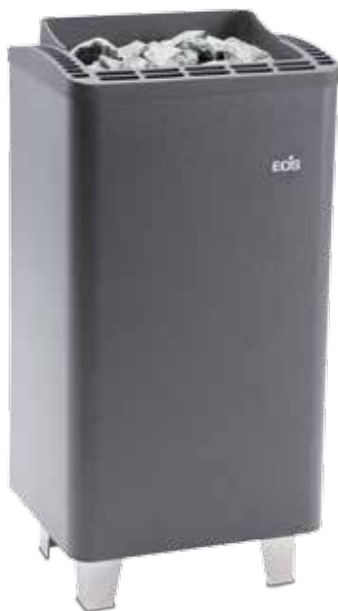

- 6,0
- 7,5
- 9,0

## Thermo-Tec S floor-standing

- :: Floor-standing version based on the Thermo-Tec model.
- :: With an elegant, curved die-cast aluminium top cover with integrated holders for optional essence cup holder or aroma tray.
- :: Stainless steel inner shell, reinforced construction.
- :: 15 kg rock store, stones included in delivery.



For optional accessories for Thermo-Tec series sauna heaters see page 45.



# :: FINNISH SAUNA HEATERS

## AIR CONVECTION - THE KEY TO THE PROPER SAUNA OPERATION

Effective, stable air convection is essential for the proper operation of every sauna cabin.

Good air convection ensures that the heat from the stove spreads quickly around the cabin and the sauna is ready for use faster. Properly circulating air means continuous air exchange and proper cooling of the stove preventing its overheating.

EOS sauna heaters are designed to ensure and promote the best possible air convection. Heating elements are either completely separated from the stones or contact them only with their ends. The space between the inner and the outer shell serves as a natural air channel.

This ensures a stable and continuous air flow. The heating elements do not get overheated which greatly extends their service life. Also the overall lifetime of the stove improves.

At the same time EOS sauna heaters feature an optimized rock store size with the well balanced quantity of stones. This ensures good air circulation on one side and the large enough stone volume for powerful water splashes on the other side.

Decades of experience in development of sauna heaters, as well as the unique experience from the cooperation with the world's leading sauna cabins manufacturers ensure that the EOS sauna heaters lead the market when it comes to reliability, quality and design.

Model	Item no.	Size (H x W x D)	Power
Thermo-Tec	94.5688	600 x 375 x 380 mm	6,0 kW
	94.5689	600 x 375 x 380 mm	7,5 kW
	94.5690	600 x 375 x 380 mm	9,0 kW
Thermo-Tec S	94.5684	780 x 375 x 360 mm	6,0 kW
	94.5685	780 x 375 x 360 mm	7,5 kW
	94.5686	780 x 375 x 360 mm	9,0 kW

# :: FINNISH SAUNA HEATERS

The background image shows the interior of a Finnish sauna. The walls, ceiling, and benches are made of light-colored wood. A heater is visible in the foreground, consisting of a wooden frame with a metal grate containing stones. The lighting is warm and ambient.

Model	Item no.	Size (H x W x D)	Power
Filius	94.5031	570 x 400 x 240 mm	4,5 kW
	94.5032	570 x 400 x 240 mm	6,0 kW
	94.5033	570 x 400 x 240 mm	7,5 kW
Filius Control	94.6038	570 x 400 x 240 mm	4,5 kW
	94.6039	570 x 400 x 240 mm	6,0 kW
	94.6040	570 x 400 x 240 mm	7,5 kW



4,5

6,0

7,5

## Filius wall-mounting

- :: Finish sauna heater for domestic saunas from 4 to 10 m<sup>3</sup>
- :: Very slim - only 24 cm depth, direct mounting to the sauna wall
- :: Modern, timeless design. Brushed stainless steel top, outer shell in anthracite pearl effect finish.
- :: 8 kg rock store, stones included in delivery.



4,5

6,0

7,5

## Filius Control built-in controls

- :: Compact wall-mounting heater with built-in control unit (temperature and heating time control).
- :: Control unit at the top side for quick and simple operation.
- :: Very slim - only 24 cm depth, direct mounting to the sauna wall
- :: Temperature sensor inside the heater, no installation needed.
- :: 8 kg rock store, stones included in delivery.



7,5

9,0

10,5

12,0

## Euro wall-mounting/floor-standing

- :: Upper class sauna heater for sauna rooms from 7 to 18 m<sup>3</sup>.
- :: Suitable for domestic and commercial use.
- :: With the optional feet may be used as a floor-standing model.
- :: Place-saving design - only 35 cm depth.
- :: Durable triple-shell construction, all made of stainless steel.
- :: Massive die-cast iron top, polished chrome steel outer shell.
- :: 15 kg rock store, stones included in delivery.



7,5

9,0

12,0

## Cubo / Cubo Plus floor-standing

- :: Modern design heater for sauna rooms from 7 to 18 m<sup>3</sup>.
- :: Suitable for domestic and commercial use.
- :: Compact foot print 40 x 39 cm thanks to the recessed terminal box.
- :: Rock store above the heating elements - for improved air convection, longer lifetime of heating elements, simplified servicing.
- :: Outer shell in anthracite pearl effect finish.
- :: Brushed stainless steel top.
- :: Rear side cover in anthracite finish optionally available.
- :: Cubo - 25 kg rock store, stones included in delivery.
- :: Cubo Plus - extra-large 40 kg rock store, stones included.



10,5

12,0

15,0

## P1 floor-standing

- :: Sauna heater for commercial saunas 10 to 25 m<sup>3</sup>.
- :: Robust, durable construction of stainless steel.
- :: Polished chrome steel outer shell.
- :: Optimized air convection for faster heat-up times.
- :: Slim design - only 380 mm depth.
- :: 30 kg rock store, stones included in delivery.



**Rear side cover for Cubo and Cubo+**  
 Optionally available for Cubo and Cubo Plus heaters, rear side cover in anthracite finish - ideal e.g. by installation in front of glass.

# :: FINNISH SAUNA HEATERS

Model	Item no.	Size (H x W x D)	Power
EURO	90.7686	610 x 460 x 350 mm	7,5 kW
	90.7687		9,0 kW
	94.5185		10,5 kW
	94.8076		12,0 kW
Feet	90.7110	Height with feet 760 mm	
Cubo	94.5073	750 x 400 x 385 mm	7,5 kW
	94.5074		9,0 kW
	94.5075		12,0 kW
Cubo+	94.5974	750 x 400 x 385 mm	7,5 kW
	94.5975		9,0 kW
	94.5976		10,5 kW
	94.5977		12,0 kW
P1	94.2830	720 x 630 x 380 mm	10,5 kW
	90.8775		12,0 kW
	90.8776		15,0 kW

# :: FINNISH SAUNA HEATERS



Model	Item no.	Size (H x W x D)	Power
Finnrock	94.3931	760 x 413 x 385 mm	7,5 kW
	94.3932		9,0 kW
	94.3933		12,0 kW
Rear side cover	94.5566	For Finnrock heaters	
Saunadome II	94.5603	1000 x 400 x 400 mm	9,0 kW
	94.5604		12,0 kW
	94.5605		15,0 kW
	94.5606		18,0 kW



7,5

9,0

12,0



## Finnrock floor-standing

- :: Premium class designer sauna heater for domestic and commercial saunas from 7 to approx. 18 m<sup>3</sup>.
- :: Unique design thanks to the partially open rock store with a special design front side grill. Compact footprint - 40 x 39,5 cm size.
- :: Extra large rock store with 40 kg volume - for powerful water splashes and high temperature stability.
- :: Very robust construction, completely made of stainless steel
- :: Rock store above the heating elements - for improved air convection, longer lifetime of heating elements and simplified servicing.
- :: Rear side cover in anthracite pearl effect finish optionally available.
- :: 40 kg stones included in delivery scope.

9,0

12,0

15,0

18,0



## Saunadome II floor-standing

- :: Upmarket category sauna heater in unique „Tower“ design for domestic and commercial sauna rooms from 10 to approx. 30 m<sup>3</sup>.
- :: 100 kg rock store - ideal for frequent, powerful water splashes and high temperature stability.
- :: Rock store open on all sides - allows water splashes from any side.
- :: Optimal for central placement or installation in front of glass walls.
- :: High safety - thanks to specially angled side frame the stones and water remain inside the rock store and may not fall out of the heater.
- :: Very high heat storage capacity.
- :: 100 kg stone volume, stones included in delivery.



### Mounting brackets for guard rail

Allows to mount a custom-design wooden guard rail directly to the heater. Ideal by installation e.g. in front of glass.

9,0

12,0

15,0



## Euro-Max floor-standing

- :: Premium class sauna heater for domestic and commercial sauna rooms from 9 to approx. 25 m<sup>3</sup>.
- :: Extra-large 60 kg rocks store with enlarged side air channels ensures top-performance at all times.
- :: Reinforced, very durable construction, all made of stainless steel.
- :: Elegant, curved die-cast aluminium top with holders for optional herbs bowl or essence tray.
- :: Rock store above the heating elements - heating elements may be replaced without removing the stones.
- :: 60 kg stone volume, stones included in delivery.



12,0

15,0

18,0



## Germanius floor-standing

- :: Luxury class designer sauna heater for domestic and commercial sauna rooms from 10 to approx. 30 m<sup>3</sup>.
- :: Curved smoked quartz glass front panel with the unique „fire-place“ illumination effect from the glowing heating elements.
- :: Extra thick brushed stainless steel top with holder for optional accessories like herbs bowl or essence tray.
- :: Special design aluminium side panels in anthracite finish.
- :: Rock store above the heating elements.
- :: 60 kg stone volume, stones included in delivery.



# :: FINNISH SAUNA HEATERS

The exclusive Germanius sauna heater will be an eye-catcher in every sauna cabin. It combines the unique design with an innovative construction - true luxury class with one-of-a-kind features for the highest demands.

Germanius heater features the front side made of an elegantly curved quartz glass, enclosed in stylish aluminium side profiles completed with a massive brushed stainless steel top.

The glowing heating elements illuminate the normally not transparent smoked glass through the hidden window in the inner shell and produce a spectacular „fireplace“ lighting effect.



Model	Item no.	Size (H x W x D)	Power
Euro-Max	94.2320	900 x 500 x 500 mm	9,0 kW
	94.2321		12,0 kW
	94.3882		15,0 kW
Germanius	94.3931	918 x 618 x 510 mm	12,0 kW
	94.3932		15,0 kW
	94.3933		18,0 kW

# :: FINNISH SAUNA HEATERS

Model	Item no.	Size (H x W x D)	Power
34G Type 1	94.8586	950 x 750 x 530 mm	15,0 kW
	94.8587		18,0 kW
	94.8588		21,0 kW
34G Type 2	94.8589	950 x 1000 x 530 mm	24,0 kW
	94.8590		27,0 kW
	94.8591		30,0 kW
	94.8592		36,0 kW
Goliath	94.4805	825 x 960 x 470 mm	18,0 kW
	94.4806		24,0 kW
	94.4807		30,0 kW
	94.4808		36,0 kW

## Accessories



Stack frame for additional 30 kg stones, for 34G heaters



Stack frame for additional 30 kg stones and cover protection rail with direct heater mounting.





15,0

18,0

21,0

24,0

27,0

30,0

36,0

## 34.G floor-standing

- Size 1 (750 mm): 15,0 - 21,0 kW
- Size 2 (1000 mm): 24,0 - 36,0 kW
- :: Commercial sauna heater for large saunas up to 75 m<sup>3</sup>.
- :: Designed for very intensive commercial operation.
- :: Exceptionally robust and durable construction, completely made of stainless steel. Terminal box with ceramic terminals.
- :: Stone volume may be increased by 30 kg with an optional stack frame.



18,0

24,0

30,0

36,0

## Goliath floor-standing

- :: Modern, design-oriented sauna heater for large saunas up to 75 m<sup>3</sup>.
- :: Optimal for very intensive commercial operation.
- :: Very robust and durable, completely made of stainless steel.
- :: Optional brackets for heater guard rail mounting directly on the heater.
- :: External shell in anthracite pearl effect finish. Brushed stainless steel top. Terminal box with ceramic terminals.
- :: Extra-large rock store with 75 kg volume, stones included in delivery.



### Mounting brackets for guard rail

Optional mounting brackets allow to mount a wooden guard rail in own design directly on the Goliath heater.



9,0

## Invisio XL underbench heater

- :: Underbench sauna heater for domestic and commercial saunas.
- :: High safety and place-saving effect thank to the concealed under-bench installation. Only 10 cm gap to the partition wall needed.
- :: Extra-large rock store with the water splash gutter across the full width. Includes water funnel, safety grill and pre-mounted cable.
- :: 75 kg stones included in delivery.



6,0

9,0

12,0

## Invisio Midi underbench heater

- :: Underbench sauna heater for domestic and commercial saunas.
- :: Slim version - only 38 cm depth, 20 kg rock store.
- :: 20 kg stones included in delivery.



3,0

4,5

6,0

## Invisio Mini underbench heater

- :: Compact version for saunas up to 8 m<sup>3</sup> size.
- :: Only 66 cm width, 15 kg rock store. Stones included in delivery.



Installation example Invisio XL

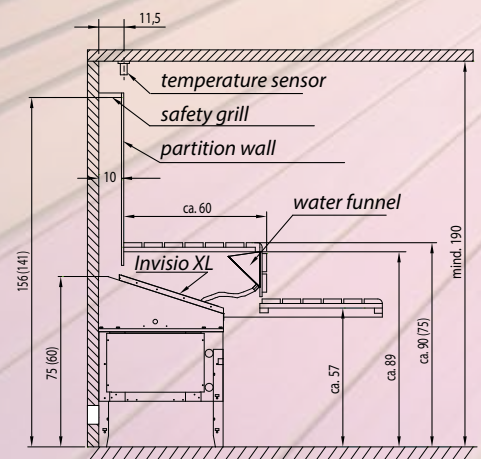

# :: FINNISH SAUNA HEATERS



Invisio is a special range of the unique concealed „under-bench“ sauna heaters.

Invisio sauna heaters are installed under the sauna benches with a partition wall with only as little as 10 cm gap to the main sauna wall.

Thanks to their construction and unique installation Invisio heaters offer high safety standards and save a lot of valuable space in the cabin. There is no more no risk of accidentally touching the heater and your sauna will look more spacious inside.

In spite of the hidden installation traditional water splashes are of course still possible. All Invisio heaters include a stainless steel water funnel with silicone tube. The special gutter inside the heater spreads the water over the entire heater width to ensure quick evaporation. All Invisio heaters also include pre-mounted cable and safety cover protection grill.

Installation example Invisio Midi

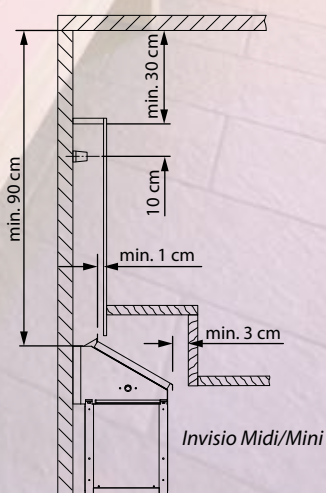

Model	Item no.	Size (H x W x D)	Power
Invisio XL	94.5522	800 x 1160 x 580 mm	9,0 kW
Invisio XL Anthracite	94.5816	800 x 1160 x 580 mm	9,0 kW
Invisio Midi	94.5786	650 x 1160 x 380 mm	6,0 kW
	94.5787		9,0 kW
	94.5788		12,0 kW
Invisio Midi Anthracite	94.5813	650 x 1160 x 380 mm	6,0 kW
	94.5814		9,0 kW
	94.5815		12,0 kW
Invisio Mini	94.5708	650 x 660 x 380 mm	6,0 kW
	95.5709		9,0 kW
	95.5710		12,0 kW
Invisio Mini Anthracite	94.5810	650 x 660 x 380 mm	6,0 kW
	94.5811		9,0 kW
	94.5812		12,0 kW

# :: FINNISH SAUNA HEATERS

## CONCEALED INSTALLATION - PLACE-SAVING AND SAFE

46.U sauna heaters provide two important advantages - they are installed behind a partition wall with only 22 cm gap to the sauna wall, which saves a lot of valuable space in a sauna room. This will allow more space for sauna benches and will make your sauna look more spacious. With only 20 cm depth 46.U heaters belong to the slimmest models on the market today.

The concealed installation ensures at the same time increased safety in use - the heater cannot be accidentally touched while it is hot. A special safety grill mounted along the top edge of the partition wall effectively prevents objects from being dropped down on the heater. 46.U heaters have been tested and approved for safety and compliance with the latest European norms.

The traditional water splashes are of course possible. Every heater includes a water funnel with the connection hose. Thanks to the special gutter inside the heater the water is spread across its full width for a quick and effective evaporation. And despite their slim depth 46.U heaters still feature an approx. 8 kg rock store.

### Installation example for 46.U sauna heaters

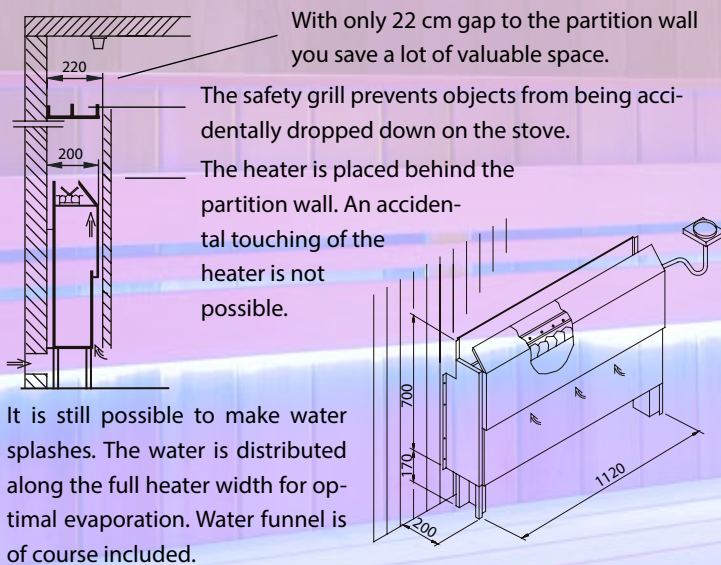

Model	Item no.	Size (H x W x D)	Power
46.U	94.4887	870 x 1120 x 200 mm	6,0 kW
	94.4888	870 x 1120 x 200 mm	7,5 kW
	94.4889	870 x 1120 x 200 mm	9,0 kW
	90.8608	870 x 1120 x 200 mm	12,0 kW
46.U Compact	94.4250	870 x 920 x 200 mm	7,5 kW



6,0

7,5

9,0

12,0

## 46.U behind-bench

- :: Sauna heater for concealed installation behind a partition wall.
- :: Optimal for intensive commercial use.
- :: Only 20 cm depth - slim design saves valuable space in a sauna.
- :: Very robust and reliable, completely made of stainless steel.
- :: Integrated gutter for water distribution, stones above the heating elements.
- :: High safety in use, no risk of touching the heater.
- :: Includes accessories: safety grill, water funnel with silicone hose, 6 m connection cable.
- :: 15 kg sauna stones included in delivery.



7,5

## 46.U Compact behind-bench

- :: Compact-size version of the 46U model.
- :: Only 920 mm width. Available with 7,5 kW power.
- :: Includes accessories: safety grill, water funnel with silicone hose, 6 m connection cable, sauna stones.

# :: BI-O SAUNA HEATERS







## SAUNA HEATERS WITH BUILT-IN VAPORIZER



3,0

## Bi-O Mini wall-mounting

- :: Combi-heater for small domestic saunas, 230 V 1N power supply.
- :: Very compact, place-saving design.
- :: Built-in vaporizer allows to set a large variety of climate forms - from traditional hot & dry to mild and humid.
- :: Vaporizer output 0,75 kW. Integrated cup holder for essences.
- :: Available with polished stainless steel or anthracite finish outer shell.



4,5

6,0

7,5

## Bi-O Filius wall-mounting

- :: Versatile combi-heater for domestic saunas in extra-slim design.
- :: Only 24 cm depth, mounts directly to the sauna wall.
- :: Modern straight-lined design with anthracite finish outer shell.
- :: Vaporizer 1,5 kW, can be mounted on the left and on the right. With cup holder for essences. Manual water filling.
- :: 8 kg rock store, stones included in delivery.



# :: BI-O SAUNA HEATERS

## BI-O SAUNA HEATERS - SET THE CLIMATE AS YOU LIKE IT

Today a traditional hot Finnish sauna, tomorrow a mellow warm air both, and the next day an invigorating herbal steamy sauna bath: EOS Bi-O type sauna heaters with an integrated vaporizer allow to set the climate in your sauna just as you like it.

The vaporizer mounted right next to the heater section lets the steam out around the stones to make it spread quickly around the cabin. An integrated bowl allows to place oils and sauna essences to make your sauna an aromatically exhilarating experience for the senses.

EOS Bi-O systems ensure optimal safety - sound alarm and automatic switch-off by water shortage are standard and the control units automatically adjust temperature and humidity.

Model	Item no.	Size (H x W x D)	Power
Bi-O Mini chrome steel	94.2444A	660 x 300 x 200 mm	3,0 kW
Bi-O Mini anthracite	94.6027	660 x 300 x 200 mm	3,0 kW
Bi-O Filius	94.5144A	575 x 470 x 240 mm	4,5 kW
	94.5145A	575 x 470 x 240 mm	6,0 kW
	94.5146	575 x 470 x 240 mm	7,5 kW

# :: BI-O SAUNA HEATERS

Model	Item no.	Size (H x W x D)	Power
Bi-O Thermat	94.5484	760 x 450 x 380 mm	6,0 kW
	94.5485	760 x 450 x 380 mm	7,5 kW
	94.5486	760 x 450 x 380 mm	9,0 kW
Bi-O Tec anthracite	94.2605A	600 x 450 x 380 mm	6,0 kW
	94.2606A	600 x 450 x 380 mm	7,5 kW
	94.2607A	600 x 450 x 380 mm	9,0 kW
Bi-O Tec chrome steel	94.2608A	600 x 450 x 380 mm	6,0 kW
	94.2609A	600 x 450 x 380 mm	7,5 kW
	94.2610A	600 x 450 x 380 mm	9,0 kW





6,0

7,5

9,0

## Bi-O Thermat wall-mounting

- :: Affordable combi-heater for domestic sauna cabins.
- :: Die-cast aluminium top, anthracite pear effect finish.
- :: Vaporizer 1,5 kW with 5 l tank, manual water filling.
- :: 15 kg rock store, stones included in delivery.



6,0

7,5

9,0

## Bi-O Tec wall-mounting

- :: High quality combi-heater for domestic sauna cabins.
- :: Elegantly curved die-cast aluminium top cover.
- :: Stainless steel inner shell. Outer shell alternatively in anthracite finish or in polished chrome steel.
- :: Essences cup holder at the steam output.
- :: Vaporizer 2 kW with 5 l water tank, manual water filling.
- :: Optional accessories: herbs bowl, aroma tray (see page 45).

7,5

9,0

10,5

12,0



## Bi-O Cubo floor-standing

- :: Modern design floor-standing combi-heater for domestic and commercial sauna cabins.
- :: Contemporary straight-lined design with brushed stainless steel top and anthracite pearl effect outer shell finish.
- :: Recessed terminal box make Bi-O Cubo ideal for installation in front of glass panels.
- :: Innovative construction - vaporizer placed under the heater, which ensures a very place-saving footprint 40 x 39,5 cm.
- :: 2 kW vaporizer with 7 l stainless steel water tank.
- :: Extra-large essence holder mounted in the rock store.
- :: 25 kg rock store, stones included in delivery.

9,0

12,0

15,0



## Bi-O Max floor-standing

- :: Premium-class floor-standing combi-heater for domestic and commercial saunas
- :: Optimal for an intensive commercial use.
- :: Timeless design, die-cast aluminium top and front cover, anthracite pear effect finish outer shell.
- :: Proven construction - durable and highly reliable, completely made of high grade stainless steel.
- :: Extra-large 60 kg rock store for powerful water splashes and temperature stability. Stones included in delivery.
- :: Service-friendly design - rock store above heating elements.
- :: Improved air convection thanks to the large side channels - very fast heat-up time and continuously high performance.
- :: 2 kW vaporizer with stainless steel water tank. Manual filling (automatic filling optionally possible).
- :: Optional accessories: large herbs bowl or aroma tray for mounting on the heater (see page 45).

# :: BI-O SAUNA HEATERS



Model	Item no.	Size (H x W x D)	Power
Bi-O Cubo	94.5922	900 x 400 x 395 mm	7,5 kW
	94.5923	900 x 400 x 395 mm	9,0 kW
	94.5924	900 x 400 x 395 mm	10,5 kW
	94.5925	900 x 400 x 395 mm	12,0 kW
Bi-O Max	94.2317	900 x 500 x 500 mm	9,0 kW
	94.2318	900 x 500 x 500 mm	12,0 kW
	94.3922	900 x 500 x 500 mm	15,0 kW

# :: BI-O SAUNA HEATERS

## DESIGN IS KING

A sauna heater is not a stand-alone product, in modern design-oriented saunas sauna heaters become more and more often an important part of the entire design concept.

EOS offers one of the largest design varieties in the world to let you design a perfect sauna where the heater optimally matches the design solution as every other element.

Model	Item no.	Size (H x W x D)	Power
Bi-O Germanius	94.3926	918 x 618 x 510 mm	9,0 kW
	94.3927	918 x 618 x 510 mm	12,0 kW
	94.3928	918 x 618 x 510 mm	15,0 kW
	94.3929	918 x 618 x 510 mm	18,0 kW





9,0

12,0

15,0

18,0

## Bi-O Germanius floor-standing

- :: Luxury class designer combi-heater for demanding domestic and commercial sauna cabins.
- :: Unique design thanks to the curved smoked quartz glass front and massive aluminium side panels.
- :: Spectacular "fireplace" illumination effect from the glowing heating elements.
- :: Robust, highly stable and durable construction made of high grade stainless steel.
- :: Extra-large rock store with 60 kg volume, rock store placed above heating elements. Stones included in delivery.
- :: Improved air convection thanks to the large side channels - very fast heat-up time and continuously high performance.
- :: 2 kW vaporizer with stainless steel water tank.
- :: Automatic water refilling (integrated top-up device).
- :: Optional accessories: large herbs bowl or aroma tray for mounting on the heater (see page 45).

15,0

18,0

21,0

24,0

30,0



## Bi-O Star floor-standing

- :: Heavy-duty commercial combi-heater for large sauna cabins. Construction based on the proven 34.G sauna heater.
- :: Very durable and reliable construction, all made of high grade stainless steel.
- :: Built-in 2 kW vaporizer, from 21 kW - 2 x 2 kW vaporizer (left and right). Manual filling (automatic refilling optionally possible).
- :: 15-21 kW - 30 kg stone volume, 24 - 30 kW - 45 kg stone volume.
- :: With an optional stack frame the stone volume may be increased by 30 kg.

7,5

9,0

12,0



## Bi-O Mat U behind-the-bench

- :: Combi-heater for concealed behind-the-bench installation. Based on the proven 46.U heater construction. For domestic and commercial use.
- :: Very slim design – only 200 mm depth.
- :: Robust, durable construction, all made of high grade stainless steel
- :: Vaporizer 1,5 kW (by 12 kW version - 2 kW) with dry run protection and acoustic water shortage alarm. Manual filling (automatic refilling optionally possible).
- :: Includes accessories: cover protection safety grill, water funnel with silicone hose, pre-mounted 6 m silicone cable.



# :: BI-O SAUNA HEATERS

Model	Item no.	Size (H x W x D)	Power
Bi-O Star	94.2587	950 x 750/1000 x 530 mm	15,0 kW
	94.2588	950 x 750/1000 x 530 mm	18,0 kW
	94.2589	950 x 750/1000 x 530 mm	21,0 kW
	94.4079	950 x 750/1000 x 530 mm	24,0 kW
	94.3037	950 x 750/1000 x 530 mm	30,0 kW
Bi-O Mat U	94.4891	1000 x 1120 x 200 mm	7,5 kW
	94.4892	1000 x 1120 x 200 mm	9,0 kW
	94.1127	1000 x 1120 x 200 mm	12,0 kW

# :: ACCESSORIES AND UPGRADES

Model	Item no.
Aroma tray with mounting bracket	94.4884
Herbs bowl with mounting bracket	94.4885
Herbs bowl with "wave" mounting	94.4221
Essence cup clip (Thermotec, Thermat, Filius)	94.5682
Essence cup clip (Euro heater)	94.5720





## Aroma tray

- :: Tray with a large evaporating surface.
- :: Made of high grade sand-blown stainless steel
- :: Includes mounting bracket.
- :: Quick and simple installation.
- :: For sauna heaters: Thermo-Tec (S), Bi-O Tec, Euro-Max, Bi-O Max, Germanius.



## Herbs bowl

- :: Large bowl, ideal for herbs, essences and oils, or salt crystals
- :: Made of high grade stainless steel, approx. 0,6 l volume.
- :: Includes mounting bracket.
- :: Quick and simple installation.
- :: For sauna heaters: Thermo-Tec (S), Bi-O Tec, Euro-Max, Bi-O Max
- :: Also available as a „Multicup“ version for wall mounting.  
With or without herbs strainer.



## Herbs bowl “wave”

- :: Herbs bowl with an elegantly curved, wave-alike mounting bracket.
- :: Ideal for herbs, sauna essences, oil or salt crystals.
- :: Made of high grade stainless steel.
- :: For sauna heaters: Germanius, Bi-O Germanius, Euro-Max, Bi-O Max, Bi-O Tec, Thermo-Tec, Thermo-Tec S.



## Essence cup

- :: Innovative essence cup with clip holder - may be easily added to already existing sauna heaters.
- :: Ideal for sauna essences and oils.
- :: Just plug the clip holder on the heater’s wall.
- :: Made of high grade stainless steel.
- :: Fits a large variety of sauna heater models.

# :: ACCESSORIES AND UPGRADES

Model	Item no.
Drain pan	94.5425
FWA 01 Compact	94.4845
FWA 03 Compact	94.6071
Auxiliary vaporizer	94.4742

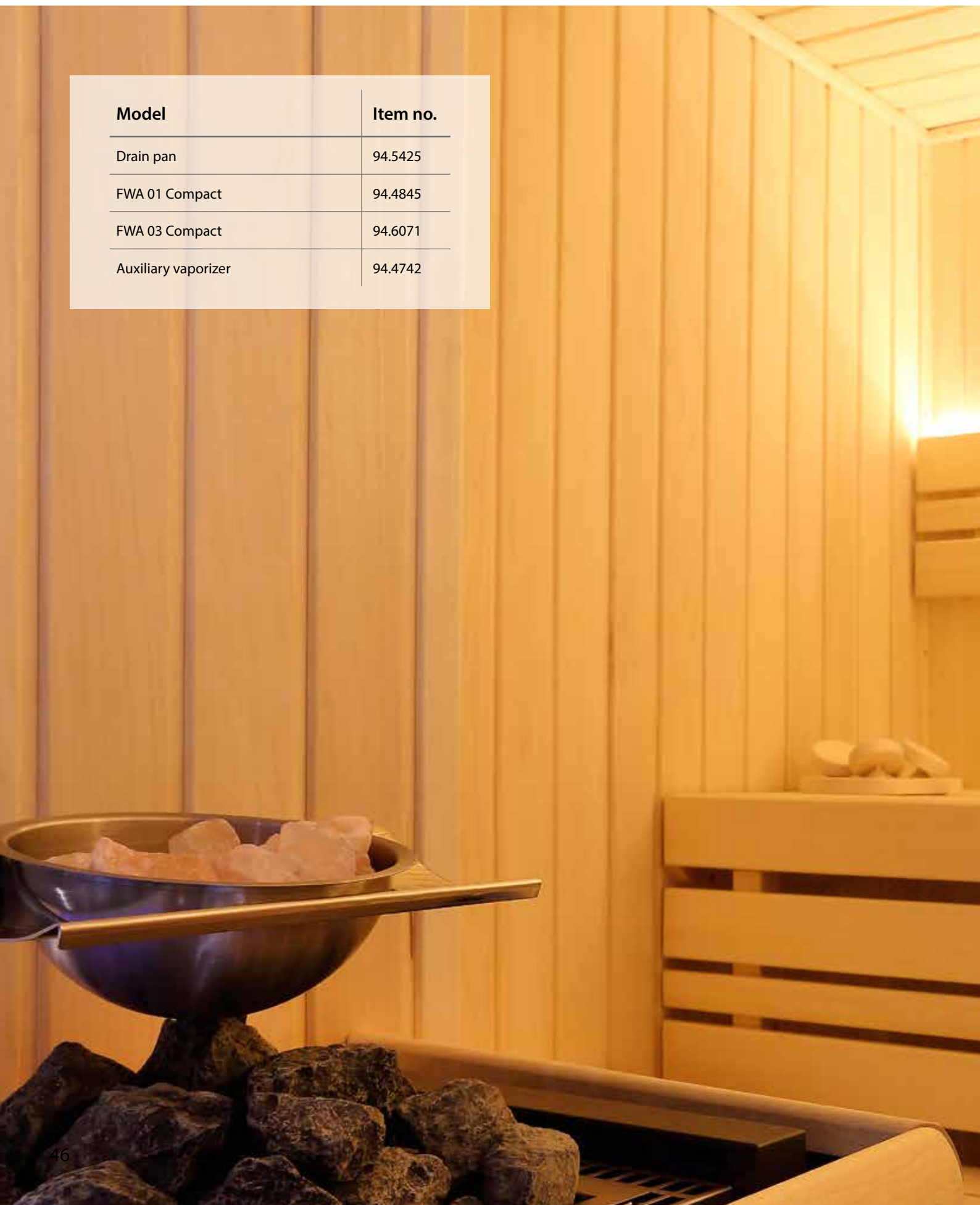

## Drain pan

- :: Made of robust plastic, with integrated handle.
- :: For Bi-0 type heaters with vaporizer.
- :: To collect drain water from the vaporizer.

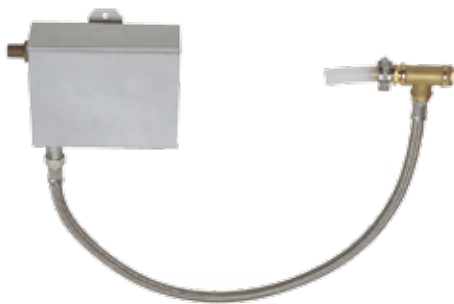

## FWA 01 / FWA 03 Compact top-up device

- :: For automatic refilling of the vaporizer from a permanently connected water supply.
- :: Very practical especially by commercial use.
- :: Mounts either on the sauna heater or on the adjacent sauna wall.
- :: Includes flex hose with 1/2" connection.
- :: Mechanical action, no power supply needed.

## Auxiliary vaporizer

- :: Slim, place-saving design. Essence holder at the steam exit. Wall-mounting.
- :: Powerful steam source - 2 kW power, 5 l water tank.
- :: May be retrofitted into existing sauna cabins. Stainless steel housing.
- :: Manual water filling through the steam opening.
- :: Dry run protection with sound alarm by water shortage.
- :: Single phase power supply 230 V 1N AC.



# :: WATER MILL SAUNA

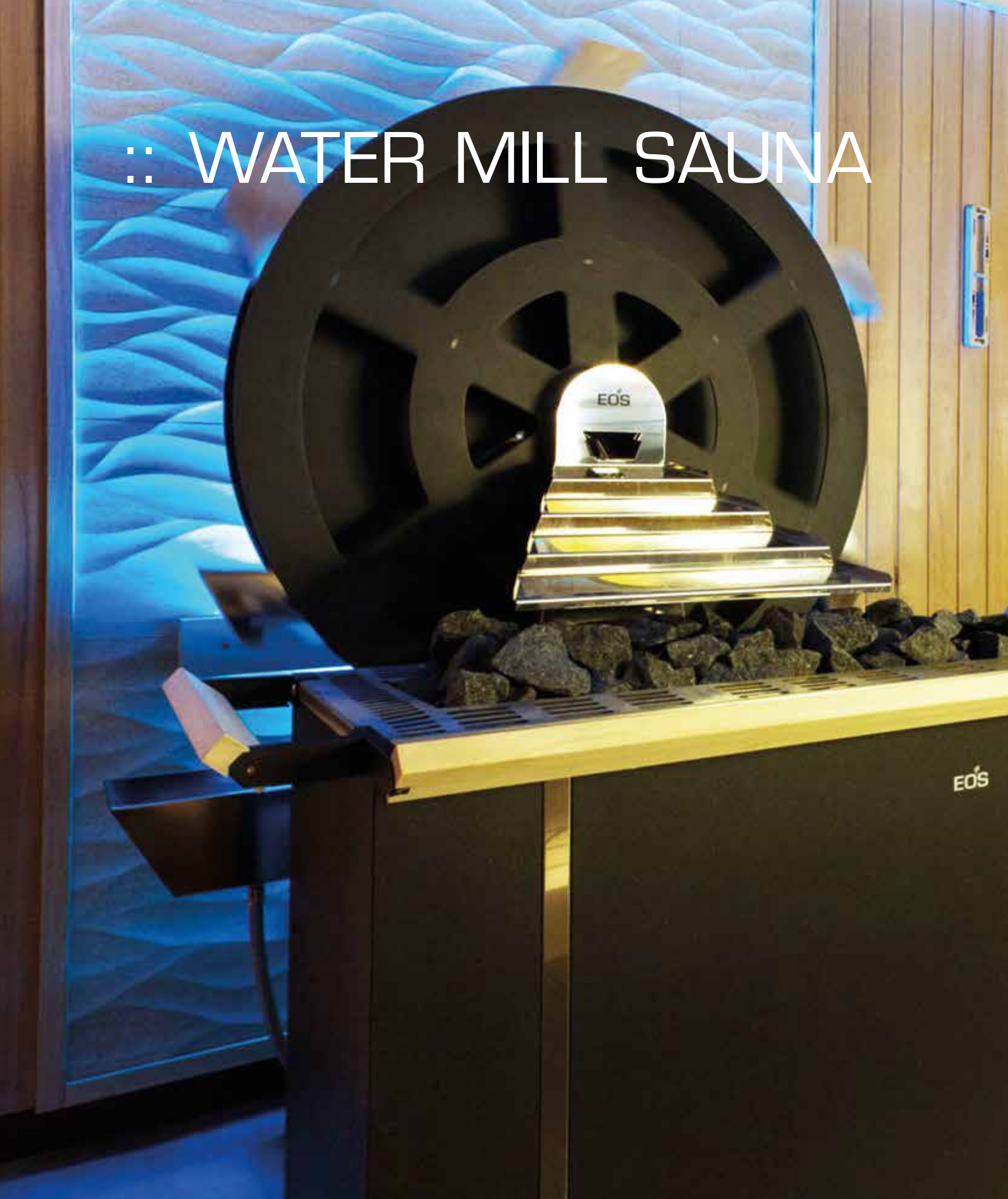





## EVENT HEATER FOR THEMED SAUNAS

# :: WATER MILL SAUNA

## WATER MILL SAUNA

The water mill sauna brings “action” and a unique water splash experience in every sauna room. The spectacular water mill wheel is perfectly completed with an impressive 34G sauna heater or a Goliath sauna heater.

The water mill wheel rotates slowly counter-clockwise which already makes it an attraction in the sauna room.

After an automatic signal it starts to rotate in other direction, so that the scoops take some water from the basin under the wheel and pour it directly into the cascade mounted over the heater, causing powerful and spectacular steam shock effects.

A very large stone volume of the sauna heater ensures at the same time high energy reserves and water evaporation capability.

Design hint: in combination with the coloured light or sound effects the water splashes may be turned into a spectacular ceremony and a unique experience for all sauna guests.



Model	Item no.	Size (H x W x D)	Power
Sauna heater 34.GM	94.3076	950 x 750 x 530 mm	18,0 kW
	94.3092		27,0 kW
	94.5149	950 x 1000 x 530 mm	30,0 kW
	94.3093		36,0 kW
Sauna heater Goliath	94.6223	825 x 960 x 470 mm	18,0 kW
	94.6224		24,0 kW
	94.6225		30,0 kW
	94.6226		36,0 kW
Water mill wheel	94.3077		



Water mill sauna set with a Goliath heater



18,0

27,0

30,0

36,0

## Set Water mill wheel + 34.GM or Goliath heater

- :: High-End sauna heater set for luxury class themed saunas, recommended for saunas from 25 m<sup>3</sup> size.
- :: With a continuously rotating mill wheel and spectacular water splashes at pre-set intervals.
- :: Mill wheel includes pre-mounted drive and control box.
- :: Adjustable intervals, e.g. every 30 minutes.
- :: With automatic water refilling thanks to the built-in top-up device (requires permanent water supply).
- :: 34.GM Sauna heater with front panel of massive granite stone. All made of stainless steel, 30 - 45 kg stones, or
- :: GOLIATH sauna heater, anthracite finish, 75 kg sauna stones.

# :: SAUNA CONTROL UNITS





INNOVATIVE. FUNCTIONAL. RELIABLE.



## ECON D1

- :: Electronic control unit for dry (Finnish) sauna.
- :: Affordable entry-class model with all essential control functions.
- :: Modern, slim-design housing, only 60 mm depth.
- :: Illuminated high-contrast LCD display with 12 languages menu navigation.
- :: Temperature control range 40 °C - 115 °C.
- :: Heating time up to 6 hours.
- :: Switching for cabin light, keypad lock, „Life-Guard“ function.
- :: For sauna heaters up to 9 kW (switching capacity 9 kW, **not extendable**).



## ECON H1

- :: Electronic control unit as ECON D1, but for dry and humid operation.
- :: Temperature control range:
  - in dry (Finnish) sauna mode: 40 °C - 115 °C
  - in humid sauna mode: 30 °C - 70 °C.
- :: Humidity control - proportional to time, adjustable in 10 steps.
- :: With water shortage alarm, sauna dry function (after-heating and extractor fan operation to dry sauna room after humid mode).
- :: For Bi-O sauna heaters up to 9 kW (switching capacity 9 kW, **not extendable**)



# :: SAUNA CONTROL UNITS

ECON is a versatile series of modern sauna control units featuring a large scope of functions and a contemporary, slim-shape design.

ECON control units are available in a variety of different versions, from very affordable entry-class models to advanced versions with a large scope of special functions such as remote switching or limited access mode. All ECON control units feature a modern high-contrast LCD matrix display with a comfortable menu navigation in 12 languages which makes their operation easy and convenient. They can be mounted directly on the wall surface or installed partially recessed in order to make them look even slimmer.

Thanks to the modern electronic relays ECON control units have very low noise operation. Every unit includes temperature sensor with cable.

ECON models have proven to be exceptionally reliable both in domestic and commercial operation. They are compliant with the latest safety norms in Europe and have been independently tested and approved for quality and safety.



Model	Item no.	Size (H x W x D)
ECON D1	94.6136	220 x 250 x 60 mm
ECON H1	94.6137	220 x 250 x 60 mm

# :: SAUNA CONTROL UNIT

Econ D2 and Econ H2 control units belong thanks to the optimal scope of functions, easy operation and particularly good price to value ratio to the most popular models of the entire ECON range.

All functions and parameters are shown at once on a large illuminated multi-line LCD. While adjusting one parameter all others always remain in sight. Menu navigation in 12 languages make the operation particularly comfortable and easy. In the case of a power loss all settings will remain saved for at least 24 hours.

The keypad lock functions lets Econ D2/H2 models be reliably protected against an unauthorized access. The desired temperature and heating time can be set or adjusted within a few seconds.



Model	Item no.	Size (H x W x D)
ECON D2	94.6138	220 x 250 x 60 mm
ECON H2	94.6139	220 x 250 x 60 mm





## ECON D2

- :: Electronic control unit for dry (Finnish) sauna
- :: Suitable for commercial operation.
- :: Extra-large multi-line LCD display, shows all parameters at a glance. Menu navigation in 12 languages.
- :: 24 h pre-set timer in real time, clock, screen-saver function.
- :: Switch for cabin light, „Life Guard“ function.
- :: Heating time limitation 6 h, extendable to 12 h.
- :: Switching capacity 9 kW, may be extended with an LSG device.



## ECON H2

- :: Electronic control unit basing on ECON D2 but for dry and humid sauna operation.
- :: Digital temperature control:  
40 °C - 115 °C (in dry Finnish sauna mode)  
30 °C - 70 °C (in humid sauna operation).
- :: Humidity control - proportional to time, adjustable in 10 steps.
- :: Suitable for commercial use.
- :: 24 h pre-set timer in real time, clock, screen-saver function.
- :: Heating time limitation 6 h, extendable to 12 h.
- :: Switching capacity 9 kW, may be extended with an LSG device.



## ECON D3

- :: Electronic control unit for dry (Finnish) sauna
- :: Optimal for commercial operation.
- :: Extra-large multi-line LCD display, shows all parameters at a glance. Menu navigation in 12 languages.
- :: 24 h pre-set timer in real time, clock, screen-saver function.
- :: Switch for cabin light, „Life Guard“ function.
- :: Heating time limitation 6 h, 12 h or unlimited.
- :: Supports an optional 2nd temperature sensor (bench sensor).
- :: Switching capacity 9 kW, may be extended with an LSG device.



## ECON H3

- :: Electronic control unit basing on ECON D3 but for dry and humid sauna operation. Optimal for commercial operation.
- :: Digital temperature control:  
40 °C - 115 °C (in dry Finnish sauna mode)  
30 °C - 70 °C (in humid sauna operation).
- :: Humidity control - proportional to time (10 steps) or as per relative air humidity in % with an optional humidity sensor.
- :: Sauna-dry mode (after-heating and extractor fan operation to dry sauna after humid mode).
- :: Switching capacity 9 kW, may be extended with an LSG device.



# :: SAUNA CONTROL UNITS

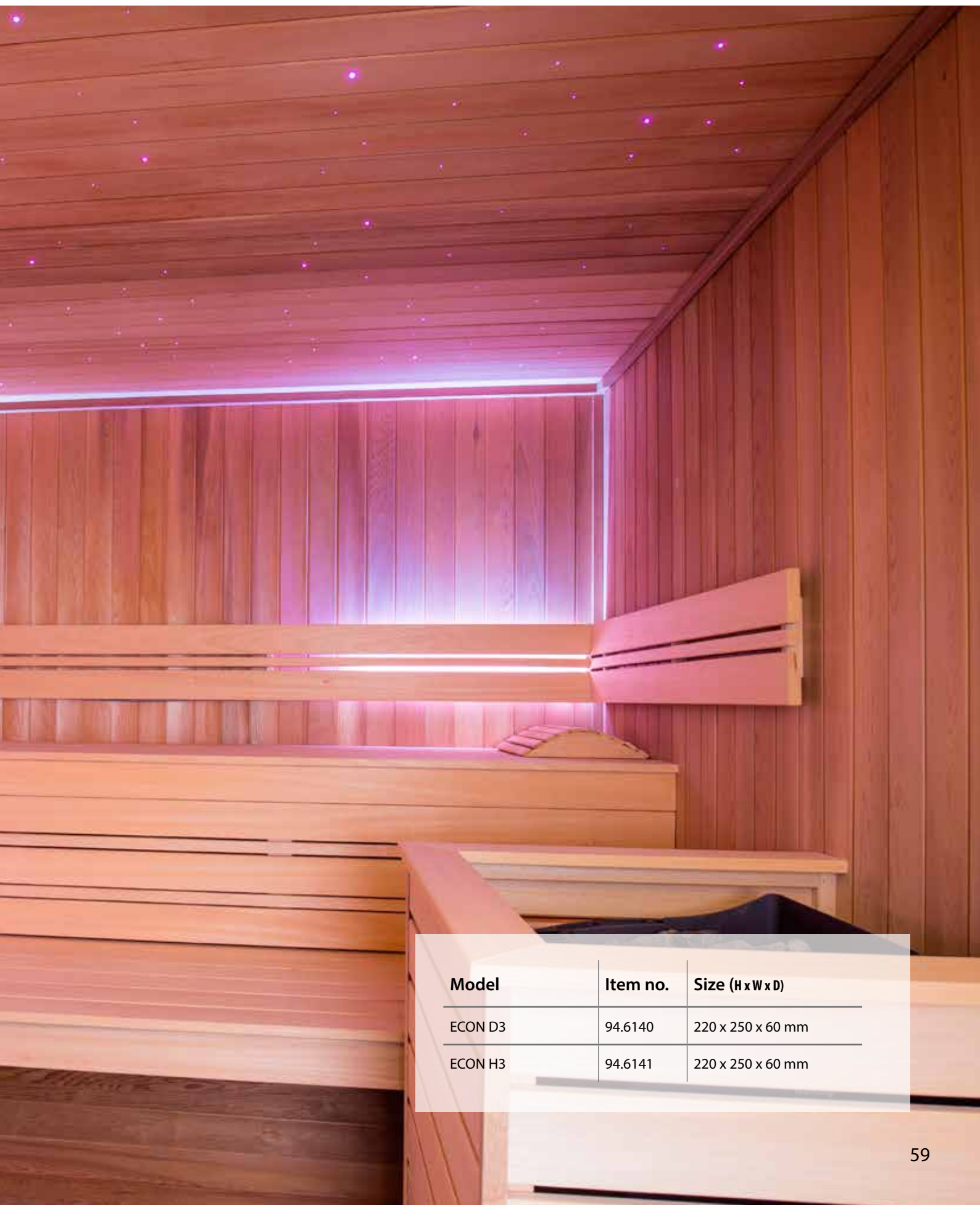

Model	Item no.	Size (H x W x D)
ECON D3	94.6140	220 x 250 x 60 mm
ECON H3	94.6141	220 x 250 x 60 mm

# :: SAUNA CONTROL UNITS

## ECON D4 / H4 - FOR DEMANDING USERS:

Econ D4 and H4 models are ideal for domestic and commercial users which need a sauna control unit combining advanced features and modern design with a particularly good price to value ratio. These models feature for instance a dimmable cabin light output with an automatic detection of inductive and capacitive loads. With an optional remote start module the sauna can be switched on or off from a remote location at a large distance. And the innovative „holiday home mode“ allows to restrict the access to the essential functions only which is particularly helpful by e.g. rented saunas or in a commercial environment.

## OPTIONS AND UPGRADES:

- :: Remote Start Module: with this module you can start your sauna from a remote location up to at least 100 m. An integrated LED lamp indicates the current operation status.
- :: Bench Sensor: improves temperature control, recommended especially by large saunas or complex layouts. Compatible with Econ D3/H3 and D4/H4 models.
- :: F2 Humidity sensor: for humidity control as per relative air humidity in a sauna. Compatible with ECON H3 and H4.

Model	Item no.	Size (H x W x D)
ECON D4	94.5842	220 x 250 x 60 mm
ECON H4	94.5843	220 x 250 x 60 mm



## ECON D4

- :: All functions like Econ D3, but additionally with:
- :: Remote switching possible (optional remote start button).
- :: Dimmable cabin light output, 10-step adjustment.
- :: Automatic detection of inductive and capacitive loads on light output (manual setting possible).
- :: Output for fan, adjustable speed (3 steps).
- :: Innovative „Holiday home mode“ - restricts access to basic functions only (on/off, temperature, light).
- :: Switching capacity 9 kW, may be extended with an LSG device.



## ECON H4

- :: Like ECON H3 model, but additionally with:
- :: Remote switching possible (optional remote start button)..
- :: Dimmable cabin light (10-step, automatic detection of inductive and capacitive loads).
- :: Output for fan, adjustable speed (3 steps).
- :: With “Holiday home mode” (restricted access).
- :: Switching capacity 9 kW, may be extended with an LSG device.



## EMOTEC D

- :: Premium class electronic control unit for very demanding domestic and commercial saunas. For dry Finnish sauna operation.
- :: With a separate slim-size display panel (can be installed up to 100 m away from the sauna). Surface or recessed mounting possible (housing included).
- :: Display panel available in anthracite or white design.
- :: TFT colour display with menu navigation in 18 languages.
- :: Innovative operation with jog-dial switch - simple, easy, intuitive.
- :: Very large scope of functions, e.g. week timer with climate management, light dimming, holiday home mode, service level, guided setup and much more.
- :: Additional options with external modules (e.g. remote control, colour light, etc.)



## EMOTEC H

- :: Like Emotec D, but with humidity control - for all EOS Bi-0 type sauna heaters.
- :: Humidity control - proportional to time (10 steps) or as per relative air humidity in % with an optional humidity sensor.
- :: Numerous comfort functions such as sauna-dry mode, adjustable after-heating temperature, fan runtime, after-heating time, smart-heat function in humid mode and much more.
- :: Guided setup, pin-code protected service level, additional innovative smart features (software updates, custom firmware, etc.).



# :: SAUNA CONTROL UNITS

## OPTIONAL MODULES:

- :: Web App Modul: allows remote sauna control from a smartphone / tablet via internet using a free EOS Sauna Control app.
- :: Coloured light module: control of almost any LED system directly from the sauna control unit.
- :: Sound module: music in your sauna. With stereo amplifier and operation directly from the sauna control unit. Music files can be streamed via Bluetooth, USB, SD card or an analogue input.

For more details please refer to page 70.

Model	Item no.	Size (HxWxD)
EMOTEC D anthracite/silver	94.5559	Display panel: 127 x 130 x 25 mm Relay box: 270 x 300 x 100 mm
EMOTEC D white/silver	94.6053	
EMOTEC H anthracite/silver	94.5560	
EMOTEC H white/silver	94.6054	

# :: SAUNA CONTROL UNITS

## EMOTOUCH II+

Luxury class control system for highest demands. Emotouch II+ stands out thanks to the unique operation principle via an innovative visual graphic interface and a large capacitive touch screen display. Sauna control has never been so easy and the scope of functions and features leaves hardly any wish unfulfilled.

### OPTIONAL MODULES:

- :: Web App Module: Allows remote control and monitoring of your sauna from a smartphone (tablet) via internet from any place in the world. Control up to 8 saunas from one device!
- :: Colour light module: For control of almost any LED light system from the sauna control unit.
- :: Sound module: Music in your sauna. With stereo amplifier and music control directly at the control unit display. Music streaming via Bluetooth, USB, SD card or an analogue input.

For more details please refer to page 70.



Model	Item no.	Size (HxWxD)
EMOTOUCH II+ Sauna Titanium	94.5561	
EMOTOUCH II+ Sauna White	94.6008	Display panel: 142 x 210 x 42 mm Relay block: 270 x 300 x 100 mm
EMOTOUCH II+ Sauna Black	94.5803	
EMOTOUCH II+ Steam Titanium	94.5951	





## EMOTOUCH II+ Sauna

- :: For dry Finnish sauna and for humid sauna operation.
- :: Great for domestic and commercial use.
- :: Large capacitive 7" touch-screen display with patented visual graphic interface.
- :: Display panel may be installed remotely up to 100 m away from sauna. 5 m connection cable included.
- :: Innovative digital type sensor. Supports bench sensor and humidity sensor.
- :: Menu navigation in 22 languages.
- :: 8 user profile for storage of personal settings. Pin code protected service level with extended settings and fine tuning.
- :: Very large scope of functions.
- :: Software updates via SD card possible.
- :: Additional options with external modules (e.g. remote control, colour light, etc.).
- :: Display panel available in 3 design: titanium, black, white.



## EMOTOUCH II+ Steam

- :: Like II+ Sauna, but designed for steam rooms.
- :: Visual graphic interface for steam room operation.
- :: Digital temperature control 30 °C - 50 °C.
- :: Special digital sensor in stainless steel housing with 5 m cable included.
- :: Display panel available in 3 design: titanium, black, white.

### **NEW - control your sauna and a steam room from one display panel!**

With the innovative „LSG Steam“ module you can control a sauna and a separate steam room independently to each other from just one display panel. With a simple swipe motion gesture you can go between sauna and steam room control interface. After connection the LSG Steam module will be detected and configured automatically, no setup needed. For every cabin you can connect separate extension modules - coloured light control, sound control, etc.



## EMOTEC LSG 09 R relay box

- :: Relay box with 9 kW switching capacity for power extension.
- :: Compact wall-mounting housing, connections on the rear side.
- :: In combination with 9 kW capable control units suitable for sauna heaters up to 18 kW power.
- :: Very low noise operation thanks to the modern electronic relays.



## LSG 18 / 18 H contactor box

- :: Contactor box for power extension.
- :: In combination with 9 kW capable control units suitable for sauna heaters up to 27 kW power.
- :: LSG 18 model: 18 kW power output.
- :: LSG 18 H: power output 18 kW + additionally 4 kW, optimal for Bi-O type sauna heaters.
- :: Cable connections from the rear or bottom side possible.
- :: Integrated fuse box (for Neozed D02 fuses).



## LSG 36 / 36 H contactor box

- :: Professional grade contactor box for power extension.
- :: In combination with 9 kW capable control units suitable for sauna heaters up to 45 kW power.
- :: LSG 36: power output 2 x 18 kW.
- :: LSG 36 H: power output 2 x 18 kW + additionally 4 kW, optimal for Bi-O type sauna heaters.
- :: Integrated fuse box (for Neozed D02 fuses).

**NOTICE: LSG 18 / 36 devices require Neozed D02 type fuse inserts. Fuse inserts are NOT included and should be specified on site as per selected heater power.**



# :: POWER EXTENSION



Model	Item no.	Switching Power	Size (H x W x D)
EMOTEC LSG 09 R	94.4998	9,0 kW	240 x 230 x 70 mm
LSG 18	94.5730	18,0 kW	270 x 300 x 100 mm
LSG 18 H	94.5731	18,0 + 4,0 kW	270 x 300 x 100 mm
LSG 36	94.4392	36,0 kW	450 x 300 x 145 mm
LSG 36 H	94.4230	36,0 + 4,0 kW	450 x 300 x 145 mm

# :: SAUNA SAFETY

## WHY S-GUARD?

Both in domestic and commercial use these days it is a common practice to switch the sauna heater either automatically or remotely. But what if you switch your sauna remotely and there is a sauna towel or a sauna bucket accidentally forgotten on the heater? How can a potential sauna fire be effectively avoided?

EOS has conducted an intensive and comprehensive research and presents an S-Guard system, an innovative safety system, which consist of the main electronic unit and two special sensors. The S-Guard functions very reliably and is able to detect already at the very early heating stage if the heater is covered or not.

## HOW S-GUARD FUNCTIONS

The patented S-Guard system should be mounted outside sauna, for instance in a plant room next to the control unit and should be connected with this control system.

Two high precision sensors PT1000 should be mounted inside sauna above the sauna heater. After installation the system has to be calibrated and will store the specific heating pattern of the installed sauna heater. Then, once the sauna is switched on, the S-Guard system will supervise the initial heating process by comparing the current heating curve with the reference curve stored in its memory. If the current curve deviates even a bit from the reference, for instance because a towel covers the heater, the S-Guard system will immediately interrupt the heating and switch off the heater. This will prevent a potential sauna fire.

The innovative S-Guard is the first system of its kind on the market and is a welcome contribution to sauna safety. Not only for commercial saunas, where an approved safety system is legally required (EN norms) by any kind of remote switching, e.g. from a remote plant room or a reception, but also in domestic saunas the S-Guard is a valuable addition for more safety in use. The new S-Guard system offers you high reliability and safety.

The operation status of the S-Guard system can be quickly checked using three LEDs and it requires only a standard power supply 230V AC

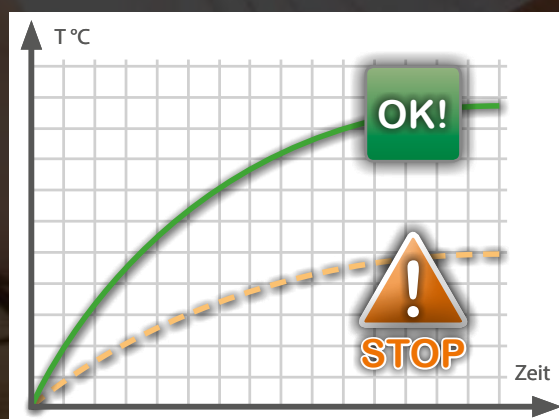
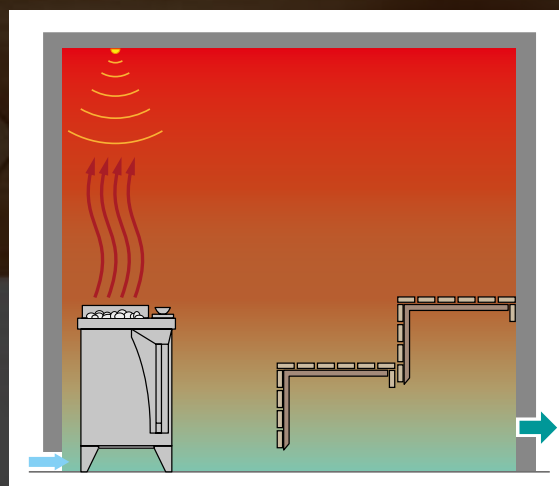

Model	Item no.
S-Guard	94.5256



Notice: We highly recommend to contact EOS already in the planning phase regarding compatibility and possible problems.



## S-Guard System

- :: Sauna heater supervision system for safety and sauna fire prevention in domestic and commercial saunas.
- :: Based on the measurement of the individual heating pattern of the sauna heater in the given sauna room.
- :: Calibration to the specific sauna heater in the specific sauna environment. Ambient air temperature may not exceed 25°C for calibration.
- :: Detects if the sauna heater is covered, e.g. by a towel, within the first 4 minutes by comparing the reference heating curve with the effective heating curve after each start.
- :: **Compatible sauna heaters (stand October 2015):**
  - Thermo-Tec
  - Bi-O Tec
  - Euro
  - P1
  - Euro-Max, Bi-O Max
  - Germanius, Bi-O Germanius
  - 34G
  - Goliath 34G2
  - Herkules series
  - Corona series
  - Mythos series.

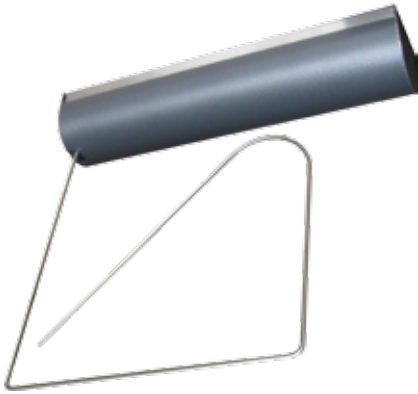

## Cover protection rail

- :: Cover protection safety rail for sauna heaters.
- :: Simple installation, may be retrofitted into an existing sauna.
- :: High reliability and safety.
- :: Available in 5 sizes for EOS sauna heaters.
- :: Approved safety solution - complies with the current European safety norm (EN 60335-2-53).



## Emergency button

- :: Special design emergency button for saunas.
- :: 2 separate circuits (1 x normally closed, 1 x normally open).
- :: Extra-long housing to easy installation in sauna cabin walls.
- :: Two circuits allow to release two separate actions once the button is pressed: e.g. switch off the heater, trigger an alarm.
- :: Visible front side - IP65 protection class.
- :: Available also in set with wooden cover plate (beech wood).



# :: SAUNA SAFETY

The cover protection rail has been developed by EOS and offers a highly reliable, safe and at the same time simple to use safety solution for sauna cabins with an automatic or remote switching. The rail is mounted directly over the heater to the sauna wall. By free standing sauna heaters it is possible to mount the rail directly on the heater (by many models).

The cover protection rail will react even by a very small pressure. If a towel or a similar object is placed on the heater the rail will bend down and will immediately interrupt the active heating or such heating may not start. After the object is removed, the rail returns to the normal position and the usual operation may be continued. This prevents that the sauna heater may be switched on in an unsafe condition and effectively minimizes the risk of a sauna fire.

In conjunction with an EOS sauna heater and control unit the cover protection rail represents a norm-compliant and approved safety solution.

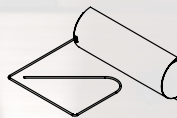

**Type 1** #944421  
HWD 140 x 328 x 328 mm

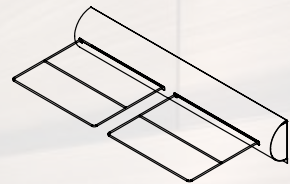

**Type 3** #944425  
HWD 140 x 728 x 322 mm

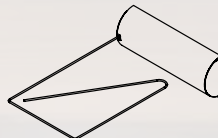

**Type 4** #944724  
HWD 140 x 328 x 482 mm

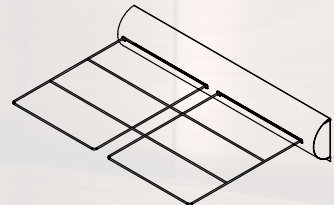

**Type 5** #944725  
HWD 140 x 728 x 482 mm

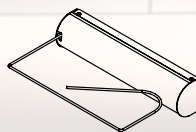

**Type 6** #945624  
HWD 140 x 328 x 222 mm

Model	Item no.	Size (HxWxD)
Cover protection rail type 1	94.4421	140 x 328 x 322 mm
Cover protection rail type 3	94.4425	140 x 728 x 322 mm
Cover protection rail type 4	94.4724	140 x 328 x 482 mm
Cover protection rail type 5	94.4725	140 x 728 x 482 mm
Cover protection rail type 6	94.5624	140 x 328 x 222 mm

# :: EXTENSION MODULES

## WEB APP MODULE FOR REMOTE SAUNA CONTROL

The innovative SBM-WCI-01 module allows to control your sauna with a smartphone or a tablet PC over the internet from any place in the world. You can check your sauna by shopping or switch it while watching TV without having to stand up from the couch. Also a quick check of the current sauna condition like its temperature or remaining heating time is easily possible.

Up to 8 users may be connected to one module or likewise from one mobile device it is possible to control up to 8 different saunas. The free EOS Sauna Control app (for Android and Apple iOS) will automatically detect the paired sauna control unit and adjust its interface for a simple and intuitive operation. Works on Emotec D/H and Emotouch II+ control units.



Model	Item no.	Size (H x W x D)
SBM-FL75 module coloured light, 75 W	94.5996	270 x 195 x 100 mm
SBM-FL150 module coloured light, 150 W	94.6007	270 x 300 x 100 mm
SBM-S sound module	94.5920	270 x 195 x 100 mm
SBM-S BT sound module with Bluetooth	94.5921	270 x 195 x 100 mm
SBM-WCI-01 web app remote control module	94.5987	60 x 18 x 90 mm





## SBM-FL75/150 coloured light control module

- :: Allows the control of almost any LED light system via the sauna control unit (e.g. LED spots, LED strips).
- :: No drivers needed, LEDs are connected directly to the module.
- :: For voltage-controlled (0 - 24 V) and current-controlled (0 - 3000 mA) LEDs.
- :: Two colour channels (RGB + white), separately switchable.
- :: Available with 75 W and 150 W output. For Emotec / EmoTouch control units.
- :: Not compatible with RGB LED strips with the common „+“ line.

## SBM-S / SBM-BT sound module

- :: The sound module allows to reproduce and control music via the sauna control unit. For Emotec / EmoTouch II+ control units.
- :: Integrated stereo amplifier 2 x 15 W, integrated MP3 player. Wall-mounting unit.
- :: Optional USB docking station for mounting in the sauna wall.
- :: Music may be retrieved via Bluetooth (BT version), USB, SD card or an analogue input.
- :: Connection to sauna control unit via sauna bus, own 230 V power supply.

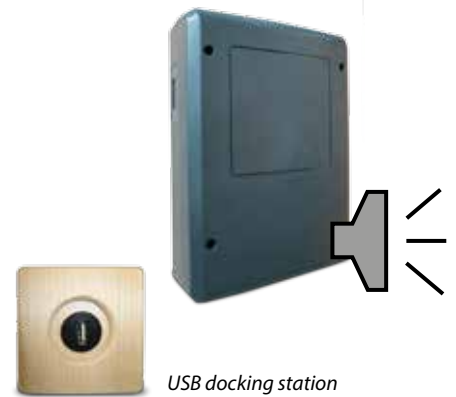

Free EOS Sauna Control app for mobile devices

## SBM-WCI-01 web app module

- :: SBM-WCI-01 module allows remote sauna control from a smartphone / tablet PC via internet from any location. Requires internet connection. For Emotec / EmoTouch II+ control units.
- :: Free EOS Sauna Control app (for Android / Apple), automatic recognition of the paired sauna control unit, self-adjusting app interface.
- :: Up to 8 users may be connected to one sauna, up to 8 saunas may be controlled from one mobile device.

## Remote start module

- :: Allows to start / stop sauna remotely from up to at least 100 m distance.
- :: Integrated LED shows the current operation status (stand-by, heating, error).
- :: Recessed installation. Connection with a 6P6C RJ12 cable (sauna bus).
- :: Elegant wooden cover panel of massive walnut wood.
- :: Compatible control unit: EmoTouch II+, Emotec D/H, Econ D4/H4.





## EMOLUX 3S

- :: LED coloured light system for ceiling installation in sauna cabins.
- :: Resistant to high sauna temperatures thanks to the special protective glass screen with wooden frame of Abachi wood.
- :: High light intensity with rich, powerful colours. Full surface illumination. Dimmable light intensity (voltage bases LEDs).
- :: Recessed installation in sauna ceiling.
- :: Three basic colours (RGB), various mixed colours possible.
- :: For control we recommend SBM-FL75 control module in conjunction with an Emotec / EmoTouch II+ control units.



## LED strips

- :: LED strips with 6-pin plug on both ends, allows to connect several strips in one chain.
- :: Rigid strip with mounting holes for quick installation.
- :: Available as RGB type and as warm white light type.
- :: Very powerful, rich colour reproduction.
- :: Three primary colours (RGB), mixed colours possible.
- :: Dimmable (24 V, voltage controlled LEDs).
- :: Various connection cables optionally available.
- :: Control e.g. with the coloured light module SBM-FL75/150



# :: COLOURED LIGHT

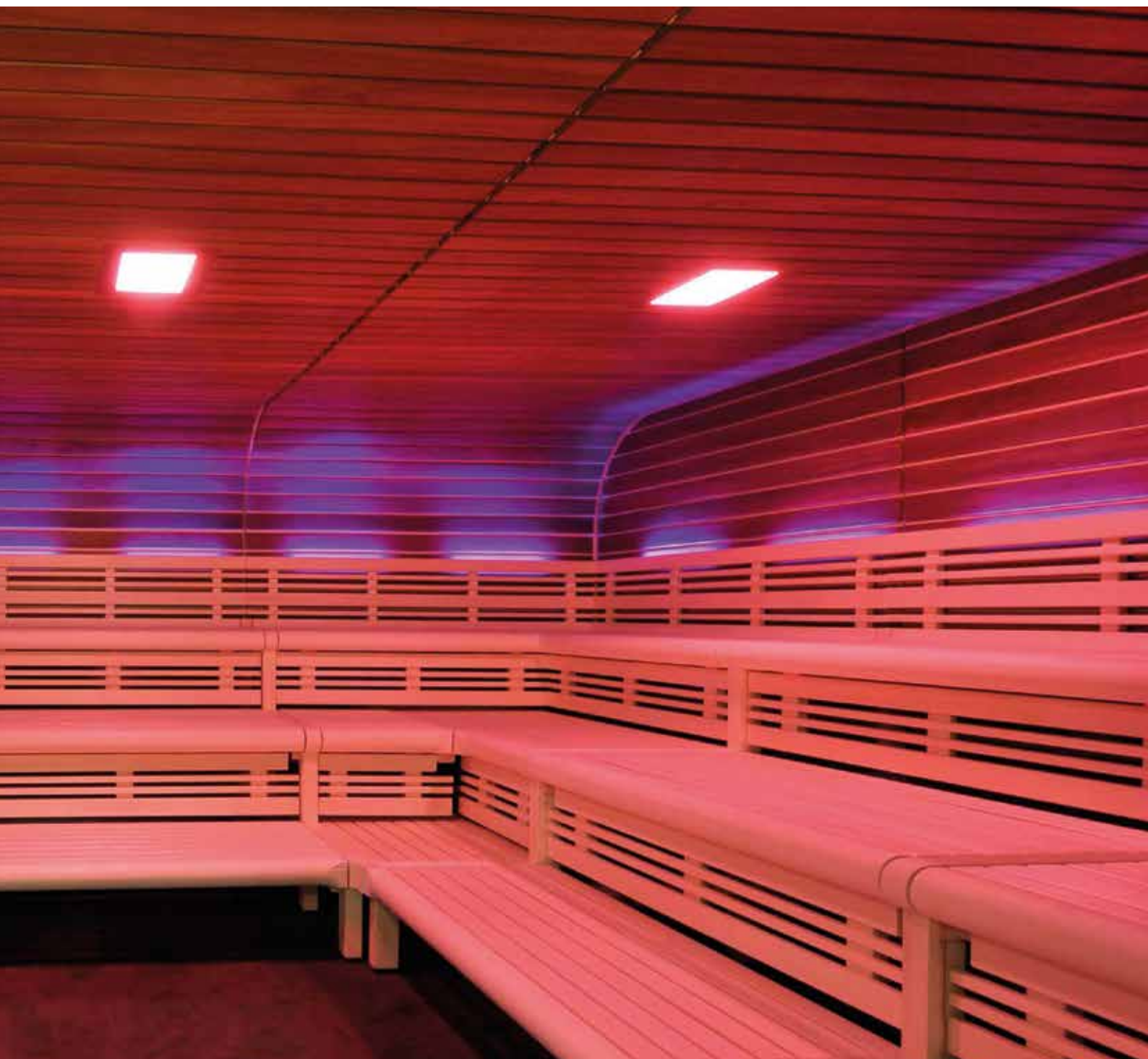

Model	Item no.	Size (H x W x D)
EMOLUX 3S	94.5995	315 x 615 x 80 mm
LED strips, warm white	94.6081	495 x 15 x 5 mm
LED strips RGB	94.6079	495 x 15 x 5 mm

# :: STEAM GENERATORS





FOR MODERN STEAM ROOMS AND HAMMAMS

- 4,5
- 6,0
- 9,0
- 12,0
- 15,0
- 18,0



## SteamTec I Classic

- :: Fully automatic steam generator for steam rooms.
- :: Optimal for intensive commercial operation.
- :: Integrated descaling and cleaning system.
- :: Stainless steel water tank. Robust aluminium chassis. Heating elements mounted on a common steel plate, can be removed for servicing.
- :: With 5 l container for cleaner, with level probe (descaling liquid not included in delivery, optional equipment).
- :: LED lamps on the front panel for operation states.
- :: Adjustable cleaning intervals (10, 20, 30 h)
- :: Without control unit. Suitable control unit - e.g. Emotouch II+ Steam.
- :: Wall-mounting device, size HWD 60 x 32 x 33 cm (4,5 - 9 kW), or 65 x 39 x 38 cm (12 - 15 kW)

- 4,5
- 6,0
- 9,0
- 12,0
- 15,0
- 18,0



## SteamTec I Premium

- :: Fully automatic steam generator for steam rooms. Proven construction based on the Steamtec I Classic model.
- :: With digital control unit - remote slim-size control panel with LED display and stainless steel front. May be installed inside steam room. Includes 7 m connection cable.
- :: Integrated essence-dosing system with peristaltic pump.
- :: Integrated controller for RGB type LED spots.
- :: Automatic descaling and cleaning - reduces the costs for servicing and maintenance. Adjustable cleaning intervals.
- :: Special features: time, essence dosing, coloured light control, cabin light, output for blower fan and extractor fan, two free volt-free outputs for other equipment (230 V 2 A).
- :: Wall-mounting device, dimensions as Steamtec I Classic.
- :: Delivery includes:
  - Steam generator, incl. brass union for steam pipe connection
  - Display panel with bottom housing and 7 m cable
  - Steam outlet 1 1/4" with brass union Ø35 mm for welding,
  - Temperature sensor with mounting kit and 7 m cable,
  - Container 5 l for descaling liquid, with level probe,
  - Water supply hose, small parts.

# :: STEAM GENERATORS

<b>Model</b>	<b>Power</b>	<b>Item no.</b>	<b>Steam output</b>
SteamTec I Classic	4,5 kW	94.4367	6 kg/h
SteamTec I Classic	6,0 kW	94.4368	8 kg/h
SteamTec I Classic	9,0 kW	94.4369	12 kg/h
SteamTec I Classic	12,0 kW	94.4556	16 kg/h
SteamTec I Classic	15,0 kW	94.4557	20 kg/h
SteamTec I Classic	18,0 kW	94.4558	24 kg/h
SteamTec I Premium	4,5 kW	94.4370	6 kg/h
SteamTec I Premium	6,0 kW	94.4371	8 kg/h
SteamTec I Premium	9,0 kW	94.4372	12 kg/h
SteamTec I Premium	12,0 kW	94.4559	16 kg/h
SteamTec I Premium	15,0 kW	94.4560	20 kg/h
SteamTec I Premium	18,0 kW	94.4561	24 kg/h

# :: STEAM GENERATORS

## STEAMTEC II - INNOVATIVE AND UNIQUE

The new Steamtec II features a completely new construction with numerous smart features. The main highlight is the innovative design of the water tank with externally placed heating elements, which are welded around the tank like a coil. They have no direct contact to water - typical problems such as scale or cracking corrosion will be therefore effectively avoided. The heating elements have now greatly longer lifetime and need no regular replacement.

An automatic descaling system will remove the scale from the water tank and drain it after use, which considerably reduces the maintenance costs. The cleaning will consider the water hardness and the evaporated water quantity.

The entire construction has been designed to last and sets standards in terms of durability and reliability even in the most intensive commercial operation.

Steamtec II stands out thanks to its numerous smart features, which make the installation and use more flexible and easy. The steam output pipe can be for instance turned around at 180° to let the steam pipeline be connected from the top. The power output can be changed on site at the push of a button in 3 kW steps, e.g. from 18 kW to 15 kW or 12 kW, which makes the planning and stock management more flexible and cost-effective.



*Heating elements are welded like a coil around the water tank and have no direct contact to water.*



*Robust construction - heavy-duty water tank and brass fittings. Designed for very intensive commercial use.*



Model	Power	Item no.	Steam output
SteamTec II Basic	6,0/9,0 kW	94.5955	8 / 12 kg/h
SteamTec II Basic	12,0/15,0/18 kW	94.5958	16 / 20 / 24 kg/h
SteamTec II Classic	6,0/9,0 kW	94.5960	8 / 12 kg/h
SteamTec II Classic	12,0/15,0/18 kW	94.5963	16 / 20 / 24 kg/h
SteamTec II Premium	6,0/9,0 kW	94.5965	8 / 12 kg/h
SteamTec II Premium	12,0/15,0/18 kW	94.5968	16 / 20 / 24 kg/h



## SteamTec II Basic



- :: High performance premium class steam generator for steam rooms.
- :: For very demanding users, ideal for intensive commercial use.
- :: New, innovative construction - heating elements placed externally outside water tank without direct contact to water.
- :: Sturdy, reinforced water tank of high grade stainless steel.
- :: Variable power output, may be set on site in 3 kW steps.
- :: Compact wall-hanging unit, extra-large Ø35 mm steam output.
- :: Automatic descaling system (chemical cleaning). 5 l container for cleaner with level probes included in delivery. Cleaner liquid - optional.
- :: Without control unit. Suitable control unit - EmoTouch II+ Steam, Econ S.
- :: Size HWD 67 x 46 x 35 cm.

## SteamTec II Classic

- :: Steam generator based on the Steamtec II Classic construction.
- :: Ideal for demanding domestic and commercial users.
- :: With control unit, remote display panel.
- :: Compact, slim-size display panel in EMOTEC design, can be installed up to 100 m away from the generator.
- :: Large colour TFT display with innovative jog-dial operation.
- :: Large scope of functions and features (light dimming, pin code protected setup level, 18 languages, week time, holiday home mode).
- :: Integrated essence dosing system with professional peristaltic pump.



## SteamTec II Premium

- :: Steam generator based on the Steamtec II Classic construction.
- :: Ideal for very demanding domestic and commercial users with particular demands for visual design and functions.
- :: With control unit basing on Emotouch II+ Steam - 7" colour touch screen display can be installed up to 100 m away from the steam generator.
- :: Innovative operation via the visual graphic interface optimized for steam room control. Full scope of functions incl. user profiles and extended setup.
- :: Firmware updates via SD-card possible.
- :: Integrated essence dosing system for 2 separate fragrance (two pumps).



## EmoTouch II+ Steam

- :: Luxury class touch screen control unit for domestic and commercial steam rooms.
- :: Visual graphic user interface designed for steam room operation.
- :: Digital temperature control. Control range 30 °C - 50 °C.
- :: Special digital sensor in stainless steel housing with 5 m cable included.
- :: Touch screen display panel available in 3 designs.
- :: Scope of functions like EmoTouch II+ Sauna model (except for remote operation).



## LSG Steam

- :: The LSG Steam module allows to control a sauna and a separate steam room from only one display panel.
- :: Automatic configuration, no manual setup needed.
- :: Includes temperature sensor for steam rooms with 5 m cable.
- :: Switching capacity 9 kW (extendable).



# :: STEAM ROOM EQUIPMENT

## **NEW - two separate cabins, only one control panel!**

With the innovative „LSG Steam“ extension module and an Emotouch II+ control unit you can control a sauna and a separate steam room from just one display panel. Go between the sauna and steam room control interface with a simple swipe motion gesture. No need to install two separate control units as before.

The LSG Steam module will be detected and configured automatically, no manual setup needed. At the same time you can of course connect additional extension modules to each cabin - for instance one coloured light control module for a sauna and one for a steam room. Ask EOS team for more details!

<b>Model</b>	<b>Item no.</b>
EMOTOUCH II+ Steam Titanium	94.5951
EMOTOUCH II+ Steam White	94.6217
EMOTOUCH II+ Steam Black	94.6216
LSG Steam	94.5950

# :: STEAM ROOM EQUIPMENT



Model	Item no.
Steam outlet	2001.4403
Temperature sensor NTC1000	2001.4405
Temperature sensor (bus type)	612400
Blower fan (with non-return valve)	2001.4401
Extractor fan	2001.4402
Disc valve for extractor fan	2001.4404
Stainless steel disc valve	2001.5210
Halogen spotlight (white light)	94.4897
RGB LED spotlight	94.4896
Warming shield "Hot Steam"	94.5769
Descaling liquid 5 l	2001.4604



## Steam outlet

- :: Made of heat-resistant, durable plastic
- :: Special steam deflecting design, holder for essences.

## Temperature sensor Steamtec

- :: Temperature sensor NTC1000 for Steamtec I.
- :: Temperature sensor (sensor sus type)- for Emotouch II+ Steam, LSG Steam control units.

Sensor (sensor bus type)



NTC1000 sensor



## Blower fan (with non-return valve)

- :: Blower fan DN 100 (80 W T50), with an external 5-step speed controller.
- :: With a non-return valve.

## Extractor fan/ Disc valve

- :: Extractor fan DN 100 (12,5 - 15 W) 230 V 50 Hz, for steam rooms.
- :: Disc valve for extractor fan (non-return valve).

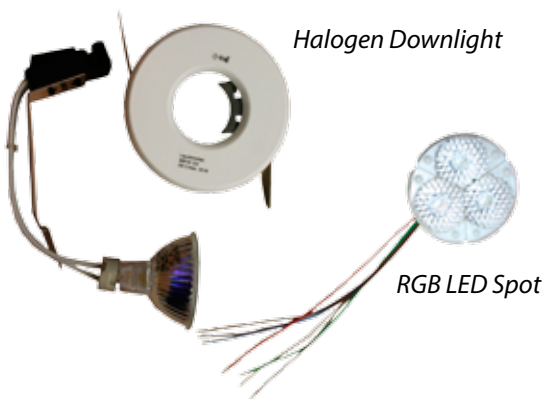

Halogen Downlight

RGB LED Spot

## Lighting / RGB lamps

- :: Halogen spotlight: recessed, IP65, with 35 W MR16/6x5,3 12 V illuminant. With white bezel and mounting fittings.
- :: RGB type LED spotlight: recessed, IP65, with RGB typ LED illuminant, 4 W / 350 mA, 6 pin. Colours: red, green, blue. White bezel.



## Descaling liquid

- :: Descaling liquid for steam generators.
- :: Formic acid solution, ready to use for Steamtec cleaning system.
- :: 5 l container. ATTENTION: dangerous goods class product.



## Steam room doors

- :: Premium class steam room doors for domestic and commercial use.
- :: Aluminium frame, 8 mm clear safety glass, magnet lock along full glass height, sealing gasket around the frame.
- :: Two designs - anodized aluminium or anthracite pearl effect powder coating. Available in 8 different sizes.
- :: Optionally available with bronzed or white satin-finished glass.
- :: Innovative threshold - special profile keeps the condensed water inside the steam room while the door is still accessible by handicapped users.
- :: Designer door handle (metal) in frame-matching finish. On request available without door handle.
- :: Highly stable and elegant hinges, cut of massive aluminium.
- :: All models have 3 hinges as standard.
- :: Doors under 1900 mm height can be delivered on request with two hinges.
- :: 57,5 mm frame thickness without hinges / 73 mm thickness with hinges.



# :: STEAM ROOM DOORS



High precision and fitting accuracy of frame parts - the frame looks as if made from one piece.

Magnet lock along the full glass height reliably holds the glass sheet. The sealing gasket around the glass may be easily replaced.



Elegant designer hinges. Cut from the massive aluminium block. Very stable and durable.

Finished to match the frame design - anodized aluminium or anthracite pearl effect powder coating.

Three hinges per frame.



Innovative design threshold, retains condensed water inside steam room while keeping the door accessible for handicapped users.

If necessary the threshold may be easily removed directly on site.

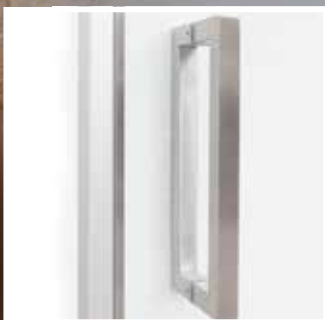

Elegant door handle in stylish straight-lined design is a perfect match to the contemporary design of modern steam rooms. The door handle is always delivered in the matching finish to the door frame.

On request the door may be delivered without the frame or with an alternative type of glass.

Model	Item no.	Frame size, H x W, mm	Doorway, H x W, mm
Type 1	94.6193	1844,5 x 789 mm	1800 x 700 mm
Type 2	94.6194	1944,5 x 889 mm	1900 x 800 mm
Type 3	94.6182	1900 x 700 mm	1855 x 611 mm
Type 4	94.6183	2000 x 800 mm	1955 x 711 mm
Type 5	94.6184	2100 x 800 mm	2055 x 711 mm
Type 6	94.6185	2100 x 900 mm	2055 x 811 mm
Type 7	94.6186	2200 x 900 mm	2155 x 811 mm
Type 8	94.6187	2094,5 x 989 mm	2050 x 900 mm

A person is relaxing in a hot tub, with their legs visible in the foreground. The background is a dark wall with two glowing blue square lights. The text is overlaid on the image.

:: INFRARED EQUIPMENT

:: ESSENCE DOSING





# :: FLAKE ICE MACHINES

EQUIPMENT FOR SPA & WELLNESS

# :: INFRARED RADIATORS



<b>Model</b>	<b>Item no.</b>	<b>Size (H x W x D)</b>
IRS 3 Ceramic	94.1878	530 x 185 x 75 mm
IRS 35 RHK	94.4305	870 x 185 x 65 mm
IRS 50 RHK	94.4306	870 x 185 x 65 mm
IRS 4 RHK with pre-mounted plug	94.2862	530 x 185 x 65 mm
IRS 4 RHK with un-mounted plug	94.4012	530 x 185 x 65 mm
Vitae 350 W	94.2865	870 x 185 x 65 mm
Vitae 500 W	94.2576	870 x 185 x 65 mm
Vitae 750 W	94.2577	870 x 185 x 65 mm

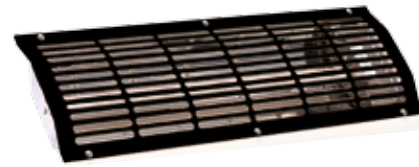

### IRS 3 Ceramic

- :: IR-radiator for IR warming cabins.
- :: With 300 W ceramic emitter, IR-C range.
- :: With reflector, metal housing, safety grill and cable.

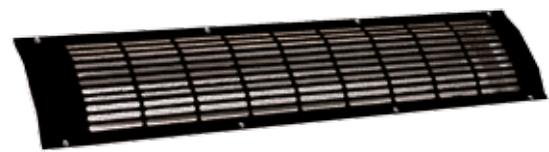

### IRS 35/IRS 50 RHK

- :: IR-radiator for IR warming cabins. IR-C range.
- :: 350 W or 500 W emitter (tube type with magnesia oxide filling)
- :: With reflector, metal housing, safety grill and cable.

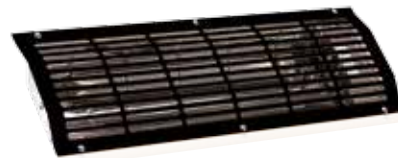

### IRS 4 RHK

- :: IR-radiator for IR warming cabins. IR-C range.
- :: 400 W emitter (tube type with magnesia oxide filling)
- :: With reflector, metal housing, safety grill and cable.

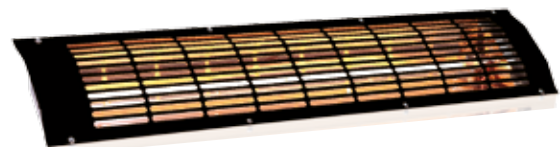

### Vitae

- :: High performance IR-radiator for IR warming cabins.
- :: Full spectre - IR-A, IR-B and IR-C range. Full power output in less than 1 sec, very high intensity, dimmable.
- :: VITAE type quartz glass emitter with 350, 500 or 750 W.
- :: With reflector, metal housing, safety grill and cable.

## Infrared heating foils

- :: IR-heating foils for infrared cabins.
- :: Available in power outputs: 90 / 275 / 350 / 450 / 550 / 650 W.
- :: Different sizes from 600 x 300 mm to 1700 x 800 mm.
- :: Concealed installation under the wooden surface.
- :: Working temperature approx. 110°C.
- :: Automatic temperature limitation at 120°C.
- :: With connection cable and on-surface high limiter.



## Corner cover

- :: Corner cover for IR radiators, with black protective flocking.
- :: Very practical by IR radiator installation in corners.
- :: Universally fits all EOS IR radiators.

## Dimmer for IR radiators

- :: Dimmer for manual adjustment of heat intensity.
- :: Particularly recommended for Vitae quartz radiators.
- :: Simple and easy adjustment of power without having to leave the cabin. Recessed installation in cabin wall.
- :: Max. power up to 1000 W.



## InfraSteam auxiliary vaporizer

- :: Compact vaporizer for domestic infrared cabins or saunas.
- :: Essence cup at the steam exit. Very easy to use, manual water filling.
- :: Built-in control unit. Very slim, place-saving design.
- :: 750 W power output, optimal for 1-2 person cabins.
- :: 230 V, with 3 m mains cord with plug.



# :: INFRARED EQUIPMENT



Model	Item no.	Size (H x W x D) / Description
IR heating foil 650 W	94.3742	Foil size: 1700 x 800 mm Heating surface: 1620 x 720 mm
IR heating foil 550 W	94.3743	Foil size: 1450 x 800 mm Heating surface: 1370 x 720 mm
IR heating foil 450 W	94.3744	Foil size: 1600 x 600 mm Heating surface: 1520 x 520 mm
IR heating foil 350 W	94.3745	Foil size: 1250 x 600 mm Heating surface: 1170 x 520 mm
IR heating foil 275 W	94.3835	Foil size: 1600 x 400 mm Heating surface: 1520 x 320 mm
IR heating foil 90 W	94.3891	Foil size: 600 x 300 mm Heating surface: 520 x 220 mm
Corner cover	94.4566	
Dimmer	94.4954	80 x 80 x 55 mm
IR plug adaptor for 4 radiators	94.4960	Connects up to 4 radiators in one line
IR plug adaptor for 6 - 9 radiators	94.4960	Connects up to 6 - 9 radiators in one line
InfraSteam vaporizer	94.4140A	750 W / 230 V

# :: CONTROL UNITS FOR INFRARED



Model	Item no.	Size (H x W x D)
Infratec Classic Without cable set	94.4388	140 x 195 x 50 mm
Infratec Classic with Pre-mounted cable set	94.4334	140 x 195 x 50 mm
ECON I1	94.5768	220 x 250 x 60 mm
Infratec Premium	94.5255	Display panel: 130 x 118 x 24 mm Relay box: 240 x 230 x 70 mm
InfraTouch I AF	94.4672	Display panel: 130 x 100 x 20 mm Relay box: 240 x 230 x 70



## Infratec Classic

- :: Electronic control unit for infrared warming cabins.
- :: Alphanumeric LCD display (time, functions, error messages).
- :: Temperature control range 30 - 70 °C.
- :: Heating time 1 - 99 min. Switch for cabin lighting (230V).
- :: Recessed installation. Available with a pre-mounted cable set or without a cable set. Temperature sensor included.
- :: 3.500 W power output, 230 V 1N AC power supply.

## ECON I1

- :: Electronic control unit for IR warming cabins. Ideal for large commercial cabins - 9 kW switching power (400V 3N AC power supply).
- :: Alphanumeric LCD display (time, functions, temperature, heating time). Menu navigation in 12 languages.
- :: Temperature control range 30 - 70 °C.
- :: Keypad lock, light switch, heating time up to 6 h, quick timer mode „Life Guard“



## Infratec Premium

- :: Electronic control unit for IR warming cabins.
- :: Compact size recessed control panel, separate relay box.
- :: Illuminated alphanumeric LCD display (time, functions, temperature, remaining time). Multi-language menu navigation.
- :: Temperature control range 30 - 70 °C.
- :: Three separate heating zones (rear and front - dimmable, feet - switchable). Light switch.
- :: Optional sensor for heating foils.
- :: 3.500 W power output, 230 V 1N AC power supply.

## InfraTouch I AF Infrared + Sauna

- :: Premium class control unit for sauna and infrared in one, with a touch screen display.
- :: 2-in-1 - controls sauna and infrared equipment in one cabin.
- :: Compact recessed touch screen display panel with aluminium frame.
- :: Easy, intuitive operation thanks to the innovative visual graphic interface.
- :: For dry Finnish sauna heaters and for Bi-O heaters with vaporizer.
- :: For all types of IR radiators and heating foils (adjustable symbols).
- :: Optional extension module for coloured light control.
- :: Pre-heating in IR mode, numerous comfort features.
- :: 3.500 W power output (extendable), 230 V 1N AC power supply.



## E-Cool flake ice machine

- :: Fully automatic luxury class flake ice machine.
- :: Compact size floor-standing machine, ready to use, no construction on site necessary. Easy to relocate.
- :: Automatic ice production, ice level sensor, very low noise operation.
- :: Up to 15 l flake ice per hour (up to 200 kg ice in 24 hours).
- :: Elegant, sleek metal housing with anthracite pearl effect finish, brushed stainless steel side panels. Designer ceramic bowl.
- :: Connections on the rear side (water supply, drain, power)
- :: 230 V 1N AC power supply.



## E-Cool Wall flake ice machine

- :: Automatic flake ice machine for concealed installation.
- :: With bottom ice chute or with side ice chute - allows flexible installation options.
- :: Fully automatic, integrated ice level sensor. Very low noise operation.
- :: Stainless steel chute (tube type) included in delivery.
- :: Up to 120 kg ice per day production capacity.
- :: Metal housing with anthracite finish, connection on the rear side (water inlet for ice production, water drain (melting water), Water inlet & drain for cooling, mains).
- :: 230 V 1N AC power supply.





# :: FLAKE ICE MACHINES

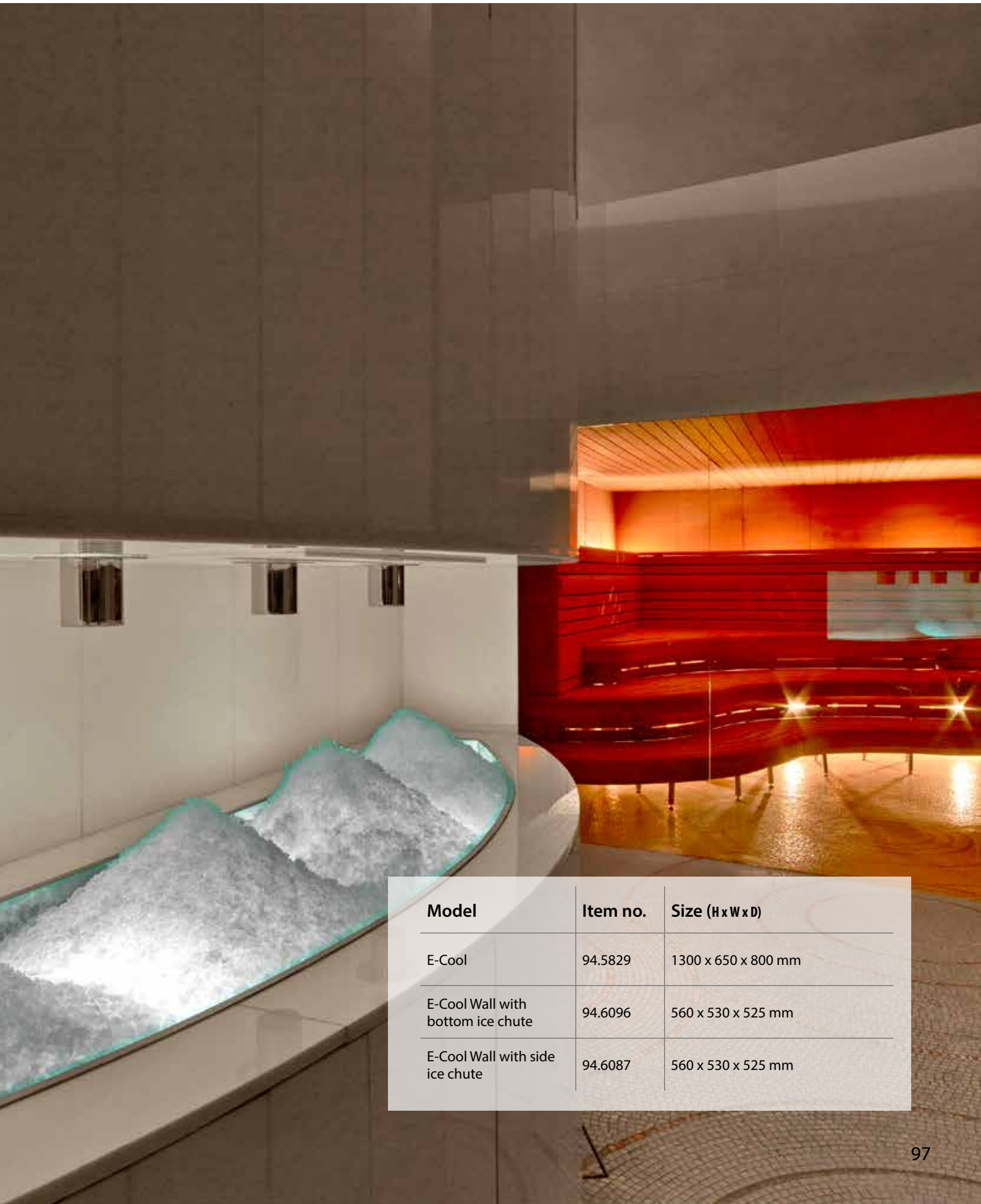

Model	Item no.	Size (H x W x D)
E-Cool	94.5829	1300 x 650 x 800 mm
E-Cool Wall with bottom ice chute	94.6096	560 x 530 x 525 mm
E-Cool Wall with side ice chute	94.6087	560 x 530 x 525 mm

# :: INFRARED & TANNING SYSTEMS



Model	Item no.
Infrasky 3000 IR RAL 9022 silver grey	94.4307
Infrasky 3000 IR RAL 9011 black	94.4315
Sunsky 400 RAL 9022 silver grey	95.3853
Sunsky 400 RAL 9011 black	95.4135
Sunsky 400 RAL 9016 white	95.5599
Sunsky 800 RAL 9022 silver grey	95.3812
Sunsky 800 RAL 9011 black	95.4381
Sunsky 800 RAL 9016 white	95.5585



## InfraSky 3000 IR system

- :: Designer ceiling-mounted infrared heating system for relaxation.
- :: For domestic and commercial operation.
- :: Perfect for relaxation zones, e.g. mounting over lounge chairs.
- :: Thanks to the ceiling-mounting provides full freedom of movement, does not block floor space.
- :: Provides comforting, cozy warmth - ideal for relaxation and rest.
- :: 6 x high performance 500 W Vitae emitters.
- :: Stylish, sleek housing, available in various finishes.
- :: Requires an external control unit (e.g. SunTec).

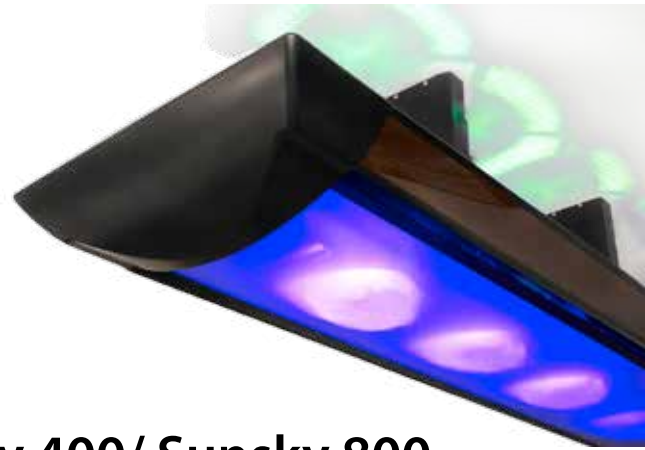

## Sunsky 400/ Sunsky 800

- :: Luxury class designer soft-tanning system for ceiling mounting.
- :: Suitable for domestic and intensive commercial use.
- :: Thanks to the ceiling-mounting provides full freedom of movement, does not block floor space.
- :: Special UV-filters provide soft-tanning and allow long, relaxing tanning times - perfect for relaxation and rest.
- :: 4 x 400 W high-pressure tanners (Sunsky 400) or 4 x 800 W high-pressure tanners (Sunsky 800).
- :: Requires an external control unit (e.g. Suntec).

## AromaTec

- :: Essence dosing and automatic water splash system for saunas.
- :: Available with dosing for 1, 2 or 3 fragrances.
- :: Completely pre-mounted on a robust metal panel.
- :: With electronic control unit, dosing pump(s) and 1 l container(s) for fragrances.
- :: 3,2" colour touch screen display for easy and convenient operation.
- :: Operation via the built-in control unit or an external push-button. Cycles, quantity and intensity adjustable. Week timer, password protection, log file.
- :: Automatic delay during sauna heat-up time.



## Duft-Tec Solo

- :: Essence dosing system for steam rooms.
- :: Integrated controller. Very simple and easy to use.
- :: Peristaltic pump with dosing intensity adjustment via interval setting.
- :: Dosing time adjustable (inside housing)
- :: Operation only by active steam production.

## Duft-Tec Quattro W

- :: Dosing system for steam rooms.
- :: For 4 fragrances (4 separate dosing lines, 4 pumps).
- :: 4 peristaltic pumps SA-type with dosing tubes 3,2 x 1,6 V with tube holder 4x1 mm and suction tube (PE 0,8 m), with UNPL control unit.
- :: Adjustable intervals and dosing intensity. Pre-mounted on PE board for quick installation and connection. 230 V 1N power supply



## Duft-Tec Quattro T

- :: Dosing system for steam rooms.
- :: For 4 fragrances (4 separate dosing lines, 4 pumps).
- :: Advanced microprocessor-based control unit, 6 time programs (8 - 20 minutes), 6 dosing quantities per fragrance (0 - 4 ml per injection), 5 status LED lamps.
- :: 4 peristaltic pumps SA type with dosing tubes 3,2 x 1,6 V and tube holder 4x1 mm and suction tube (PE 0,8 m).

# :: ESSENCE DOSING SYSTEMS



Model	Item no.	Size (H x W x D)
AromaTec 1 essence	94.5188	440 x 410 x 170 mm
AromaTec 2 essences	94.5189	650 x 500 x 170 mm
AromaTec 3 essences	94.5190	750 x 560 x 170 mm
Duft-Tec Solo	94.5261	120 x 80 x 90 mm
Duft-Tec Quattro W	94.5262	500 x 600 x 170 mm
Duft-Tec Quattro T	94.5263	500 x 600 x 170 mm

# :: SALT INHALATION SYSTEMS

Model	Item no.
Duft-Tec dosing set DD	94.5267
Duft-Tec dosing valve (injector)	94.5268
Console for canisters up to 10 l	94.5269
Steam outlet LD	94.5270
Button plate 4 fold (not illuminated) for Duft-Tec Quattro T, with 5 m cable	94.5271
Button plate 4 fold (ring illumination) for Duft-Tec Quattro T, with 5 m cable	94.5109
Bottom housing for recessed mounting, for 4-fold plate	94.5272
Wall-through connector for Aromatec models, stainless steel	94.5192
Water sprinkler for Aromatec models, stainless steel	94.9191
Sol-Tec SL	94.5264
Sol-Tec V2	94.5265
Salt solution for Sol-Tec 6 x 1 l (boxed) with 6 bags (ca. 5% brine) à 1 l, incl. disinfecting tabs	94.5273
Salt solution for Sol-Tec 6 x 5 l (boxed) with 6 bags (ca. 5% brine) à 5 l, incl. disinfecting tabs	94.5274

## Duft-Tec/Aromatec accessories

- :: Duft-Tec dosing set DD: dosing valve VA 3/8" - 4x1, 3 m dosing tube PTFE 4x1.
- :: Duft-Tec dosing valve: VA steel 3/8" - 4x1.
- :: Console for canisters up to 10 l. For various dosing systems.
- :: Steam outlet LD, V4A stainless steel mixing pipe, connection for steam + air.
- :: Button plate 4 fold (no illumination) for Duft-Tec Quattro T dosing system.
- :: Button plate 4 fold (ring illumination) for Duft-Tec Quattro T dosing system.
- :: Bottom housing for button plate recessed mounting, black plastic.
- :: Wall-through connector for Aromatec dosing systems.
- :: Water sprinkler for Aromatec dosing systems.



## Sol-Tec SL salt nebulizer

- :: Salt nebulizer for inhalation in dry rooms like **saunas** and **salt grottos**.
- :: New generation system with 3,2" colour touch-screen display control unit, numerous comfort features (week timer, password protection ...)
- :: Peristaltic pump with speed control for adjustable dosing quantity, diaphragm compressor, disinfecting set.
- :: Console VA for 5 l salt solution bag, high grade stainless steel 2-way injector with bezel and wall-through connector.
- :: Completely pre-mounted on robust metal plate for wall-mounting.
- :: Optional: salt solution in 1 l or 5 l plastic bags.

## Sol-Tec V2 salt nebulizer

- :: Salt nebulizer for inhalation in **steam rooms**.
- :: Dosing capacity up to 100 ml/min in continuous operation.
- :: With top quality diaphragm pump, separate for low-noise operation.
- :: New generation 3,2" touch-screen control panel with numerous functions.
- :: Stainless steel injector with bezel and wall-through connector, 5 m dosing tube PTFE 4x1.
- :: Disinfecting set, console VA for 5 l salt solution bags.
- :: Optional: salt solution in 1 l or 5 l plastic bags.



# :: SAUNA ACCESSORIES







ENHANCE YOUR SAUNA EXPERIENCE

# :: SAUNA ACCESSORIES

Model	Item no.
Multicup	94.2534
Multicup with herbs strainer	94.5494
"Sauna Flower" evaporation jar	94.5240
Salt glue, 1 kg pack, for salt bricks and tiles	94.5510
Salt rocks, 1 kg pack, for Multicup	94.2630
Salt tile, 200 x 100 x 25 mm, 20 pcs / box	94.5433
Salt tile, 200 x 200 x 25 mm, 20 pcs / box	94.5430
Salt brick, 200 x 100 x 50 mm, front side raw finish	94.5432
Salt bricks, 200 x 100 x 50 mm, all sides straight cut	94.5426
Wall panel with Himalaya salt bricks, Abachi wood frame	94.5578
Sauna bath robe, size S	94.4360
Sauna bath robe, size M	94.4361
Sauna bath robe, size L	94.4362
Sauna bath robe, size XL	94.4363
Sauna bath robe, size XXL	94.4364
Sauna towel	94.4359



## Multicup bowl

- :: Multicup - practical wall-hanging bowl for more fun in your sauna.
- :: May be used for Himalaya salt, brine, herbs, oils. Diameter 16 cm, approx. 0,6 l volume.
- :: High grade stainless steel, suspension and wall-mounting.
- :: Delivery includes 1 kg original Himalaya salt rocks.
- :: Also available with an integrated herbs strainer.

## Sauna Flower evaporation jar

- :: Ceramic jar with an adjustable dosing valve, for mounting to the sauna wall over the sauna heater. Creates a fountain effect by evaporation.
- :: Complete set with ceramic jar, valve, suspension and small parts.



## Himalaya salt

- :: Himalaya salt for a wide variety of wellness applications.
- :: Originates from ancient dried seas of the Permian period.
- :: 1 kg packing, optimal for instance for Multicup.

## Himalaya salt bricks and tiles

- :: Bricks cut from natural Himalaya rock salt, available in two versions - straight cut on all sides and with raw front side. 20 x 10 x 5 cm.
- :: Alternatively available as tiles - 20 x 20 x 2,5 cm or 20 x 10 x 2,5 cm.
- :: For installation we recommend special salt glue (in 1 kg packs).



## Himalaya salt wall panel

- :: Wall panel with Himalaya salt bricks 1080 x 285 x 40 mm.
- :: Filled with straight cut bricks 200x100x50 mm.
- :: For wall mounting installation on suitable surfaces.

## Saun bath robe and towels

- :: Sauna bath robe, with pocket and belt.
- :: Heavy top quality 100% cotton.
- :: With embroidery "emotion of sauna", white. Washable at 60°C.
- :: Sauna towel, premium quality 100% cotton.
- :: With embroidery "emotion of sauna", white, washable at 60°C.





## Sauna lamp

- :: Sauna lamp with curved wooden shade 205 x 270 mm, dazzle-free, with splash-protected and heat resistant (T 150 °C) oval lamp.
- :: With oval shape lamp, IP54 class, die-cast aluminium base with matt glass globe and ceramic socket E27, without illuminant.
- :: Alternatively available also without a wooden shade.
- :: Special bulb, mini-size, E27, 40 W, 300°C proof, optionally available.



## Thermometer/ Hygrometer

- :: Sauna thermometer, round, wall-mounting, Ø 100 mm.
- :: Measuring range 0 - 120 °C.
- :: Sauna hygrometer, round, wall-mounting, Ø 100 mm.
- :: Measuring range 0 - 100% relative air humidity.
- :: „Made in Germany“ quality.

## Combi thermo-/hygrometer

- :: Combi thermo-/hygrometer Ø 100 mm or Ø 160 mm.
- :: For temperature and air humidity measurement.
- :: With highlighted „optimal zones“ for sauna climate.
- :: „Made in Germany“ quality.



## Sand timer

- :: Classic sauna sand time, wood
- :: Contrast sand filling for easy reading
- :: 15 min. runtime

## Combi thermo/hygrometer

- :: Sauna thermometer and hygrometer mounted in a stylish glass frame with wooden enclosure.
- :: Range 0 - 120 °C / 0 - 100 % rel. air humidity.
- :: Size 180 x 245 mm. Instrument diameter Ø 100 mm.
- :: „Made in Germany“ quality.



# :: SAUNA ACCESSORIES

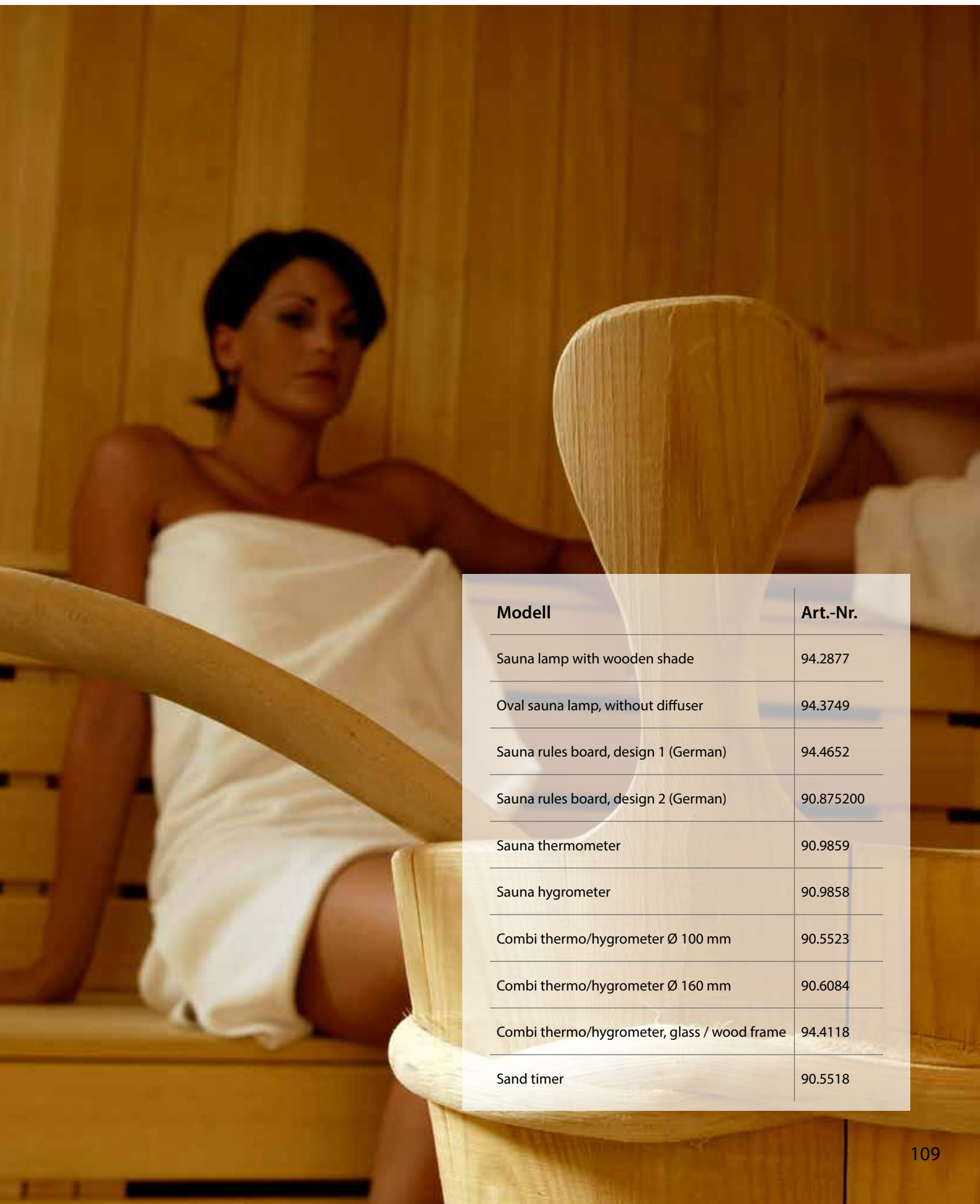

Modell	Art.-Nr.
Sauna lamp with wooden shade	94.2877
Oval sauna lamp, without diffuser	94.3749
Sauna rules board, design 1 (German)	94.4652
Sauna rules board, design 2 (German)	90.875200
Sauna thermometer	90.9859
Sauna hygrometer	90.9858
Combi thermo/hygrometer Ø 100 mm	90.5523
Combi thermo/hygrometer Ø 160 mm	90.6084
Combi thermo/hygrometer, glass / wood frame	94.4118
Sand timer	90.5518

# :: SAUNA ACCESSORIES

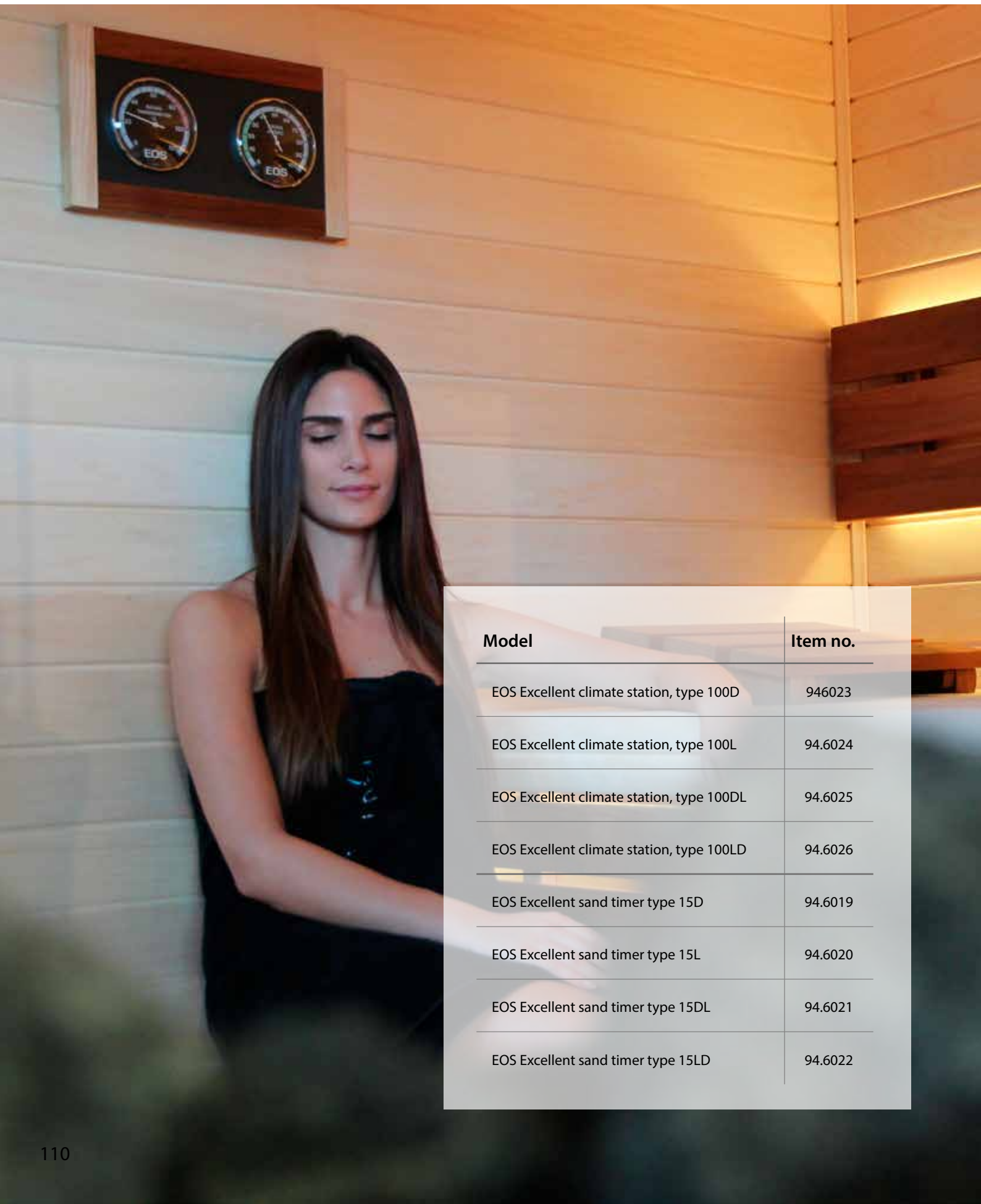

Model	Item no.
EOS Excellent climate station, type 100D	946023
EOS Excellent climate station, type 100L	94.6024
EOS Excellent climate station, type 100DL	94.6025
EOS Excellent climate station, type 100LD	94.6026
EOS Excellent sand timer type 15D	94.6019
EOS Excellent sand timer type 15L	94.6020
EOS Excellent sand timer type 15DL	94.6021
EOS Excellent sand timer type 15LD	94.6022



## EOS Excellent climate station

- :: Exclusive combination of thermometer and hygrometer.
- :: Round instruments in a metal plate with anthracite pearl-effect finish and an exclusive frame cut of massive walnut, acer or walnut/acer combinations.
- :: Ø 100 mm thermometer and hygrometer, range 0 - 120 °C / 0 - 100% rel. air humidity. Size 180 x 245 mm.
- :: Available in 4 design versions with walnut, acer or walnut / acer frame:
  - Typ 100D - walnut frame
  - Typ 100L - acer frame
  - Typ 100 DL - walnut vertical, acer horizontal
  - Typ 100 LD - acer vertical, walnut horizontal

## EOS Excellent sand timer

- :: Exclusive sand timer for Sauna in stylish, cubistic design. With a high contrast sand filling.
- :: Hand-cut from a massive walnut or acer wood.
- :: With an innovative automatic fixation in vertical position thanks to the hidden magnet.
- :: Available in 4 design versions with walnut, acer or walnut / acer frame:
  - Typ 15D - walnut
  - Typ 15L - acer
  - Typ 15 DL - walnut front, acer base
  - Typ 15 LD - acer front, walnut base





## Sauna set N I and N II

- :: Set N I, 6 parts: sauna bucket 5 l , PVC liner, ladle, sand timer, combi thermo/hygrometer Ø 100 mm , sauna rules board (German). Gift box.
- :: Set N II, 5 parts: sauna bucket 5 l , PVC bucket liner, ladle, sand timer, combi thermo/hygrometer Ø 100 mm. Gift box.

## Sauna set Stainless Steel

- :: Sauna bucket 4,5 l, stainless steel with wooden handle, stainless steel ladle with wooden handle.



## Drench bucket

- :: Sauna drench bucket with permanent water supply, volume 4,5 - 7,5 l adjustable thanks to the built-in floater valve.
- :: Type 1 - with U-shape wall-mounting bracket
- :: Type 2 - wall-mounting on a metal bar
- :: Type 3 - ceiling-mounted on a chain
- :: Type 4 - as type 1, but the bucket made of stainless steel.



## Ergonomic sauna backrest

- :: Ergonomically shaped backrest, poplar.
- :: Size HWD 520 x 400 x 70 mm



## Sauna evaporation stone

- :: Evaporation stone with 4 holes for water, holds up to 60 ml.
- :: Ideal to be placed between the sauna stones for a longer water evaporation.

## Sauna ventilation fan

- :: Ventilation fan, good for saunas up to 16 m<sup>3</sup>, IP55 class, capacity: 160 cbm/h, with bearing.
- :: For larger saunas rooms several fans may be used in parallel connection.
- :: Allowed ambient temperature range: -10°C to +70 °C.





# :: SAUNA ACCESSORIES



## REFRESHING!

Cool thing - a drench bucket is a great way to cool yourself after a hot sauna bath!

Model	Item no.
Sauna lamp with shade	94.2877
Oval sauna lamp (without shade and bulb)	94.3749
Sauna rules board, type 1	94.4652
Sauna rules board, type 2	90.875200
Sauna thermometer	90.9859
Sauna hygrometer	90.9858
Combi thermo-/hygrometer Ø 100 mm	90.5523
Combi thermo-/hygrometer Ø 160 mm	90.6084
Combi thermo-/hygrometer in glass and wood frame	94.4118
Sand timer	90.5518

# :: SAUNA ACCESSORIES

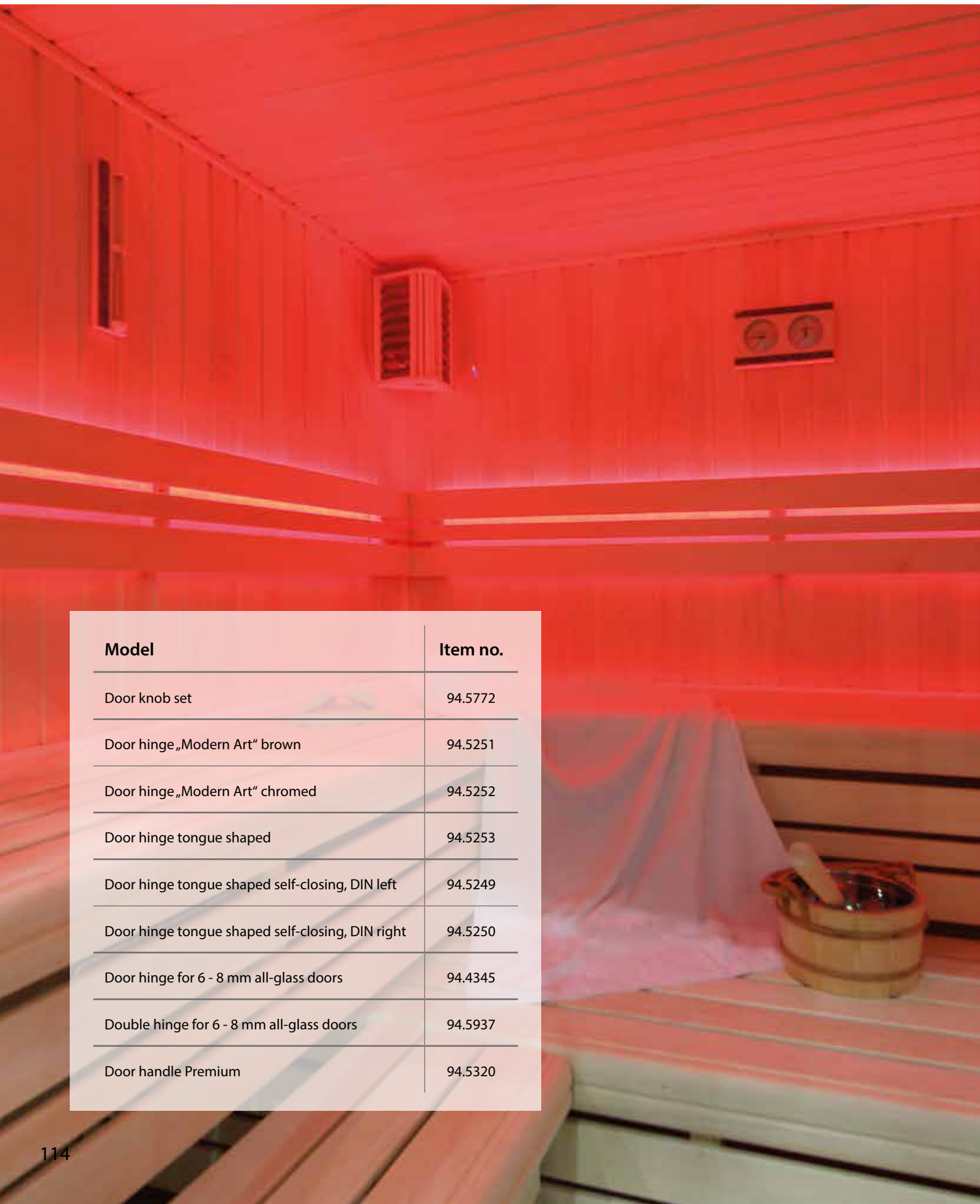

Model	Item no.
Door knob set	94.5772
Door hinge „Modern Art“ brown	94.5251
Door hinge „Modern Art“ chromed	94.5252
Door hinge tongue shaped	94.5253
Door hinge tongue shaped self-closing, DIN left	94.5249
Door hinge tongue shaped self-closing, DIN right	94.5250
Door hinge for 6 - 8 mm all-glass doors	94.4345
Double hinge for 6 - 8 mm all-glass doors	94.5937
Door handle Premium	94.5320

## Door hinge **Modern Art**

- :: Glass door hinge Modern Art, threaded drill-in pins for door rebate, for domestic saunas. Notice: flushed with door frame, for drilled holes 1 x 20 mm.
- :: Max load: 20 kg/hinge
- :: Rebate depth: milled into frame - 20 mm / screw on surface - 17 mm.

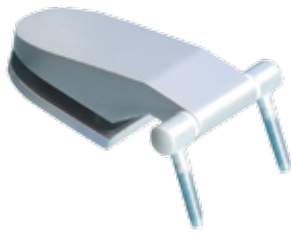
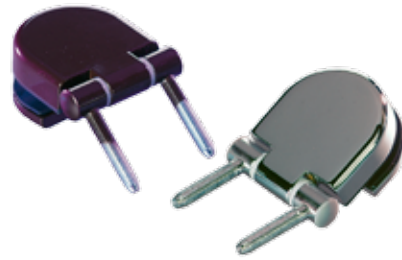

## Door hinge **Tongue shape**

- :: Tongue shape door hinge for domestic and commercial saunas.
- :: Fastening into rebate: 2 threaded drill-in pins M8x40 left/right for internal doors, bore holes 2x 20 mm (template available on request).
- :: Max load: 30 kg/hinge

## Door hinge **Tongue shape self-closing**

- :: Self-closing tongue-shape glass door hinge, screw on hinge for door rebate, for internal doors in domestic and commercial facilities.
- :: Bore holes 2 x 20 mm, Max load: 30 kg/hinge.
- :: Rebate depth: milled into frame 23 mm/ screw on 20 mm, 1 protective plastic sleeve for glass bore holes. Matt chrome finish.

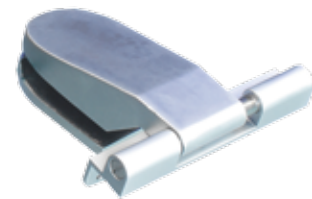

## Door hinge for glass doors

- :: Door hinge for 6 - 8mm glass doors, aluminium zinc alloy.
- :: Max load: 28 kg/hinge.

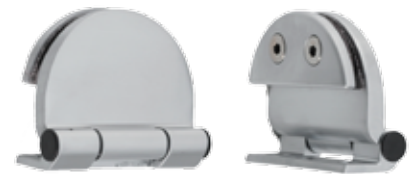

## Double hinge for glass doors

- :: Door hinge for 6 - 8mm glass doors, opening angle 180°, aluminium zinc alloy.
- :: Max load: 28 kg/piece.

## Door handle **Premium**

- :: Premium door handle set for glass doors.
- :: Wood inside, metal outside. With mounting parts.
- :: Drilling distance 200 mm, M6 thread.



## Door knob set

- :: Door knob for glass doors 6 - 10 mm.
- :: Frosted glass knob on the outer side.
- :: Wooden knob on the inner side.



## Sauna door Premium

- :: All-glass door, 8 mm safety glass, incl. hinges and sealing gasket, premium door handle (wood/metal), magnet door lock.
- :: Clear glass, glass sheet W x H 625 x 1844 mm
- :: Frame size W x H 715 x 1934 mm



## Door magnet lock

- :: U-shape clip for glass doors 6 mm or 8 mm.
- :: Door magnet 95 N or 150 N.



## Sauna door Basic

- :: All-glass door, 6 mm safety glass, incl. hinges and sealing gasket, door knob and magnet lock.
- :: Glass - clear or bronzed.
- :: Glass sheet W x H 625 x 1844 mm
- :: Frame size W x H 715 x 1934 mm



## Door roller catch

- :: For all-glass doors.
- :: Approx. 60 N power, adjustable.
- :: Suitable for long-term temperature 120°C.
- :: Very reliable and durable.

## Silicone cable

- :: Premium quality cable with heat-resistant silicone coating.
- :: Ideal for sauna & steam equipment connection.
- :: Available in various types for connection of heaters, control units, sensors, lighting and other equipment.
- :: In standard 2 or 5 m cuts, custom length available on request.



## Sauna stones

- :: Classic olivine diabase stones for sauna.
- :: Average size approx. 50 - 80 mm.
- :: For all EOS sauna heaters,

# :: SAUNA ACCESSORIES

Model	Length	Item no.
Roller catch for glass doors, 60 N		94.5771
U-shaped metal clip for 6 mm glass		94.4120
U-shaped metal clip for 8 mm glass		94.4126
Door magnet lock 95 N		94.4124
Door magnet lock 150 N		94.4125
Sauna door Basic, clear		94.4119
Sauna door Basi, bronzed		94.4127
Saunatür Premium, clear		94.4128
Silicone cable 3 x 1,5 mm <sup>2</sup>	5 m	94.3737
Silicone cable 5 x 1,5 mm <sup>2</sup>	2 m	94.2440
	5 m	94.2872
Silicone cable 5 x 2,5 mm <sup>2</sup>	2 m	94.2437
	5 m	94.2871
Silicone cable 5 x 4 mm <sup>2</sup>	5 m	94.2870
Silicone cable 5 x 6 mm <sup>2</sup>	5 m	94.2869
Silicone cable 2 x 0,5 mm <sup>2</sup> rot	5 m	94.2866
Silicone cable 2 x 0,5 mm <sup>2</sup> weiß	5 m	94.2867
Silicone cable 3 x 0,5 mm <sup>2</sup> rot	5 m	94.2868
Sauna stones 15 kg		94.4149
Sauna stones 20 kg		94.1879
Sauna stones 25 kg		90.8573

# :: IMPORTANT NOTES

## SAUNA CONTROL UNITS - FUNCTIONS AND FEATURES

	Dimensions HWD, mm	electronic temperature control	Pre-set timer 0-24 h	Heating time limitation, hours	Cabin light control	Cabin light output dimmable	Display of time / pre-set timer 24 h	Temperature control range, dry sauna, °C	Temperature control range, humid mode, °C	LCD multi-functional display (illuminated)	Colour TFT display	Colour touchscreen display	Fan control	Speed control for fan output	Support for the 2nd temp. sensor	Support for the optional humidity sensor	Sauna dry program	Data retention after power loss (24 h)	Power extension 18/27/36 kW with LSG box	Optional coloured light control	For dry & humid sauna operation	Remote switching	Max switching capacity, kW	
EMOTEC D	display panel: 127 x 130 x 25 relay block: 270 x 300 x 100	■	■	6/12/∞	■	■	■	30-115		■		■	■	■	■			■	■	■		■	9	
EMOTEC H	display panel: 141 x 201	■	■	6/12/∞	■	■	■	30-115	30-70	■		■	■	■	■	■	■	■	■	■	■	■	9	
EmoTouch II+	130 x 100 x 20	■	■	6/12/∞	■	■	■	30-115	30-70		■	■	■	■	■	■	■	■	■	■	■	■	9	
InfraTouch	220 x 250 x 60	■	■	6/12/∞	■	■	■	70-110	30-70			■	■	■			■	■	■	■	■	■	3,3	
Econ D1		■		6	■		■	40-115		■								■					9	
Econ H1		■		6	■		■	40-115	30-70	■								■	■			■	9	
Econ D2		■	■	6/12	■		■	40-115		■									■	■				9
Econ H2		■	■	6/12	■		■	40-115	30-70	■								■	■	■		■	9	
Econ D3		■	■	6/12/∞	■		■	40-115		■					■				■	■				9
Econ H3		■	■	6/12/∞	■		■	40-115	30-70	■					■	■	■	■	■	■		■		9
Econ D4		■	■	6/12/∞	■	■	■	40-115		■			■	■	■	■	■	■	■	■			■	9
Econ H4		■	■	6/12/∞	■	■	■	40-115	30-70	■			■	■	■	■	■	■	■	■		■	■	9
EMOTEC <sup>®</sup> L 09		240 x 230 x 70	Relay box with switching capacity 9 kW																				9	
LSG 18	270 x 300 x 100	Contactor box with switching capacity 18 kW																				18		
LSG 18 H		Contactor box as LSG 18, but with an extra 4 kW output for vaporizer																				18		
LSG 36	450 x 300 x 142	Contactor box with switching capacity 36 kW																				36		
LSG 36 H		Contactor box as LSG 36, but with an extra 4 kW output for vaporizer																				36		

## HEATER POWER SELECTION AND CONNECTIONS

Heating power kW	Cabin size in m <sup>3</sup> (based on recommendations of RAL for indoor saunas)														Min. cable cross section in mm <sup>2</sup>		
	3-5	4-6	6-8	7-10	9-14	14-18	18-25	24-30	24-34	35-40	40-50	50-65	65-75	Connection 400 V 3N AC	Connection 230 V AC	Fuse protection A	
3,0	■														3 x 1,5 <sup>2</sup>	1 x 16	
4,5		■												5 x 2,5 <sup>2</sup>		3 x 16	
6,0			■														
7,5				■													
9,0					■								5 x 4 <sup>2</sup>		3 x 25		
12,0						■											
15,0							■										
18,0								■					5 x 6 <sup>2</sup>		3 x 35		
21,0									■								
24,0										■							
27,0											■		5 x 10 <sup>2</sup>		3 x 50		
30,0												■					
36,0																min. 5 x 10 <sup>2</sup>	



**EOS Saunatechnik GmbH**  
Schneiderstriesch 1  
35759 Driedorf, Germany  
Tel. +49 (0)2775 82-0  
Fax +49 (0)2775 82-431  
E-Mail: [info@eos-sauna.de](mailto:info@eos-sauna.de)  
Internet: [www.eos-sauna.de](http://www.eos-sauna.de)