



BASIC-LINE

Solid plastic cable carriers with fixed chain widths

- Economically priced solutions for standard applications
- Types with fixed or openable brackets
- Many types available immediately ex-stock world wide



MONO

Cable carriers with simple design for standard applications

page 60



QuickTrax

Compact and cost-effective cable carriers in two-component technology

page 74



UNIFLEX *Advanced*

Light, quiet all-rounder with wide range of applications

page 82



UNIFLEX

Proven cable carrier with many opening and cover variants

page 96



TKP35

Robust all-rounder with variable subdivision

page 110

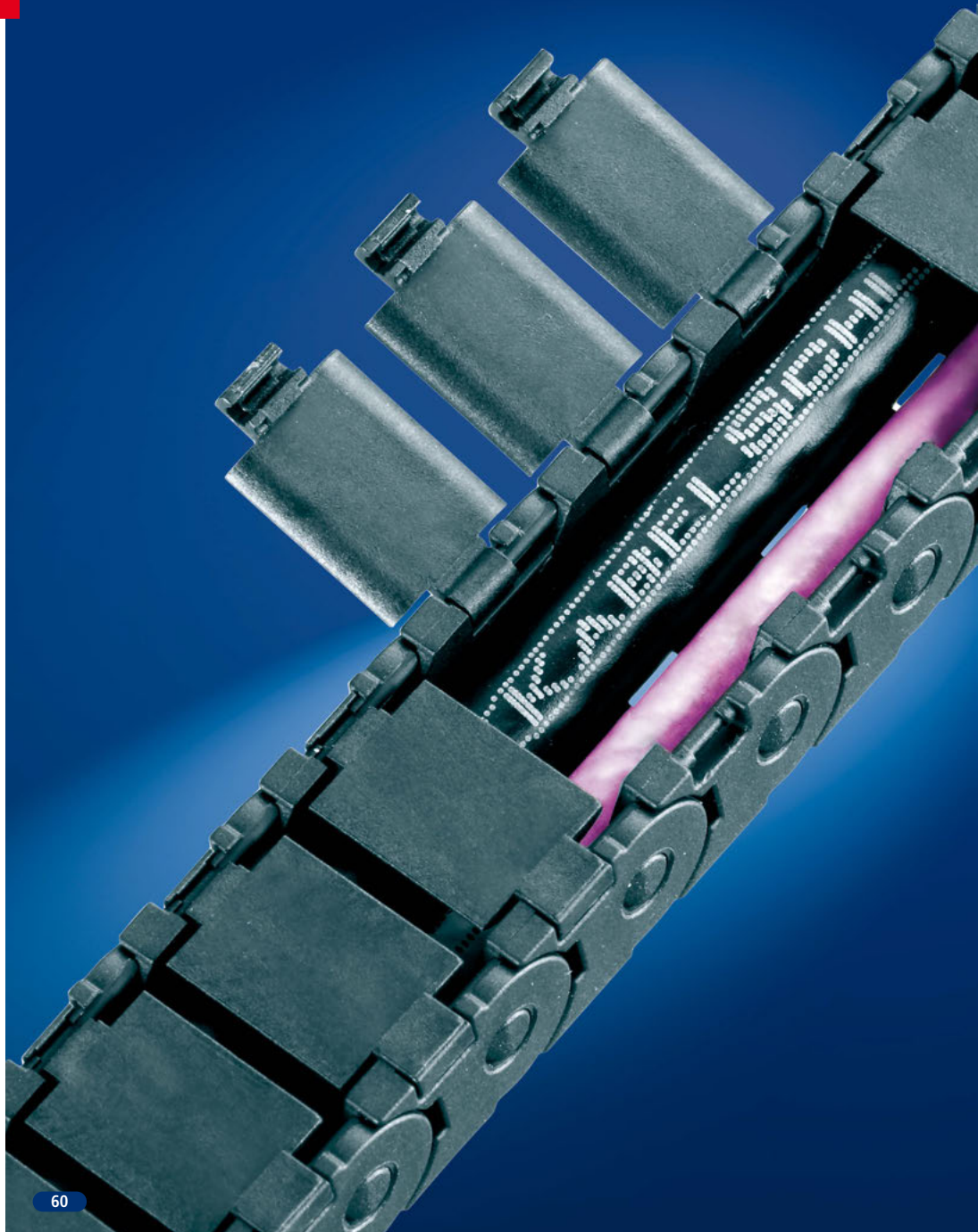

MONO

Cable carriers with simple design for standard applications*

- Cost-effective cable carrier
- Simple and quick assembly
- Almost all types available immediately ex stock all around the world
- TÜV design approved in accordance with 2PFg 1036/10.97



NOTE:
UNIFLEX Advanced
 replaces **MONO 0450/0625**
 + improved design
 + more cost effective
 > from page 12

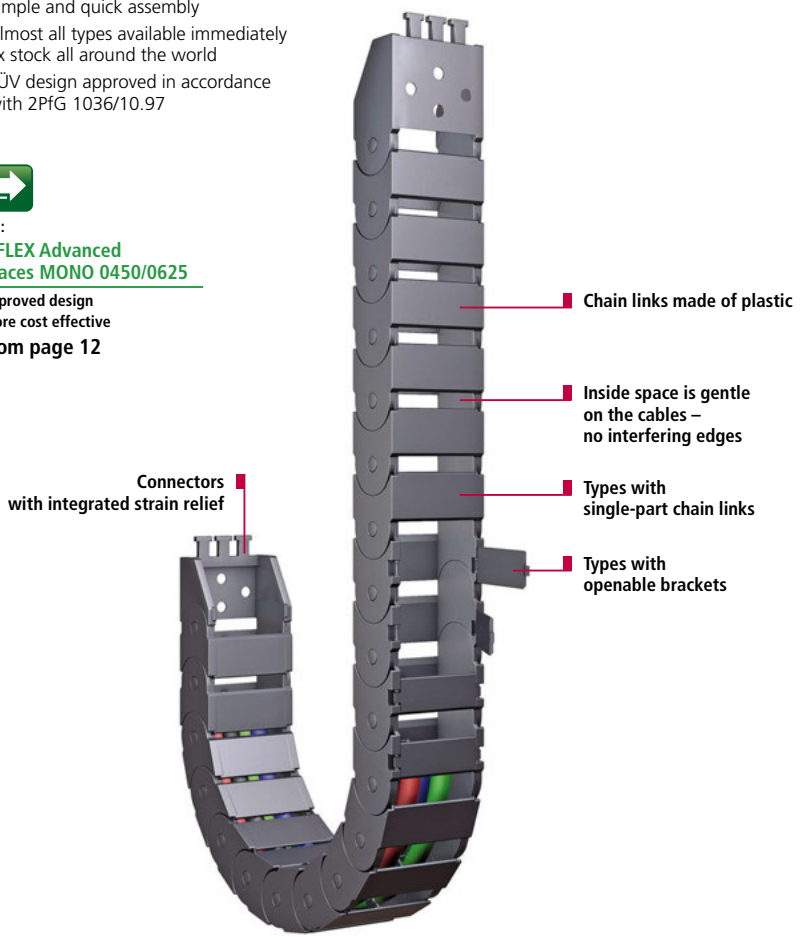

Inside heights



Inside widths



kabelschlepp.de

Fon: +49 2762 4003-0

OnlineEngineer.de
 Online-KABELSCHLEPP-Experte
 Cable Carrier Configuration



Small types for restricted installation conditions

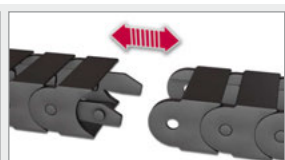

Fast shortening/extending due to simple connection of the chain links



Different connection options by simply changing the connectors

Subject to change.

* Some features can be different for certain types for design reasons. Our specialists are happy to advise you.

Overview MONO

Types 0130, 0180 with hinged, openable brackets

Inside heights



Inside widths



kabelschlepp.de

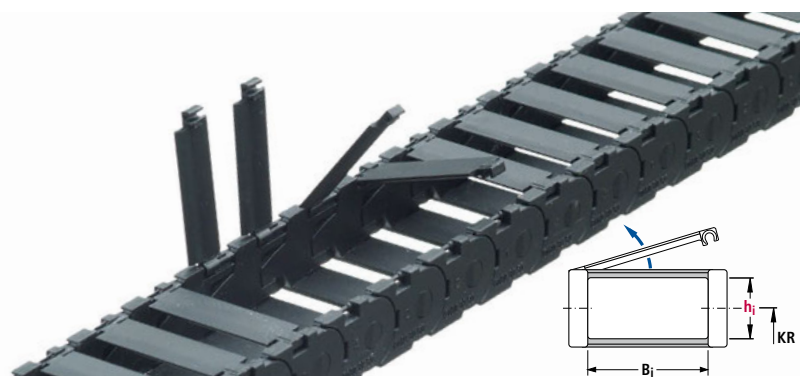

Type	hi	Bi	Maximum travel length in m	Dynamics of unsupported arrangement		Page
				Travel speed v _{max} in m/s	Travel acceleration a _{max} in m/s ²	
0130	10	6-40	40	10	50	64
0180	15	10-40	70	10	50	66

Dimensions in mm

Fon: +49 2762 4003-0

Types 0132, 0202, 0182 with fixed brackets

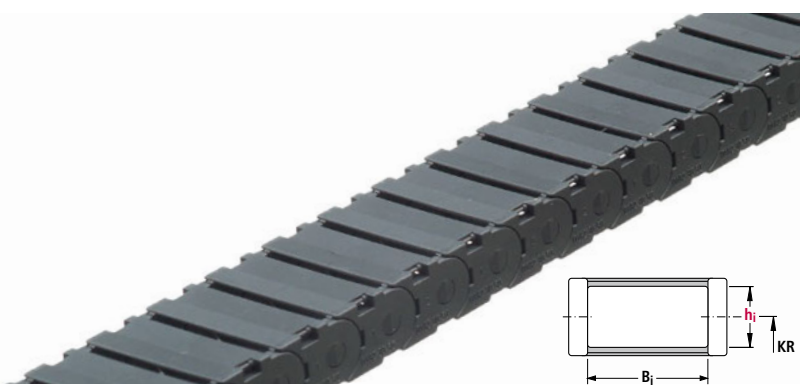

Type	hi	Bi	Maximum travel length in m	Dynamics of unsupported arrangement		Page
				Travel speed v _{max} in m/s	Travel acceleration a _{max} in m/s ²	
0132	10	6-40	40	10	50	64
0182	15	10-40	70	10	50	66
0202	11	6-20	70	10	50	68

Dimensions in mm

Use our free project planning service.

Overview MONO

Type 0320 with fixed brackets



Inside heights



Inside widths



Type	h _i	B _i	Maximum travel length in m	Dynamics of unsupported arrangement		Page
				Travel speed v _{max} in m/s	Travel acceleration a _{max} in m/s ²	
0320	19	13-37	80	10	50	70

Dimensions in mm

kabelschlepp.de



NOTE:

UNIFLEX Advanced replaces MONO 0450/0625

- + improved design
- + more cost effective
- > from page 12

Font: +49 2762 4003-0

OnlineEngineer.de
TSUBAKI KABELSCHLEPP
 Cable Chain Configuration

Types 0132 and 0130

Inside height



Inside widths



Type 0132

Inside/Outside: Not to be opened

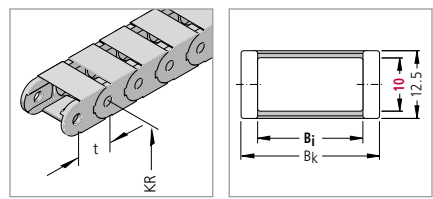

Type 0130

Outside: Hinged, openable brackets

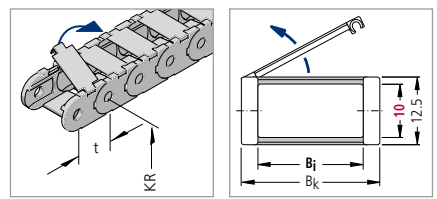

Dimensions and intrinsic chain weight

Type	h _i mm	B _i mm	B _k mm	Intrinsic chain weight kg/m
0132.06	10	6	12	0.13
0132.10	10	10	16	0.14
0132.15	10	15	21	0.15
0132.20	10	20	26	0.16
0132.30*	10	30	36	0.18
0132.40	10	40	46	0.20

* on request

Type	h _i mm	B _i mm	B _k mm	Intrinsic chain weight kg/m
0130.06	10	6	12	0.13
0130.10	10	10	16	0.14
0130.15	10	15	21	0.15
0130.20	10	20	26	0.16
0130.30*	10	30	36	0.18
0130.40	10	40	46	0.20

* on request

Bend radius and pitch

Types 0132 and 0130

Bend radii KR mm		
20	28	37

Pitch t = 13.0 mm

Load diagram

for unsupported length L_f depending on the additional load

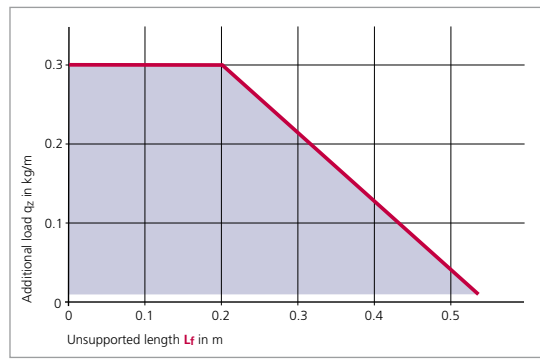

Unsupported length L_f

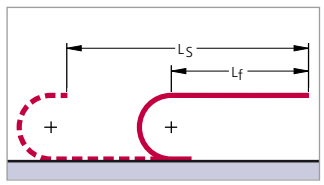

In the case of longer travel lengths, sag of the cable carriers is technically permissible depending on the application.

In a gliding arrangement, even longer travel lengths are possible (see page 375).

We are at your service to advise on these applications.

Example of ordering

Cable carrier: **0130** - **10** - **28** - **390** Connection: **FA/MA**

Type: Inside width B_i in mm Bend radius KR in mm Chain length L_k in mm (without connection) Connection Fixed point/Driver

kabelschlepp.de

Fon: +49 2762 4003-0

Use our free project planning service.

Types 0132 and 0130

Connection dimensions

Plastic connectors with integrated strain relief

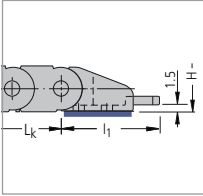

Short connectors without strain relief are also available for restricted installation conditions. Please contact us.

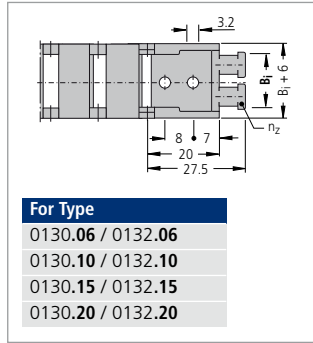

For Type
0130.06 / 0132.06
0130.10 / 0132.10
0130.15 / 0132.15
0130.20 / 0132.20

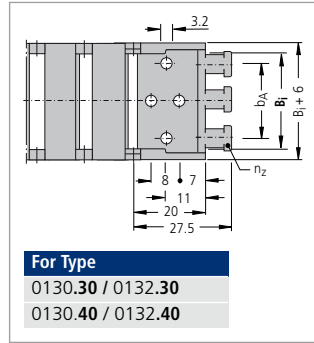

For Type
0130.30 / 0132.30
0130.40 / 0132.40

Type	B _i mm	B _k mm	b _A mm	n _Z
0130.06 / 0132.06	6	12	–	1
0130.10 / 0132.10	10	16	–	1
0130.15 / 0132.15	15	21	–	2
0130.20 / 0132.20	20	26	–	2
0130.30 / 0132.30	30	36	22	3
0130.40 / 0132.40	40	46	32	4

The dimensions of the fixed point and driver connections are identical.

Inside height



Inside widths



kabelschlepp.de

Fon: +49 2762 4003-0

Connection variants

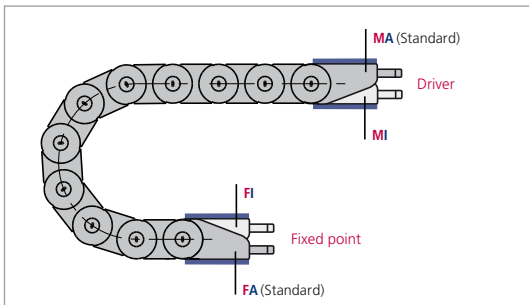

Connection point

- M – Driver
- F – Fixed point

Connection type

- A – Threaded joint outside (standard)
- I – Threaded joint inside

In the standard version, the connectors are mounted with the threaded joint outwards (FA/MA).

When ordering please specify the desired connection type (see ordering key on page 414).

The connection type can subsequently be altered simply by varying the connectors.

Types 0182 and 0180

Inside height



Inside widths



Type 0182

Inside/Outside: Not to be opened

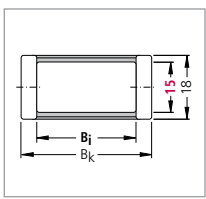
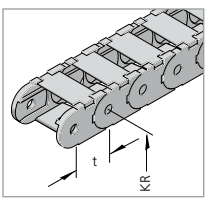

Type 0180

Outside: Hinged, openable brackets

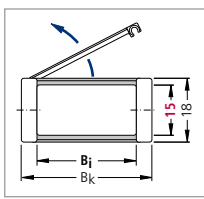
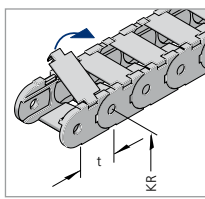

Dimensions and intrinsic chain weight

Type	h _i mm	B _i mm	B _k mm	Intrinsic chain weight kg/m
0182.10	15	10	18	0.23
0182.15	15	15	23	0.24
0182.20	15	20	28	0.25
0182.30	15	30	38	0.28
0182.40	15	40	48	0.30

Type	h _i mm	B _i mm	B _k mm	Intrinsic chain weight kg/m
0180.10	15	10	18	0.23
0180.15	15	15	23	0.24
0180.20	15	20	28	0.25
0180.30	15	30	38	0.28
0180.40	15	40	48	0.30

kabelschlepp.de

Bend radius and pitch

Types 0182 and 0180

Bend radii KR mm		
28	37	50

Pitch t = 18.0 mm

Load diagram

for unsupported length L_f depending on the additional load

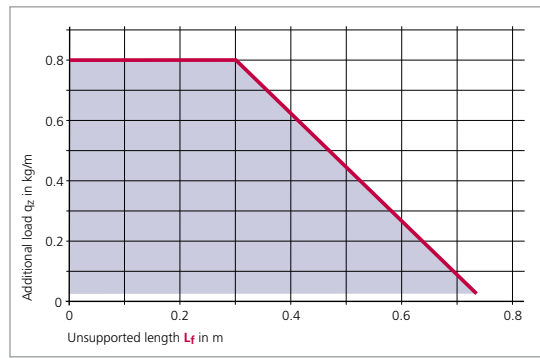

Unsupported length L_f

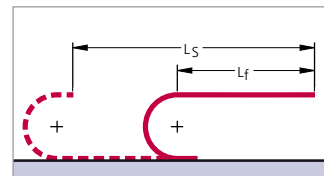

In the case of longer travel lengths, sag of the cable carriers is technically permissible depending on the application.

In a gliding arrangement, even longer travel lengths are possible (see page 375).

We are at your service to advise on these applications.

Example of ordering

Cable carrier	0180	-	30	-	37	-	720	Connection	FA/MA
Type	Inside width B _i in mm		Bend radius KR in mm		Chain length L _k in mm (without connection)		Connection Fixed point/Driver		

Use our free project planning service.

Fon: +49 2762 4003-0

Types 0182 and 0180

Connection dimensions

Plastic connectors with integrated strain relief

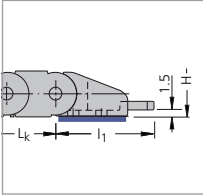

Short connectors without strain relief are also available for restricted installation conditions. Please contact us.

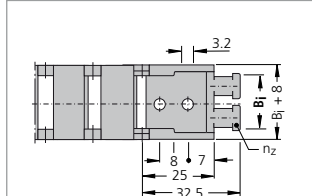

For Type

0180.10 / 0182.10
0180.15 / 0182.15
0180.20 / 0182.20

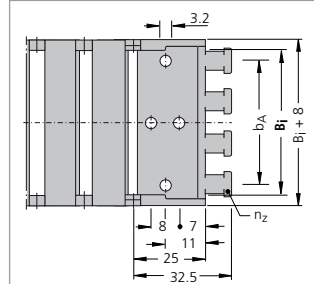

For Type

0180.30 / 0182.30
0180.40 / 0182.40

Type	B _i mm	B _k mm	b _A mm	n _Z
0180.10 / 0182.10	10	18	–	1
0180.15 / 0182.15	15	23	–	2
0180.20 / 0182.20	20	28	–	2
0180.30 / 0182.30	30	38	22	3
0180.40 / 0182.40	40	48	32	4

The dimensions of the fixed point and driver connections are identical.

Inside height

15

Inside widths

10
40

kabelschlepp.de

Fon: +49 2762 4003-0

Connection variants

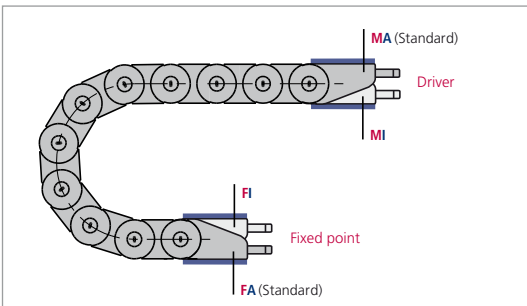

Connection point

M – Driver
F – Fixed point

Connection type

A – Threaded joint outside (standard)
I – Threaded joint inside

In the standard version, the connectors are mounted with the threaded joint outwards (FA/MA).

When ordering please specify the desired connection type (see ordering key on page 414).

The connection type can subsequently be altered simply by varying the connectors.

Type 0202

Inside/Outside: Not to be opened

Inside height



Inside widths

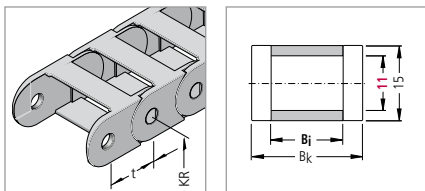

Dimensions and intrinsic chain weight

Type	h_i mm	B_i mm	B_k mm	Intrinsic chain weight kg/m
0202.06	11	6	13	0.14
0202.10	11	10	17	0.15
0202.15	11	15	22	0.16
0202.20	11	20	27	0.17

Bend radius and pitch

Bend radii KR mm			
18	28	38	50

Pitch $t = 20.0$ mm

kabelschlepp.de

Fon: +49 2762 4003-0

Use our free project planning service.

Load diagram

for unsupported length L_f depending on the additional load

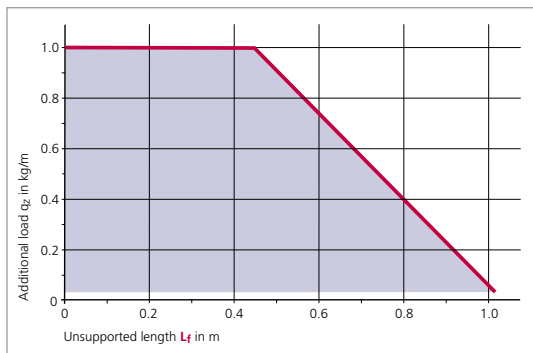

Unsupported length L_f

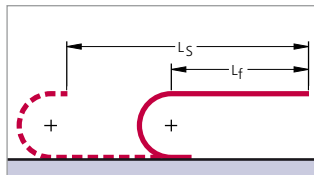

In the case of longer travel lengths, sag of the cable carriers is technically permissible depending on the application.

In a gliding arrangement, even longer travel lengths are possible (see page 375).

We are at your service to advise on these applications.

Example of ordering

Cable carrier				Connection
0202	10	28	460	FA/MA
Type	Inside width B_i in mm	Bend radius KR in mm	Chain length L_k in mm (without connection)	Connection Fixed point/Driver

Type 0202

Connection dimensions

Plastic connectors
with integrated strain relief

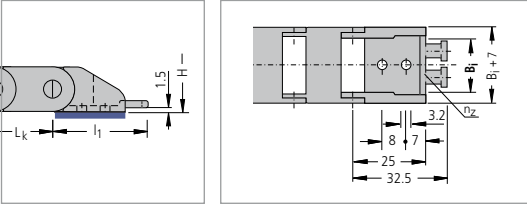

Type	B _i mm	B _k mm	n _Z
0202.06	6	13	1
0202.10	10	17	1
0202.15	15	22	2
0202.20	20	27	2

The dimensions of the fixed point and driver connections are identical.

Connection variants

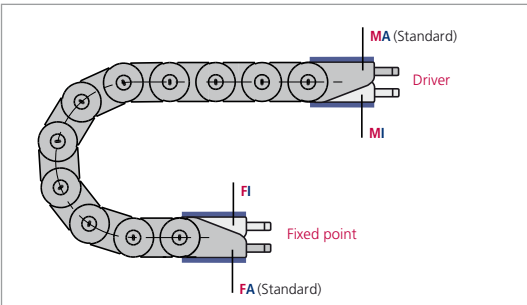

Connection point

- M** – Driver
- F** – Fixed point

Connection type

- A** – Threaded joint outside (standard)
- I** – Threaded joint inside

In the standard version, the connectors are mounted with the threaded joint outwards (**FA/MA**).

When ordering please specify the desired connection type (see ordering key on page 414).

The connection type can subsequently be altered simply by varying the connectors.

Inside height



Inside widths



kabelschlepp.de

Fon: +49 2762 4003-0

OnlineEngineer.de
Hersteller-Kunden-Service
 Cable Chain Configuration

Type 0320

Inside/Outside: Not to be opened

Inside height



Inside widths

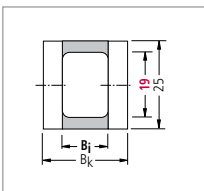
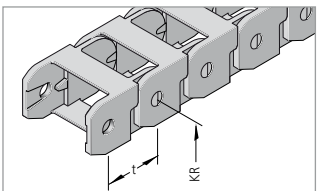

Type 0320.20 / .30

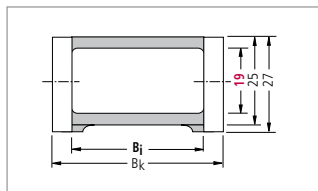

Type 0320 / .42 / .52 / .62 – with glide runners

Dimensions and intrinsic chain weight

Type 0320.20 / .30

Type	h _i mm	B _i mm	B _k mm	Intrinsic chain weight kg/m
0320.20	19	13	24	0.32
0320.30	19	19	30	0.35

Type 0320 / .42 / .52 / .62

Type	h _i mm	B _i mm	B _k mm	Intrinsic chain weight kg/m
0320.42	19	24	35	0.39
0320.52	19	29	40	0.44
0320.62	19	37	48	0.47

Bend radius and pitch

Type 0320.20 / .30

Bend radii KR mm		
37	47	77

Pitch t = 32.0 mm

Type 0320 / .42 / .52 / .62

Bend radii KR mm			
37	47	77	100

Pitch t = 32.0 mm

Load diagram

for unsupported length L_f depending on the additional load

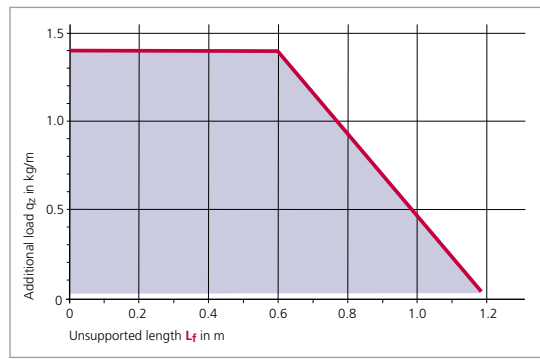

Unsupported length L_f

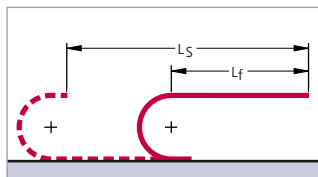

In the case of longer travel lengths, sag of the cable carriers is technically permissible depending on the application.

In a gliding arrangement, even longer travel lengths are possible (see page 375).

We are at your service to advise on these applications.

Example of ordering

Cable carrier	0320.42	-	77	-	800	Connection	FA/MA
Chain type	Bend radius KR in mm	Chain length L _k in mm (without connection)	Connection Fixed point/Driver				

kabelschlepp.de

Fon: +49 2762 4003-0

Use our free project planning service.

Type 0320

Connection dimensions

Plastic connectors
with integrated strain relief

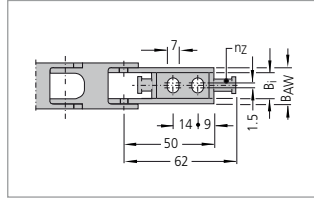
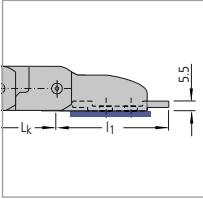

Type 0320.20

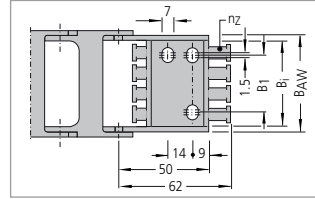

Type 0320.42 / .52 / .62

Inside height

19

Inside widths

13

37

Connection dimensions at fixed point connection:

$$B_{AW} = B_i + 5.5$$

$$B_1 = B_i - 12.5$$

Connection dimensions at driver connection:

$$B_{AW} = B_i + 11$$

$$B_1 = B_i - 10.5$$

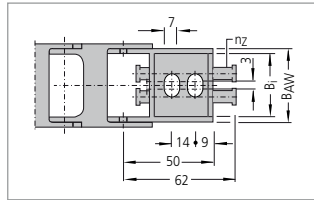

Type 0320.30

Type	B _i mm	B _k mm	n _z
0320.20	13	24	1
0320.30	19	30	2
0320.42	24	35	2
0320.52	29	40	3
0320.62	37	48	4

kabelschlepp.de

Connection variants

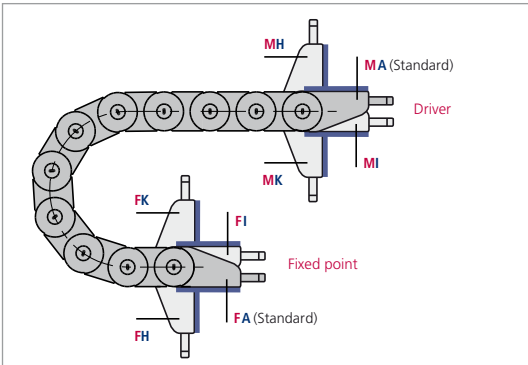

Connection point

- M** – Driver
- F** – Fixed point

Connection type

- A** – Threaded joint outside (standard)
- I** – Threaded joint inside
- H** – Threaded joint, rotated through 90° to the outside
- K** – Threaded joint, rotated through 90° to the inside

In the standard version, the connectors are mounted with the threaded joint outwards (**FA/MA**).

When ordering please specify the desired connection type (see ordering key on page 414).

The connection type can subsequently be altered simply by varying the connectors.

Fon: +49 2762 4003-0

OnlineEngineer.de
The online engineer
for cable chain configuration

Notes

Inside height



Inside widths



kabelschlepp.de

Fon: +49 2762 4003-0

Use our free project planning service.

Notes

Inside
height



Inside
widths



kabelschlepp.de

Font:
+49 2762 4003-0

OnlineEngineer.de
The online engineer
Cable Center Configuration

