

## Model and Specification

Series	Crystal Series			
Model	R6060BA	R6060BA	R6030AA	R6030AA
Part Number	R6060BA-1	R6060BA-3	R6030AA-2	R6030AA-4
Quantity(pcs)	4	2	4	2
Rated Power(W)	6.6	3.3	13.2	6.6

Color:	Monochrome
Input Voltage(V AC):	100~240
Working Voltage(V DC):	12
Operating Temperature (°C[°F]):	0~40[32~104]
Storage Temperature (°C[°F]):	-20~60[-4~140]

## Dimension and Connection Illustration

Unit:mm[in]

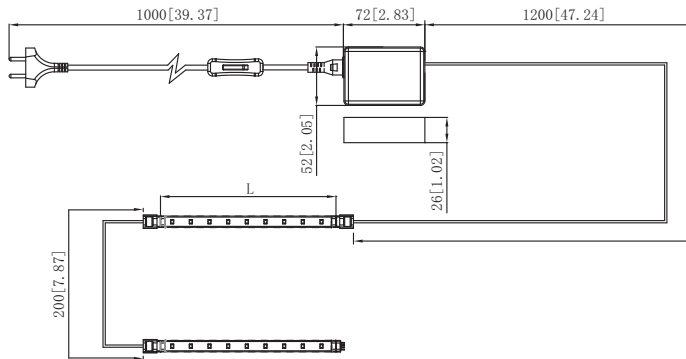

Fig.1 R6060BA-3: L=300[11.81]  
R6030AA-4: L=500[19.69]

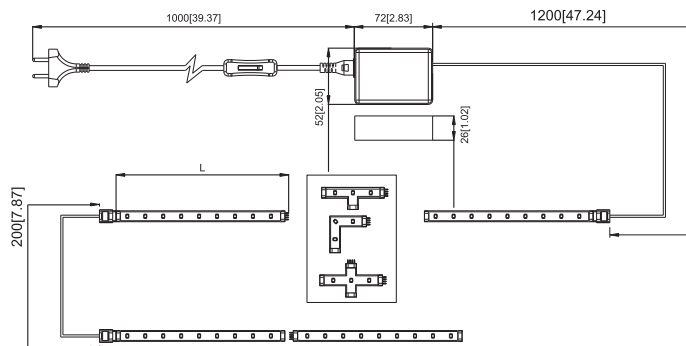
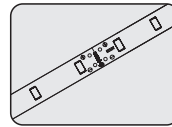

Fig.2 R6060BA-1: L=300[11.81]  
R6030AA-2: L=500[19.69]

## Installation and Use

### 1. Product Parts:



LED Strips

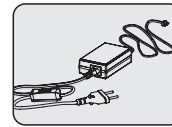

SMPS

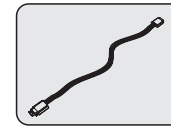

Line Connector

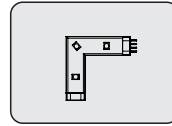

L-connector

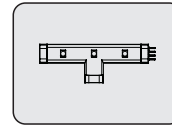

T-connector

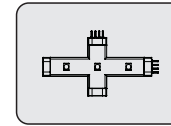

Cross-connector

### 2. Installation Guide:

#### Connecting Modes between the Strips

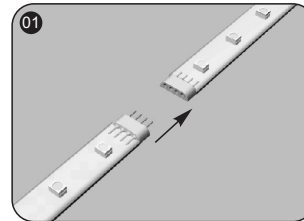

- The line pins of any strips can be connected to the line holes of strips.

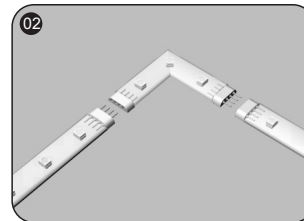

- The line pins or line holes of L-connectors can be connected to those of strips.

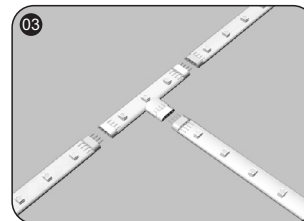

- The line pins or line holes of T-connectors can be connected to those of strips.

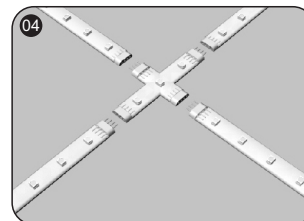

- The line pins or line holes of Cross-connectors can be connected to those of other strips.

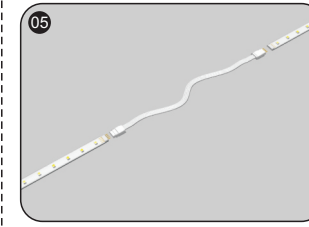

- The line pins of any strips can be connected to the line holes of any strips and other line holes of other strips.

#### Installation Procedures

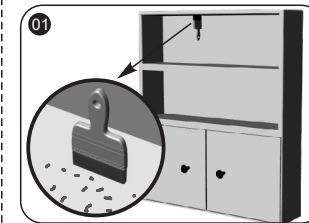

- Clean the mounting surface before installing and confirm the installation position and quantity.

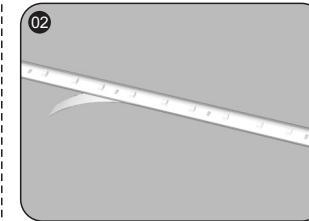

- Peel off the adhesive tape gradually, and stick strips on the mounting surface.

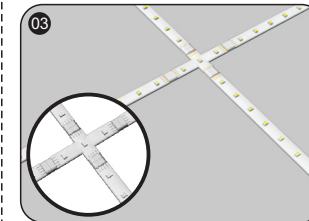

- Choose the connecting mode between the LED strips.

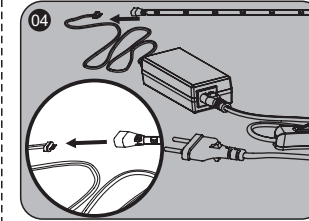

- Plug the interface of the strip into the Power Supply.

⚠ Note: Don't plug the SMPS connector reversely!

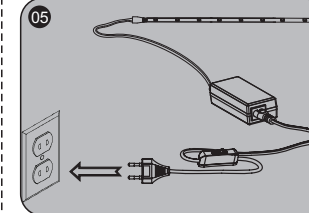

- Turn off the switch, and energize the power supply, then you can control the LED strip with the switch.

⚠ Note: Keep the switch, the power supply and the controller out of reach of children.

## NOTE

- Make sure that you keep the surface clean before installing strips.
- Don't exceed 4pcs flex LED strips per power supply.
- Forbid using any acid and alkali adhesive to fix the strips.
- Turn power off before installing products.

## Malfunction & Solution Table

Malfunction & Solution Table		
Malfunction	Possible Causes	Solutions
None LED works	1.The power supply doesn't work.	Power on the supply.
	2.The connector is damaged.	Replace a connector.
	3.The pins and the holes of the connectors are not connected well, which causes the LED strips not work.	Replace the damaged products or re-connect the connectors properly.
Some LED strips don't work	1.Some of the pins of the products are damaged.	Replace the strips with new ones.
	2.Something wrong with the connector.	Replace the connector.
Brightness of the LEDs is dim or not even	Too many products connected to the power supply	Reduce the quantity to the standard quantity per string.
LED strips are blinking	1.Bad connections exist.	Find the bad points and remove them.
	2.The power supply malfunctions.	Replace the power supply with a new one.

## WARNING

- Turn power off before installing the products.
- Forbid using any acid and alkali adhesive or glue to fix the product.

## Declaration

- Warranty: 2 years or 9,000 hours, whichever comes first.
- If the luminaire is damaged, please contact the manufacturer or his service agent.
- All the data and pictures in this manual are subject to actual products.
- Information provided is subject to change without notice.

# Crystal Series Flex LED Strip Manual

R6060BA-1 R6060BA-3  
R6030AA-2 R6030AA-4



Read this manual carefully before using this product and keep it!