

FAN TECHNICAL DATA

ID CODE	720056
FAN NAME	DD 10-10 TAC2 3/4
SUPPLY	230V-50Hz
MOTOR	ECM 2.3 3/4 5SME39SL0666 (5SME39SL07 - ECM2.3)
IP CLASS	44
THERMAL CLASS	B
MODE	VSPD
RANGE	700 - 3800 m3/h
CONFORMITY	CE
CONTROL DEVICE	included

NOMINAL INSTALLATION DATA

	Amps (A)	Abs.Power (W)	Max air T°(TM) (°C)
Maximum	5,3	925	55

DIMENSIONS

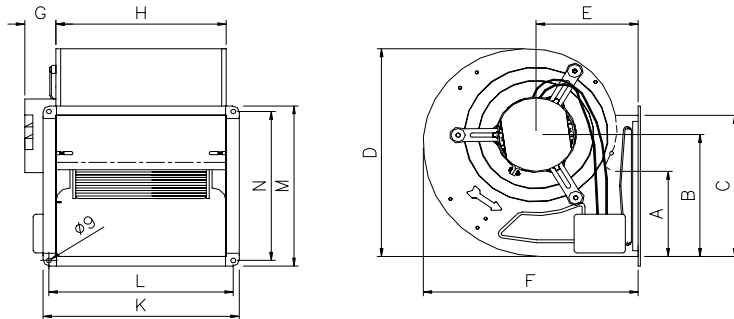

A	B	C	D	E	F	G	H	K	L	M	N
163	229	265	391	180	379	80	300	346	325	301	280

We are constantly working to make our products better and more reliable. Therefore we cannot guarantee data update.
Therefore, although we put a lot of care in the making of our documentation, we cannot be held responsible for any error and/or omissions that could have slipped in.

MAXIMUM WORKING ENVELOPE

measured in our laboratory according to AMCA/ASHRAE 210.85 fig.12

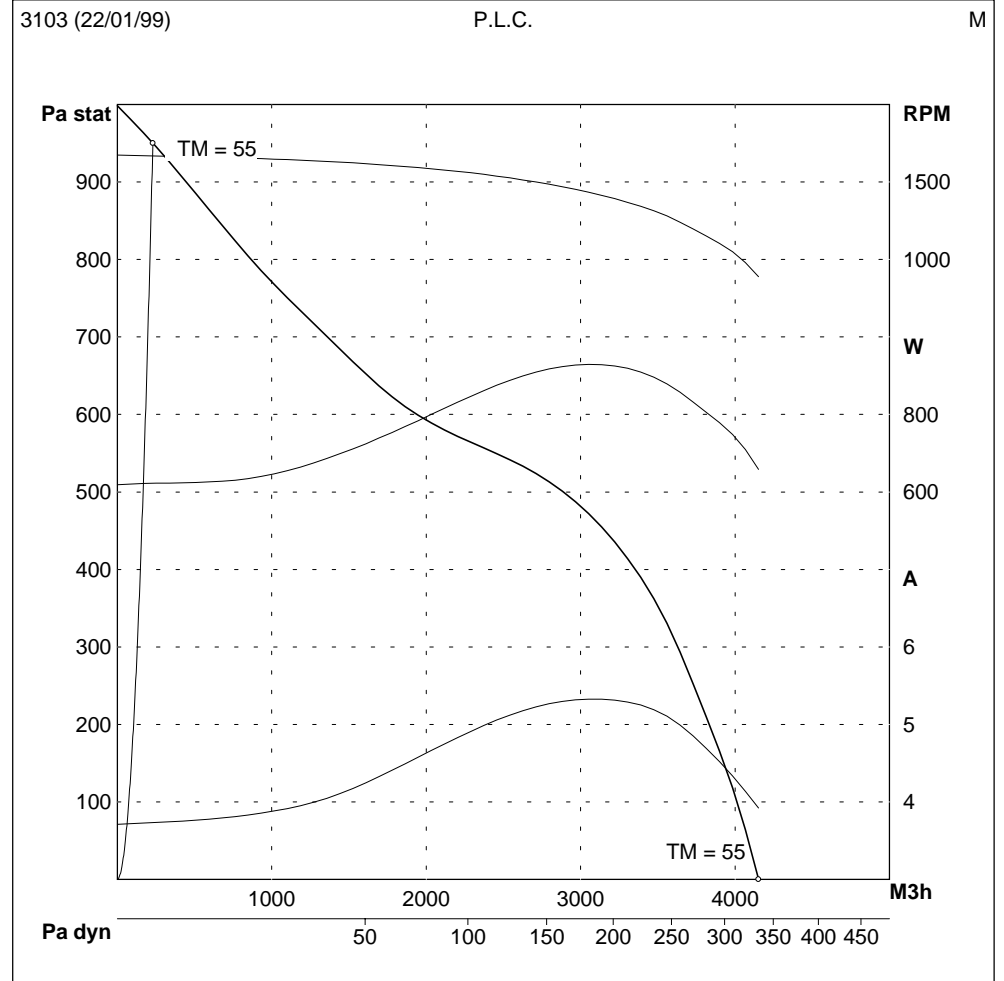

WIRING DIAGRAM

