

ALL FLANGED TEE

DN1	DN2	L	l	e1	e2	weight	code
50	50	300	150	7,0	7,0	11,5	T050050
65	50	330	160	7,0	7,0	12,0	T065050
65	65	330	165	7,0	7,0	13,0	T065065
80	50	330	150	7,0	7,0	14,2	T080050
80	65	330	165	7,0	7,0	15,0	T080065
80	80	330	165	7,0	7,0	15,6	T080080
100	50	360	170	7,2	7,0	18,4	T100050
100	65	360	175	7,2	7,0	18,4	T100065
100	80	360	175	7,2	7,0	18,4	T100080
100	100	360	180	7,2	7,2	19,3	T100100
150	50	340	180	7,8	7,0	27,8	T150050
150	80	440	205	7,8	7,0	28,5	T150080
150	100	440	205	7,8	7,2	29,5	T150100
150	150	440	215	7,8	7,8	32,5	T150150
200	80	520	225	8,4	7,0	43,0	T200080
200	100	520	240	8,4	7,2	43,5	T200100
200	150	520	250	8,4	7,8	48,0	T200150
200	200	520	260	8,4	8,4	49,0	T200200
250	80	405	265	9,0	7,0	65,0	T250080
250	100	700	275	9,0	7,2	69,0	T250100
250	150	485	280	9,0	7,5	70,0	T250150
250	200	700	235	9,0	8,4	80,0	T250200
250	250	700	350	9,0	9,0	89,0	T250250
300	80	425	295	9,6	7,0	93,0	T300080
300	100	450	300	9,6	7,2	97,0	T300100
300	150	500	310	9,6	7,5	98,0	T300150
300	200	800	350	9,6	8,4	101,0	T300200
300	250	620	330	9,6	9,0	106,0	T300250
300	300	800	400	9,6	9,6	125,0	T300300
400	150	900	350	10,8	7,5	163,0	T400150
400	200	900	350	10,8	8,4	169,0	T400200
400	250	665	390	10,8	9,0	175,0	T400250
400	300	725	400	10,8	9,6	179,0	T400300
400	400	900	450	10,8	10,8	198,0	T400400

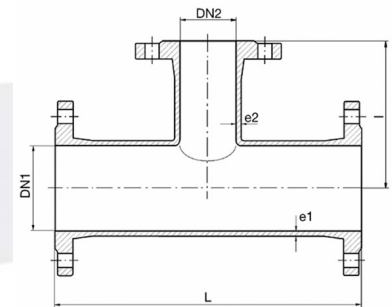

Technical characteristics:

Body- ductile cast iron GGG-50

According to DIN EN 545 standard

Epoxy coating RAL5015

Drilling of flanges: PN10/16, starting from DN200- PN10