

Ruijie Reyee RG-EST330F-P Wireless Bridge

Installation Guide

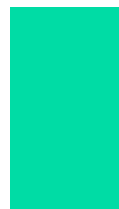
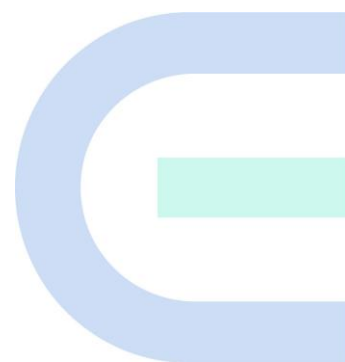

Copyright

Copyright © 2025 Ruijie Networks

All rights are reserved in this document and this statement.

Without the prior written consent of Ruijie Networks, any organization or individual shall not reproduce, extract, back up, modify, or propagate the content of this document in any manner or in any form, or translate it into other languages or use some or all parts of the document for commercial purposes.

 , and other Ruijie networks logos are trademarks of Ruijie Networks.

All other trademarks or registered trademarks mentioned in this document are owned by their respective owners.

Disclaimer

The products, services, or features you purchase are subject to commercial contracts and terms, and some or all of the products, services, or features described in this document may not be available for you to purchase or use. Except for the agreement in the contract, Ruijie Networks makes no explicit or implicit statements or warranties with respect to the content of this document.

The names, links, descriptions, screenshots, and any other information regarding third-party software mentioned in this document are provided for your reference only. Ruijie Networks does not explicitly or implicitly endorse or recommend the use of any third-party software and does not make any assurances or guarantees concerning the applicability, security, or legality of such software. You should choose and use third-party software based on your business requirements and obtain proper authorization. Ruijie Networks assumes no liability for any risks or damages arising from your use of third-party software.

The content of this document will be updated from time to time due to product version upgrades or other reasons, Ruijie Networks reserves the right to modify the content of the document without any notice or prompt.

This manual is designed merely as a user guide. Ruijie Networks has tried its best to ensure the accuracy and reliability of the content when compiling this manual, but it does not guarantee that the content of the manual is completely free of errors or omissions, and all the information in this manual does not constitute any explicit or implicit warranties.

Preface

Intended Audience

This document is intended for:

- Network engineers
- Technical support and servicing engineers
- Network administrators

Technical Support

- The official website of Ruijie Reyee: <https://reyee.ruijie.com>
- Technical Support Website: <https://reyee.ruijie.com/en-global/support>
- Case Portal: <https://www.ruijienetworks.com/support/caseportal>
- Community: <https://community.ruijienetworks.com>
- Technical Support Email: service_rj@ruijienetworks.com
- Online Robot/Live Chat: <https://reyee.ruijie.com/en-global/rita>

Conventions

1. Signs

This document also uses signs to indicate some important points during the operation. The meanings of these signs are as follows:

Caution

An alert that calls attention to safety instruction that if not understood or followed can result in personal injury.

Warning

An alert that calls attention to important rules and information that if not understood or followed can result in data loss or equipment damage.

Note

An alert that calls attention to essential information that if not understood or followed can result in function failure or performance degradation.

Instruction

An alert that contains additional or supplementary information that if not understood or followed will not lead to serious consequences.

Specification

An alert that contains a description of product or version support.

2. Note

This manual provides installation steps, troubleshooting, technical specifications, and usage guidelines for cables and connectors. It is intended for users who want to understand the above and have extensive experience in network deployment and management, and assume that users are familiar with related terms and concepts.

Contents

Preface	1
1 Overview	1
1.1 About the RG-EST330F-P	1
1.2 Package Contents.....	1
1.3 Product Appearance	2
1.3.1 Appearance of the RG-EST330F-P	2
1.3.2 Components on the Back Panel	3
1.4 Technical Specifications	5
1.5 Power Supply Technical Specifications.....	7
2 Safety Precautions	8
2.1 Safety Guidelines.....	8
2.1.1 General Safety Guidelines.....	8
2.1.2 Chassis-Lifting Guidelines	8
2.1.3 Electric Safety	8
2.2 Site Requirements	9
2.2.1 Installation Requirements	9
2.2.2 Lightning Protection Requirements	9
2.2.3 Temperature/Humidity Requirements	9
2.2.4 Electromagnetic Interference.....	9
2.3 Tools	10
2.4 Checking Before Installation	10
3 Installation	11
3.1 Before You Begin.....	11

3.2 Safety Precautions During Installation	11
3.3 Installing the RG-EST330F-P	11
3.3.1 Pole Mounting using Band Clamps	12
3.3.2 Mounting the RG-EST330F-P on a Wall.....	12
3.4 Connecting the Cables	13
3.5 Verifying the Installation.....	16
4 Debugging	17
4.1 Powering On	17
4.2 Configuring the Bridge	17
5 Monitoring and Maintenance.....	18
5.1 Monitoring	18
5.2 Hardware Maintenance.....	18
6 Common Troubleshooting	19
6.1 Troubleshooting Flowchart	19
7 Appendix.....	20
7.1 Connectors and Media.....	20

1 Overview

1.1 About the RG-EST330F-P

The RG-EST330F-P is an IEEE 802.11ac-compliant wireless bridge launched by Ruijie Reyee for applications such as video surveillance backhaul and remote data transmission in scenarios covering elevators, tower cranes, factories, campuses, and construction sites.

The RG-EST330F-P operates on the 5 GHz frequency band and supports 2x2 Multiple Input Multiple Output (MIMO) with two spatial streams, delivering a maximum wireless throughput of 867 Mbps for bridging applications. This meets users' bandwidth demands for data links. Additionally, the RG-EST330F-P supports the IEEE 802.11n standard, offering a maximum data rate of 150 Mbps on the 2.4 GHz band, which is ideal for remote device management. The RG-EST330F-P also supports IEEE 802.3af-compliant PoE and features two PoE-out ports, with a total output power of 15.4 W.

1.2 Package Contents

Table 1-1 Package Contents

No.	Item	Quantity
1	RG-EST330F-P wireless bridge	1
2	DC power adapter 24 V/1.5 A	1
3	Passive PoE injector	1
4	<i>Quick Start Guide</i>	1
5	<i>Warranty Card</i>	1
6	Band clamps	2
7	Screw kit (including four screws and four wall anchors)	1
8	Mounting template	1

Note

The package contents are subject to the purchase contract, and actual delivery may vary. Please check the items carefully against the package contents or purchase contract. If you have any questions, please contact the distributor.

1.3 Product Appearance

1.3.1 Appearance of the RG-EST330F-P

Figure 1-1 Front View of the RG-EST330F-P

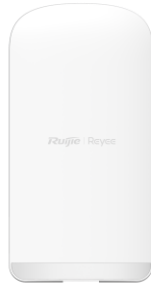
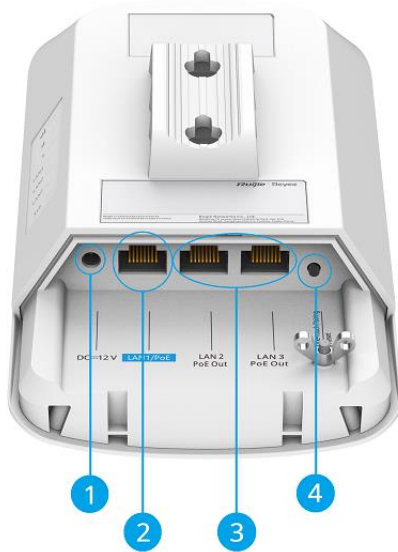

Figure 1-2 Side and Back View of the RG-EST330F-P



1.3.2 Components on the Back Panel

Figure 1-3 Components on the Back Panel



Note

The label is located on the back of the wireless bridge.

Table 1-2 Components on the Back Panel

No.	Component	Description
1	DC power connector	Connected to a 12–24 V DC power adapter.
2	LAN1/PoE port	<ul style="list-style-type: none"> ● 10/100BASE-T port. ● Connected to a Cat5e or higher cable. ● Supporting 24 V passive PoE power supply. ● Supporting IEEE 802.3at-compliant PoE power supply.
3	LAN2 and LAN3 PoE-out ports	<ul style="list-style-type: none"> ● 10/100BASE-T ports. ● Supporting IEEE 802.3at-compliant PoE output.
4	Reset/One-Touch Pairing button	<ul style="list-style-type: none"> ● Press and hold the button for less than 2s: The wireless bridge pairs with another wireless bridge in 30s (the LED blinks during pairing). ● Press and hold the button for 2s to 10s: No action is triggered. ● Press and hold the button for more than 10s: The wireless bridge is restored to factory settings.

Note

- After the One-Touch Pairing button is pressed, the wireless bridge is switched to BaseStation mode regardless of whether it is in BaseStation or CPE mode.
- During one-touch pairing, the signal LEDs on the wireless bridge in BaseStation mode blink for 1 minute (it will stop blinking after 1 minute if no bridge connection is established). The signal LEDs on the wireless bridge in CPE mode also blink until the pairing is complete.

- Only a wireless bridge that has been reset to factory settings and has not been bridged before can be switched to CPE mode through one-touch pairing.
- The one-touch pairing feature is enabled by default and can be disabled through eWeb.
- One-touch pairing is disabled during interference scanning.
- When the bridge is powered by a 12 V DC adapter, 48 V passive PoE, or IEEE802.3af standard PoE, the PoE-out function is not supported. However, when powered by a 24V passive PoE or IEEE802.3at standard PoE, the PoE-out function is supported.
- When the bridge is powered by a 12 V DC adapter, 48 V passive PoE, or IEEE802.3af standard PoE, the PoE-out function is not supported. However, when powered by a 24V passive PoE or IEEE802.3at standard PoE, the PoE-out function is supported.

Figure 1-4 LEDs

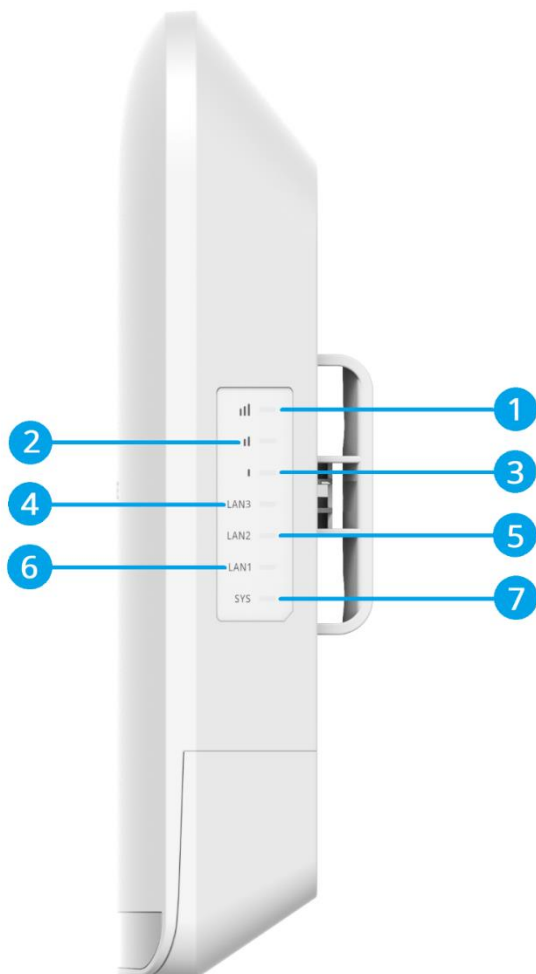

Table 1-3 LEDs

No.	LED	Description
1, 2, and 3	Signal LEDs	<ul style="list-style-type: none"> ● LED 3, LED 2, and LED 1 off: The bridge is not paired with another bridge. ● LED 3 on or blinking: The bridge is paired with another bridge, and the Received Signal Strength Indicator (RSSI) is lower than -75 dBm. ● LED 3 on: The bridge is paired with another bridge, and the RSSI is greater than -75 dBm. ● LED 3 on and LED 2 blinking: The bridge is paired with another bridge, and the RSSI is greater than -73 dBm. ● LED 3 and LED 2 on: The bridge is paired with another bridge, and the RSSI is greater than -71 dBm. ● LED 3 and LED 2 on and LED 1 blinking: The bridge is paired with another bridge, and the RSSI is greater than -68 dBm. ● LED 3, LED 2, and LED 1 on: The bridge is paired with another bridge, and the RSSI is greater than -64 dBm. ● LED 3, LED 2, and LED 1 blinking: The bridge is pairing with another bridge.
4 and 5	Port LEDs	<ul style="list-style-type: none"> ● Off: The port is not connected. ● Solid on: The port is connected, but is not receiving or sending data. ● Fast blinking: The port is connected, and is receiving and sending data.
6	System LED	<ul style="list-style-type: none"> ● Off: The bridge is not powered on. ● Solid on: The bridge is operating normally. ● Slow blinking: The bridge is operating but an alarm or a power failure occurs. ● Fast blinking (8 to 10 times/second): The bridge is starting up. ● Fast blinking (2 times/second): The bridge is initializing or upgrading.

1.4 Technical Specifications

 **Note**

The weight in the following table refers to the weight of a single device.

Table 1-4 Technical Specifications

Model	RG-EST330F-P
Radio Design	<ul style="list-style-type: none"> ● 2.4 GHz: single-stream ● 5 GHz: dual-stream 2x2 MIMO
Protocol and Standard	<ul style="list-style-type: none"> ● 5 GHz: 802.11ac/n/a ● 2.4 GHz: 802.11b/g/n
Operating Frequency Bands	<ul style="list-style-type: none"> ● 2.4 GHz: 802.11b/g/n: 2.400 GHz to 2.483 GHz ● 5 GHz: 802.11a/n/ac: 5.150 GHz to 5.350 GHz, 5.470 GHz to 5.725 GHz, 5.725 GHz to 5.850 GHz <hr/> <p> Note</p> <p>Country-specific restrictions apply.</p>

Model	RG-EST330F-P
	<ul style="list-style-type: none"> ● European Union & United Kingdom: 2400 MHz to 2483.5 MHz, EIRP ≤ 20 dBm; 5470 MHz to 5725 MHz, EIRP ≤ 30 dBm ● Myanmar: 2400 MHz to 2483.5 MHz, EIRP ≤ 23 dBm; 5725 MHz to 5825 MHz, EIRP ≤ 30 dBm ● Thailand: 2400 MHz to 2483.5 MHz, EIRP ≤ 20 dBm; 5470 MHz to 5725 MHz, EIRP ≤ 30 dBm; 5725 MHz to 5825 MHz, EIRP ≤ 30 dBm ● Indonesia: 2400 MHz to 2483.5 MHz, EIRP ≤ 27 dBm; 5725 MHz to 5825 MHz, EIRP ≤ 23 dBm ● Egypt: 2400 MHz to 2483.5 MHz, EIRP ≤ 20 dBm; 5150 MHz to 5350 MHz, EIRP ≤ 23 dBm
Antenna Type	Built-in antenna (horizontal/vertical): 30°/30°
Antena Gain	<ul style="list-style-type: none"> ● 2.4 GHz: 2 dBi ● 5 GHz: 13 dBi
Working Distance	3 km (1.86 mi)
Data Rate	<ul style="list-style-type: none"> ● 2.4 GHz: 150 Mbps ● 5 GHz: 867 Mbps
Modulation	<ul style="list-style-type: none"> ● OFDM: BPSK@6/9 Mbps, QPSK@12/18 Mbps, 16-QAM@24 Mbps, 64-QAM@48/54 Mbps ● DSSS: DBPSK@1 Mbps, DQPSK@2 Mbps, CCK@5.5/11 Mbps ● OFDM: BPSK, QPSK, 16QAM, 64QAM
Receiver Sensitivity	<ul style="list-style-type: none"> ● 11b: -91 dBm (1 Mbps), -88 dBm (5 Mbps), -85 dBm (11 Mbps) ● 11a/g: -89 dBm (6 Mbps), -80 dBm (24 Mbps), -76 dBm (36 Mbps), -71 dBm (54 Mbps) ● 11n: -83 dBm (MCS0), -65 dBm (MCS7), -83 dBm (MCS8), -65 dBm (MCS15)
Max. Transmit Power	<ul style="list-style-type: none"> ● 2.4 GHz: ≤ 100 mW (20 dBm) (adjustable) ● 5 GHz: ≤ 400 mW (26 dBm) (single stream)
Power Step	1 dBm
Dimensions (W x D x H)	198.8 mm x 102 mm x 53.4 mm (7.83 in. x 4.02 in. x 2.1 in.) (excluding packaging materials)
Package Dimensions (W x D x H)	276 mm x 165 mm x 107 mm (10.87 in. x 6.5 in. x 4.21 in.)
Weight	<p>0.37 kg (0.82 lbs.) (excluding packaging materials)</p> <p>0.91 kg (2.01 lbs.) (including packaging materials and one paie)</p>
Service Ports	3 x 10/100BASE-T auto-negotiation ports
Button	1 x Reset/One-Touch Pairing button
LED	1 x system LED, 3 x port LEDs, and 3 x signal LEDs
Power Supply	<ul style="list-style-type: none"> ● 24 V passive PoE input (supplied with a passive PoE injector) ● IEEE 802.3at-compliant PoE ● 12–24 V DC power supply (supplied with a 24 V DC power adapter) ● 12 V DC (solar panel)

Model	RG-EST330F-P
Power Consumption	< 9 W (without PoE Out)
Environmental	Operating temperature: -30°C to +55°C (-22°F to +131°F)
	Storage temperature: -40°C to +85°C (-40°F to +185°F)
	Operating humidity: 5% RH to 95% RH (non-condensing)
	Storage humidity: 5% RH to 95% RH (non-condensing)
Mounting	<ul style="list-style-type: none"> ● Wall-mount ● Pole-mount
IP Rating	IP55
Certification	CE
Mean Time Between Failures (MTBF)	> 400,000 hours

! Warning

Operation of this equipment in a residential area is likely to cause radio interference.

1.5 Power Supply Technical Specifications

The RG-EST330F-P can be powered by 24 V/1.5 A DC power supply, 24 V passive PoE power supply, and IEEE 802.3at-compliant PoE power supply. It is supplied with a 24 V/1.5 A DC power adapter and a passive PoE injector.

Technical specifications of the DC power adapter:

Table 1-5 Technical Specifications of the DC Power Adapter

Inner Diameter	Outer Diameter	Insertion Depth	Polarity
1.35 mm (0.05 in.)	3.5 mm (0.14 in.)	10 mm (0.40 in.)	Center: positive (+); Barrel: negative (-). Reverse polarity symbol is not allowed.

! Warning

- Avoid using PoE injectors or switches of other models to power the bridges in BaseStation and CPE modes, as this may cause irreparable damage to the bridges.
- To ensure reliable operation of the bridge, use the supplied DC power adapter or passive PoE injector indoors.
- When the bridge is operating at full load, ensure the ambient temperature remains below 55°C (131°F).
- When using a DC power supply to power the device, ensure that the power output of the DC power supply is less than 100 W.

2 Safety Precautions

2.1 Safety Guidelines

Note

- To prevent personal injury and device damage, carefully read the safety guidelines before installing the equipment.
 - The following safety guidelines may not cover all potential hazards.
-

2.1.1 General Safety Guidelines

- Do not expose the equipment to high temperatures, dust, or harmful gases. Do not install the equipment in flammable or explosive environments. Keep the equipment away from sources of electromagnetic interference (EMI), such as large radar stations, radio stations, and substations. Do not subject the equipment to unstable voltage, vibration, or excessive noise.
 - The installation site should be dry. Do not install the equipment in a place near the sea. Keep the equipment at least 500 meters (1640.42 ft.) away from the ocean and do not face it towards the sea breeze.
 - The installation site should be free from water flooding, seepage, dripping, or condensation. The installation site should be selected according to network planning, communications equipment features, and considerations such as climate, hydrology, geology, earthquake, electrical power, and transportation.
-

Caution

Always install and remove the equipment according to the installation procedures outlined in this document.

2.1.2 Chassis-Lifting Guidelines

- After the equipment is installed, avoid handling it frequently.
- Cut off all power supplies and unplug all power cords before moving or handling the equipment.

2.1.3 Electric Safety

Warning

- Improper or incorrect electric operations may cause a fire, electric shock, and other accidents, and lead to severe and fatal personal injury and equipment damage.
 - Direct or indirect contact with high voltage or mains power supply via wet objects may cause fatal dangers.
-

- Observe local regulations and specifications during electric operations. Only personnel with relevant qualifications can perform such operations.
- Check whether there are potential risks in the work area. For example, check whether the power supply is grounded, and whether the grounding is reliable.

2.2 Site Requirements

To ensure the normal operation and prolonged service life of the equipment, the installation site must meet the following requirements.

2.2.1 Installation Requirements

- The equipment should be installed in an open environment if possible. If the environment is enclosed, verify that a good ventilation and heat dissipation system is available.
- Ensure that the installation position is sturdy enough to support the weight of the RG-EST330F-P and its accessories.
- Ensure that the installation location is suitable for the RG-EST330F-P, leaving sufficient space on the front, back, left, and right sides for heat dissipation.

2.2.2 Lightning Protection Requirements

- When the connection cable between the main grounding conductor and local equipotential earthing terminal board (LEB) on each floor is short, use a stranded copper wire with a sectional area not less than 1.318 mm² (16 AWG) for the connection cable.
- Use a shielded network cable if possible. Ensure that devices connected to both ends of the shielded network cable are reliably grounded, and that the sheath of the shielded network cable is also grounded if possible. If no shielded network cable is available, wire the network cable through a steel pipe and bury the steel pipe for lead-in, and properly ground both ends of the steel pipe.
- The RG-EST330F-P features a built-in 4 kV surge protector, so generally no additional surge protector is needed. However, if higher surge protection is required, an external surge protector can be added, and it should be connected to a grounding cable during installation.

2.2.3 Temperature/Humidity Requirements

To ensure proper operation and extend the service life of the equipment, maintain an appropriate temperature and humidity in the operating environment. The operating environment with too high or too low temperature and humidity for a long period of time may damage the equipment.

- In an environment with high humidity, the insulating material may have poor insulation or even leak electricity. Sometimes high humidity may causes changes in the mechanical properties and causes rusting of metal parts.
- In an environment with low relative humidity, static electricity is prone to occur and damage the internal circuits of the equipment.
- Too high temperatures can accelerate the aging of insulation materials, greatly reducing the reliability of the equipment and severely affecting its service life.

Table 2-1 Temperature and Humidity Requirements

Operating Temperature	Operating Humidity
-30°C to +55°C (-22°F to +131°F)	5% RH to 95% RH (non-condensing)

2.2.4 Electromagnetic Interference

- Take interference prevention measures for the power supply system.

- Keep the equipment far away from grounding or lightning protection devices for power equipment.
- Keep the equipment away from radio stations, radar stations, high-frequency high-current devices, and microwave ovens.

2.3 Tools

Table 2-2 Tools

Common Tools	Marker, Phillips screwdriver, hammer drill, hammer, hose clamp, power cords, Ethernet cables, diagonal pliers, cable ties
Special Tools	Anti-ESD gloves, wire stripper, crimper, RJ45 connector crimping plier, and wire cutter
Meters	Multimeter and Ethernet cable tester
Relevant Devices	PC, display, and keyboard

 **Note**

The RG-EST330F-P is not shipped with a tool kit. You need to prepare a tool kit by yourself.

2.4 Checking Before Installation

Upon unpacking the product, carefully inspect each item according to the provided package contents. If there is any discrepancy with the actual contents, please contact the supplier or distributor.

3 Installation

⚠ Caution

Before installing the equipment, make sure that you have carefully read the requirements described in Section [2 Safety Precautions](#).

3.1 Before You Begin

Carefully plan and arrange the installation position, networking mode, power supply, and cabling before installation. Confirm the following requirements before installation:

- The installation site provides sufficient space for proper ventilation.
- The installation site meets the temperature and humidity requirements of the equipment.
- The power supply and required current are available in the installation site.
- The selected power modules meet the system power requirements.
- The installation site meets the cabling requirements of the equipment.
- The installation site meets the site requirements of the equipment.
- The customized equipment meets the client-specific requirements.

3.2 Safety Precautions During Installation

Before installation, ensure that the installation site meets the requirements described in Section [2.2 Site Requirements](#), and pay attention to the following:

- Use the supplied 24 V/1.5 A DC power adapter or an equivalent power source with the same specifications to power the equipment. Do not use adapters with different specifications.
- The supplied DC power adapter and passive PoE injector support power supply over Ethernet cables up to 100 meters (328.08 ft.). Before using an Ethernet cable for power supply, ensure that the power switches on the power modules are turned off.
- Ensure that the Ethernet cable and power cord are securely connected.

3.3 Installing the RG-EST330F-P

⚠ Caution

- When installing the equipment, ensure that it is positioned to maximize the coverage area for antenna radiation.
 - This installation guide is for reference only. The actual installation procedure may differ depending on the specific product.
-

3.3.1 Pole Mounting using Band Clamps

Note

The recommended pole diameter ranges from 35 mm (1.38 in.) to 89 mm (3.50 in.). If the pole falls outside this range, you will need to use hose clamps with a wall thickness of at least 2.5 mm (0.10 in.).

- (1) Thread the band clamps through the mounting bracket on the back of the bridge.
- (2) Tighten the band clamps to secure it to the pole.

Figure 3-1 Mounting the RG-EST330F-P on a Vertical Pole

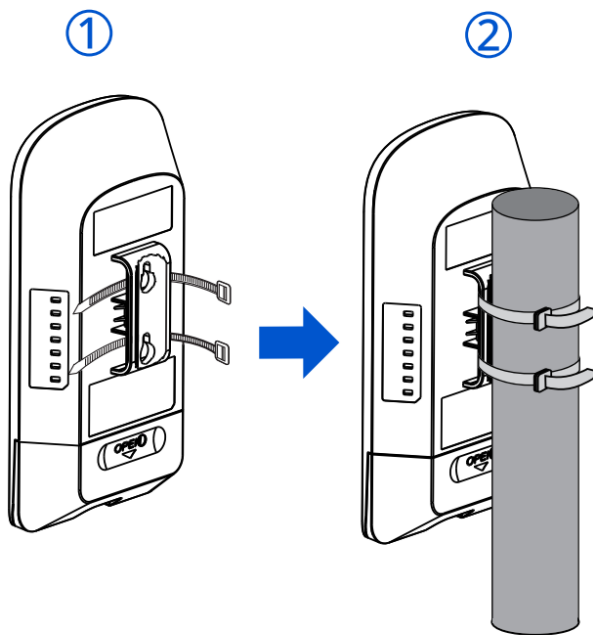

3.3.2 Mounting the RG-EST330F-P on a Wall

- (1) Use the mounting template to mark the screw holes on the wall, then drill the holes and insert the 4.2 mm x 19 mm (0.17 in. x 0.75 in.) BA (SS) tapping screws.

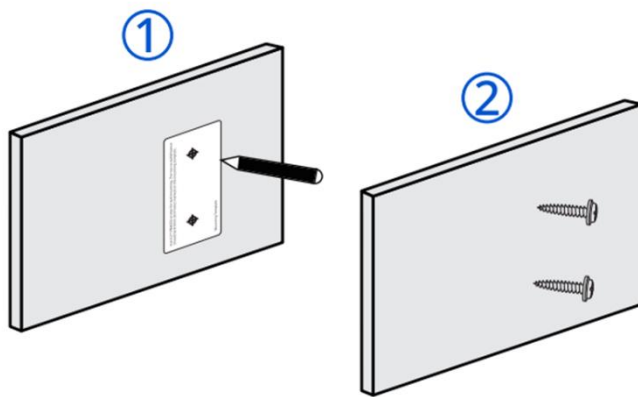
Figure 3-2 Drilling Holes and Securing the Screws

(2) Align the holes on the mounting bracket with the screws, then slide the device into place.

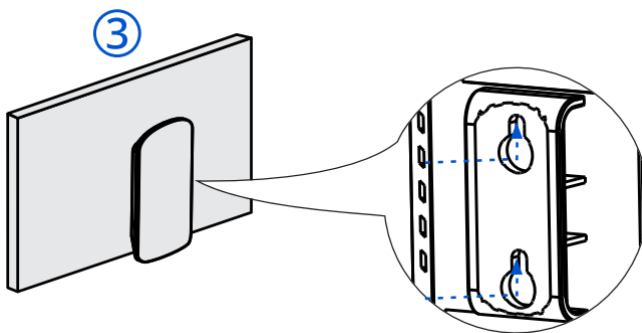
Figure 3-3 Mounting the Device

3.4 Connecting the Cables

Warning

- After connecting the device to an Ethernet cable, cover the Ethernet port to ensure it is waterproof and dustproof.
- Do not use PoE injectors or switches of different models for power supply, as this may damage the device.
- If a solar panel is used to power the bridge, ensure that the power of the solar panel is less than 100 W.

Select or make an Ethernet cable suitable for the distance between the bridge and the power source equipment. (The bridge supports Cat5e or higher cables up to 100 meters (328.08 ft) for PoE power supply.)

You can connect the cables in the following ways:

- Connect the Ethernet cable to the passive PoE injector:
 - (1) Connect one end of the Ethernet cable to the PoE port of the passive PoE injector, and the other end to the LAN1/PoE port on the bridge.
 - (2) Connect the LAN port of the passive PoE injector to a server or IP camera.
 - (3) Connect the 24 V/1.5 A DC power adapter to the DC power connector of the PoE injector for power supply.

- (4) Connect one end of the Ethernet cable to the LAN2 or LAN3 port on the bridge, and the other end to an IP camera.

Figure 3-4 Connecting the Ethernet Cable to the Passive PoE Injector

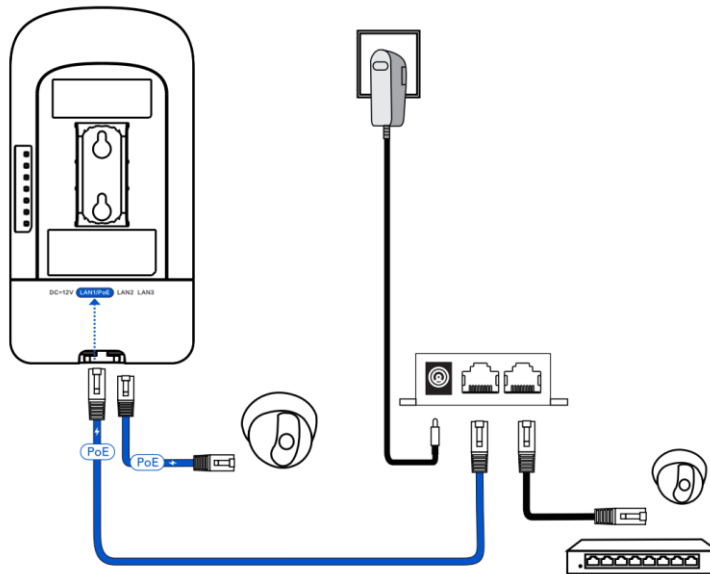

- Connect the Ethernet cable to a solar panel:
 - (1) Connect one end of the Ethernet cable to the LAN1/PoE, LAN2, or LAN3 port on the bridge, and the other end to a server or IP camera.
 - (2) Connect the 12 V/1.5 A DC solar panel to the DC connector on the bridge for power supply.

Figure 3-5 Connect the Ethernet cable to a solar panel

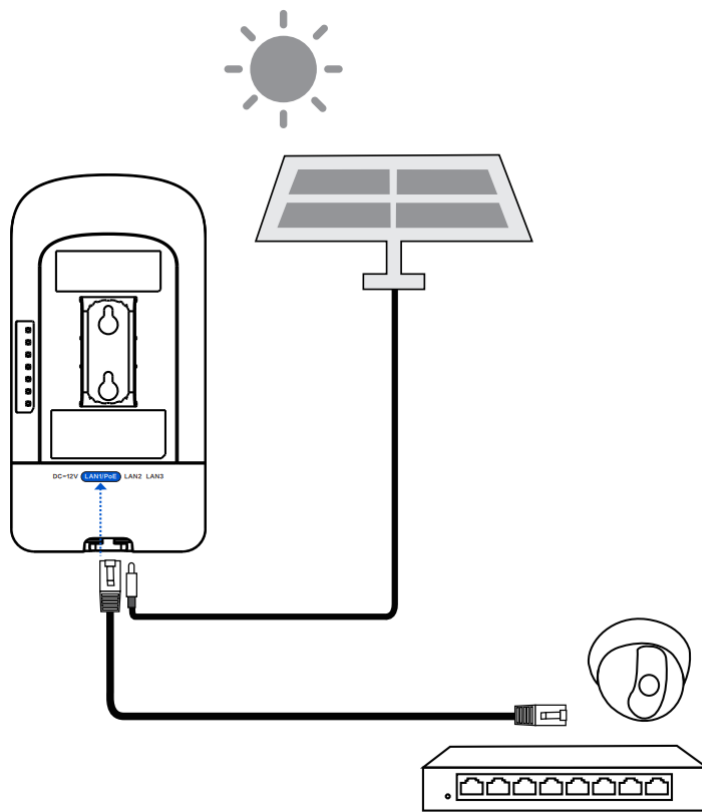

Solar Panel

Solar panels convert light energy from sunlight into electrical energy. The RG-EST330F-P requires a solar power panel with an output specification of 12V/1.2A DC.

Notes for Installing the Solar Panel

Because the sun’s position differs between the Northern and Southern Hemispheres, the solar panel should face south in the Northern Hemisphere and north in the Southern Hemisphere to achieve optimal power output. Additionally, the tilt angle of the solar panel affects the efficiency of solar energy conversion. The optimal tilt angle varies with latitude. The following table shows the optimal tilt angles for different latitude ranges.

Latitude Range	Optimum Tilt
0°–10°	10°–20°
10°–20°	20°–30°
20°–30°	30°–40°
30°–40°	40°–50°
40°–50°	50°–60°
50°–60°	Approximately 60°

- Connect the Ethernet cable to a PoE switch:

- (1) Connect one end of the Ethernet cable to a PoE port on the PoE switch, and the other end to the LAN1/PoE port on the bridge.
- (2) Connect one end of the Ethernet cable to the LAN2 or LAN3 port on the bridge, and the other end to an IP camera.

Figure 3-6 Connect the Ethernet cable to a PoE switch

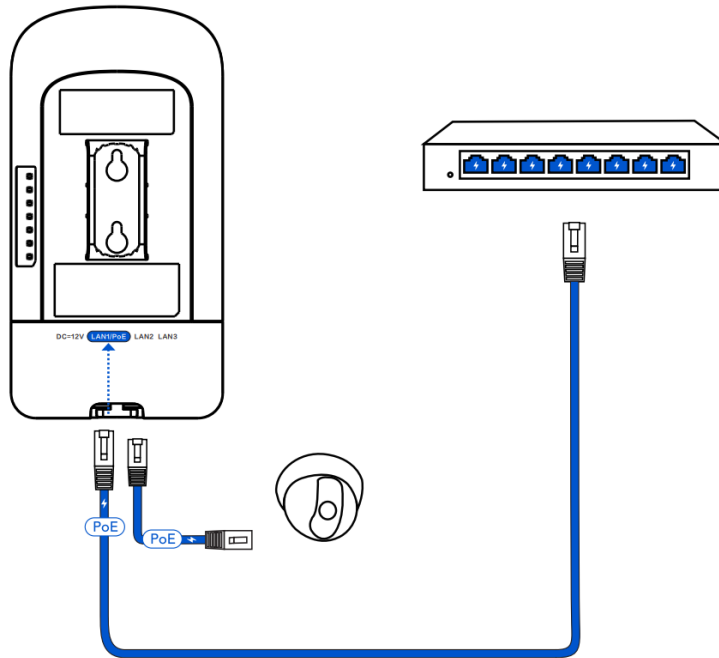

3.5 Verifying the Installation

- (1) Checking the Bridge
 - Verify that the external power supply meets the requirement of the wireless bridge.
 - Verify that the wireless bridge is securely fastened.
- (2) Checking the Power Supply
 - Verify that the power cord is properly connected and meets safety requirements.
 - Connect the power supply to the bridge and verify that it works properly.

4 Debugging

4.1 Powering On

- (1) Checklist Before Power-on
 - The power cord is properly connected.
 - The power voltage meets the requirement.
- (2) Recommended: After the bridge is powered on, check whether the LED status is normal.

4.2 Configuring the Bridge

- Method 1: Configure the bridge through Ruijie Reyee App

- (1) The power cord is properly connected.
- (2) Scan the QR code on this page or on the device to download and install Ruijie Reyee App.



- (3) Log in to Ruijie Reyee App.

- Method 2: Log in to eWeb for configuration

- (1) Connect the LAN port of the wireless bridge to a PC using an Ethernet cable for wired connection, or connect your smartphone or PC to the device's SSID (default SSID: @Ruijie-bxxxx) for wireless connection.
- (2) Enter **10.44.77.254** in a browser to access the device's eWeb.
- (3) Enter the device password (default password: admin) and click **Login** to log in to eWeb for configuration.

⚠ Caution

- Enter the initial password **admin** to log in and begin configuration.
 - To ensure device security, set a password after login and change the password regularly.
-

5 Monitoring and Maintenance

5.1 Monitoring

You can observe the LEDs to monitor the device in operation.

5.2 Hardware Maintenance

If the hardware is faulty, please contact Ruijie Networks technical support.

6 Common Troubleshooting

6.1 Troubleshooting Flowchart

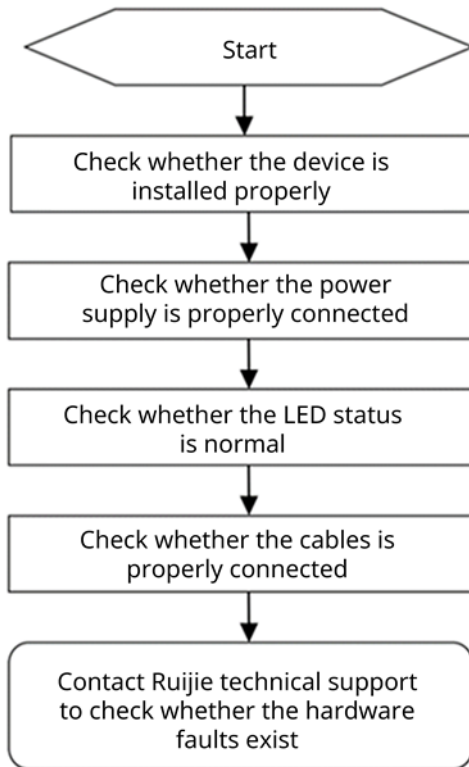

7 Appendix

7.1 Connectors and Media

1000BASE-T/100BASE-TX/10BASE-T Port

The 1000BASE-T/100BASE-TX/10BASE-T is a 10/100/1000 Mbps port that supports auto MDI/MDIX Crossover. Compliant with IEEE 802.3ab, 1000BASE-T requires Cat5e 100-ohm UTP or STP (STP is recommended) with a maximum distance of 100 meters (328 ft.).

The 1000BASE-T port requires all four pairs of wires to be connected for data transmission. [Figure 7-1](#) shows the connection of four twisted pairs of a 1000BASE-T port.

Figure 7-1 1000BASE-T Twisted Pair Connections

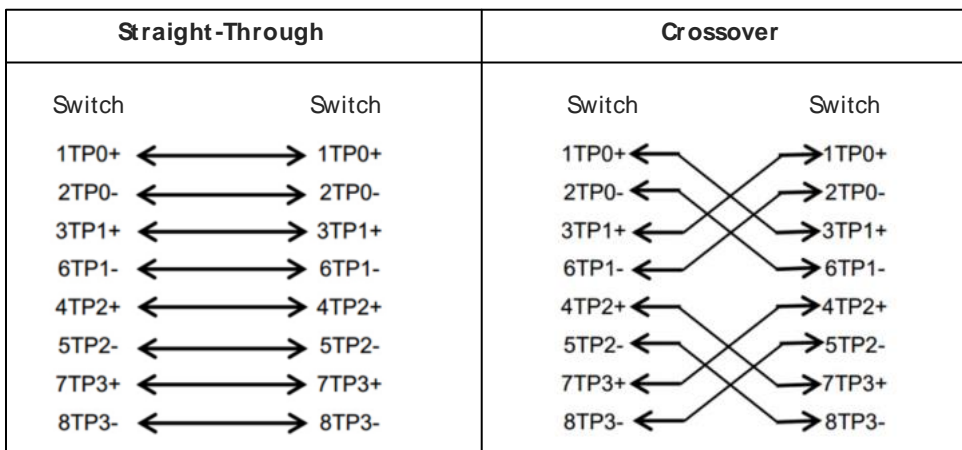

A 100BASE-TX/10BASE-T port can be interconnected using cables of the preceding specifications. For 10 Mbps, the 100BASE-TX/10BASE-T port can be connected using 100-ohm Category 3, Category 4, and Category 5 cables; for 100 Mbps, the 100BASE-TX/10BASE-T port can be connected using 100-ohm Category 5 cables with a maximum connection distance of 100 meters (328 ft.). [Table 7-1](#) lists 100BASE-TX/10BASE-T pin assignments.

Table 7-1 100BASE-TX/10BASE-T Pin Assignments

Pin	Socket	Plug
1	Input Receive Data+	Output Transmit Data+
2	Input Receive Data-	Output Transmit Data-
3	Output Transmit Data+	Input Receive Data+
6	Output Transmit Data-	Input Receive Data-
4, 5, 7, 8	Not Used	Not Used

[Figure 7-2](#) shows feasible connections of the straight-through and crossover twisted pairs for a 100BASE-TX/10BASE-T port.

Figure 7-2 100BASE-TX/10BASE-T Twisted Pair Connections

