



CONNECTORS

MEASURING INSTRUMENTS

Pressure Gauge T-Piece	77
Pressure Gauge TC 25.0, connection below	78
Pressure Gauge TC 25.0, connection behind	79
Pressure Gauge TC 50.5, connection below	80
Pressure Gauge TC 50.5, connection behind	81
In-line Seal	82
In-line Seal - supplement sheet	83
Pressure Transducer for TC 25.0.....	84
Pressure Transducer for TC 50.5.....	85



Pressure Gauge T-Piece

Product group:	Measuring instruments
Description:	Pressure Gauge T-Piece
Valid standards:	Connectors-Standard, DIN 32676 Series B (ISO 1127)
Materials:	Stnr.-W. 1.4435 BN2 (Fe < 0.5%) acc. EN 10088
Permissible sterilization temperature:	150°C
Version / Surface quality:	Surface, internal and external bright finish Ra, internal < 0.4 µm
Pipe-Hygiene Classes:	H 3 / H 4 acc. DIN 11865
Marking:	Size, material number, melt number, manufacturer code
Certificate:	Certificate acc. EN 10204-3.1
Option:	Electropolishing
Remarks:	Technical contents are subject to change Further dimensions available on request.

Dimensions for Pressure Gauge T-Piece									
Sizes	AD	S1	A	ID	L	T	H	Item No.	
acc. ISO 2852 / ISO 1127									
ISO DN 15	21.3	1.6	25.0	16.0	60.0	16.0	22.70	253.213.025	
ISO DN 20	26.9	1.6	25.0	16.0	60.0	16.0	25.50	253.269.025	
ISO DN 25	33.7	2.0	25.0	16.0	60.0	16.0	28.80	253.337.025	
ISO DN 40	48.3	2.0	25.0	16.0	60.0	16.0	36.10	253.482.025	

The technical drawing shows a cross-section of a T-piece. The main vertical pipe has an outer diameter AD and a wall thickness S1. The horizontal gauge connection has an inner diameter ID and a total height A. The gauge connection is attached to the side of the main pipe, with a distance L from the top of the main pipe to the top of the gauge connection. The gauge connection has a thickness T and a distance H from the bottom of the main pipe to the bottom of the gauge connection.

All lengths in millimeters (if not specified differently).

Pressure Gauge TC 25.0, Connection Below

Product group:	Measuring instruments
Description:	Pressure Gauge TC 25.0, connection below
Valid standards:	TC acc. DIN 32676
Materials:	Diaphragm: Strn.-W. 1.4435 acc. EN 10088-3 (AISI 316 L) Case: CrNi steel (AISI 316 L), connector: 1.4435 BN2
Diaphragm filling liquid:	KN 7 Glycerin (FDA 21 CFR 182.1320)
Accuracy class without diaphragm seal:	1.6
Accuracy class, with diaphragm seal:	2.5 at 20°C
Permissible sterilization temperature:	121°C
Permitted vacuum:	Acc. to measuring range
Version / Surface quality:	Surface, internal and external bright finish Ra, internal < 0.8 µm
Marking:	Material number, melt number Serial number on face
Optional extras:	Inspection Certificate for parts in contact with product: 2.2 or 3.1 acc. EN 10204 Option: calibration 5 or 10 measured points (990.000.004.3, 990.000.004.4) Other Measuring ranges and pressure gauge displays with Circumference 100 mm available on request
Remarks:	Technical contents are subject to change

Dimensions for Pressure Gauge TC 25.0, connection below			
Model	Measuring ranges	A	Item No.
MDM 05 - 3 U	-1 to + 3 bar	25.0	280.005.003
MDM 05 - 6 U	-1 to + 6 bar	25.0	280.005.006
MDM 05 - 9 U	-1 to + 9 bar	25.0	280.005.009
MDM 05 - 25 U	0 to + 25 bar	25.0	280.005.025
MDM 05 - 40 U	0 to + 40 bar	25.0	280.005.040
MDM 05 - 45 PSI	-15 to + 45 PSI	25.0	282.005.045
MDM 05 - 75 PSI	-15 to + 75 PSI	25.0	282.005.075
MDM 05 - 100 PSI	-15 to + 100 PSI	25.0	282.005.100

The drawing shows a front view of the pressure gauge. The main body is circular with a diameter of 63.0 mm. The total height from the base to the top of the gauge is 105.0 mm. The diameter of the base is labeled as 'A'.

Pressure Gauge TC 25.0, Connection Behind

Product group:	Measuring instruments
Description:	Pressure Gauge TC 25.0, connection behind
Valid standards:	TC acc. DIN 32676
Materials:	Diaphragm: Strn.-W. 1.4435 acc. EN 10088-3 (AISI 316 L) Housing: CrNi steel, supports: 1.4435 BN2
Diaphragm filling liquid:	KN 7 Glycerin (FDA 21 CFR 182.1320)
Accuracy class without diaphragm seal:	1.6
Accuracy class, with diaphragm seal:	2.5 at 20°C
Permissible sterilization temperature:	121°C
Permitted vacuum:	Acc. measuring ranges
Version / Surface quality:	Surface, internal and external bright finish Ra, internal < 0.8 µm
Markings:	Size, material number, melt number Serial number on face
Optional extras:	Inspection Certificate for parts in contact with product: 2.2 or 3.1 acc. EN 10204 Option: calibration 5 or 10 measured points (990.000.004.3, 990.000.004.4) Other Measuring ranges and pressure gauge displays with Circumference 100 mm available on request
Remarks:	Technical contents are subject to change

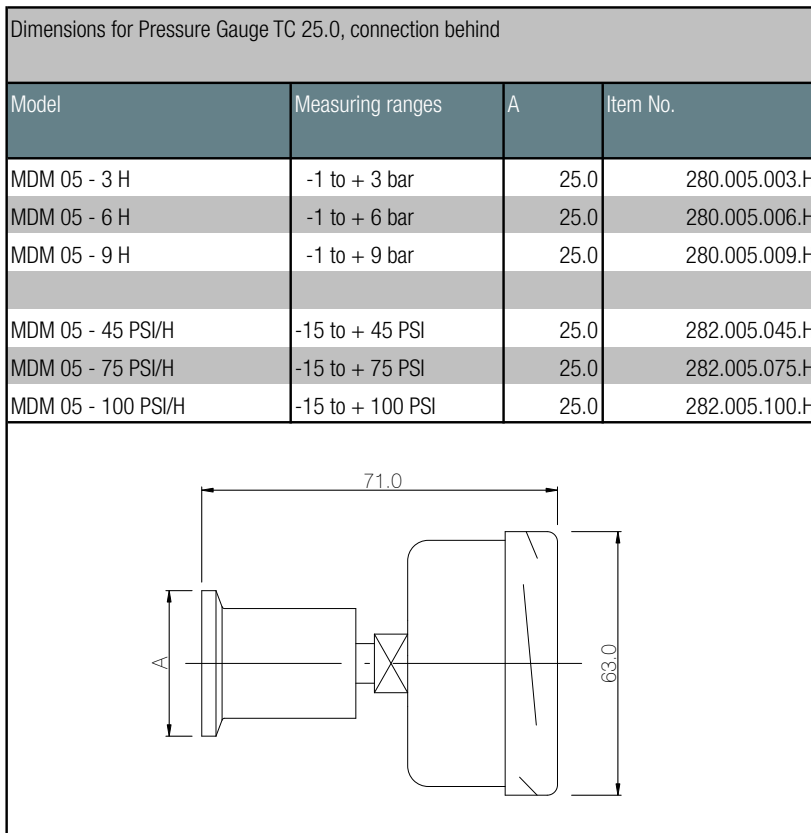

All lengths in millimeters (if not specified differently).

Pressure Gauge TC 50.5, Connection Below

Product group:	Measuring instruments
Description:	Pressure Gauge TC 50.5, below connection
Valid standards:	TC acc. DIN 32676
Materials:	Diaphragm: Stnr.-W. 1.4435 acc. EN 10088-3 (AISI 316 L)
Housing:	CrNi steel, supports: 1.4435 BN2
Diaphragm filling liquid:	KN 7 Glycerin (FDA 21 CFR 182.1320)
Accuracy class, without diaphragm seal:	1.6
Accuracy class, assembled with diaphragm:	2.5 at 20°C
Permissible sterilization temperature:	121°C
Permitted vacuum:	Acc. measuring ranges
Version / Surface quality:	Surface, internal and external bright finish Ra, internal < 0.8 µm
Marking:	Size, material number, melt number Serial number on face
Optional extras:	Inspection Certificate for parts in contact with product: 2.2 or 3.1 acc. EN 10204 Option: calibration 5 or 10 measured points (990.000.004.3, 990.000.004.4) Other pressure ranges and pressure gauge displays with Circumference 100 mm available on request
Remarks:	Technical contents are subject to change

Dimensions for Pressure Gauge TC 50.5, connection below			
Model	Measuring ranges	A	Item No.
MDM 15 - 3 U	-1 to + 3 bar	50.5	280.015.003
MDM 15 - 6 U	-1 to + 6 bar	50.5	280.015.006
MDM 15 - 9 U	-1 to + 9 bar	50.5	280.015.009
MDM 15 - 25 U	0 to + 25 bar	50.5	280.015.025
MDM 15 - 40 U	0 to + 40 bar	50.5	280.015.040

The drawing shows a front view of the pressure gauge. The dial is circular with a diameter of 63.0 mm. The total height of the gauge, including the base, is 105.0 mm. The base has a diameter labeled 'A'.

Pressure Gauge TC 50.5, Connection Behind

Product group:	Measuring instruments
Description:	Pressure Gauge TC 50.5, connection behind
Valid standards:	TC acc. DIN 32676
Materials:	Diaphragm: Stnr.-W. 1.4435 acc. EN 10088-3 (AISI 316 L) Housing: CrNi steel, supports: 1.4435 BN2
Diaphragm filling liquid:	KN 7 Glycerin (FDA 21 CFR 182.1320)
Accuracy class, without diaphragm seal:	1.6
Accuracy class, with diaphragm seal:	2.5 at 20°C
Permissible sterilization temperature:	121°C
Permitted vacuum:	Acc. measuring range
Version / Surface quality:	Surface, internal and external bright finish Ra, internal < 0.8 µm
Markings:	Size, material number, melt number Serial number on face
Optional extras:	Inspection Certificate for parts in contact with product: 2.2 or 3.1 acc. EN 10204 Option: calibration 5 or 10 measured points (990.000.004.3, 990.000.004.4) Other Measuring ranges and pressure gauge displays with Circumference 100 mm available on request
Remarks:	Technical contents are subject to change

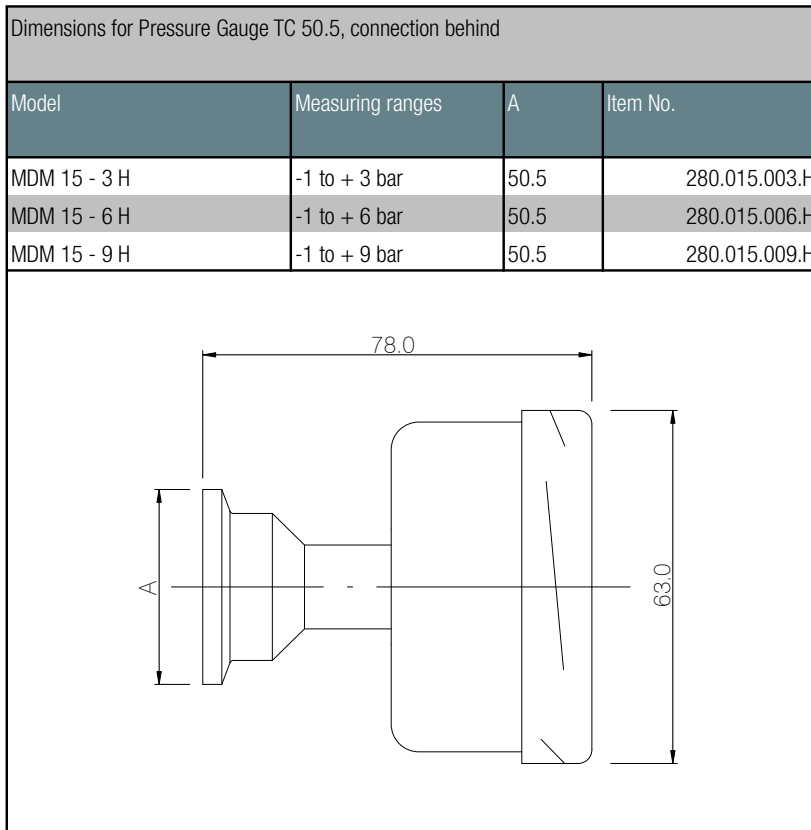

All lengths in millimeters (if not specified differently).

In-line Seal

Product group:	Measuring Instruments
Description:	Tri-Clamp In-line Seal
Valid standards:	TC acc. DIN 32676
Materials:	Diaphragm: Strn.-W. 1.4435 acc. EN 10088-3 welded on body. Housing: CrNi steel, supports: 1.4435 BN2
Filling medium:	KN 7 Glycerin (FDA 21 CFR 182.1320)
Accuracy class, without diaphragm seal:	1.6
Accuracy class, with diaphragm seal:	2.5
Permitted Pressure:	Acc. measuring range
Permissible sterilization temperature:	121°C
Permitted vacuum:	Acc. measuring range
Version / Surface quality:	Surfaces, internal: thin-walled diaphragm welded on body Surfaces, external bright finish, Ra on the medium side < 0.8 µm
Markings:	Size, material number, melt number, manufacturer code Serial number on dial
Optional extras:	Inspection Certificate for parts in contact with product: 2.2 oder 3.1 acc. EN 10204 Option: calibration 5 or 10 measured points (990.000.004.3, 990.000.004.4) In-line seal with 50.5mm clamp connection or with integrated temperature measurement available on request
Remarks:	Technical contents are subject to change

Dimensions for Tri-Clamp In-line seal				
Model	Measuring ranges	A	Size of connection (ID)	Item No.
RDM 05 - 6	-1 to + 6 bar	25.0	10	283.005.006.SP
RDM 05 - 9	-1 to + 9 bar	25.0	10	283.005.009.SP
RDM 05 - 25	0 to + 25 bar	25.0	10	283.005.025.SP
RDM 05 - 40	0 to + 40 bar	25.0	10	283.005.040.SP
RDM 05 - 3	-1 to + 3 bar	25.0	16	283.005.003
RDM 05 - 6	-1 to + 6 bar	25.0	16	283.005.006
RDM 05 - 9	-1 to + 9 bar	25.0	16	283.005.009
RDM 05 - 25	0 to + 25 bar	25.0	16	283.005.025
RDM 05 - 40	0 to + 40 bar	25.0	16	283.005.040

In-Line Seal - supplement sheet

Product group:	Measuring instruments
Description:	Tri-Clamp In-line Seal
Application and construction:	<p>The in-line seal is ideally suited for applications with flowing and highly viscous measuring media. Since it is completely integrated into the process line, there are no disturbing turbulences, corners, dead spaces or other obstructions in the direction of flow. The medium can flow without hindrance and thus effects the self-cleaning of the measuring chamber.</p> <p>The diaphragm seal is manufactured from a cylindric jacket section, into which a thin-walled diaphragm is welded in.</p>
Assembly:	The in-line seal is clamped between two clamp connections directly in the pipeline, so that there is no need for any special measuring point connections.
Optional extras:	<p>In-line seal with clamp connection 50.5 mm available on request.</p> <p>In-line seal with integrated temperature measurement available on request.</p>

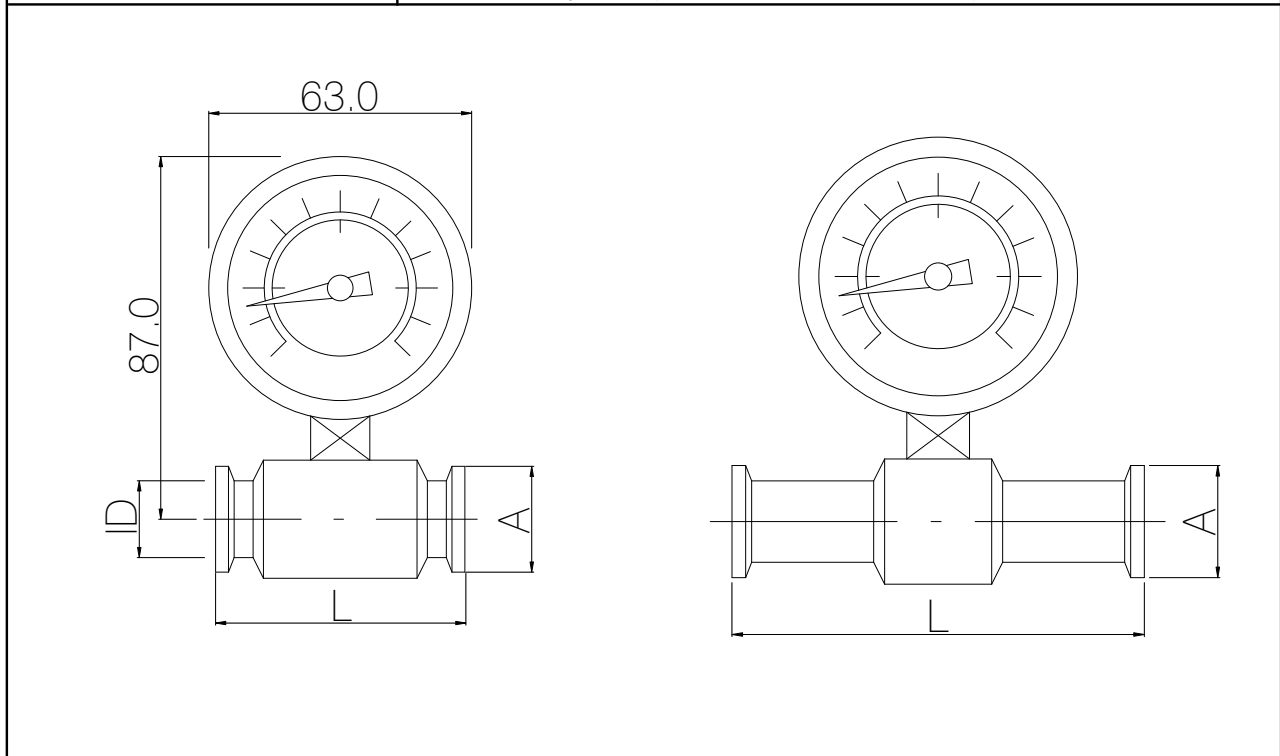

All lengths in millimeters (if not specified differently).

Pressure Transducer for TC 25.0

Product group:	Measuring instruments
Description:	Pressure Transducer for TC 25.0
Valid standards:	TC acc. DIN 32676
Materials:	Support material: 1.4435, diaphragm, parts in contact with medium, and housing: CrNi steel Cap: Plastic All parts in contact with medium: CrNi steel manufactured and completely welded
Outlet signal:	As standard available with 4...20 mA 2-wire outlet signal
Option:	0...5 V: 3-wire, 0...10 V: 3-wire
Voltage signals:	4...20 mA and 0...5 V (power supply: 10...30 V), 0...10 V (power supply: 14...30 V) Other signals available on request
Pressure ranges:	Acc. table
Ingress protection:	IP 65
Optional extras:	Inspection Certificate for parts in contact with product: 2.2 or 3.1 acc. EN 10204 Option: calibration 5 or 10 measured points (990.000.004.3, 990.000.004.4) Digital indicator without external supply for direct connection to Pressure Transducer available on request Tested version (ATEX) available on request
Remarks:	Technical contents are subject to change

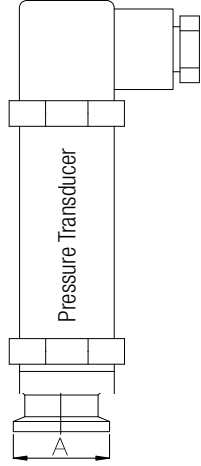
Dimensions to Pressure Transducer for TC 25.0				
Model	Measuring ranges	A	Item No.	
MDM-D 05 - 3	-1 to + 3 bar	25.0	282.005.003	
MDM-D 05 - 6	-1 to + 6 bar	25.0	282.005.006	
MDM-D 05 - 9	-1 to + 9 bar	25.0	282.005.009	
MDM-D 05 - 25	0 to + 25 bar	25.0	282.005.025	
MDM-D 05 - 40	0 to + 40 bar	25.0	282.005.040	

Pressure Transducer for TC 50.5

Product group:	Measuring Instruments
Description:	Pressure Transducer for TC 50.5
Valid standards:	TC acc. DIN 32676
Materials:	Support material: 1.4435, diaphragm, parts in contact with medium and housing: CrNi steel Cap: Plastic All parts in contact with medium: CrNi steel manufactured and completely welded
Outlet signal:	As standard available with 4...20 mA 2-wire outlet signal
Option:	0...5 V: 3-wire, 0...10 V: 3-wire
Voltage signals:	4...20 mA and 0...5 V (power supply: 10...30 V), 0...10 V (power supply: 14...30 V) Other signals available on request
Pressure ranges:	Acc. table
Ingress protection:	IP 65
Options:	Inspection Certificate for parts in contact with product: 2.2 or 3.1 acc. EN 10204 Option: calibration 5 or 10 measured points (990.000.004.3, 990.000.004.4) Digital indicator without external supply for direct connection to Pressure Transducer available on request Tested version (ATEX) available on request
Remarks:	Technical contents are subject to change

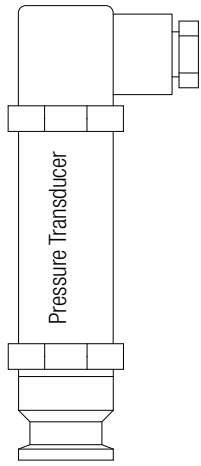
Dimensions for TC 50.5				
Type	Measuring ranges	A	Item No.	
MDM-D 05 - 3	-1 to + 3 bar	50.5	282.015.003	
MDM-D 05 - 6	-1 to + 6 bar	50.5	282.015.006	
MDM-D 05 - 9	-1 to + 9 bar	50.5	282.015.009	
MDM-D 05 - 25	0 to + 25 bar	50.5	282.015.025	
MDM-D 05 - 40	0 to + 40 bar	50.5	282.015.040	

All lengths in millimeters (if not specified differently).