



▪ **QUICK SELECTION** / Selezione veloce

input speed (n_1) = 1400 min⁻¹

Output Speed n_2 [min ⁻¹]	Ratio i	Motor power P_{1M} [kW]	Output torque M_{2M} [Nm]	Service factor f.s.	Nominal power P_{1R} [kW]	Nominal torque M_{2R} [Nm]	B5 motor flanges not available		Available B14 motor flanges			Dynamic efficiency RD	Tooth Module Mn [mm]	Ratios code
							-	-	Q	R	T			
200	7	1.8	71	1.7	3.0	119			B-C	B-C		83	3.1	01
140	10	1.8	99	1.3	2.3	128			B-C	B-C		81	3.1	02
93	15	1.5	121	1.1	1.6	131			B-C	B-C		79	3.1	03
74	19	1.1	111	1.2	1.3	131			B-C	B-C		78	2.6	04
58	24	1.1	135	1.0	1.1	135			B-C	B-C		75	2.0	05
47	30	1.1	167	0.8	0.92	139			B-C	B-C		74	3.2	06
39	36	0.75	125	1.1	0.84	140			B-C	B-C		68	2.7	07
31	45	0.55	111	1.2	0.63	129			B-C	C		66	2.1	08
21	67	0.55	151	0.8	0.43	118			B-C	C		60	1.5	09
17.5	80	0.37	115	1.0	0.36	113			B-C	C		57	1.3	10
14.9	94	0.37	123	0.9	0.34	113			B-C	C		52	1.1	11

Motor Flanges Available
Flange Motore Disponibili

B) Supplied with Reduction Bushing
Fornito con Bussola di Riduzione

B) Available on Request without reduction bushing
Disponibile a Richiesta senza Bussola di Riduzione

C) Motor Flange Holes Position
Posizione Fori Flangia Motore

EN Unit I63 is supplied with synthetic oil, providing "long life" lubrication. For mounting position V5-V6 please contact us. See table 1 for lubrication and recommended quantity. In table 2 please see possible radial loads and axial loads on the gearbox. For complete documentation please visit our web site.

I Il riduttore tipo I63 viene fornito lubrificato a vita con olio sintetico. Per posizioni V5-V6 contattare il ns. servizio tecnico. Vedi tab.1 per oli e quantità consigliati. In tab.2 sono presenti i carichi radiali e assiali applicabili al riduttore. Per la documentazione completa consulta il nostro sito.

D Für die Lebensdauerschmierung ist das Getriebe der Größe I63 mit synthetischem Öl befüllt. Bei Einbaulage V5 oder V6 bitten wir um Rücksprache. In Tabelle 1 ist die Schmiermenge und das empfohlene Schmiermittel angegeben. In Tabelle 2 sind die zulässigen Radial- und Axialbelastungen des Getriebes aufgeführt. Die komplette Dokumentation, Wartungs- und Inbetriebnahmeanleitungen finden Sie unter.

E El reductor tamaño I63 se suministra, lubricado de por vida con aceite sintético. Para las posiciones V5 y V6 contactar con nuestro servicio técnico. Ver tabla 1, para cantidades y aceites recomendados. En la tabla 2, se encuentran las cargas radiales y axiales admitidas por el reductor. Para documentación completa, consultar nuestra Web.

Standard	On request				
0.98 LT	0.69 LT	0.69 LT	0.98 LT	0.98 LT	0.98 LT
AGIP	KLUBER		SHELL	MOBIL	
Telium VSF 320	Syntheso D220 EP		Tivela Oil WB	Glygoyl 30 SHC 630	

tab. 1

▪ RADIAL AND AXIAL LOADS			
Output shaft Albero di uscita	n_2	FA	FR
	200	360	1800
	150	400	2000
	100	460	2300
	75	500	2500
	50	600	3000
	25	700	3800
	15	800	4000

tab. 2

▪ **SELECT THIS TYPE AND THIS SPECIFIC SIZE ON THE WEB PAGES TO GET COMPLETE TECHNICAL DATA.**
Selezionare tipo e gandezza specifica nel sito web per la documentazione completa.

Gearbox weight
peso riduttore **14.6 kg**

PI63UN... Basic wormbox
Riduttore base

M. flanges	Kit code	øF	A
71B14	KI63.4.047	105	97
80B14	KI63.4.046	120	98
90B14	KI63.4.041	140	99

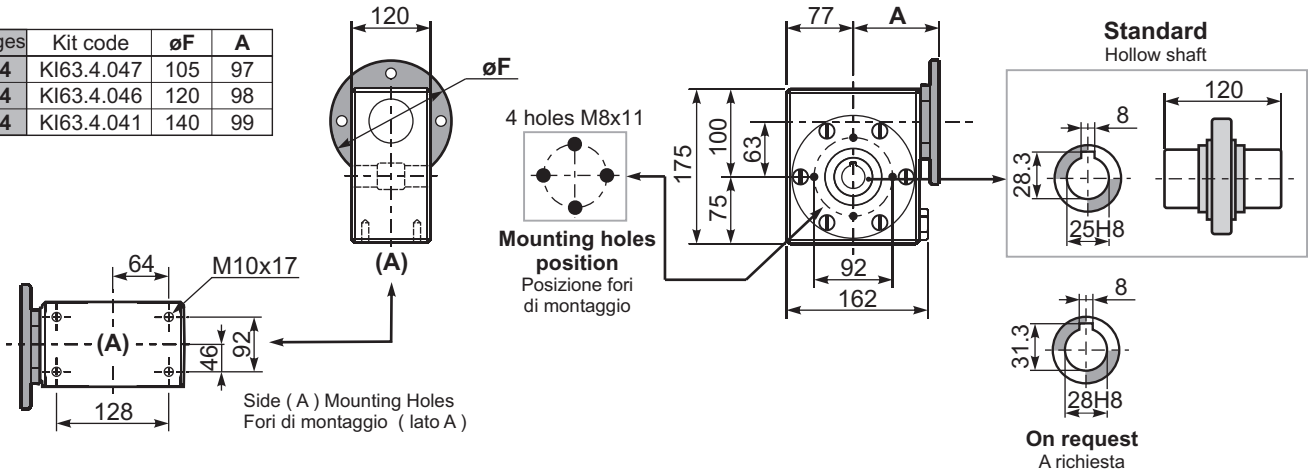

BI63UN... Modular base
Base modulare

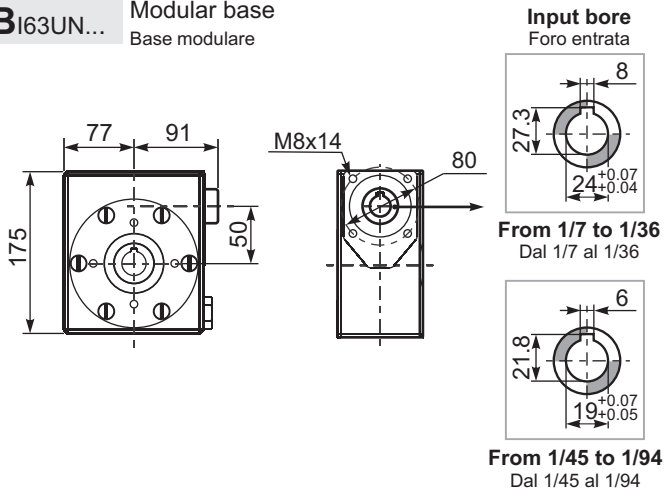

PI63FL... Output flange
Flangia uscita

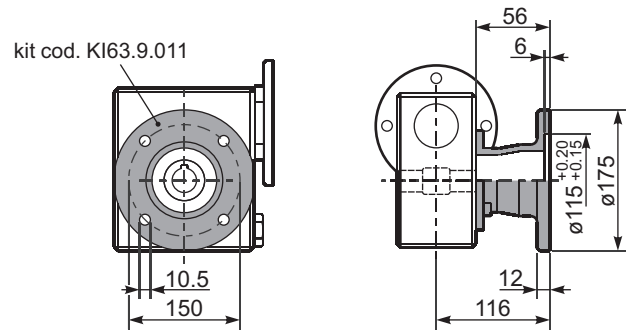

PI63BR... Reaction arm
Braccio di reazione

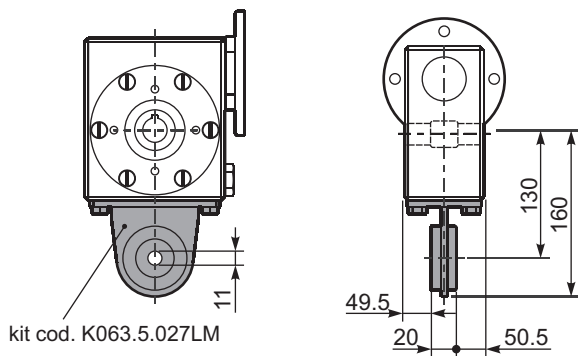

PI63.....S... Single Shaft
Albero lento semplice

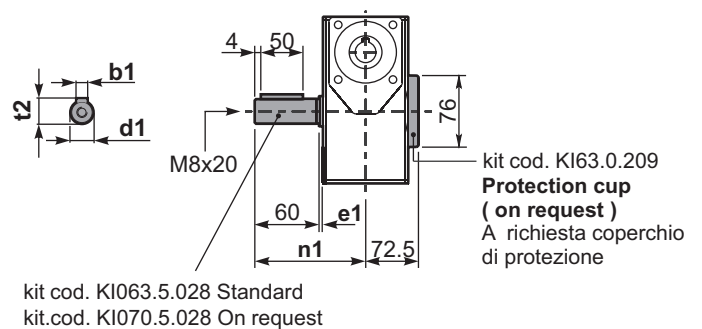

	b1	e1	d1	n1	t2
Standard	8	3.2	25 ^{-0.005} _{-0.020}	121.9	28
On request	8	3.5	28 ^{-0.005} _{-0.020}	122.2	31