



QUICK SELECTION / Selezione veloce

input speed (n_1) = 1400 min⁻¹

Output Speed n_2 [min ⁻¹]	Ratio i	Motor power P_{1M} [kW]	Output torque M_{2M} [Nm]	Service factor f.s.	Nominal power P_{1R} [kW]	Nominal torque M_{2R} [Nm]	Available B5 motor flanges				Available B14 motor flanges				Output Shaft 	Ratios code 	
							C	D	E	F	R	T	U	V			
							71	80	90	100 112	80	90	100 112	132			
225	6.21	7.5	305	1.0	7.9	320	B								3018	standard ø40 On request ø35	-
196	7.15	7.5	351	1.0	7.9	369	B								3016		
168	8.36	7.5	410	1.0	7.9	431	B								3014		
120	11.71	7.5	575	1.0	7.6	585	B								2018		
104	13.48	5.5	485	1.3	7.0	620	B								2016		
89	15.75	5.5	567	1.1	6.0	617	B								2014		
77	18.22	4	477	1.3	5.2	620	B								1616		
68	20.58	4	539	1.1	4.2	566	B								1318		
66	21.29	4	558	1.1	4.4	617	B								1614		
59	23.69	4	621	1.0	4.0	620	B								1316		
51	27.69	3	544	1.1	3.4	617	B								1314		
48.3	29.00	3	570	1.0	3.1	580	B								1116		
41.3	33.90	3	666	0.9	2.8	617	B								1114		
38.4	36.43	2.2	525	1.0	2.3	550	B								818		
33.4	41.94	1.5	412	1.5	2.3	620	B								816		
28.6	49.02	1.5	481	1.3	1.9	617	B								814		
24.2	57.75	1.1	416	1.1	1.2	440	B								616		
20.7	67.50	1.1	486	1.0	1.1	507	B								614		

The dynamic efficiency is **0.96** for all ratios

A Motor Flanges Available
Flange Motore Disponibili

B Supplied with Reduction Bushing
Fornito con Bussola di Riduzione

B Available on Request without reduction bushing
Disponibile a Richiesta senza Bussola di Riduzione

C Motor Flange Holes Position
Posizione Fori Flangia Motore

EN Unit **F62C** is supplied with synthetic oil for lifetime lubrication, no maintenance is necessary. See table 1 for lubrication and recommended quantity. In table 2 please see possible radial loads and axial loads on the gearbox.
For complete documentation please visit our web site.

I Il riduttore **F62C** viene fornito completo di olio sintetico per la lubrificazione permanente e non necessita di alcuna manutenzione. Vedi tab.1 per oli e quantità consigliati. In tab.2 sono presenti i carichi radiali e assiali applicabili al riduttore.
Per la documentazione completa consulta il nostro sito.

D Das Getriebe **F62C** ist mit synthetischem Öl gefüllt und ist lebensdauergeschmiert. In Tabelle 1 ist die Schmiermenge und das empfohlene Schmiermittel angegeben. In Tabelle 2 sind die zulässigen Radial- und Axialbelastungen des Getriebes aufgeführt. Die komplette Dokumentation, Wartungs- und Inbetriebnahmeanleitungen finden Sie unter.

E El reductor tamaño **F62C** se suministra, lubricado de por vida con aceite sintético y no requieren mantenimiento alguna. Ver tabla 1, para cantidades y aceites recomendados. En la tabla 2, se encuentran las cargas radiales y axiales admitidas por el reductor.
Para documentación completa, consultar nuestra Web.

Standard supplied	For these mounting position specify in the order or add oil Per queste posizioni specificare in fase d'ordine o aggiungere olio				
1.90 LT	1.40 LT	1.05 LT	1.50 LT	1.90 LT	1.40 LT
AGIP Telium VSF 320	BP Energol SGXP220	SHELL Tivela Oil WB	KLUBER Syntheso D220 EP	MOBIL Glygoyle 30	

tab. 1

Output shaft
Albero di uscita

$F_{eq} = F_R \cdot \frac{71.5}{x + 41.5}$

n_2	FA	FR	n_2	FA	FR	n_2	FA	FR
200	834	4169	85	1122	5610	15	1430	7150
140	937	4686	70	1188	5940	-	-	-
120	990	4950	40	1430	7150	-	-	-

Input shaft
Albero in entrata

n_1	FA	FR
1400	120	602
900	245	1227
500	385	1925

tab. 2

SELECT THIS TYPE AND THIS SPECIFIC SIZE ON THE WEB PAGES TO GET COMPLETE TECHNICAL DATA.
Selezionare tipo e gandezza specifica nel sito web per la documentazione completa.

PF62CC...

Basic gearbox
Riduttore base

Gearbox weight
peso riduttore **21.8kg**

Motor Flange

Motor Flange	E	L2
71 B5	212.5	321
80/90 B5	214.5	341
100/112B5	214.5	366
80 B14	212.5	301
90 B14	215.5	311
100 B14	212	321
132 B14	245.5	341

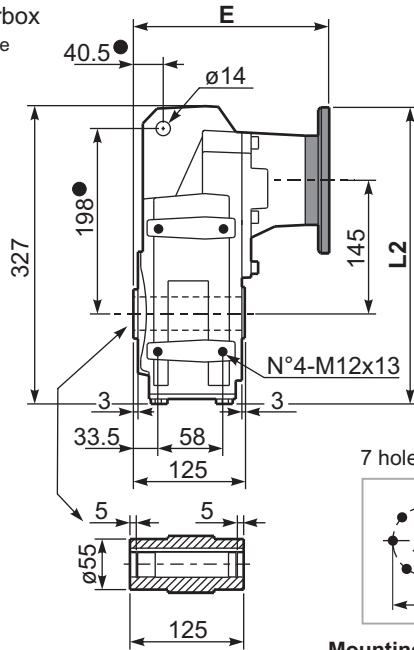

● Available torque arms,
see our web site
Bracci di reazione disponibili,
consulta il nostro sito web

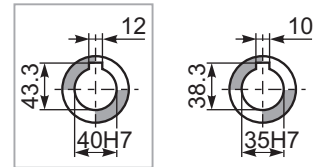
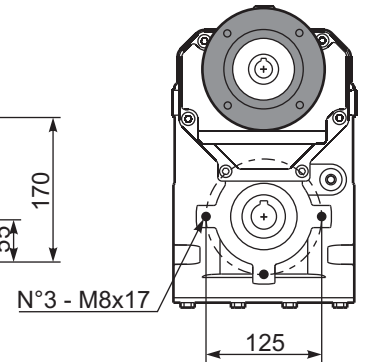
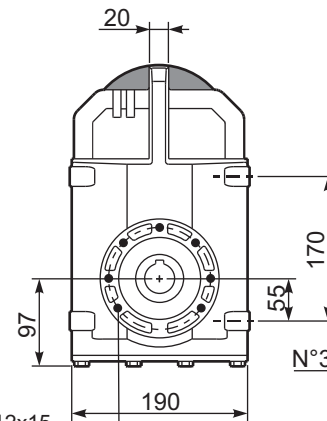
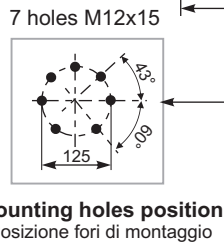

Standard
Hollow shaft
On request
A richiesta

PF62C...-F...

Output flange
Flangia uscita

Motor Flange	K1
71 B5	236
80/90 B5	238
100/112B5	238
80 B14	236
90 B14	239
100/112B14	235.5
132B14	254

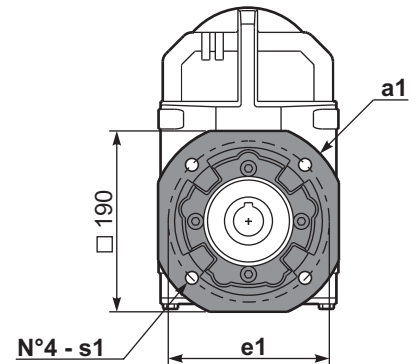
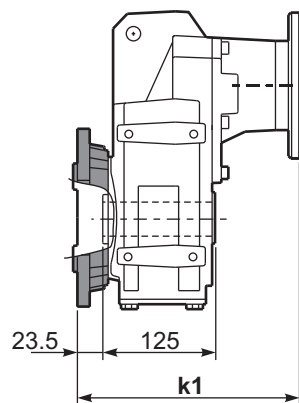
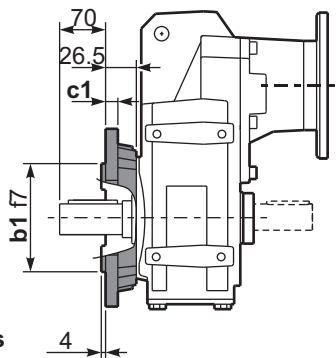

Available output flanges
Flange di uscita

a1 ø	b1	c1	e1	s1	Kit code
200	130	10	165	11	KF60.9.010
250*	180	15	215	13.5	KF60.9.011

* Standard output flange / Flangia uscita standard

RF62CC...

Input Shaft
Albero in entrata

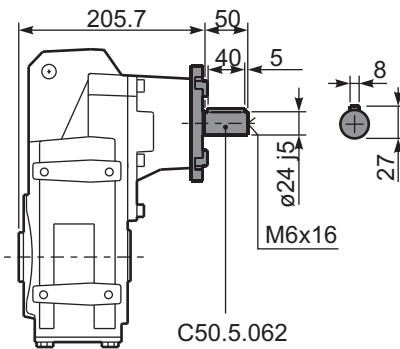

PF62CA/B...

Single and Double output shaft
Albero uscita semplice e doppio

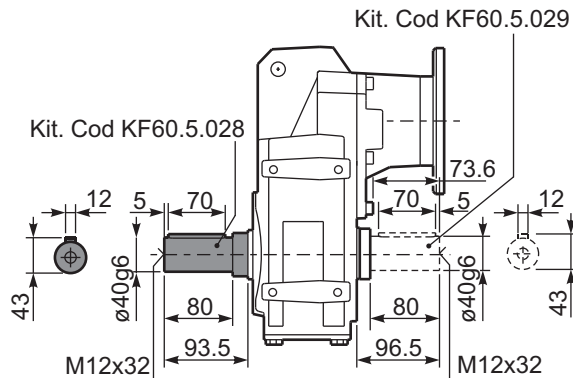

PF62CD/S...

Shrink disk
Calettatore

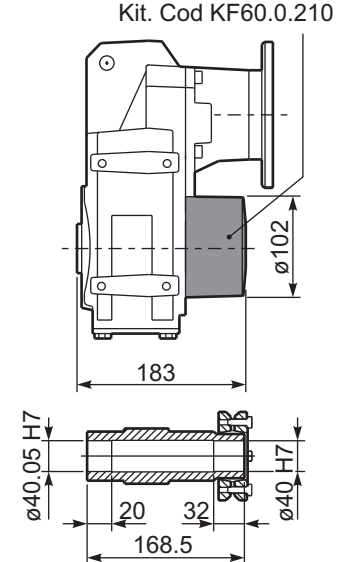

F63C Compact-Gear 670Nm

Rating - Cast Iron SHAFT MOUNTED HELICAL



QUICK SELECTION / Selezione veloce

input speed (n_1) = 1400 min⁻¹

Output Speed n_2 [min ⁻¹]	Ratio i	Motor power P_{1M} [kW]	Output torque M_{2M} [Nm]	Service factor f.s.	Nominal power P_{1R} [kW]	Nominal torque M_{2R} [Nm]	Available B5 motor flanges				Available B14 motor flanges				Output Shaft 	Ratios code 	
							B	C	D	E	Q	R	T	U			
							63	71	80	90	71	80	90	100 112			
37.6	37.23	1.5	354	1.8	2.8	652	B				C	C			281316	standard ø40 On request ø35	-
32.2	43.52	1.5	414	1.6	2.3	648	B				C	C			281314		
23.9	58.49	1.5	557	1.0	1.6	576	B				C	C			191318		
20.8	67.34	1.5	641	1.0	1.53	652	B				C	C			191316		
17.9	78.05	1.1	545	1.2	1.32	652	B				C	C			171316		
15.3	91.61	1.1	639	1.0	1.12	652	B				C	C			151316		
12.8	109.35	0.75	520	1.3	0.94	652	B				C	C			131316		
10.8	129.66	0.75	617	0.9	0.70	576	B				C	C			101318		
9.4	149.26	0.55	521	1.3	0.69	652	B				C	C			101316		
8.3	169.22	0.55	590	1.0	0.54	576	B				C	C			91318		
8.0	174.46	0.55	609	1.1	0.59	648	B				C	C			101314		
7.2	194.80	0.55	680	1.0	0.53	652	B				C	C			91316		
6.1	227.69	0.37	534	1.2	0.45	648	B				C	C			91314		
5.4	257.23	0.37	604	1.1	0.40	652	B				C	C			71316		
4.7	300.66	0.25	477	1.4	0.34	648	B				C	C			71314		

The dynamic efficiency is **0.93** for all ratios

Motor Flanges Available
Flange Motore Disponibili

Supplied with Reduction Bushing
Fornito con Bussola di Riduzione

Available on Request without reduction bushing
Disponibile a Richiesta senza Bussola di Riduzione

Motor Flange Holes Position
Posizione Fori Flangia Motore

EN Unit **F63C** is supplied with synthetic oil for lifetime lubrication, no maintenance is necessary. See table 1 for lubrication and recommended quantity. In table 2 please see possible radial loads and axial loads on the gearbox.
For complete documentation please visit our web site.

I Il riduttore **F63C** viene fornito completo di olio sintetico per la lubrificazione permanente e non necessita di alcuna manutenzione. Vedi tab.1 per oli e quantità consigliati. In tab.2 sono presenti i carichi radiali e assiali applicabili al riduttore.
Per la documentazione completa consulta il nostro sito.

D Das Getriebe **F63C** ist mit synthetischem Öl gefüllt und ist lebensdauergeschmiert. In Tabelle 1 ist die Schmiermenge und das empfohlene Schmiermittel angegeben. In Tabelle 2 sind die zulässigen Radial- und Axialbelastungen des Getriebes aufgeführt. Die komplette Dokumentation, Wartungs- und Inbetriebnahmeanleitungen finden Sie unter.
Inbetriebnahmeanleitungen finden Sie unter.

E El reductor tamaño **F63C** se suministra, lubricado de por vida con aceite sintético y no requieren mantenimiento alguna. Ver tabla 1, para cantidades y aceites recomendados. En la tabla 2, se encuentran las cargas radiales y axiales admitidas por el reductor.
Para documentación completa, consultar nuestra Web.

Standard supplied	For these mounting position specify in the order or add oil Per queste posizioni specificare in fase d'ordine o aggiungere olio				
2.00 LT	1.50 LT	1.15 LT	1.60 LT	2.00 LT	1.50 LT
AGIP Teliun VSF 320	BP Energol SGXP220	SHELL Tivela Oil WB	KLUBER Syntheso D220 EP	MOBIL Glygoyle 30	

tab. 1

Output shaft
Albero di uscita

$F_{eq} = FR \cdot \frac{71.5}{x \cdot 41.5}$

n_2	FA	FR	n_2	FA	FR	n_2	FA	FR
200	834	4169	85	1122	5610	15	1430	7150
140	937	4686	70	1188	5940	-	-	-
120	990	4950	40	1430	7150	-	-	-

Input shaft
Albero in entrata

n_1	FA	FR
1400	120	602
900	245	1227
500	385	1925

tab. 2

SELECT THIS TYPE AND THIS SPECIFIC SIZE ON THE WEB PAGES TO GET COMPLETE TECHNICAL DATA.
Selezionare tipo e gandezza specifica nel sito web per la documentazione completa.

PF63CC... Basic gearbox
Riduttore base

Gearbox weight
peso riduttore **22.0kg**

Motor Flange

Motor Flange	E	L2
63 B5	222.5	312
71 B5	223.5	322
80/90 B5	222.5	342
71 B14	220.5	294.5
80 B14	221.5	302
90 B14	222.5	312
100/112B14	238.5	322

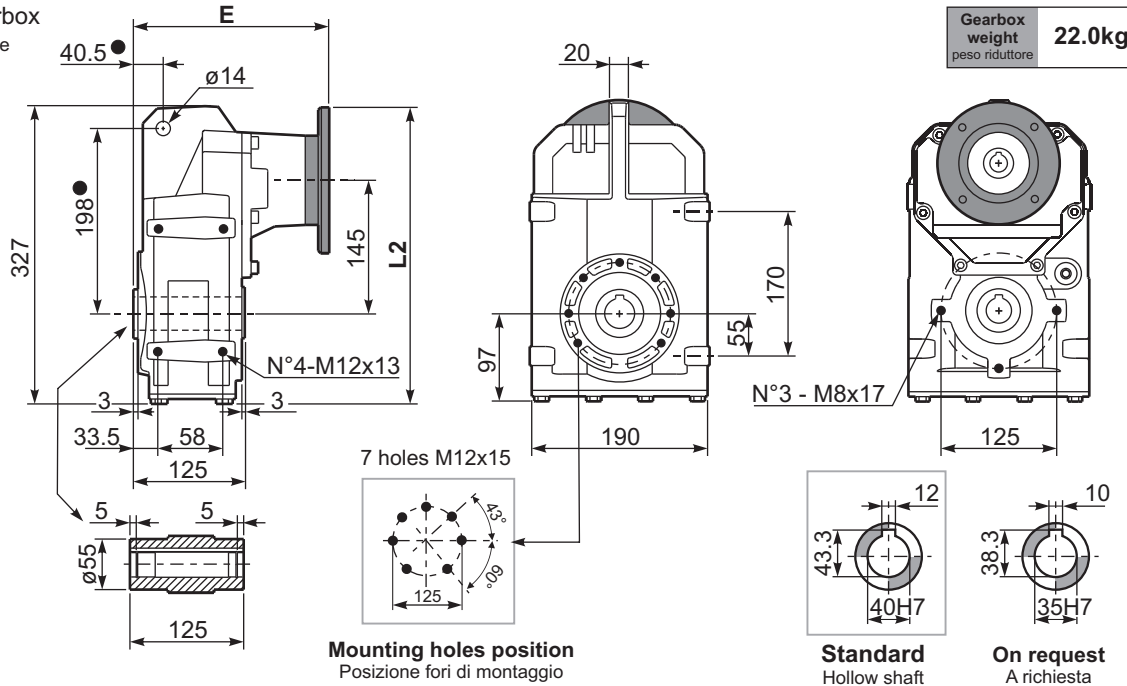

● Available torque arms, see our web site
Bracci di reazione disponibili, consulta il nostro sito web

PF63C...-F... Output flange
Flangia uscita

Motor Flange	k1
63 B5	246
71 B5	247
80/90 B5	246
71 B14	243.5
80 B14	244.5
90 B14	245.5
100/112B14	261.5

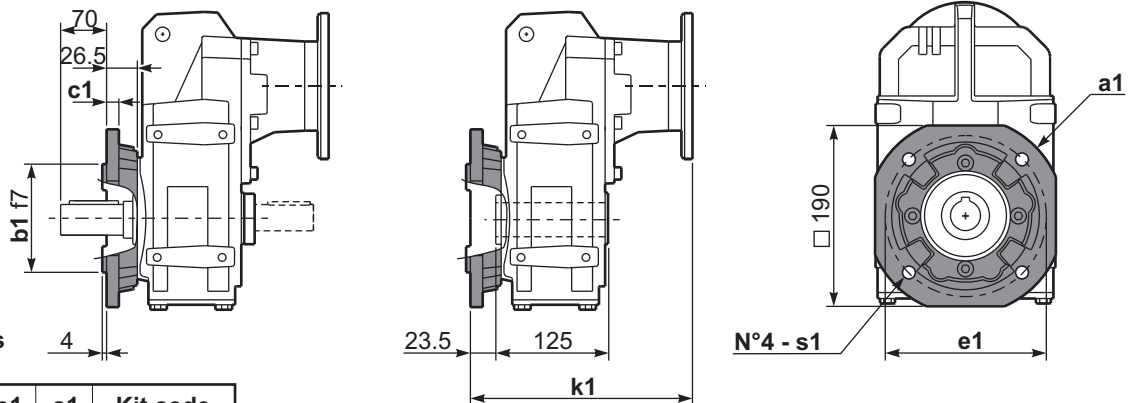

Available output flanges
Flange di uscita

a1 ø	b1	c1	e1	s1	Kit code
200	130	10	165	11	KF60.9.010
250*	180	15	215	13.5	KF60.9.011

* Standard output flange / Flangia uscita standard

RF63CC... Input Shaft
Albero in entrata

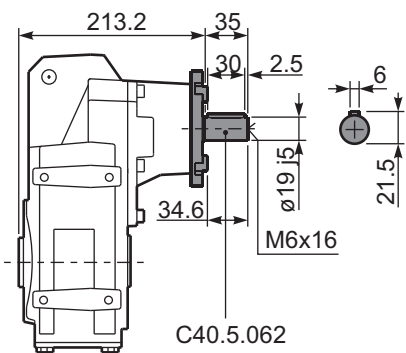

PF63C A/B... Single and Double output shaft
Albero uscita semplice e doppio

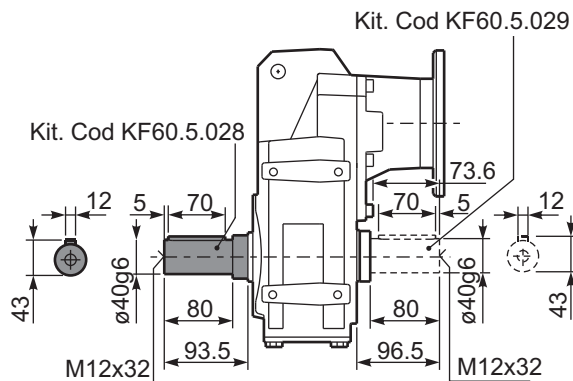

PF63C D/S... Shrink disk
Calettatore

