





QUICK SELECTION / Selezione veloce

input speed (n_1) = 1400 min⁻¹

| Output Speed n_2 [min ⁻¹] | Ratio i | Motor power P_{1M} [kW] | Output torque M_{2M} [Nm] | Service factor $f.s.$ | Nominal power P_{1R} [kW] | Nominal torque M_{2R} [Nm] | Available B5 motor flanges | | | | Available B14 motor flanges | | | | Output Shaft  | Output Shaft  | Ratios code  |
|---|--------------|---------------------------------|-----------------------------------|--------------------------|-----------------------------------|------------------------------------|----------------------------|----|-----|-----|-----------------------------|----|----|------------|---|---|--|
| | | | | | | | B | C | D | E | Q | R | T | U | | | |
| | | | | | | | 63 | 71 | 80* | 90* | 71 | 80 | 90 | 100 112 | | | |
| 398 | 3.52 | 3 | 69 | 1.2 | 3.5 | 80 | B | | | | C | C | | | 2821 | standard ø25 | - |
| 320 | 4.37 | 3 | 86 | 1.0 | 3.1 | 90 | B | | | | C | C | | | 2818 | | |
| 252 | 5.55 | 3 | 109 | 0.9 | 2.8 | 100 | B | | | | C | C | | | 2813 | | |
| 220 | 6.36 | 2.2 | 92 | 1.0 | 2.3 | 95 | B | | | | C | C | | | 1921 | | |
| 191 | 7.33 | 2.2 | 106 | 1.1 | 2.5 | 120 | B | | | | C | C | | | 2812 | | |
| 177 | 7.89 | 2.2 | 114 | 1.1 | 2.3 | 120 | B | | | | C | C | | | 1918 | | |
| 139 | 10.06 | 2.2 | 145 | 1.0 | 2.3 | 150 | B | | | | C | C | | | 1913 | | |
| 120 | 11.66 | 1.5 | 114 | 1.5 | 2.3 | 174 | B | | | | C | C | | | 1713 | | |
| 106 | 13.26 | 1.5 | 130 | 1.2 | 1.8 | 160 | B | | | | C | C | | | 1912 | | |
| 102 | 13.68 | 1.5 | 134 | 1.1 | 1.6 | 144 | B | | | | C | C | | | 1513 | | |
| 91 | 15.37 | 1.5 | 151 | 1.1 | 1.6 | 160 | B | | | | C | C | | | 1712 | | |
| 86 | 16.20 | 1.5 | 159 | 0.9 | 1.3 | 138 | B | | | | C | C | | | 1910 | | |
| 78 | 18.04 | 1.5 | 177 | 0.9 | 1.4 | 160 | B | | | | C | C | | | 1512 | | |
| 74 | 18.80 | 1.1 | 135 | 1.0 | 1.1 | 138 | B | | | | C | C | | | 1710 | | |
| 65 | 21.54 | 1.1 | 155 | 1.0 | 1.1 | 160 | B | | | | C | C | | | 1312 | | |
| 63 | 22.29 | 1.1 | 161 | 1.0 | 1.1 | 167 | B | | | | C | C | | | 1013 | | |
| 53 | 26.30 | 0.75 | 129 | 1.1 | 0.80 | 138 | B | | | | C | C | | | 1310 | | |
| 47.6 | 29.40 | 0.75 | 144 | 1.1 | 0.83 | 160 | B | | | | C | C | | | 1012 | | |
| 39 | 35.91 | 0.55 | 129 | 1.1 | 0.59 | 138 | B | | | | C | C | | | 1010 | | |
| 36.5 | 38.37 | 0.55 | 138 | 1.2 | 0.64 | 160 | B | | | | C | C | | | 912 | | |
| 29.9 | 46.86 | 0.55 | 169 | 0.8 | 0.45 | 138 | B | | | | C | C | | | 910 | | |
| 27.6 | 50.67 | 0.37 | 123 | 1.1 | 0.40 | 132 | B | | | | C | C | | | 712 | | |
| 22.6 | 61.88 | 0.37 | 150 | 0.9 | 0.34 | 138 | B | | | | C | C | | | 710 | | |

The dynamic efficiency is **0.96** for all ratios

*Nel montaggio P la flangia può superare l'ingombro massimo dei piedi. Eventualmente utilizzare la flangia B14
* In the P mounting the B5 motor flange can exceed the foot maximum dimensions. Possibly use the flange B14

A) Motor Flanges Available
Flange Motore Disponibili

B) Supplied with Reduction Bushing
Fornito con Bussola di Riduzione

C) Available on Request without reduction bushing
Disponibile a Richiesta senza Bussola di Riduzione

D) Motor Flange Holes Position
Posizione Fori Flangia Motore

EN Unit **402A** is supplied with synthetic oil for lifetime lubrication, no maintenance is necessary. See table 1 for lubrication and recommended quantity. In table 2 please see possible radial loads and axial loads on the gearbox.
For complete documentation please visit our web site.

I Il riduttore **402A** viene fornito completo di olio sintetico per la lubrificazione permanente e non necessita di alcuna manutenzione. Vedi tab.1 per oli e quantità consigliati. In tab.2 sono presenti i carichi radiali e assiali applicabili al riduttore.
Per la documentazione completa consulta il nostro sito.

D Das Getriebe **402A** ist mit synthetischem Öl gefüllt und ist lebensdauergeschmiert. In Tabelle 1 ist die Schmiermenge und das empfohlene Schmiermittel angegeben. In Tabelle 2 sind die zulässigen Radial- und Axialbelastungen des Getriebes aufgeführt. Die komplette Dokumentation, Wartungs- und Inbetriebnahmeanleitungen finden Sie unter.

E El reductor tamaño **402A** se suministra, lubricado de por vida con aceite sintético y no requieren mantenimiento alguna. Ver tabla 1, para cantidades y aceites recomendados. En la tabla 2, se encuentran las cargas radiales y axiales admitidas por el reductor.
Para documentación completa, consultar nuestra Web.

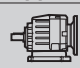
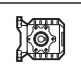
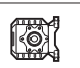
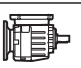
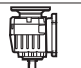
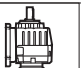
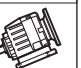
| Standard supplied | For these mounting position specify in the order or add oil Per queste posizioni specificare in fase d'ordine o aggiungere olio | | | | | | |
|---|--|---|---|---|---|---|--|
|  |  |  |  |  |  |  | |
| 0.25 LT | 0.30 LT | 0.40 LT | 0.40 LT | 0.40 LT | 0.50 LT | 0.40 LT | |
| AGIP Teliun VSF 320 | BP Energol SGXP220 | SHELL Tivela Oil WB | KLUBER Syntheso D220 EP | MOBIL Glygoyle 30 | | | |

tab. 1

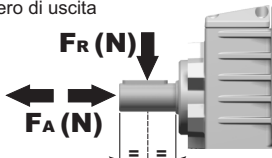
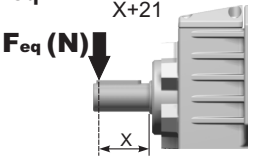
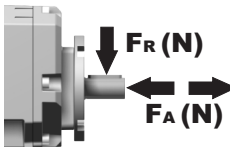
| RADIAL AND AXIAL LOADS | | | | | | | | |
|--|-----|------|---|-----|------|-------|-----|------|
| Output shaft Albero di uscita | | | $F_{eq} = F_R \cdot \frac{46}{X+21}$ | | | | | |
|  | | |  | | | | | |
| n_2 | FA | FR | n_2 | FA | FR | n_2 | FA | FR |
| 300 | 310 | 1550 | 140 | 406 | 2030 | 70 | 540 | 2700 |
| 250 | 330 | 1650 | 120 | 448 | 2240 | 40 | 600 | 3000 |
| 200 | 360 | 1800 | 85 | 480 | 2400 | 15 | 600 | 3000 |
| Input shaft Albero in entrata | | |  | | | | | |
| n_1 | FA | FR | | | | | | |
| 1400 | 240 | 1200 | | | | | | |
| 900 | 280 | 1400 | | | | | | |
| 500 | 340 | 1700 | | | | | | |

tab. 2

SELECT THIS TYPE AND THIS SPECIFIC SIZE ON THE WEB PAGES TO GET COMPLETE TECHNICAL DATA.
Selezionare tipo e gandezza specifica nel sito web per la documentazione completa.

P402A**B1**... With feet
Con piedini

Gearbox weight
peso riduttore With flange **5.7 kg**
With feet **5.9 Kg**

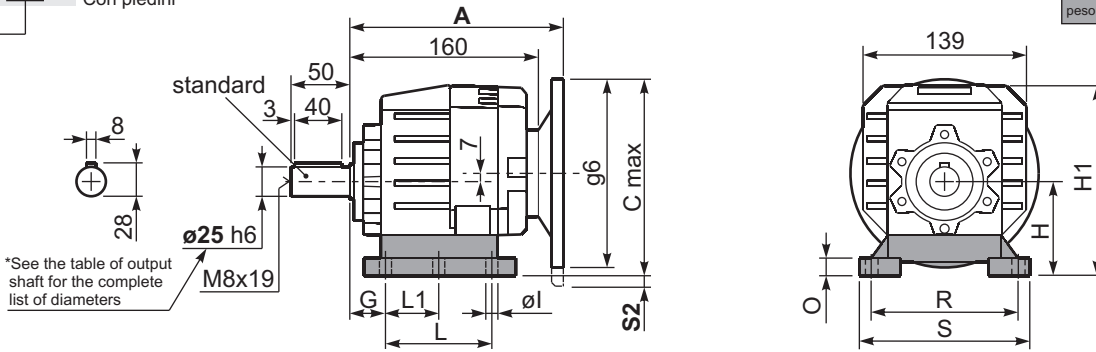

Feet / piedini

| Feet Code | Market reference | G | H | R | L | L1 | S | H1 | O | øl | S2 only with motor flange | B5 max. Flange | kit code |
|-----------|------------------|----|-----|---------|--------|----|-----|-----|----|----|---------------------------|----------------|--------------|
| B1 | 112 | 18 | 85 | 110 | 87 | 50 | 130 | 167 | 15 | - | 8 80/90B5 | - | KC35.9.021 |
| B2 | 212/3 | 18 | 100 | 130 | 107.5 | 60 | 155 | 182 | 17 | 11 | - | - | KC40.9.025 |
| S1 | 17 | 18 | 75 | 110 | 90+110 | 50 | 145 | 155 | 15 | 9 | 18 80/90B5 | - | KC40.9.022 |
| S2 | 27 | 25 | 90 | 110 | 130 | - | 145 | 172 | 20 | 9 | 3 80/90B5 | - | KC40.9.024 |
| M1 | 42/3 | 25 | 80 | 110+120 | 85 | - | 145 | 162 | 15 | 9 | 13 80/90B5 | - | KC40.9.023 |
| L4 | 04 | 13 | 80 | 105 | 76 | - | 132 | 162 | 5 | 10 | 13 80/90B5 | - | KC35.9.023LM |
| L5 | 05 | 16 | 100 | 125 | 90 | - | 150 | 182 | 6 | 12 | - | - | KC40.9.027LM |

Other feet are available, see our web site
Sono disponibili altri piedini, consulta il nostro sito web

A see on page bottom

Most popular types
Tipi più diffusi

P402A-**F**... Output flanges
flange di uscita

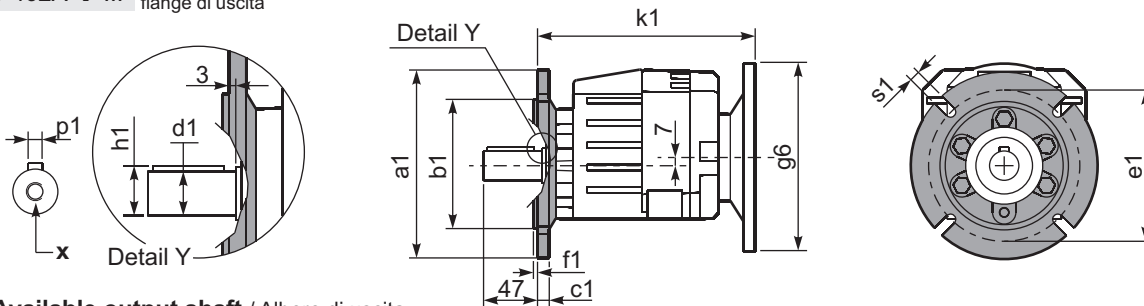

***Available output shaft / Albero di uscita**

| | Shaft - d1 | p1 | h1 | x |
|---------------------------|------------|----|------|-------|
| Standard | ø 25x50 | 8 | 28 | M8x19 |
| On request A richiesta | ø 14x40 | 5 | 16 | M5x13 |
| | ø 16x40 | 5 | 18 | M6x16 |
| | ø 19x40 | 6 | 21.5 | M6x16 |
| | ø 20x40 | 6 | 22.5 | M8x19 |
| | ø 24x50 | 8 | 27 | M8x19 |

Available output flanges / flange di uscita

| a1 ø | b1 | c1 | e1 | f1 | s1 | kit code |
|------|-----|------|-----|-----|----|------------|
| 120 | 80 | 10 | 100 | 3 | 9 | KC40.9.010 |
| 140 | 95 | 10 | 115 | 3 | 9 | KC40.9.011 |
| 160 | 110 | 10 | 130 | 3 | 9 | KC40.9.012 |
| 200 | 130 | 11 | 165 | 3.5 | 11 | KC40.9.013 |
| 250 | 180 | 11.5 | 215 | 3.5 | 14 | KC40.9.014 |

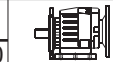

With flange and feet only on request. Ask for compatibility

P402A-**N**... Basic gearbox
Riduttore base

R402A-**N**... Input Shaft
Albero in entrata

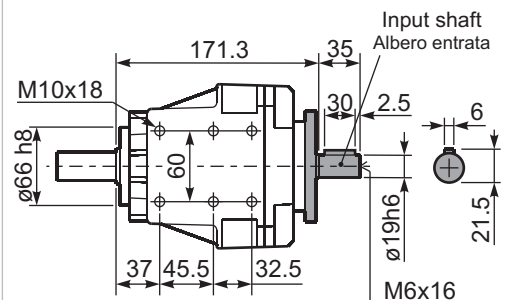
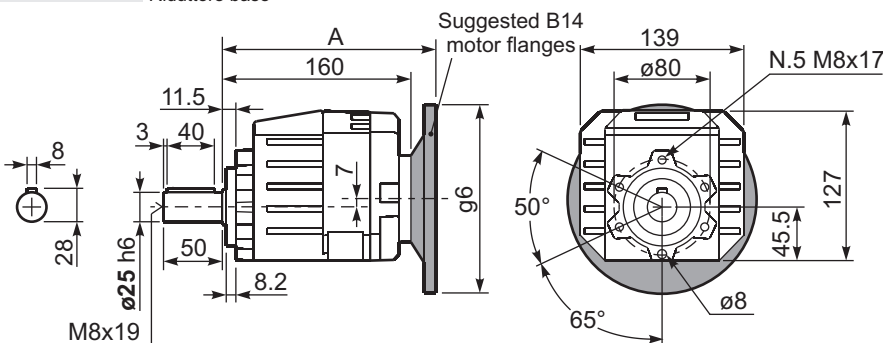

| B5 Motor Flanges | A | C _{max} | g6 | k1 | kit code |
|------------------|-------|------------------|-----|-------|------------|
| 63 B5 | 180.5 | 162 | 140 | 183.5 | K063.4.041 |
| 71 B5 | 178.5 | 170 | 160 | 181.5 | K063.4.042 |
| 80/90 B5 | 180.5 | 190 | 200 | 183.5 | K063.4.043 |

| B14 Motor Flanges | A | C _{max} | g6 | k1 | kit code |
|-------------------|-------|------------------|-----|-------|------------|
| 71 B14 | 178.5 | 142.5 | 105 | 181.5 | K063.4.047 |
| 80 B14 | 179.5 | 150 | 120 | 182.5 | K063.4.046 |
| 90 B14 | 180.5 | 160 | 140 | 183.5 | K063.4.041 |
| 100/112 B14 | 196.5 | 170 | 160 | 199.5 | KC40.4.041 |