

(Not suitable for children under 8+ years old)  
(Please read through this manual before use)

# 1:20 HIGH SPEED RACING CAR

## 2.4GHZ WIRELESS RECEIVER

(Instruction manual)

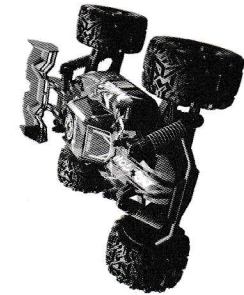

NO.S757

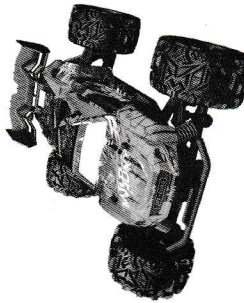

NO.S767

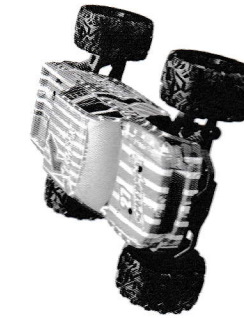

NO.S777

### 1 PRODUCT PARAMETERS

- Product name:** 1:20 High Speed Racing car
- Product size:** NO.S757 / S767 / S777 21.7x17x9.3cm
- Transmitter battery:** 2-1.5V AA Non-rechargeable batteries
- Battery parameter:** 3.7V 500 mAh Lithium
- Material:** Plastic, electronic components
- Controll distance:** < 30 meters
- Control time:** 15-20 minutes
- Charging time:** 90 minutes
- Max Speed:** 20km/h

### 10. Product Configuration:



### 2 PARTS NAME

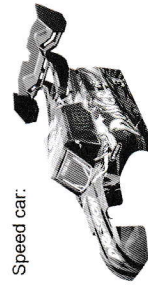

Speed car:

Body (Three car body style available option)

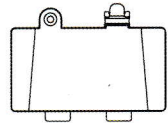

battery cover

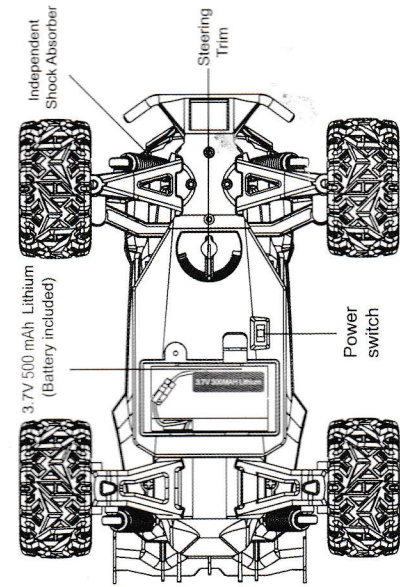

### 3 REMOTE CONTROL

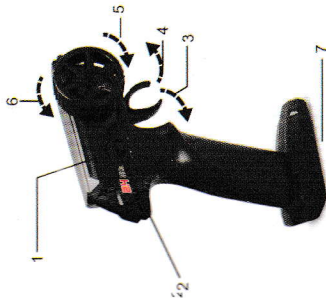

1. Power Indicator
2. Power Switch
3. Forward
4. Reverse
5. Turn Right
6. Turn Left
7. 2\*1.5V "AA" batteries (not included in the product)

#### Step 1



#### Step 2



#### Step 3



- ① Unscrew and open the battery cover
- ② Insert 2 AA batteries (not included) in the correct direction.
- ③ Close the battery cover and lock it.

If the remote will not be used for a long time, make sure to turn it off and remove the batteries.

### 4 CHARGING PROCEDURE

- The charging method of the USB charger (3.7V Lithium):**  
Connect the USB charger cable to the computer interface or the USB adapter according to the diagram. The red indicator will turn off. Then connect the cable with the battery according to the diagram. The red indicator turns on when charging. About 90 minutes later, the red indicator turn off again, showing that charging is completed.

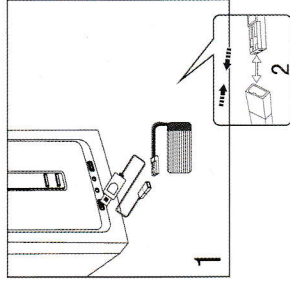

3. Use crossing screwdriver to wrench the screws on the chassis of the remote control car in anti-clockwise direction, open the battery cover.

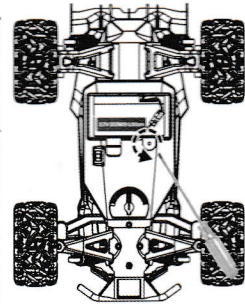

4. Mount battery pack close the battery cover and screw it in clockwise direction.

