

E1

Reolink E1 smart home security camera captures Super HD videos in the resolution of 2304x1296 (3 megapixels), and with 8 infrared LEDs, it can see up to 40ft in the dark. Stay connected with what you care anytime with all-day home camera.

1. Specs



1	Daylight Sensor
2	8 IR LEDs
3	Lens
4	Status LED
5	Built-in Mic
6	Reset Button
7	Micro SD Card Slot



1	LAN Port
2	Speaker
3	Power

Status Light

Status Light	Camera Status
Solid Blue	Camera is starting up/ WiFi connection succeeded
Blinking Blue	WiFi is not configured/ WiFi connection failed

2. Setup and Install

Set up the Camera

What's in the Box

Note: The package content may vary and update with different version and platforms, please take the below information only for a reference. And the actual package content are subject to the latest information on the product selling page.

E1



E1 *1



Mounting Plate *1



Quick Start Guide*1



Power Adapter*1



Mounting Template *1



Surveillance Sticker*1



Pack of Screws*1



Reset Needle*1

Set up the Camera on the App

There are two methods to do the initial setup of the camera:
1. with a Wi-Fi connection; 2. with a network cable connection.

1. With Wi-Fi Connection

Step 1. Tap the  icon in the top right corner to add the camera.

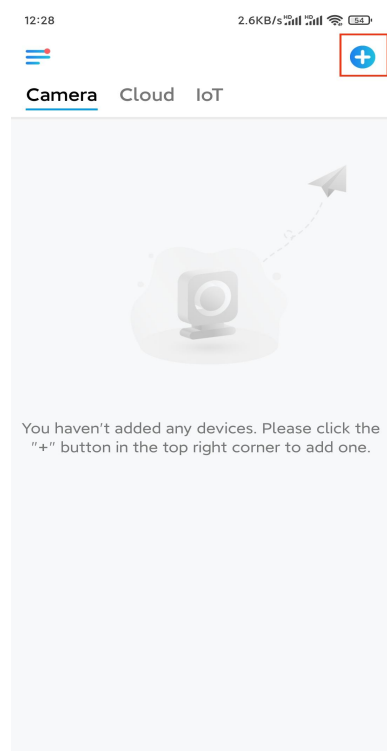

Step 2. Scan the QR code on the camera.

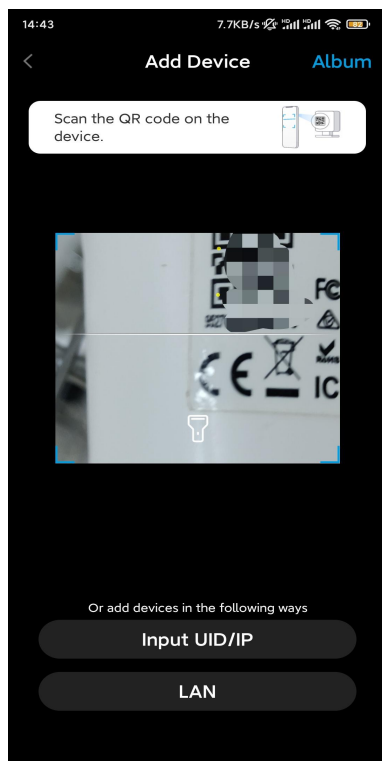

Step 3. Tap **Choose Wi-Fi Connection** to configure the Wi-Fi settings.

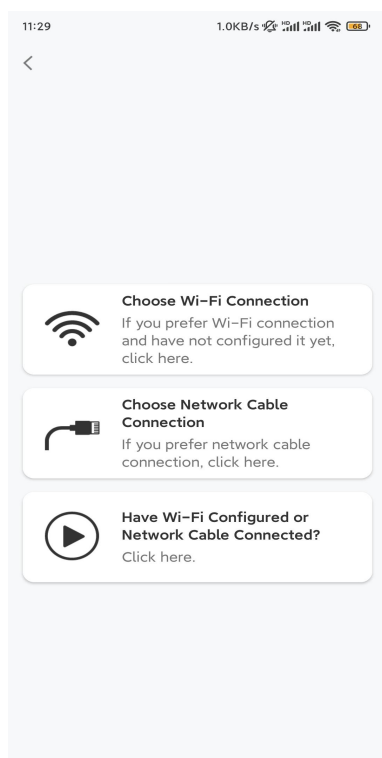

Step 4. After you hear the voice prompts from the camera, tick “I have heard the voice played by the camera” and tap **Next**.

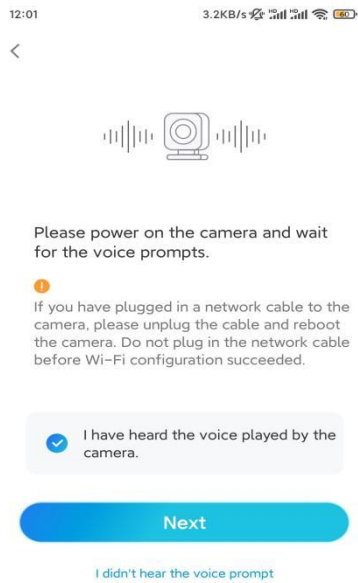

Step 5. Select a WiFi network, enter the WiFi password, and tap **Next**.

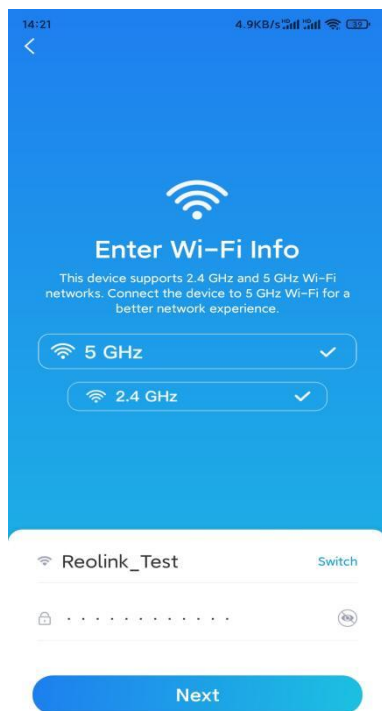

Step 6. Scan the QR code on the app with the camera lens.
Tap **Scan Now**. The QR code will be generated and displayed on your phone.
Please hold your phone in front of the camera at a distance of about 20 cm (8 inches) and have the phone face the camera lens to let the camera scan the QR code.

After you hear the beep sound, tick "I have heard a beep sound from the camera" and tap **Next**.

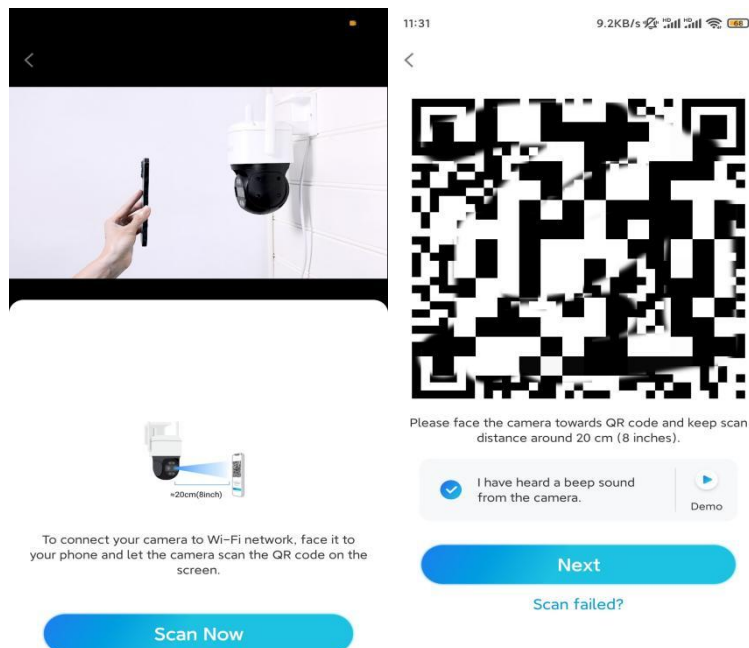

Step 7. After you hear a voice prompt "Connection to the router succeeded" from the camera, tick "I have heard the voice prompt" and tap **Next**.

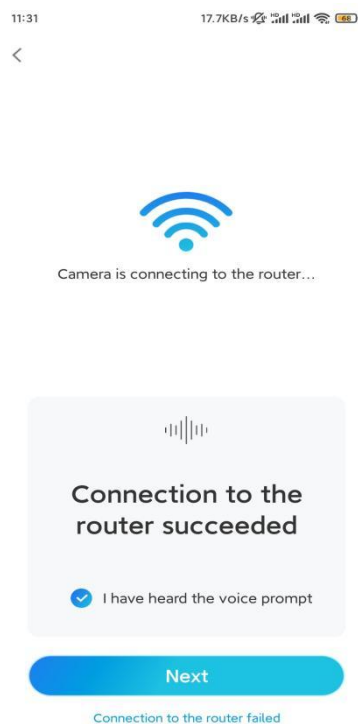

Note: If you hear the voice prompt "Connection to the router failed", please double-check if you have entered the Wi-Fi information correctly in the previous

step.

Step 8. Create a login password and name your camera.

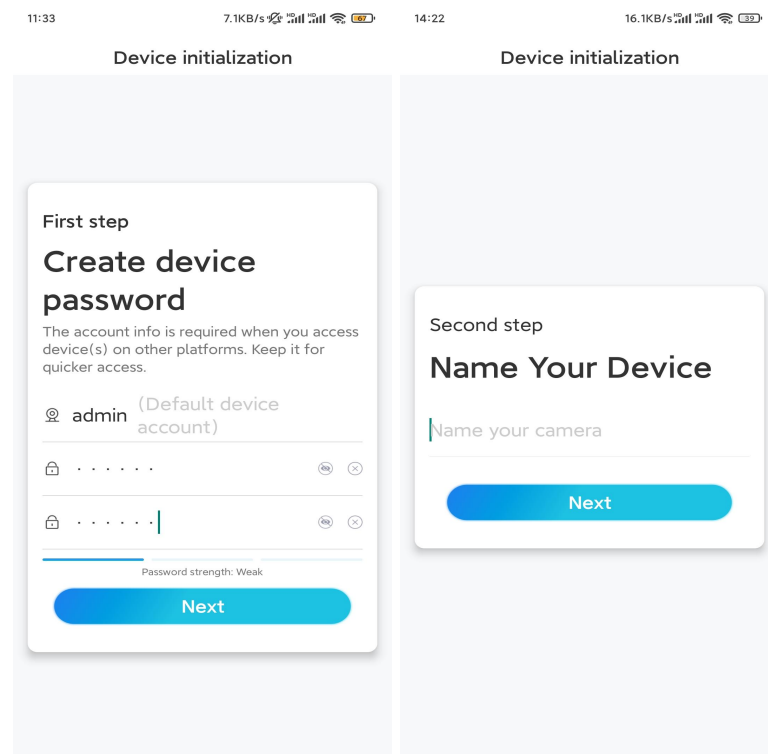

Step 9. Initialization finished. Tap **Finish**, and you can start live viewing now.

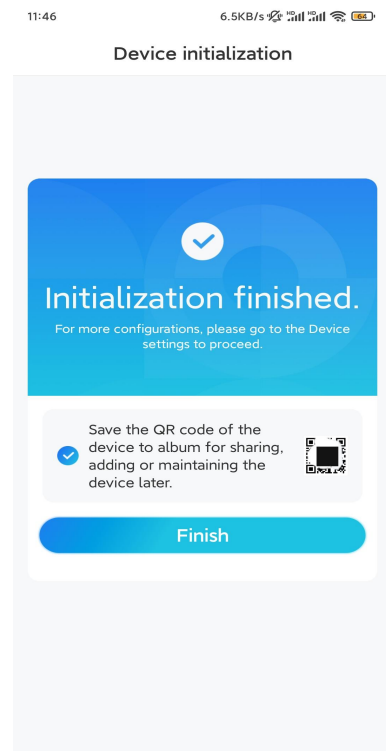



2. With a Network Cable Connection

To do the initial setup, please power on the camera with the DC adapter, connect

the camera to your router's LAN port with an Ethernet cable, and follow the steps below.

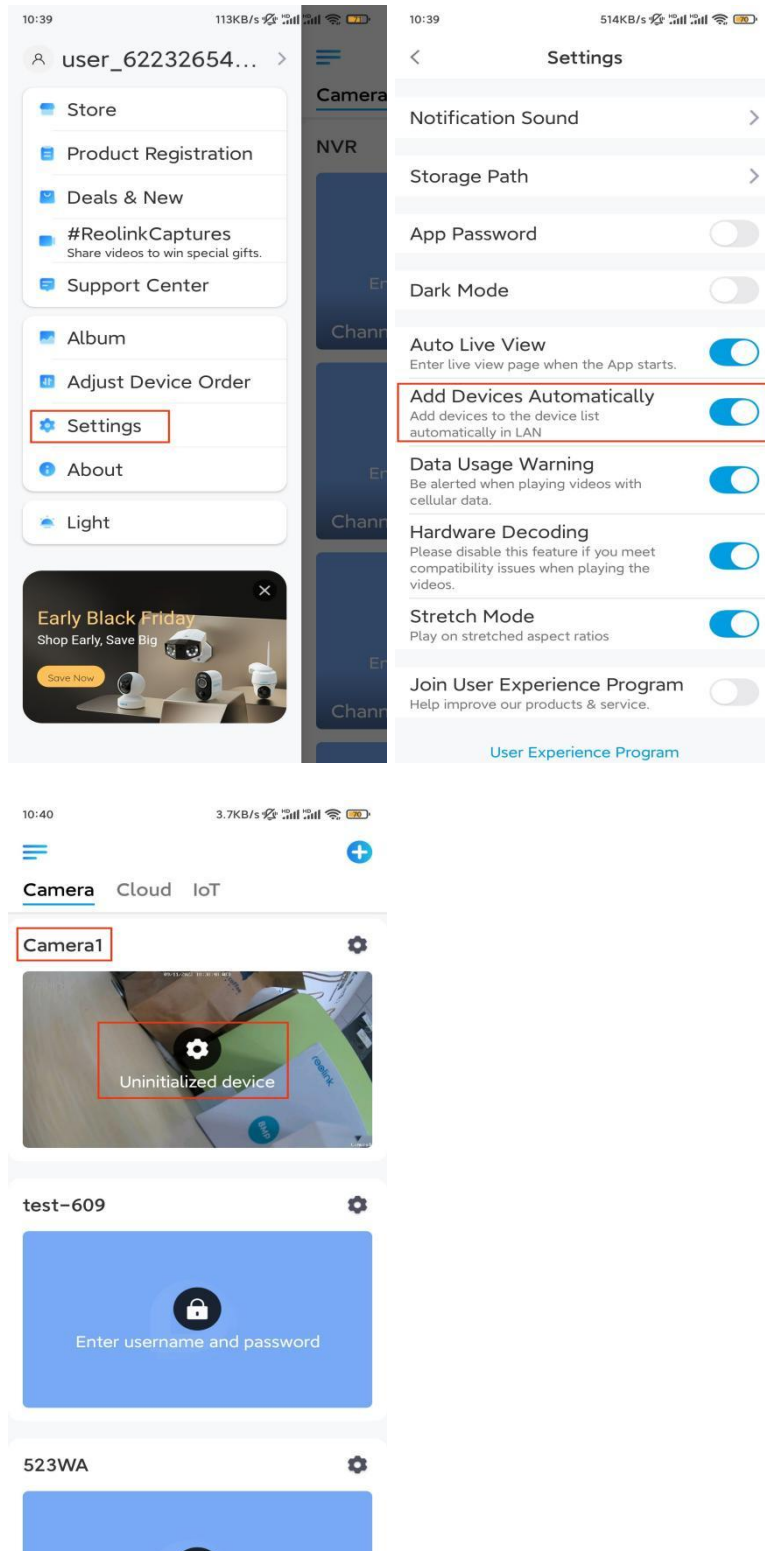
Step 1. If your phone, the camera, and the router are on the same network and you've enabled the **Add Device Automatically** option in the App **Settings**, you can tap and select this device on the **Devices** page and skip to **Step 3**.



Otherwise, you can tap the  icon in the top right corner and scan the QR code on the camera to add the camera.

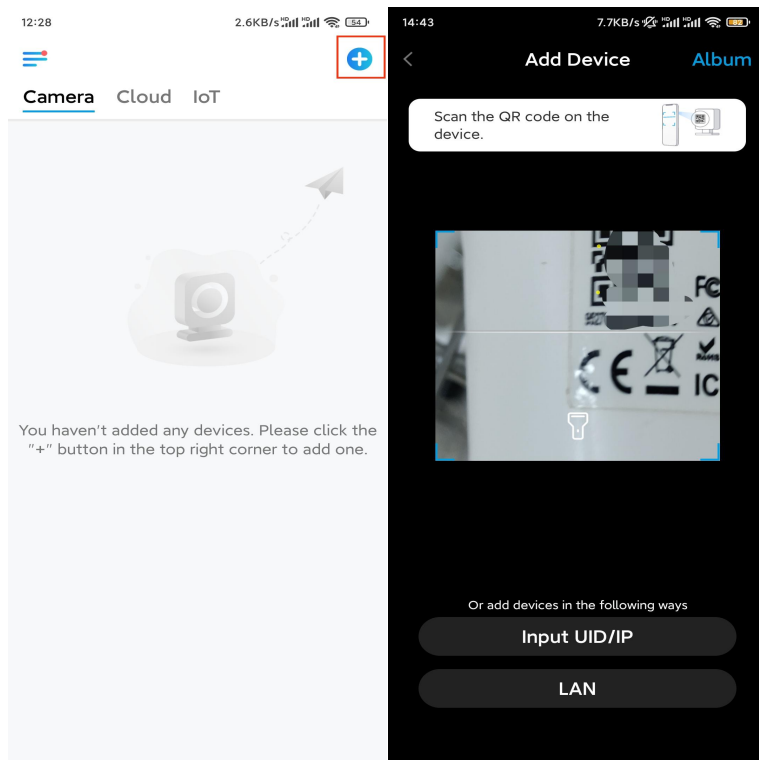

Step 2. Tap Choose Network Cable Connection.

Please make sure the camera is connected in the correct way, as shown in the diagram, and then tap **Access the Camera**.

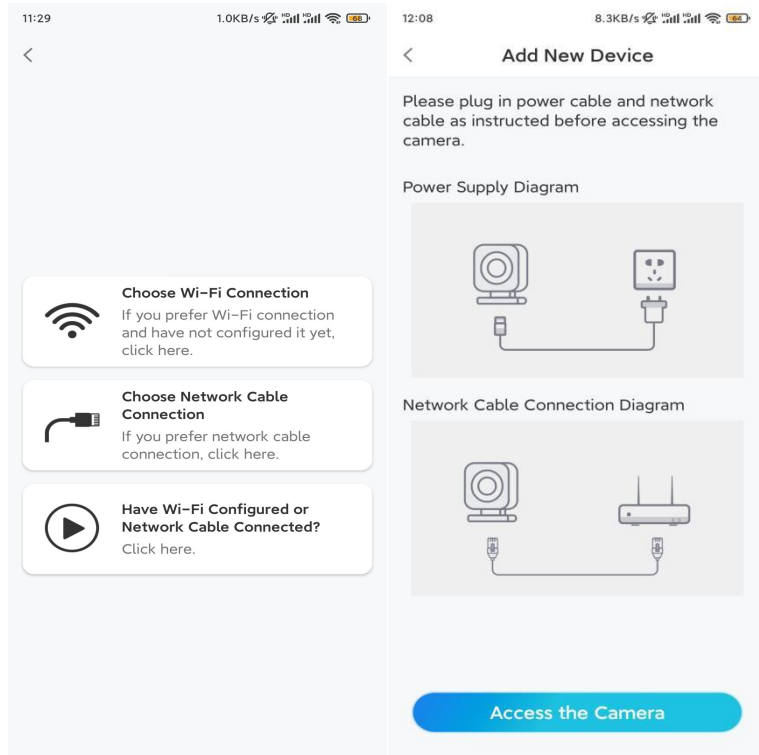

Step 3. Create a device password and name the device.

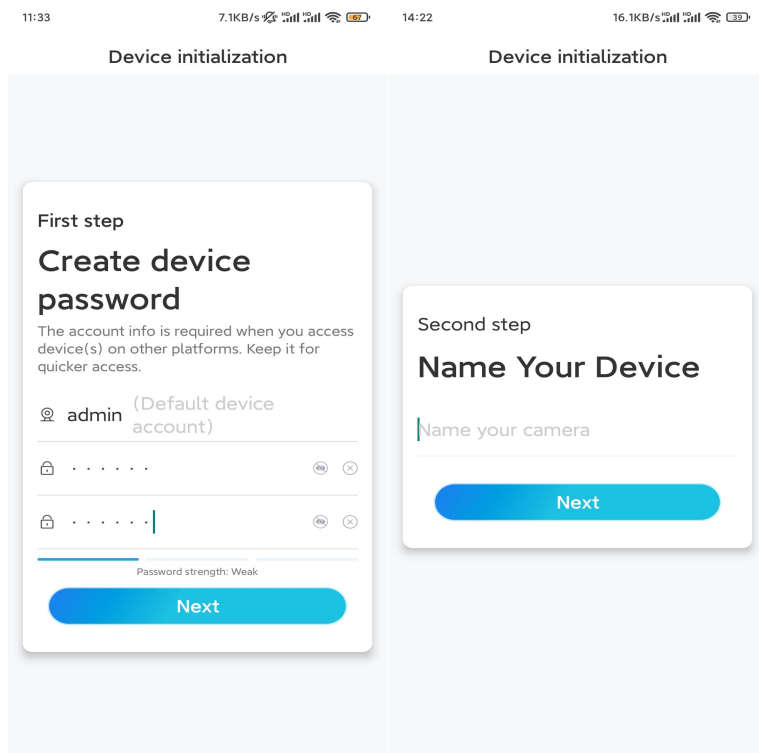

Step 4. Select the WiFi network that you want to join, enter the password of the WiFi network, and tap **Save** to save the configuration.

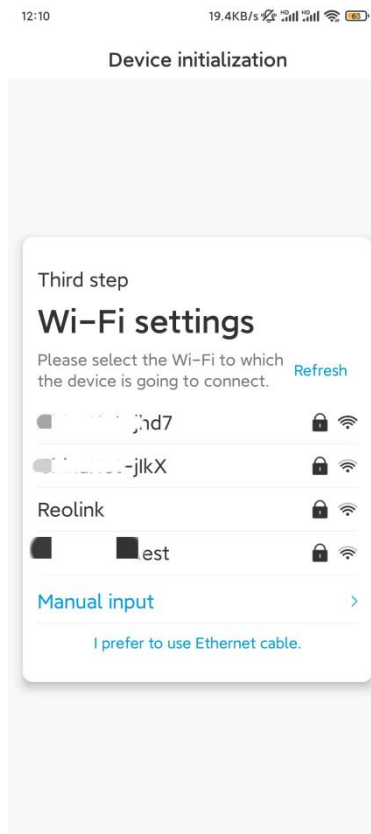

Step 5. Initialization finished. Tap **Finish**, and you can start live viewing now.

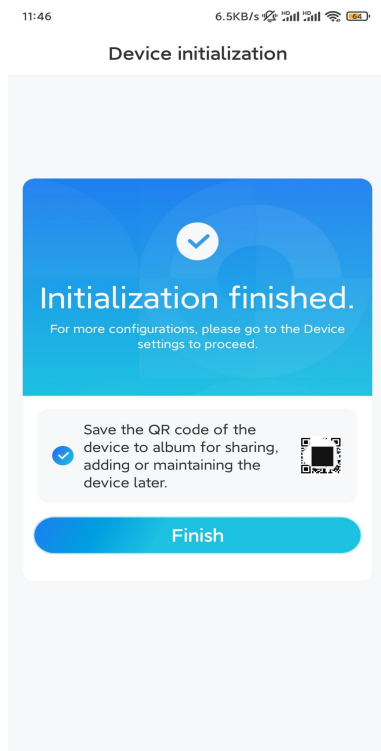

Install the Camera

Here is a guide on how to install the camera to the ceiling.

Step 1. Install the Mounting Plate.

- Drilling two screw holes on the wall according to the mounting hole template.
- Insert the two plastic anchors into the holes in the wall.
- Secure the base unit in place by tightening the screws into the plastic anchors.

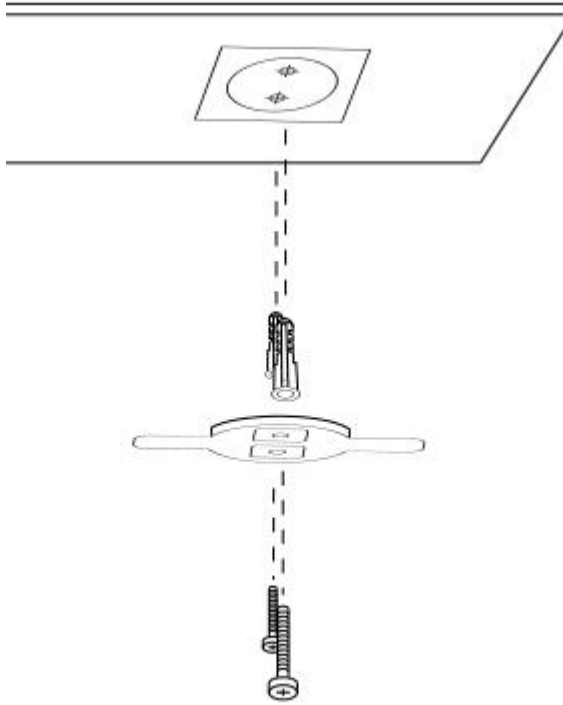

Step 2. Attach the Camera.

Align the camera with the bracket, then turn the camera unit clockwise to lock it in position.

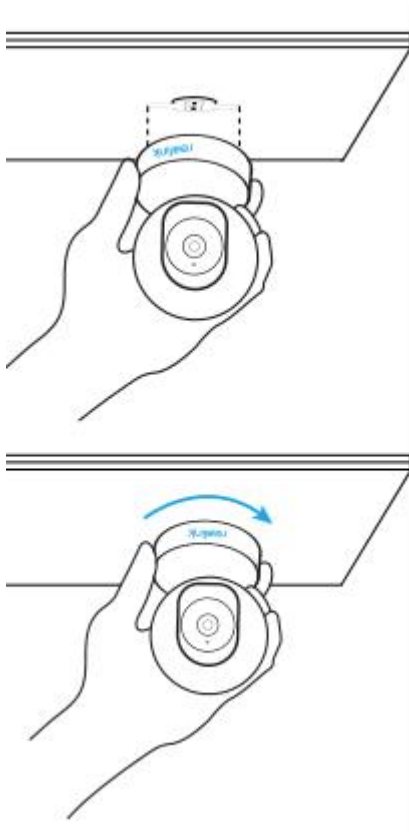

Notes:

- To remove it from the ceiling, turn the camera counterclockwise.
- In case your camera is mounted upside down, its picture shall be rotated as well. Please go to **Device Settings > Display** on Reolink App/Client and click **Flip Vertical** to adjust the image.