



DIGGA CENTRAL EUROPE
DRIVES YOUR SUCCESS



AUGERS DRIVES TRENCHERS

WWW.DIGGA-CE.COM

/ HYDRIVE & BIGFOOT
/ ACCESSORIES

/ PREMIUM DRIVES
/ ACCESSORIES

DIGGA MANUFACTURING

NOT JUST ASSEMBLERS WE ARE THE ORIGINAL MANUFACTURER

OUR PHILOSOPHY

WE WILL ENDEAVOUR TO MANUFACTURE QUALITY MADE, AFFORDABLE PRODUCTS WITHOUT SACRIFICING OUR GOALS OR PRODUCT INTEGRITY. WE WILL SUPPLY YOU WITH A PRODUCT RANGE AND EXPERTISE THAT WILL BECOME INVALUABLE TO YOUR BUSINESS.

QUALITY, SERVICE, RELIABILITY
GUARANTEED

About Digga™

Digga is Australia's largest earthmoving attachment and planetary gearbox manufacturer; exporting products globally through 5 company owned, international facilities and its loyal dealer network. Formed in 1981 by founder, Chairman & Director of Research and Development, Stewart Wright, Digga pioneered pendulum drilling in Australia and today produces the largest range of compact, high-torque planetary drives for drilling and the attachment industry. Digga are a multi-award winning company both for product design and business practices, recognised for their innovative approach to leading edge design and manufacturing quality.



Digga manufacturing

Digga are not just an assembly plant, we are the original manufacturer. Our central manufacturing and head office facilities are located in Brisbane, Australia and the 12,500sqm, state-of-the-art facility features some of the most technologically advanced machinery in Australia. We manufacture Digga gears, components and attachment range using only the highest grade material and work to meet ISO 9001 quality assurance standards across all our sites.

Digga Central Europe

In Poland and central Europe Digga equipment is distributed and serviced by Serafin P.U.H - a family-based business set up in 2005 in Przybysławice, Poland. The founder Andrzej Serafin began by designing and selling machines dedicated to farming and brewing industry. Nowadays the company offers wide range of high-quality products, from agricultural and communal to building ones. Since 2008 Serafin P.U.H. has been successfully expanding Digga's dealer network in central and eastern Europe. It's responsible for supplying with equipment as well as providing after-sale service among individual and business customers.

- > Poland
- > Slovakia
- > Lithuania
- > Latvia
- > Estonia
- > Hungary

EXPORT AWARDS:

- 2002 GOLD COAST REGIONAL EXPORT AWARD
- 2009 BRITISH EXPORT EXCELLENCE AWARD
- 2013 QLD EXPORT AWARD
- 2014 QLD MANUFACTURING EXPORTER OF THE YEAR
- 2015 QLD MANUFACTURING EXPORTER OF THE YEAR
- 2017 QLD EXPORT AWARD - LEADERSHIP & INNOVATION



Digga's 12,500m² (130,000 sq ft) state of the art manufacturing facility, Brisbane Australia.



**THE MOST ADVANCED
AUGER DRIVE YOU'LL EVER
OWN OR OPERATE.**

**A TRUSTED REPUTATION FOR
DELIVERING QUALITY PRODUCTS
THAT PERFORM**



**WE ARE NOT JUST AN ASSEMBLER, DIGGA ARE
THE ORIGINAL DESIGNERS AND MANUFACTURERS.**

**OUR CORE EXPERTISE: 2,900Nm – 500,000Nm
(AND EVERYTHING IN BETWEEN).**



**INTEGRATED MOTOR
AND OUTPUT HOUSING** **POWERED BY
EATON**

Working with leading motor manufacturers Eaton, Digga have developed our unique range of custom, hydraulic motors designed specifically for the earth moving industry.

The design merges the motor with the input housing creating a direct connection to the gearset and eliminating the need for several gearbox components. In turn, the weight and overall length of the drive unit are amongst the most compact on the market. There are also less moving parts and fewer potential leak points.

With the hydraulic motor ports positioned practically within the drive unit, manoeuvrability when drilling is maximised and there is greater protection to hoses and fittings during transport and storage.



**MORE COMPACT DESIGN,
LESS MAINTENANCE**

All of our gears are precision machined from high grade alloy steel, specifically formulated for the manufacture of high performance gears in the earth moving industry. The compact design of our gear set allows for greater length under the drive, for augers or pile installation. As our drives can go down the hole they provide added depth when drilling allowing you to work more efficiently.

DESIGN AND DEVELOPMENT

Digga utilises advanced 3D modelling software, finite analysis, cyclic testing, and extensive in field testing to ensure a product that performs, day in and day out.

LEADING WARRANTY



2 PIECE SHAFT DESIGN

The Digga 2 piece shaft design gives the operator greater peace of mind should there be a bearing failure. Our design allows for minimal movement in the shaft even after preload comes off - by making the Digga shaft a separate component to the planetary carrier, the planetary gears are isolated from the pushing, pulling and bending forces generated by the machine.

Digga offer a lifetime warranty on shaft pullout.



HIGHEST SIDE LOAD RATINGS

Digga drives have more than double the side load capacity of any other gearbox on the market. Under torque load, the Digga two piece shaft design ensures there is no increased load on the bearing. The bearings do the job they were designed for, efficiently maintaining axial and side loading.



VIS TWO SPEED

High quality motor manufactured by EATON. The VIS series is 50% more efficient than conventional gear motors. It is contamination resistant, capable of 60kw power (95Hp) and tolerates higher pressures than the 6K series.

Digga 2-speed motors boast an increase of 50% in high speed/low torque.



ENERGY CONTROL VALVE

The Digga engineered Energy Control Valve (ECV) is fitted to the drive manifold and controls the rapid decompression of oil (pile Kick-Back) caused during the application of screw anchoring. It can also be retrofitted to most Digga drilling drives.

DIGGA PREMIUM AUGER DRIVES

Digga's Premium Drives (PD) are optimised to the tonnage of your machine ensuring a more accurate drive selection.

E.g. 5 tonne machine

Standard selection - PD5

Lighter duty (more speed) - PD4

Heavy duty (more power) - PD6

FEATURES

- Compact high torque Digga manufactured gearbox
- Highly efficient design with less moving parts
- Fitted with Eaton/Digga geroler hydraulic motor
- No case drain required
- Full range of shafts available upon request
- Extreme duty shaft locking system
- Drive fits down the hole for greater digging depth
- Low maintenance with 5 year gear box and 3 year motor warranty

EXPORTING TO THE WORLD FOR OVER 10 YEARS

THE DEMAND FOR DIGGA PRODUCTS GLOBALLY LEAD THE BUSINESS LAUNCHING INTO EXPORT TRADES IN 1996. WE OPENED INTERNATIONAL MANUFACTURING AND DISTRIBUTION PLANTS IN EUROPE AND THE USA AND BUILT ON OUR LOYAL DEALER NETWORK TO MEET THE REQUIREMENTS OF INTERNATIONAL MARKETS.

MACHINES 750KG - 2T

	PDD	PDX	PDX2
Rec Flow Range	15-45 lpm	20-50 lpm	30-50 lpm
Max Torque	1,171 Nm	1,743 Nm	2,307 Nm
Pressure Valve Fitted	N / A	N / A	N / A
Max Pressure	Do not exceed 240 bar @ 60 lpm		
Max Flow	Do not exceed 115 lpm @ 130 bar		
Max Power	Do not exceed 25 Kw (34 hp)		
Overall Length	500 mm	557 mm	557 mm
Diameter	187 mm	187 mm	187 mm
Weight (no hitch)	41 Kg	45 Kg	45 Kg
Std Output Shaft	65 mm RND	65 mm RND	65 mm RND

MACHINES 2T - 5T

	PDX2	PD3	PD4	PD5	PD6
Rec Flow Range	30-50 lpm	45-75 lpm	55-85 lpm	60-95 lpm	70-115 lpm
Max Torque	2,307 Nm	3,544 Nm	4,448 Nm	5,151 Nm	5,596 Nm
Pressure Valve Fitted	N / A	Optional	Optional	Optional	Optional
Max Pressure (Do not exceed)	240 bar @ 60 lpm				
Max Flow (Do not exceed)	115 lpm @ 130 bar				
Max Power (Do not exceed)	25 Kw (34 hp)				
Overall Length	557 mm	579 mm	579 mm	579 mm	730 mm
Diameter	187 mm	240 mm	240 mm	240 mm	240 mm
Weight (no hitch)	45 Kg	57 Kg	58 Kg	67 Kg	89 Kg
Std Output Shaft	65mm RND	65mm RND	65mm RND	75 mm SQ	75 mm SQ
2 Speed Available	NO	YES	NO	NO	YES
Max Pressure (Do not exceed)	200 bar @ 76 lpm				
Max Flow (Do not exceed)	76 lpm @ 200 bar				

MACHINES 5T - 10T

	PD5	PD6	PD7	PD6HF	PD8HF	PD10HF
Rec Flow Range	60-95 lpm	70-115 lpm	75-115 lpm	70-150 lpm	80-200 lpm	100-200 lpm
Max Torque	5,151 Nm	5,596 Nm	6,040 Nm	5,634 Nm	7,136 Nm	9,690 Nm
Pressure Valve Fitted	Optional	Optional	Optional	Included	Included	Included
Max Pressure (Do not exceed)	240 bar @ 60 lpm		240 Bar @ 130 lpm			
Max Flow (Do not exceed)	115 lpm @ 130 bar		210 lpm @ 145 bar 230 lpm @ 130 Bar 230 lpm @ 130 Bar			
Max Power (Do not exceed)	Do not exceed 25 Kw (34 hp)		50 Kw (67HP)			
Overall Length	579 mm	730 mm	734 mm	950 mm	950 mm	950 mm
Diameter	240 mm	240 mm	240 mm	290 mm	290 mm	290 mm
Weight (no hitch)	67 Kg	89 Kg	90 Kg	149 Kg	149 Kg	149 Kg
Std Output Shaft	75 mm SQ	75 mm SQ	75 mm SQ	75 mm SQ	75 mm SQ	75 mm SQ
2 Speed Available	NO	YES	NO	YES	YES	YES
Max Pressure (Do not exceed)	200 bar @ 76 lpm		240 bar @ 150 lpm			
Max Flow (Do not exceed)	76 lpm @ 200 bar		180 lpm @ 200 bar			

MACHINES 5T - 12T

	PD4HF	PD6HF	PD8HF	PD10HF
Rec Flow Range	50-150 lpm	60-150 lpm	80-200 lpm	100-200 lpm
Max Torque	4,473 Nm	5,634 Nm	7,136 Nm	9,690 Nm
Pressure Valve Fitted	Included	Included	Included	Included
Max Pressure	Do not exceed 240 bar @ 130 lpm			
Max Flow (Do not exceed)	170 lpm @ 180 bar	210 lpm @ 145 bar	230 lpm @ 130 bar	230 lpm @ 130 bar
Max Power	Do not exceed 50 Kw (67 hp)			
Overall Length	950 mm	950 mm	950 mm	950 mm
Diameter	290 mm	290 mm	290 mm	290 mm
Weight (no hitch)	125 Kg	149 Kg	149 Kg	149 Kg
Std Output Shaft	75 mm SQ	75 mm SQ	75 mm SQ	75 mm SQ
2 Speed Available	YES	YES	YES	YES
Max Pressure (Do not exceed)	240 bar @ 150 lpm			
Max Flow (Do not exceed)	180 lpm @ 200 bar			

EXCAVATORS 10T - 20T

	PD12	PD15	PD18	PD22	PD25
Rec Flow Range	120-230 lpm	120-230 lpm	120-230 lpm	120-230 lpm	120-230 lpm
Max Torque	11,268 Nm	13,918 Nm	17,630 Nm	22,176 Nm	26,267 Nm
Pressure Valve Fitted	Included	Included	Included	Included	Included
Max Pressure	Do not exceed 240 bar @ 130 lpm				
Max Flow (Do not exceed)	230 lpm @ 130 bar	210 lpm @ 145 bar	230 lpm @ 130 bar	230 lpm @ 130 bar	230 lpm @ 130 bar
Max Power	Do not exceed 50 Kw (67 hp)				
Overall Length	950 mm	1,006 mm	1,006 mm	1,006 mm	1,152 mm
Diameter	290 mm	290 mm	290 mm	290 mm	355 mm
Weight (no hitch)	149 Kg	176 Kg	176 Kg	176 Kg	300 Kg
Std Output Shaft	75 mm SQ	75 mm SQ	75 mm SQ	75 mm SQ	100 mm SQ
2 Speed Available	YES	NO	YES	YES	NO
Max Pressure (Do not exceed)	240 bar @ 150 lpm				
Max Flow (Do not exceed)	180 lpm @ 200 bar				

EXCAVATORS 20T - 50T

	PD25	PD30	PD40	PD50
Rec Flow Range	120-230 lpm	120-230 lpm	120-230 lpm	120-230 lpm
Max Torque	26,267 Nm	30,543 Nm	33,041 Nm	38,420 Nm
Pressure Valve Fitted	Included	Included	Included	Included
Max Pressure	Do not exceed 240 bar @ 130 lpm			
Max Flow	Do not exceed 230 lpm @ 130 bar			
Max Power	Do not exceed 50 Kw (67 hp)			
Overall Length	1,152 mm	1,152 mm	1,152 mm	1,152 mm
Diameter	355 mm	355 mm	355 mm	355 mm
Weight (no hitch)	300 Kg	300 Kg	300 Kg	300 Kg
Std Output Shaft	100 mm SQ	100 mm SQ	100 mm SQ	100 mm SQ
2 Speed Available	YES	YES	YES	YES
Max Pressure (Do not exceed)	240 bar @ 150 lpm			
Max Flow (Do not exceed)	180 lpm @ 200 bar			





RYNO HITCH

Developed for faster connection to the auger or pile, the Ryno cradle hitch is designed to handle the torsional loads of anchors and screw piling. The Ryno hitch front cradle allows the operator to angle the drive up to 90 degrees for easy connection to augers or anchors while a rear cradle stops the auger drive or anchor from swinging freely when manoeuvring over uneven terrain.

Features:

- 3 cradle positions
- Premium grade steel
- Extra heavy duty, fully engineered design
- Compact and faster connection to the auger/pile
- Safer. No more standing piles or large augers with persons or machinery to connect your drive

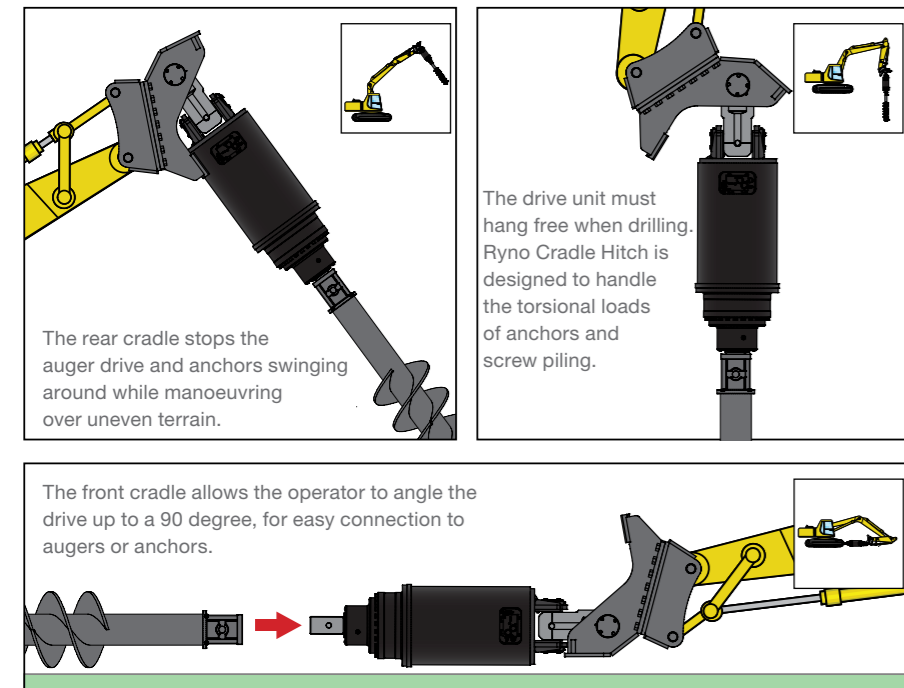

CRADLE HITCH

The double pin hitch with drive unit cradle allows the operator to angle the drive up to 90 degrees with greater support given by the cradle making the drive easier and more stable when connecting to augers or anchors. The Digga cradle hitch is to suit PDD-PD50 drives.

Features:

- Ideal for augering in all ground conditions and screw anchoring
- Loose pin or fixed pin for machines with hydraulic quick hitch

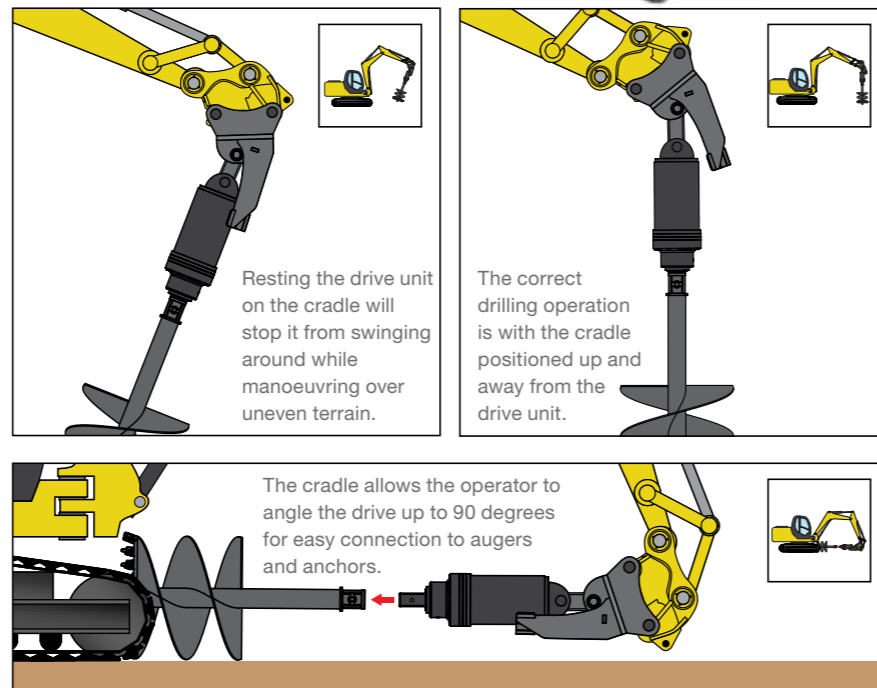

HITCHES

Digga manufacture a range of hitches to suit excavators up to 80t. Configurations include double or single pin fixed and loose pin.

- Single and double pin options available.
- Highly efficient, compact design.
- Premium grade steel.
- Extra Heavy Duty, fully engineered design.
- Faster connection to machine and drive.

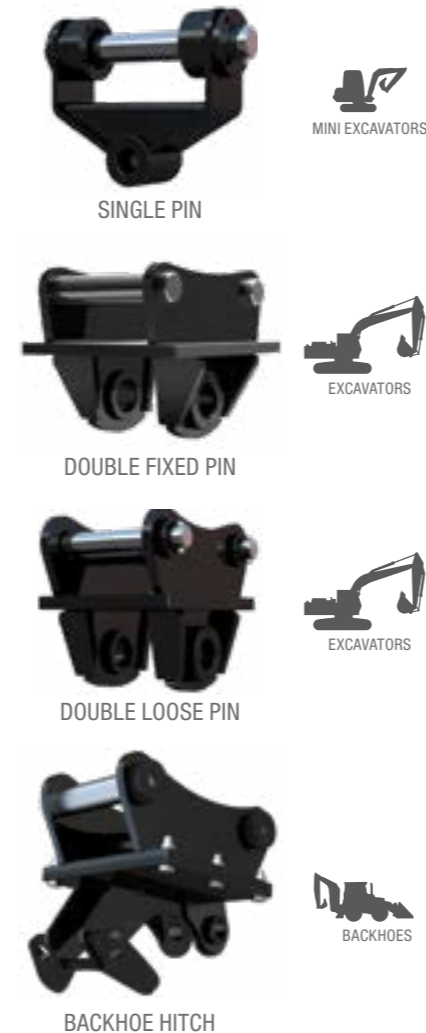

SWING CONTROL SYSTEM

The Digga Swing Control System (SCS) controls the pendulum action of your auger making it easier to operate and control, safer on the work site, and greatly improving operator efficiency and effectiveness.

- ✓ INCREASED EFFICIENCY
- ✓ INCREASED PRODUCTIVITY
- ✓ INCREASED SAFETY



The revolutionary Digga patented SCS is integrated into the hitch and drive hood; requiring no additional hydraulics and can be retrofitted to most existing Digga auger drives.

Its unique design means the faster you move, the quicker the drive unit stops.

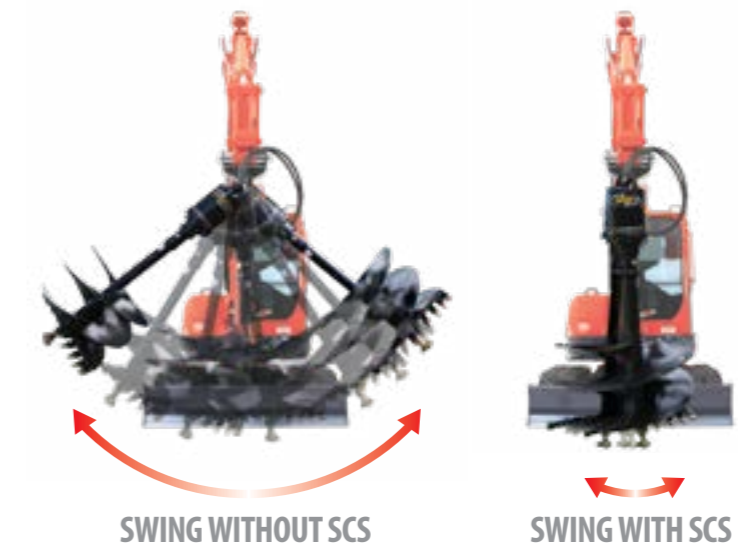

MACHINE MOUNTS

Digga manufacture a fixed or optional side shift mount for most skid steer loaders, backhoes, telehandlers and mini machines. The optional side shift frames feature a slide cradle which allows the user to offset the attachment mounted on the frame, enabling trenching and drilling close to structures.



AUGERS

TRUE-CUT DIGGA AUGERS CUT A TRUE SIZED HOLE

Digga's true-cut design ensures a 300mm auger drills a 300mm hole. All our augers boast a heavy duty design and fitted with high efficiency cutting heads to maximise your drilling performance. Our range of quality wear parts provide longevity and performance.

DIGGA CUTTING SYSTEMS

The cutting head is the most crucial part of the auger and this is where Digga technology exceeds the rest of the market. Digga cutting heads are optimised for the most efficient cutting angles and rotational cutting efficiency. Choosing the right cutting head with correct teeth and pilot combinations is essential to ensuring maximum customer satisfaction.

DIGGA CUTTING SYSTEMS

Digga augers are measured from tip to tip of the teeth. The cutting head is what cuts the hole.

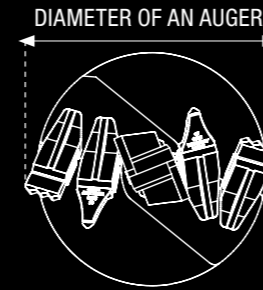

EXTENSIONS

Digga drilling extensions are built for strength and capable of handling powerful loads from larger machines. With a full range of adaptors available there is an extension to suit very model of Digga auger drive and augers.

WEAR PARTS, TEETH AND PILOTS

Digga provides a full range of auger teeth and pilots to suit your individual requirements - standard, flat tungsten, and multi-faced tungsten for tougher ground conditions. Digga also provide rotating rock pick teeth for dedicated rock drilling.

- Quality made
- Drill into most ground conditions
- Huge range of teeth for most augers and application

TREE PLANTING AUGER BLADED TEETH (EARTH/CLAY)

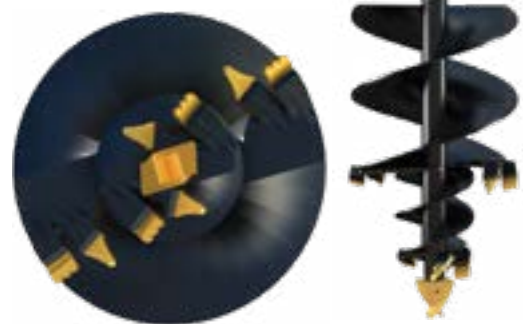

DESIGNED TO EASILY DRILL HOLES TO PLACE TREES AND SHRUBS OF ALL SIZES & IMPROVE ESTABLISHMENT

Digga tree planting augers are designed to drill a smaller diameter hole for the tap root and a larger secondary hole at the top for the root ball. The design of the cutting system will leave the hole walls rough, not glazed, meaning the plant stock has the maximum chance of establishing.

NOT SUITED FOR ROCK.

A / EARTH AUGERS BLADED TEETH (EARTH/CLAY/SHALES)



EARTH AUGER FOR GENERAL DRILLING

The angle and geometry of the teeth to the pilot is the key to the efficiency in which these augers perform. Available in earth, tungsten (TC) or multi-faced tungsten (MFT) braised onto the face of the teeth, providing longer wear life and greater cutting performance.

NOT SUITED TO HARDER FRACTURABLE ROCK.

RC / ROCK-COMBO AUGERS TAPER TEETH (ALL GROUND CONDITIONS)



TAPER TEETH DESIGNS ARE THE ULTIMATE ALL PERFORMANCE AUGER

No need to have two augers for different conditions our rock-combo augers are suitable for all ground conditions. Cut a clean hole in soft earths and clays and have the ultimate ripping ability in fracturable rock.

FOR LARGER EXCAVATORS IN HARDER CONDITIONS, TTL - TRIPLE TUNGSTEN TEETH ARE THE RIGHT SELECTION FOR OPTIMUM SOFT ROCK DRILLING.

DR / ROCK AUGER ROTATING ROCK PICK TEETH (SHALE/FRACTURABLE ROCK)



HEAVY DUTY DESIGN AND EFFICIENT CUTTING HEAD MAKE THE ULTIMATE DEDICATED ROCK AUGER

Digga's rock augers are engineered with a heavy duty design and high efficiency cutting heads to maximise your drilling performance. Fitted with a range of quality wear parts providing superior wear and performance in harder grounds.

N.B. NOT SUITED FOR EARTH OR CLAY DRILLING.



Features

- High quality steel
- Telescopic design for easier operation and storage
- Large range of extensions up to 5000mm in length
- Easy to fit

TRULOC BLADED TEETH TO SUIT A4 AUGERS (EARTH)

Digga's new TRULOC tooth range allows the tooth to be secured in 3 different ways. You can choose to use one, two or all three methods to hold your auger teeth.

The range also features an easy to remove pin, stabilising channels and the Digga quality that you've come to expect. The TRULOC teeth are suitable for light to moderate ground conditions.

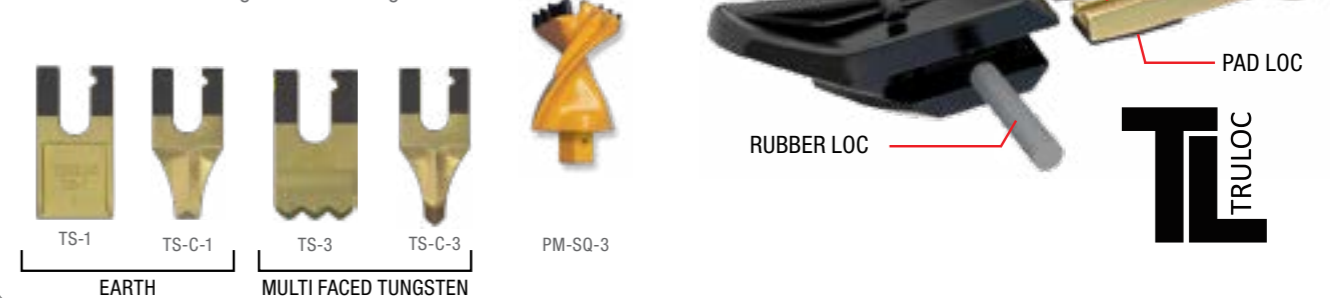

PADLOCK BLADED TEETH TO SUIT A6 AND A8 AUGERS (EARTH)

Our Padloc tooth retaining system utilises heavy duty rubber pads vulcanised onto the metal legs of the teeth to ensure your teeth are locked in tight whilst still easy enough to remove for easy replacement in the field.



TAPERED TEETH TO SUIT RC/ ROCK-COMBO AUGERS

No need to have two augers for different conditions. Ideal in all drilling conditions up to very hard rock. Cut a clean clear hole in soft earth and clay and have the ultimate ripping ability in fracturable rock.

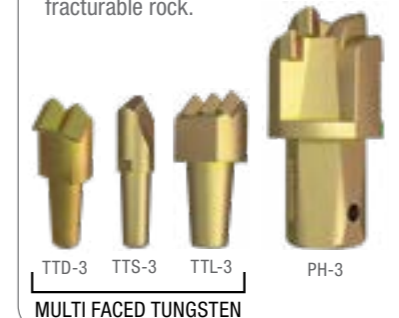

ROTATING ROCK PICK TO SUIT ROCK AUGERS

Engineered to burst into fracturable rock, concrete and abrasive conditions; they feature a dimpled retainer to provide increased holding power.



TRENCHERS

DIGGA'S BIGFOOT TRENCHER RANGE

The Bigfoot trencher features an adjustable depth control foot which ensures the operator trenches to a set depth at all times. With three different chain options for trenching in different ground conditions, trench in general earth to rocky ground, concrete, asphalt and even frozen ground with ease.

THE MOST ADVANCED TRENCHER

Digga Bigfoot trenchers are the most user friendly on the global market. Our patented crumber bar allows the operator to start trenching in the trench eliminating the need to get out of the machine to reset the Digga crumber bar. The trencher foot can be seen clearly from within the cab and helps the operator to see when the trencher is in the correct trenching position. The spoil auger and barrel clear the spoil faster to increase efficiency and productivity.

FEATURES

- Headstart crumber - start trenching with the crumber bar in the down position
- Adjustable skid foot - ensures the operator trenches to a set depth at all times
- Easy to see trencher foot - visible from within the cab to ensure that the trencher is in the correct position
- Barrel and spoil auger - removes spoil faster
- 3 different chain options - trench in most ground conditions
- Quality made - built with tried and tested materials and components
- 3 year gear box and 2 year motor warranty for complete peace of mind

TRENCHER CHAINS

No ground is too soft and there is no ground too hard for the Bigfoot trencher with chain options available for soft clean grounds to the hardest of shale.

Choose from three types of trencher chains depending on your ground conditions: earth, combination, and Diggatac. What's more, Digga's Diggatac range provides extended tooth life and reduced vibration, particularly when starting in tough conditions.

MINI BIGFOOT TRENCHER

Delivering maximum performance and quality, the mini Bigfoot trencher is designed specifically for mini loaders or those wanting a lighter weight trencher with maximum efficiency. This is the lightest, most compact and power packed mini trencher on the market today and fitted with a 1 5/8" chain.

	Mini Bigfoot
Length	1402 mm
Horizontal	645 mm
Width	989 mm
Motor Size	2K Bell EATON
Hydraulic Flow	40-90 lpm
Max Pressure - Do not exceed	240 bar @ 60 lpm
Max Flow - Do not exceed	95 lpm @ 200 bar
Max Continuous Power	25 Kw (34 hp)
Cutting Width	100, 150, 200 mm
Cutting Depths	Up to 900 mm



BIGFOOT TRENCHER

Ideal for excavators from 1.2T to 4.5T with flows between 30-75lpm, this trencher is suitable for trenching 900mm digging depth and 200mm digging width and fitted with a 1 5/8" chain.

	BFT-900
Length	1920 mm
Horizontal	668 mm
Width	1212 mm
Motor Size	2K Bell EATON
Hydraulic Flow	50-95 lpm
Max Pressure - Do not exceed	240 bar @ 60 lpm
Max Flow - Do not exceed	95 lpm @ 200 bar
Max Continuous Power	25 Kw (34 hp)
Cutting Width	100, 150, 200 mm
Cutting Depths	Up to 900 mm
Weight (150mm combo chain)	261 kg



BIGFOOT XD TRENCHER

Ideal for excavators from 4.5T to 8T with flows between 60-150lpm; this trencher is fitted with a 2" chain, and suitable for heavy duty trenching up to 1500mm digging depth and 300mm digging width. A high flow model is also available.

	BFTXD-900	BFTXD-1200	BFTXD-1200HF	BFTXD-1500HF
Length	2225 mm	2532 mm	2532 mm	2689 mm
Horizontal	777 mm	777 mm	777 mm	836 mm
Width	1212 mm	1212 mm	1212 mm	1212 mm
Motor Size	2K Bell EATON	2K Bell EATON	6K Bell EATON	6K Bell EATON
Hydraulic Flow	60-115 lpm	60-115 lpm	105-170 lpm	105-170 lpm
Max Pressure - Do not exceed	240 bar @ 60 lpm		240 bar @ 130 lpm	
Max Flow - Do not exceed	95 lpm @ 200 bar		160 lpm @ 190 bar	
Max Continuous Power	25 Kw (34 hp)		50 Kw (67 hp)	
Cutting Width		150, 200, 250, 300 mm		
Cutting Depths	Up to 900 mm	Up to 1200 mm	Up to 1200 mm	Up to 1500 mm
Weight (150mm combo chain)	388 kg	405 kg	424 kg	461 kg



CHAINS

All Digga trenchers are available with a variety of chain types and widths to suit your individual needs. We only use anti-back-flex chains to give you better performance.

EARTH

- Cup tooth on every second station.
- Best for soft clean ground with no floaters or tree roots.



COMBO

- Combination of earth and tungsten teeth.
- Suitable for most applications.
- Cuts through hard soils, roots, soft shale and rocky ground.



DIGGATAC

- Full tungsten teeth on every station.
- Best for rocky hard shale, asphalt or even frozen ground.





OVER 500 WORLD WIDE DISTRIBUTORS



DIGGA

DIGGA CENTRAL EUROPE

SERAFIN P.U.H. ANDRZEJ SERAFIN
UL. WIDOKOWA 1
32-088 PRZYBYŚLAWICE
POLAND

OFFICE: 0048 12 43 44 107
WWW.DIGGA-CE.COM
INFO@DIGGA-CE.COM

HEAD OFFICE

4 OCTAL STREET
YATALA QLD 4207
AUSTRALIA

PH: +61 7 3807 3330
EMAIL: INFO@DIGGA.COM

WWW.DIGGA.COM



YOUR LOCAL
AUTHORISED
DIGGA DEALER

IMPORTANT: The attachments shown in this brochure are for illustrative purposes only and may include some non-standard optional extras. All specifications should be regarded as approximate only. For full details contact Digga Central Europe. In the interest of product improvement, Digga reserves the right to change these specifications without prior notice.



DIGGA
YOUR LOCAL DEALER

