

**GHS 175 x 6 x 6660 C**

**Stock Code : 43175666603**

**Reference No : 01-001**

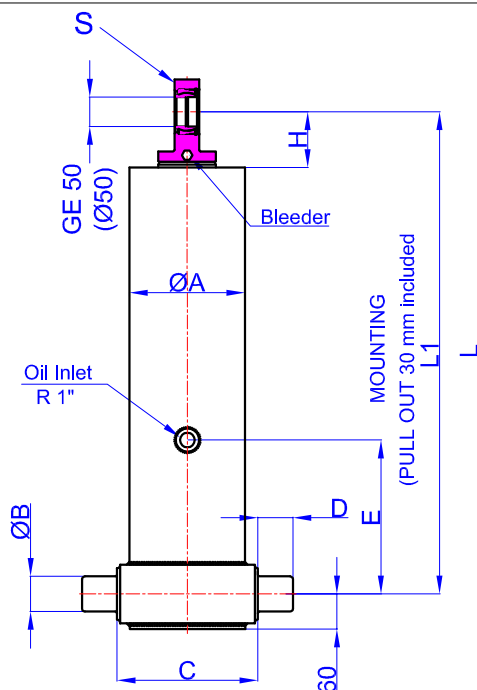

A	:	197	mm
B	:	60	mm
C	:	240	mm
D	:	60	mm
E	:	350	mm
H	:	95	mm
L	:	1397	mm
*L1	:	1427	mm
S	:	42	mm

\* Inc 30 mm pull out :  
 tolerance +20 -0  
 Hard Chromed all stages  
 Working Pressure : 170 Bar  
 Max. Working Pressure : 190 Bar  
 All Cylinder Materials are St  
 52 Cold Drawn Tubes

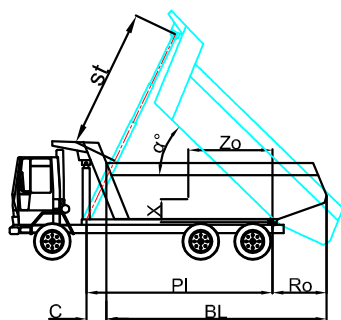

STAGE	1	2	3	4	5	6	7	8	TOTAL
EFFECTIVE DIAMETER (mm)	Ø175	Ø154,5	Ø135	Ø116	Ø98	Ø80			
STROKE	1110	1110	1110	1110	1110	1110			6660
OIL DISPLACEMENT (L)	28	22	17	12,5	9	6			99,5
THRUST AT 170 BAR (TONS)	40	31	24	18	12	8			

BL (body length)	8500			8300			8100		
Ro (rear overhang)	200	500	800	200	500	800	200	500	800
alpha°	45	47	49	46	48	50	48	50	52
Ycog (vert. pos. centre of gravity)									
PI (Pivot length)									
alpha° = st x 60 / PI									
st	6375	6425	6451	6363	6400	6416	6480	6500	6500

Weight : --- Kg

Drawing No : 43175666603-02-001

**Bracket : 47000024-0001**

R	:	60,8	mm
S	:	70	mm
T	:	218	mm
U	:	334	mm
V	:	80	mm
Y	:	152	mm
Z	:	368	mm

\* Bracket are optional

Weight : 16,5 Kg

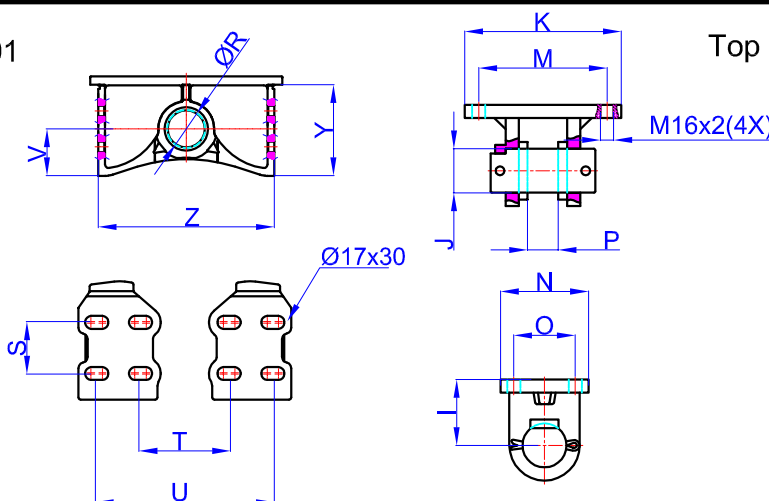

**Top Clavis : 47000026-0001**

I	:	85	mm
J	:	50	mm
K	:	216	mm
M	:	184	mm
N	:	125	mm
O	:	95	mm
P	:	39	mm

\* Bracket are optional