

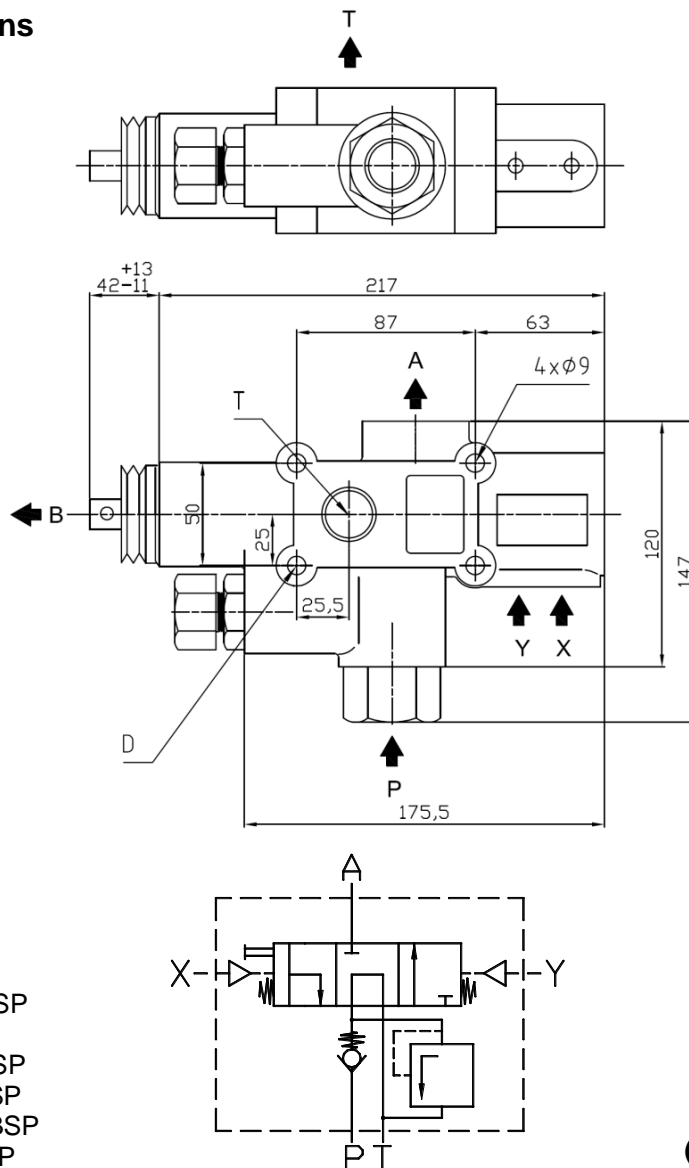

Tipping Valve		Ref. DTCA130
DT	Open Circuit 130 L	

Main Dimensions



- A – Outlet 3/4" BSP
- B – Pull Stroke end
- P – Pump 3/4" BSP
- T – Tank 3/4" BSP
- X – Descent 1/8" BSP
- Y – Ascent 1/8" BSP

(Dimensions in mm)

Main Data

Maximum pressure (Bar)	350
Operating pressure (Bar)	up to 300
Flow rate (l/min)	130
Weight (kg)	5.2

Notes:

- ✓ This tipping valve can be used in progressive descent with our air commands ABCD.
- ✓ Tighten the tipping valve with only three bolts. Do not use the "D" hole. Screw the three bolts with a max. tightening torque of 20 N.m (soft tightening).

ABER is constantly engaged in improving its products and, therefore, reserves itself the right to modify without any further notice the characteristics shown



ABER - Embraiaagens e Comandos Hidráulicos - A. B. LDA
 Rua Francisco de Almeida, Nº 30 – Vila Nova da Telha – 4470 MAIA - Portugal
 Telephone: +351.22.9438070 Fax: +351.22.9420823 e-mail: aber@aber.pt <http://www.aber.pt>