

Welcome to use UNIWA V202T 4G flip feature phone. This user manual will provide with a basic operation guide to you.

Table of Contents

1. Unboxing and Powering On the Phone	01
1.1 Package Contents	01
1.2 Function Description	01
2. Basic Functions	02
2.1 Making Phone Call	02
2.2 Sending Text Message	02
2.3 Answering Call	02
2.4 Adjusting Volume	03
2.5 Listening to Voicemail	03
2.6 Taking Photos and Recording Video	03
3. Contact Management	03
3.1 Adding Contact	03
3.2 Editing Contact Information	04
3.3 Deleting Contact	04
4. Settings	04
4.1 Date and Time Setting	04
4.2 Language Setting	04
4.3 Factory Reset	04
4.4 Profiles	05
4.5 Brightness and Screen Setting	05
4.6 Other Setting	05
5. SOS Emergency Call	05
6. Product Specification	06
7. Technical Support	08

1. Unboxing and Powering On the Phone

1.1 Package Contents

Mobile Phone*1 Charger*1 Battery*1
Charging Dock*1 User Manual*1

1.2 Function Description



Please insert SIM card and battery into the phone as shown in the diagram below:

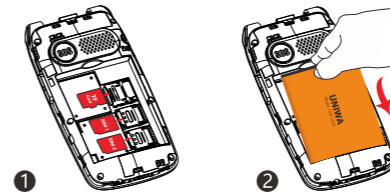

Connect the charger or charging dock to charge the phone until it is fully charged. Press and hold the hang-up button for 5 seconds to power on the phone.

Note: Before installing the battery, make sure to remove the insulation tape from battery contacts, as shown in the diagram on the right:



2. Basic Functions

2.1 Making Phone Call

Turn on the phone, ensure there is a signal, and press the number keys on the dial pad to input the phone numbers. Press the call button to make the call. Press the hang-up button to end the call.

2.2 Sending Text Message

Turn on the phone, press the SMS shortcut key to enter message interface. Then, press the "New Message" option, enter the recipient's phone number, type your message content, and press "Send Message."

Tip: In the message inputting interface, you can press the key to switch input methods.

2.3 Answering Call

When your phone receive an incoming call, you will hear the ringtone. Simply open the phone to answer the call. Press the hang-up button to decline the call.

2.4 Adjusting Volume

To adjust the volume for calls or media playback, open the phone and use the volume +/- keys located on the right side of the phone.

2.5 Listening to Voicemail

Access the voicemail service menu and follow the instructions provided by your mobile carrier to set up voicemail service. Once configured, you can use the service.

2.6 Taking Photos and Recording Video

Open the phone and press the camera shortcut key to enter the camera interface. Aim at the subject you want to capture and press the key to take a photo. Alternatively, press the menu key to select the video recording mode, as shown in the diagram on the right. You can view/manage your photos and videos in the "Multimedia" menu.

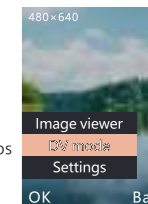

Tip: Insert a TF memory card before recording video.

3. Contact Management

3.1 Adding Contact

Open the phone, enter the contact's number using the keypad, then press the key to create a new contact. Enter the contact's name and phone number, and press the menu key to "Save" the contact.

3.2 Editing Contact Information

Open the phone, press the back key to enter the contact list, use the navigation keys to select the contact you want to edit, press the key to confirm, and then press the key to edit the contact.

3.3 Deleting Contact

Select the contact you want to delete, then press the menu key, choose "Delete" from the menu, and press the key to delete the contact.

4. Settings

4.1 Date and Time

In the "Phone Settings" option, select the "Date and Time" submenu to adjust date and time setting.

4.2 Language Setting

Open the phone, press the menu key to enter the main menu, use the navigation keys to scroll to the "Phone Settings" page, and then press the key to enter the "Phone Settings" options. You will find the "Language Settings" submenu as shown in the diagram on the right.

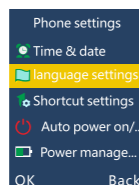

4.3 Factory Reset

In the "Phone Settings" submenu, you will find the "Factory Reset" option. The factory reset password is: **1234**
Note: Before making a factory reset, please backup important data such as your contacts and messages.

4.4 Profiles

In the "Settings" menu, you can find the "Profiles" option. There are five selectable Profiles: Normal, Silent, Meeting, Indoor, and Outdoor. You can choose the appropriate Profiles based on your need, as shown in the diagram below:

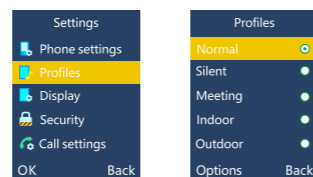

4.5 Brightness and Screen Setting

Go to the "Settings" menu, select the "Display" option, and you can adjust screen brightness and screen timeout setting.

4.6 Other Setting

In the "Applications" menu, you can also find additional features such as Calendar, Calculator, Alarm, Bluetooth, Flashlight, and more.

5. SOS Emergency Call

To access the SOS settings on your phone, please follow these steps:

1. Press the menu key to enter the main menu.
2. Use the navigation keys to the "SOS" menu.
3. Press key to enter SOS settings menu, as shown in the diagram.

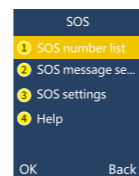

You can set up to 5 emergency contact numbers and one SOS message. In case of an emergency, you can press and hold the emergency call button on the back of the phone for 3 seconds, and the phone will dial the emergency contact numbers and send the SOS message to them.

6. Product Specification

Basic Information	
Model	V202T
Operating System	RTOS (Non-Smart OS)
Dimensions	104*55*19.8mm
Multilingual	Support
Hardware	
Dual Display	- 2.4-inch Inner Display with a resolution of 320*240 pixels - 1.77-inch Outer Display with a resolution of 160*128 pixels
Processor	Unisoc T107 Cat.1
Storage	Supports up to 32GB TF (microSD) card

Camera	Single 0.3MP front camera
Battery	Removable 4.35V Lithium-ion battery
Speaker	2030 BOX Speaker (Supports HAC)
Network and Connectivity	
Network Bands	2G: GSM 850/900/1800/1900MHz
	3G: WCDMA 850/900/1700/1900/2100MHz
	4G: FDD-LTE B1/2/3/4/5/7/8/12/17/20/28a/28b/66 TDD-LTE: B38/40/41
Bluetooth	V3.0
Input/Output Interfaces	
SIM Card Slots	*2 (Nano SIM cards)
TF (microSD) Card Slot	*1
3.5mm Headphone Jack	*1
USB Type-C Port	*1

Features	
SOS Button	Supports up to 5 pre-set SOS contacts and 1 SOS message
Phonebook Capacity	2000 contacts
Flashlight	Support
FM Radio	Support

7. Technical Support

If you encounter any issue, please refer to this user manual or contact our technical support.

Customer support email
2850699288@qq.com

Thank you for choosing UNIWA V202T 4G flip feature phone. We wish you a pleasant experience!

EC REP Prolinx GmbH
Brehmstr.56,40239 Duesseldorf
Germany

Copyright ©2023 Shenzhen Cwell Electronic Technology Co.,Ltd.

FCC Warning:

Any Changes or modifications not expressly approved by the party responsible for compliance could void the user's authority to operate the equipment.

This device complies with part 15 of the FCC Rules. Operation is subject to the following two conditions: (1) This device may not cause harmful interference, and (2) this device must accept any interference received, including interference that may cause undesired operation.

Note: This equipment has been tested and found to comply with the limits for a Class B digital device, pursuant to part 15 of the FCC Rules. These limits are designed to provide reasonable protection against harmful interference in a residential installation. This equipment generates, uses and can radiate radio frequency energy and, if not installed and used in accordance with the instructions, may cause harmful interference to radio communications. However, there is no guarantee that interference will not occur in a particular installation. If this equipment does cause harmful interference to radio or television reception, which can be determined by turning the equipment off and on, the user is encouraged to try to correct the interference by one or more of the following measures:

- Reorient or relocate the receiving antenna.
- Increase the separation between the equipment and receiver.
- Connect the equipment into an outlet on a circuit different from that to which the receiver is connected.
- Consult the dealer or an experienced radio/TV technician for help.

Specific Absorption Rate (SAR) information

SAR tests are conducted using standard operating positions accepted by the FCC with the phone transmitting at its highest certified power level in all tested frequency bands, although the SAR is determined at the highest certified power level, the actual SAR level of the phone while operating can be well below the maximum value. Before a new model phone is available for sale to the public, it must be tested and certified to the FCC that it does not exceed the exposure limit established by the FCC, tests for each phone are performed in positions and locations as required by the FCC.

For body worn operation, this model phone has been tested and meets the FCC RF exposure guidelines when used with an accessory designated for this product or when used with an accessory that contains no metal and that positions the handset a minimum of 5mm from the body.

Non-compliance with the above restrictions may result in violation of RF exposure guidelines.