



PHILADELPHIA

Piazzetta  design

PHILADEPHIA

Gas fireplace with hand-worked earthenware surround. Expert craftsmanship has gone into making the earthenware ornamentation. Each surround is a truly unique piece. Also available in double-sided version for gas burning.

SURROUND WEIGHT: 38 kg

GAS BURNING (NATURAL GAS OR LPG) IG 120

INLET: in grey enamelled steel

FIREBOX: in Aluker®

GLASS: ceramic heat resistant up to 750°C

FUNCTION CONTROL: remote control

CERAMIC LOGS: standard supply

HEATING: convection and radiation

CEILING FLUE GAS OUTLET:

concentric pipe Ø 10/15 cm

WALL FLUE GAS OUTLET:

concentric pipe Ø 13/20 cm

FIREBOX HEAT OUTPUT: 11.5 kW (Natural gas)

10.5 kW (LPG)

THERMAL EFFICIENCY: 80% (Natural gas)

77% (LPG)

CONSUMPTION AT RATED HEAT OUTPUT:

1.1 m³/h (Natural gas)

790 g/h (LPG)

WEIGHT: 125 kg

RATED HEAT OUTPUT: 8.3 kW (Natural gas)

7.3 kW (LPG)

TYPE-EXAMINATION: EC certification E0780

OPTIONAL ACCESSORIES:

- river pebles
- height regulation kit

GAS BURNING (NATURAL GAS OR LPG) IG 120B

INLET: in grey enamelled steel

FIREBOX: in Aluker®

GLASS: ceramic heat resistant up to 750°C

FUNCTION CONTROL: remote control

CERAMIC LOGS: standard supply

HEATING: convection

and radiation

CEILING FLUE GAS OUTLET:

concentric pipe Ø 10/15 cm

WALL FLUE GAS OUTLET:

concentric pipe Ø 13/20 cm

FIREBOX HEAT OUTPUT: 11.5 kW (Natural gas)

10.5 kW (LPG)

THERMAL EFFICIENCY: 80% (Natural gas)

75% (LPG)

CONSUMPTION AT RATED HEAT OUTPUT:

1.1 m³/h (Natural gas)

790 g/h (LPG)

WEIGHT: 119 kg

RATED HEAT OUTPUT: 8.3 kW (Natural gas)

7.3 kW (LPG)

TYPE-EXAMINATION: EC certification E0780

OPTIONAL ACCESSORIES:

- river pebles
- height regulation kit

WOOD BURNING ME 120/48

INLET: in enamelled steel

FIREBOX: in Aluker®

GRATE: in Aluker® with cast iron grid

DOOR: rise n'fall with glass ceramic heat resistant up to 750°C, may also be opened as hinged door for cleaning

PRIMARY AIR: adjustable by hand

SECONDARY AIR: pre-determined

SMOKE DAMPER: automatic and adjustable

ASH DRAWER: removable

HEATING: natural convection or forced

air circulation by Multifuoco System®

on request

FLUE OUTLET: Ø 25 cm

NOMINAL OUTPUT: 16.5 kW

THERMAL EFFICIENCY: 75.5%

NOMINAL CONSUMPTION: 4.8 kg/h

MAX OUTPUT: 17.3 kW

MAX CONSUMPTION: 5.4 kg/h

WEIGHT: 350 kg

Laboratory measurements were made using beech wood with moisture content below 20%

Type approval in accordance with EN13230

OPTIONAL ACCESSORIES:

- ventilation kit Multifuoco System® with automatic or manual switching on and off and 4-speed remote control.
- sensor kit for dual Multifuoco System®
- adjustable height kit

DIMENSIONI:

	IG120	IG120B	ME120/48
A	38,5	38,5	65
B	121	121	123,5
C	12,5	19,5	19,5
ø	20	20	25

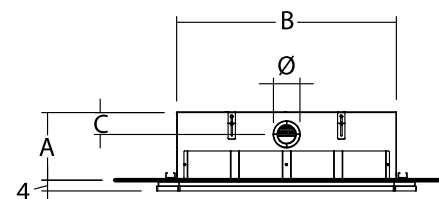
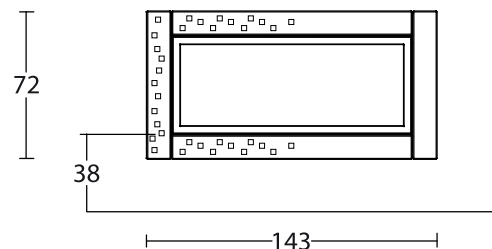

Measurements expressed in cm