

**Commercial offer of
garden outside sauna from
Thermowood Production**

+38(067)410-49-33 – Tel, Viber, WhatsApp, Telegram

<https://lestorg.org.ua>

[Our Youtube chanel](#)

MODULAR SAUNA 6X3M

Price 11 100€

The sauna is delivered ready-made, if installation is necessary on the territory of the Customer, the installation is 10% of the price of the sauna.

Dimensions:

- Length – 6.0 m
- Width - 3.0 m

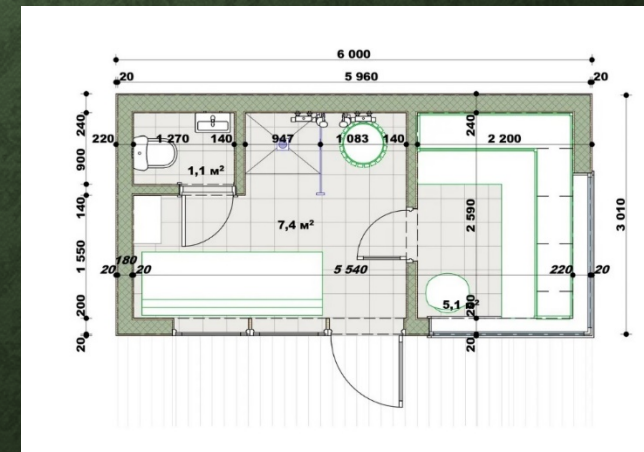

+38(067)410-49-33 – Tel, Viber, WhatsApp, Telegram

MODULAR SAUNA 6X3M

Price 11 100€

The sauna is delivered ready-made, if installation is necessary on the territory of the Customer, the installation is 10% of the price of the sauna.

Dimensions:

- Length – 6.0 m
- Width - 3.0 m

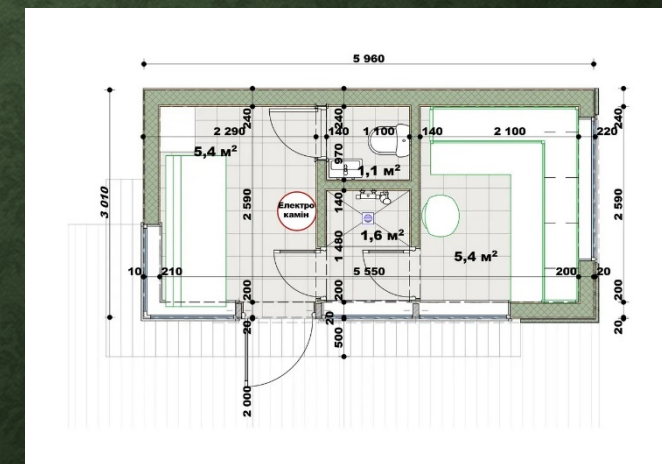

+38(067)410-49-33 – Tel, Viber, WhatsApp, Telegram

MODULAR SAUNA 6X3M

Price 11 100€

The sauna is delivered ready-made, if installation is necessary on the territory of the Customer, the installation is 10% of the price of the sauna.

Dimensions:

- Length – 6.0 m
- Width - 3.0 m

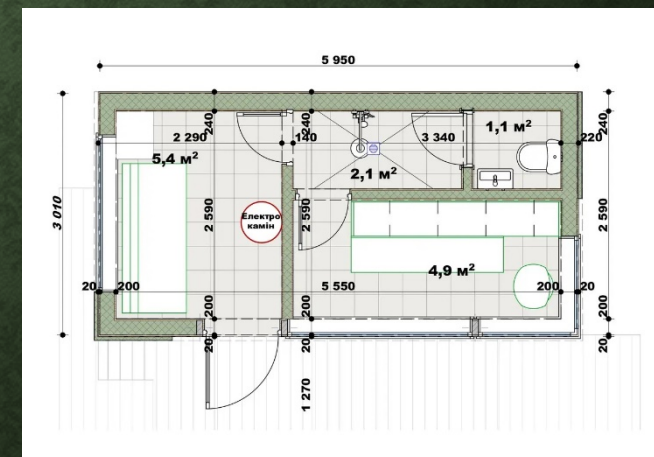

+38(067)410-49-33 – Tel, Viber, WhatsApp, Telegram

MODULAR SAUNA 6X3M

Price 11 100€

The sauna is delivered ready-made, if installation is necessary on the territory of the Customer, the installation is 10% of the price of the sauna.

Dimensions:

- Length – 6.0 m
- Width - 3.0 m

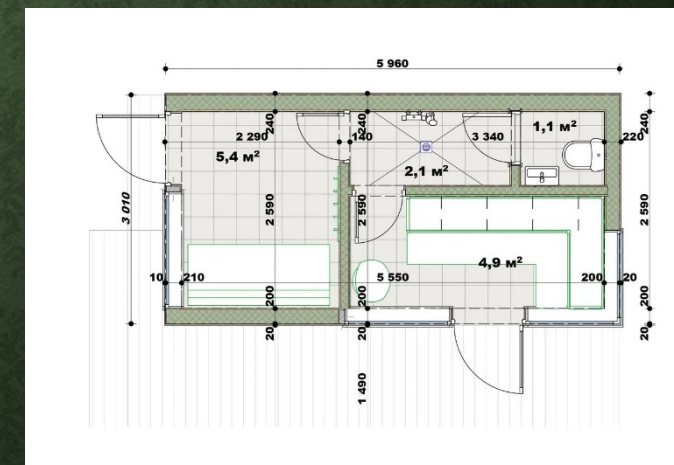

+38(067)410-49-33 – Tel, Viber, WhatsApp, Telegram

MODULAR SAUNA 6X3M

Price 11 100€

The sauna is delivered ready-made, if installation is necessary on the territory of the Customer, the installation is 10% of the price of the sauna.

Dimensions:

- Length – 6.0 m
- Width - 3.0 m

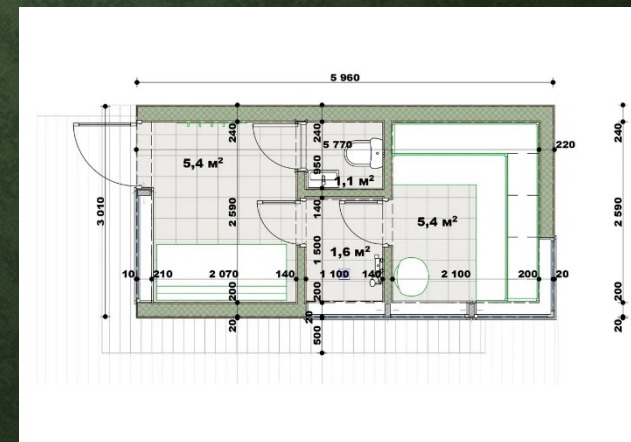

+38(067)410-49-33 – Tel, Viber, WhatsApp, Telegram

MODULAR SAUNA 6X3M

Price 11 100€

The sauna is delivered ready-made, if installation is necessary on the territory of the Customer, the installation is 10% of the price of the sauna.

Dimensions:

- Length – 6.0 m
- Width - 3.0 m

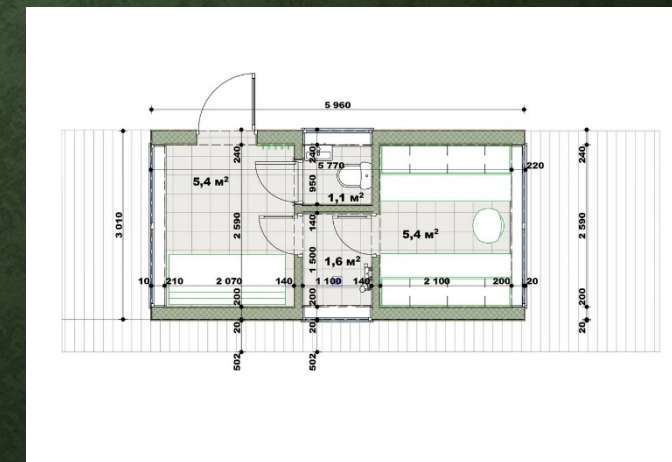

+38(067)410-49-33 – Tel, Viber, WhatsApp, Telegram

MODULAR SAUNA 6X3M

Price 11 100€

The sauna is delivered ready-made, if installation is necessary on the territory of the Customer, the installation is 10% of the price of the sauna.

Dimensions:

- Length – 6.0 m
- Width - 3.0 m

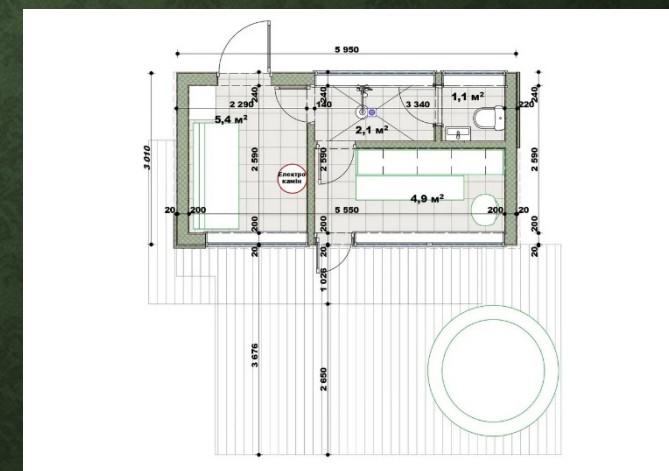

+38(067)410-49-33 – Tel, Viber, WhatsApp, Telegram

MODULAR SAUNA 6X3M

Price 11 800€

The sauna is delivered ready-made, if installation is necessary on the territory of the Customer, the installation is 10% of the price of the sauna.

Dimensions:

- Length – 6.0 m
- Width - 3.0 m

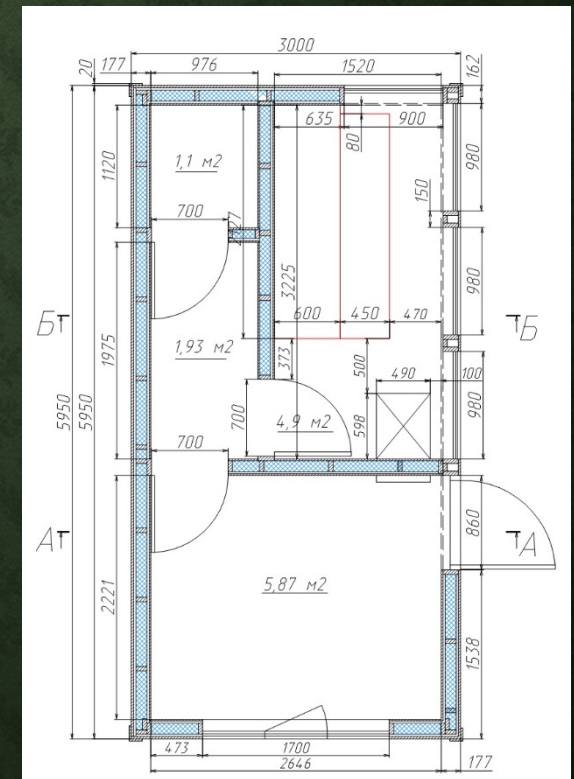

+38(067)410-49-33 – Tel, Viber, WhatsApp, Telegram

MODULAR SAUNA 6X3M

Price 11 650€

The sauna is delivered ready-made, if installation is necessary on the territory of the Customer, the installation is 10% of the price of the sauna.

Dimensions:

- Length – 6.0 m
- Width - 3.0 m

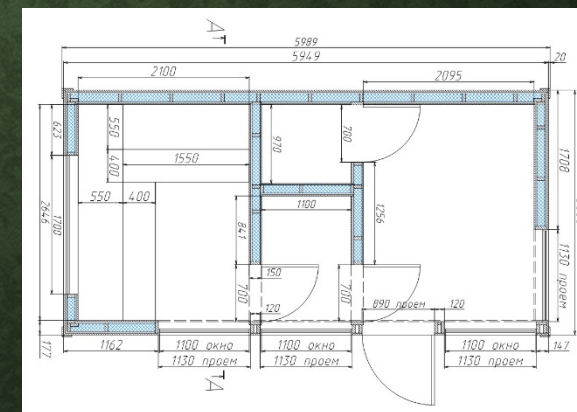

+38(067)410-49-33 – Tel, Viber, WhatsApp, Telegram

MODULAR PANORAMIC SAUNA 4X2.3M

Price 5 710€

The sauna is delivered ready-made, if installation is necessary on the territory of the Customer, the installation is 10% of the price of the sauna.

Dimensions:

- Length – 4.0 m
- Width - 2.3 m



+38(067)410-49-33 – Tel, Viber, WhatsApp, Telegram

MODULAR SAUNA BARN-HOUSE 2.3X4M

Price 6 660€

The sauna is delivered ready-made, if installation is necessary on the territory of the Customer, the installation is 10% of the price of the sauna.

Dimensions:

- Length – 2.3 m
- Width - 4.0 m

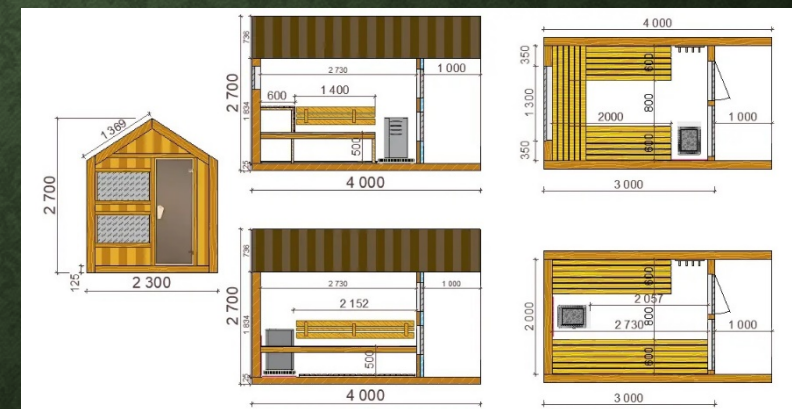

+38(067)410-49-33 – Tel, Viber, WhatsApp, Telegram

MODULAR SAUNA 2.3X3M

Price 3 820€

The sauna is delivered ready-made, if installation is necessary on the territory of the Customer, the installation is 10% of the price of the sauna.

Dimensions:

- Length – 2.3 m
- Width - 3.0 m

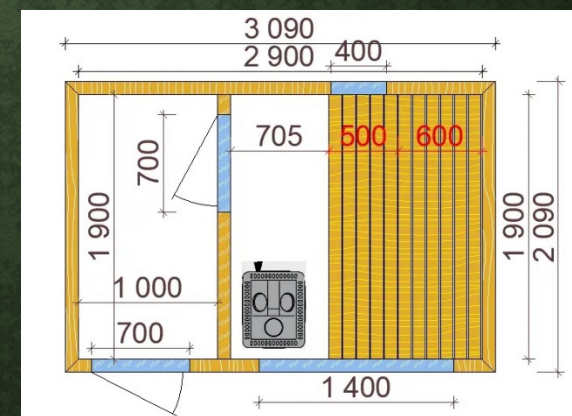

+38(067)410-49-33 – Tel, Viber, WhatsApp, Telegram

Specifications:

Frame	Wooden, made of calibrated pine bar 150*40mm; 100*40mm; dried to 12% moisture
Floor	OSB-10mm EGGER OSB 3; wind protection membrane JUTA W2 85g/m ² ; insulation 150mm Rockwool Rockmin; vapor protective membrane JUTA 120g/m ² ; 32 mm tongue-andgroove pine floor board
The walls	Externally calibrated pine cladding board 110*20mm; rail 40*20mm (for air gap); wind protection membrane JUTA W2 85 g/m ² ; OSB-10mm EGGER OSB 3; insulation 100mm Rockwool Superrock; vapor protective membrane JUTA 120g/m ² ; wooden pine lining.
Roof	profiled flooring with polymer coating, wave height 20mm, thickness 0.48mm, amount of zinc 200 g/m ² ; rail 40*20mm (for air gap); wind protection membrane JUTA W2 85g/m ² ; insulation 150 mm Rockwool Rockmin; vapor protective membrane JUTA 120g/m ² ; wooden pine lining.
Entrance door	Metal-plastic, manufactured by STEKO
Windows	Energy-saving profile, manufacturer STEKO

+38(067)410-49-33 – Tel, Viber, WhatsApp, Telegram

Dyeing	1 coat of Tikkurila Pinja wood stain - all wooden surfaces are also hidden. 2nd layer of Tikkurila Pinja color plus - all external and internal surfaces.
Electrical equipment	Internal wiring: PVA sockets 3×2.5, PVA lighting 3×1, PVA 2×1 Manufacturer INTERELEKTRO; Equipment is not included.
Plumbing equipment	Internal laying of sewers and pipelines (cold/hot water) Equipment not included.

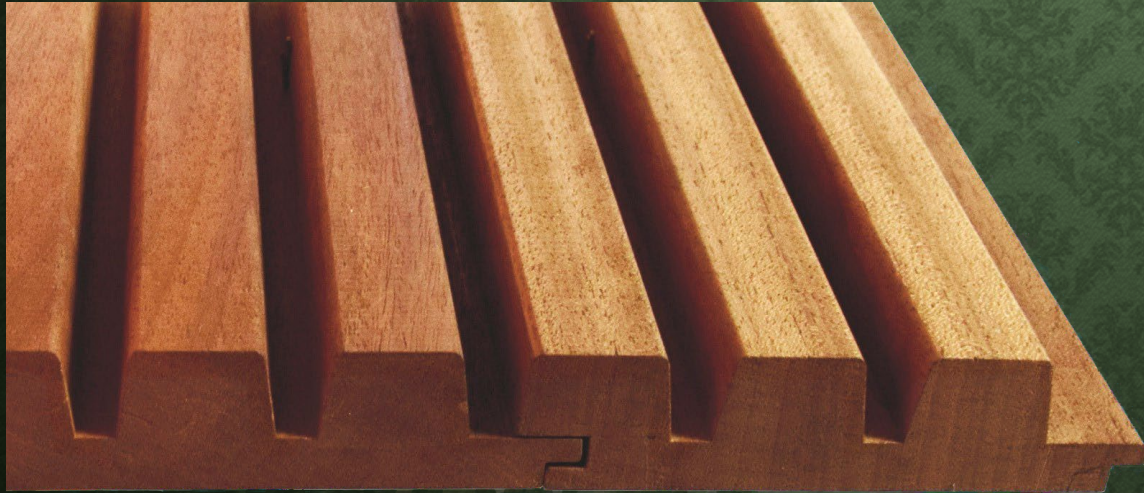

+38(067)410-49-33 – Tel, Viber, WhatsApp, Telegram

Do you still have a questions?

**Ask them to our specialist and get an answer with in
15 minutes**

We are pleased to invite you to our manufacture!

**Export of our products: customs clearance,
registration of the certificate Euro1 to reduce the
cost of customs clearance, phyto certificate.
There are dealers of our products in Europe.**



+38(067)410- 49-33 – Tel, Viber, WhatsApp, Telegram

<https://lestorg.org.ua/> [Our Youtube chanel](#)