

Servo motor datasheet

Inspection Controlled:
Controlled date:

Unannotated technical requirements according to the following implementation
1. Unannotated dimensional tolerances according to GB1804-m;
2. Unspecified dimensional tolerances according to GB1184-k;

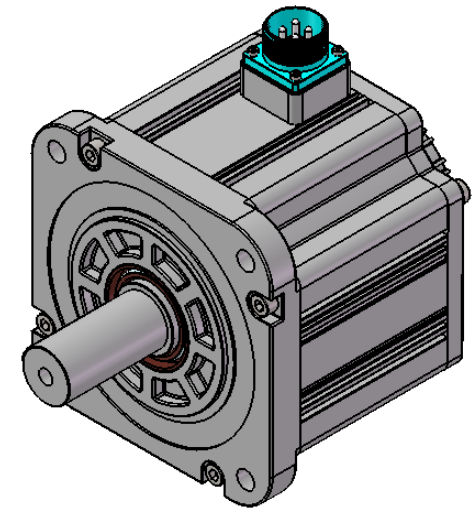
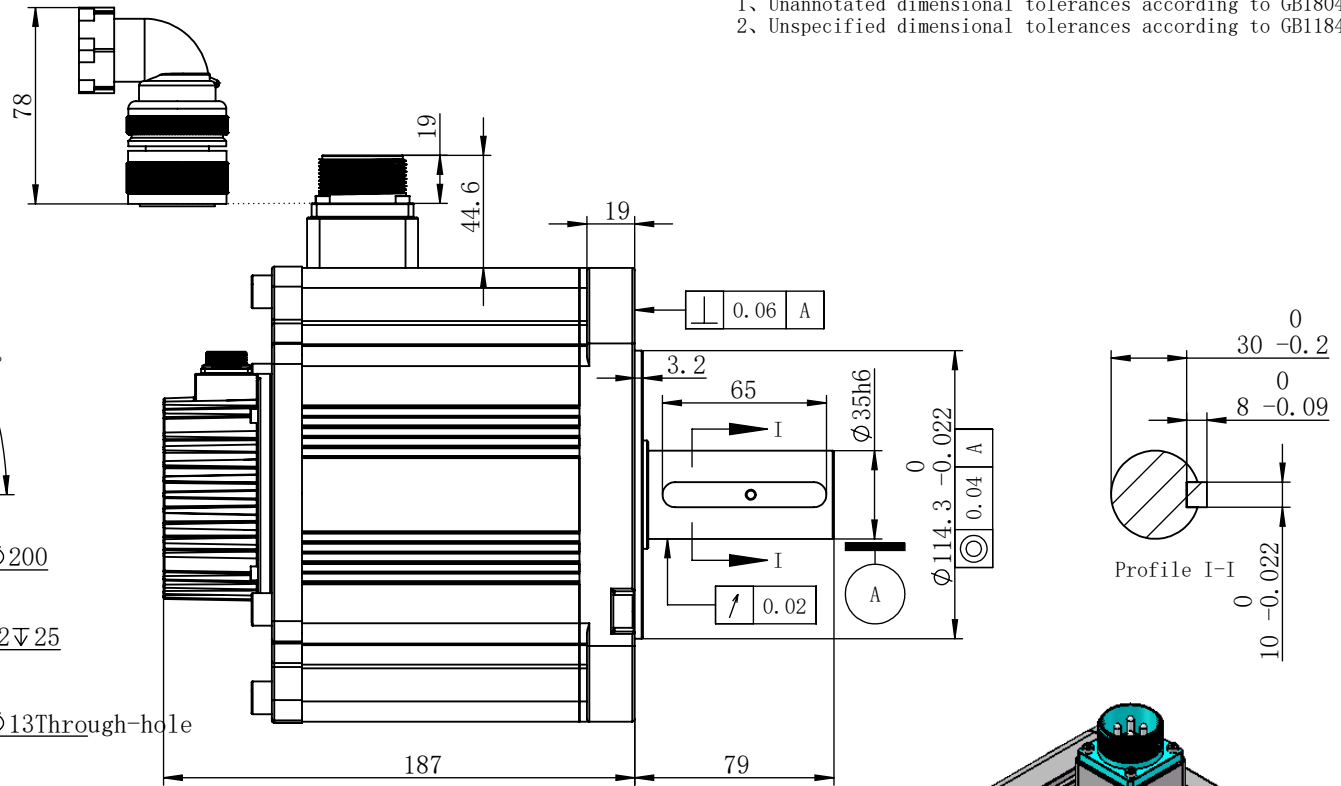
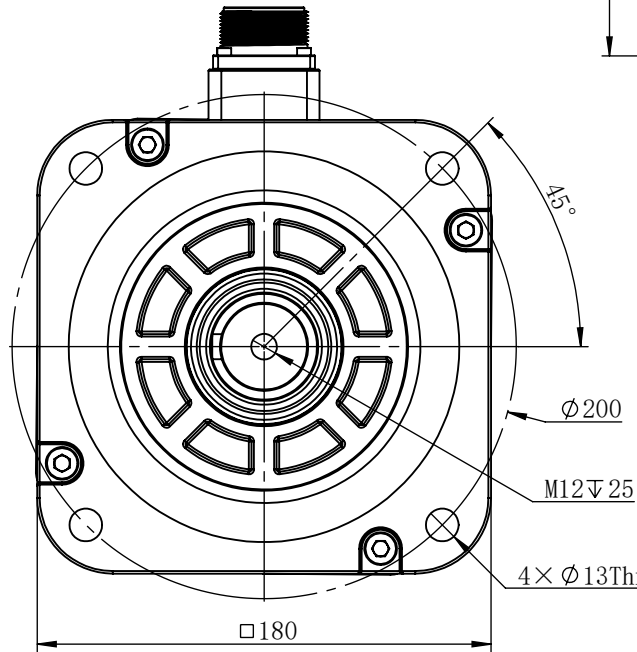

Connector	CMS3102A22-22P-Z			
Pin No.	A	B	C	D
Signal	U	V	W	PE
Colour	Red	Blue	Black	Yellow/green

Connector	16M-9H								
Pin No.	1	2	3	4	5	6	7	8	9
Signal	5V	0V	E+	E-	SD+	SD-	PE	/	/
Colour	Red	Black	Brown	White	Blue	Yellow	Shield	/	/

Motor technical specifications					
Name	Data	Unit	Name	Data	Unit
Rated power	2900	W	Rated voltage	380	V
Rated speed	1500	rpm	Max. speed	2000	rpm
Rated current	7.1	A rms	Peak current	17.75	A rms
Rated torque	18.46	N.m	Peak torque	46.15	N.m
Rotor inertia	49.56	Kg.m ² × 10 ⁻⁴	Feedback element	23bit multi-turn absolute	

T-n characteristic curve:

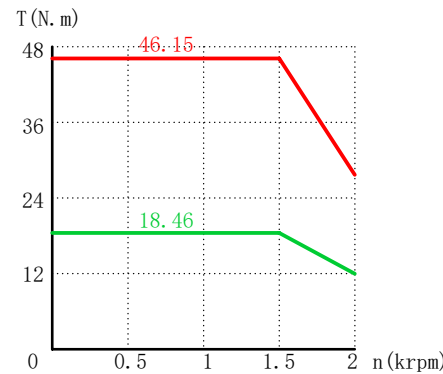

— Rated characteristic curve
— Overload characteristic curve

Suzhou Veichi Electric Co., Ltd View:

Material Name: Servo Motor Design: Wang Zhiqing

Material Code: 9120122236 Date: 2021/10/20

Specifications: V7E-M18D-2R915-D1 VersionA0