

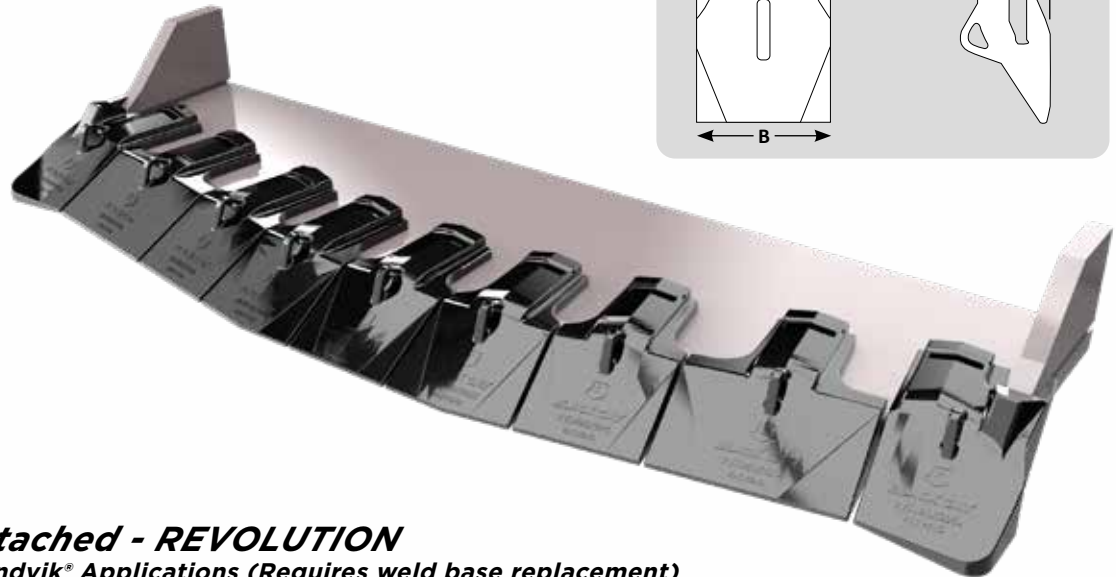

LOAD HAUL DUMP

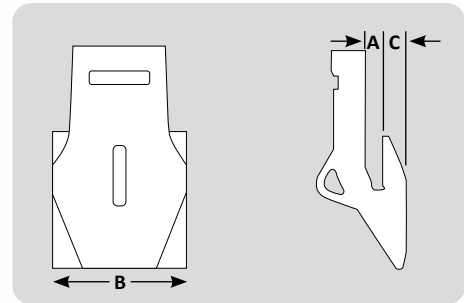

Mechanically Attached - REVOLUTION

For Caterpillar® and Sandvik® Applications (Requires weld base replacement)

Part #	Description	Weight	A	B	C	Base	Rubber Bolt Seat	T-Nut Lock	Bolt
RVSU32X250	STRAIGHT SHROUD	33.2 Kg	32 mm	245 mm	45 mm	RVS7B	RVS1BL	RVS7LP	RVS1B
RVSU32X310	STRAIGHT SHROUD	38.6 Kg		310 mm	45 mm				
RVSU32X380	STRAIGHT SHROUD	47.7 Kg		380 mm	45 mm				
RVSU32X275T	TRANSITION SHROUD	35.5 Kg		300 mm	45 mm				
RVSU32X210L	LEFT END SHROUD	39.2 Kg		244 mm	63 mm				
RVSU32X210R	RIGHT END SHROUD	39.3 Kg		244 mm	63 mm				
RVSU50X290	STRAIGHT SHROUD	49.8 Kg	50 mm	287 mm	51 mm				
RVSU50X330	STRAIGHT SHROUD	54.7 Kg		325 mm	51 mm				
RVSU50X420	STRAIGHT SHROUD	70.8 Kg		415 mm	51 mm				
RVSU50X288T	TRANSITION SHROUD	53.7 Kg		319 mm	51 mm				
RVSU50X235L	LEFT END SHROUD	68.2 Kg		277 mm	78 mm				
RVSU50X235R	RIGHT END SHROUD	68.2 Kg		277 mm	78 mm				

Steps:

1. Insert the rubber / steel lock into the base cavity.
2. Slide the shroud over the base / Lock assembly.
3. Insert the locking plate through the slot in the shroud.
4. Insert and tighten the bolt through the locking plate.

Tighten to approximately 150 foot pounds. Do not overtighten.

RVS Underground Lip Shrouds Installation

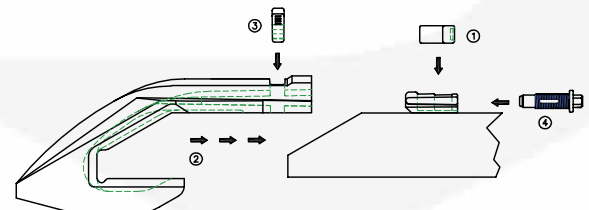

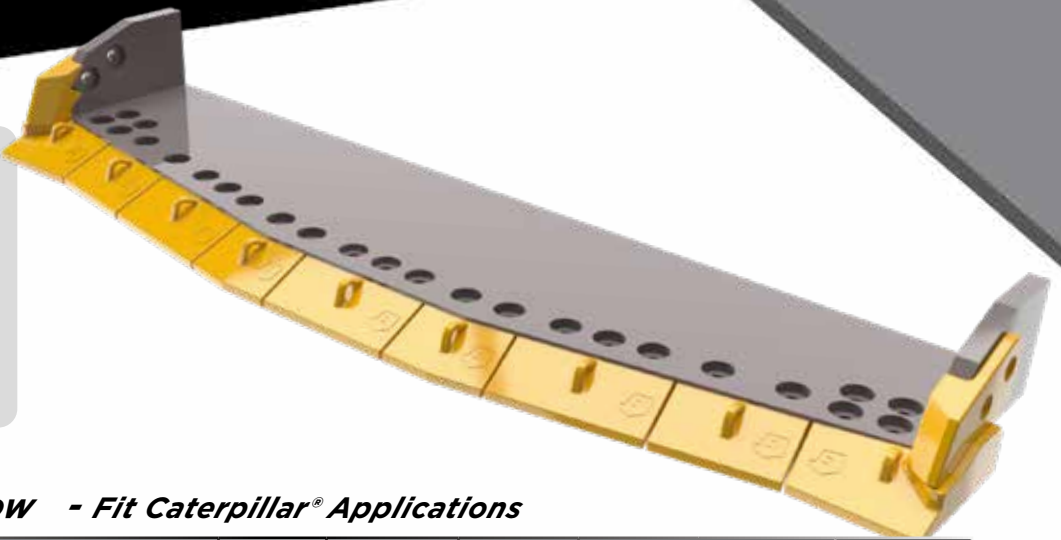
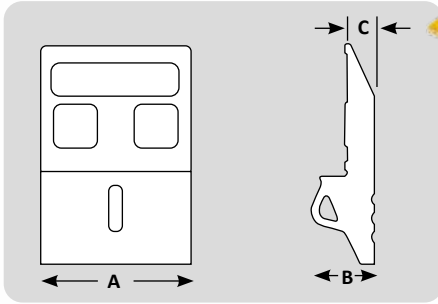

Bolt on - LHD Half Arrow - Fit Caterpillar® Applications

Part #	Description	Weight	A	B	C	Hole Qty	Bolt Diameter
4709309	STRAIGHT SHROUD	42.4 Kg	280 mm	101 mm	55 mm	2	1.25"
4709310	STRAIGHT SHROUD	47.8 Kg	315 mm	101 mm	55 mm	2	1.25"
4709311	STRAIGHT SHROUD	60.9 Kg	405 mm	101 mm	55 mm	3	1.25"
4709308	TRANSITION SHROUD	40.0 Kg	293 mm	101 mm	55 mm	2	1.25"
4709306	RIGHT END SHROUD	66.5 Kg	380 mm	101 mm	55 mm	4	1.25"
4709307	LEFT END SHROUD	66.5 Kg	380 mm	101 mm	55 mm	4	1.25"
4709312	RH END SHROUD HALF LIFE	58.1 Kg	380 mm	101 mm	55 mm	4	1.25"
4709313	LH END SHROUD HALF LIFE	58.1 Kg	380 mm	101 mm	55 mm	4	1.25"
5226266	RH END SHROUD NEW SPACING	73.5 Kg	380 mm	101 mm	55 mm	4	1.25"
5226267	LH END SHROUD NEW SPACING	73.5 Kg	380 mm	101 mm	55 mm	4	1.25"
5569102	RH END SHROUD NEW SPACING HALF LIFE	73.5 Kg	380 mm	101 mm	55 mm	4	1.25"
5569103	LH END SHROUD NEW SPACING HALF LIFE	73.5 Kg	380 mm	101 mm	55 mm	4	1.25"
2530064	CORNER PROTECTOR RIGHT END	17.6 Kg	381 mm	-	32 mm	2	1.25"
2530065	CORNER PROTECTOR LEFT END	17.6 Kg	381 mm	-	32 mm	2	1.25"

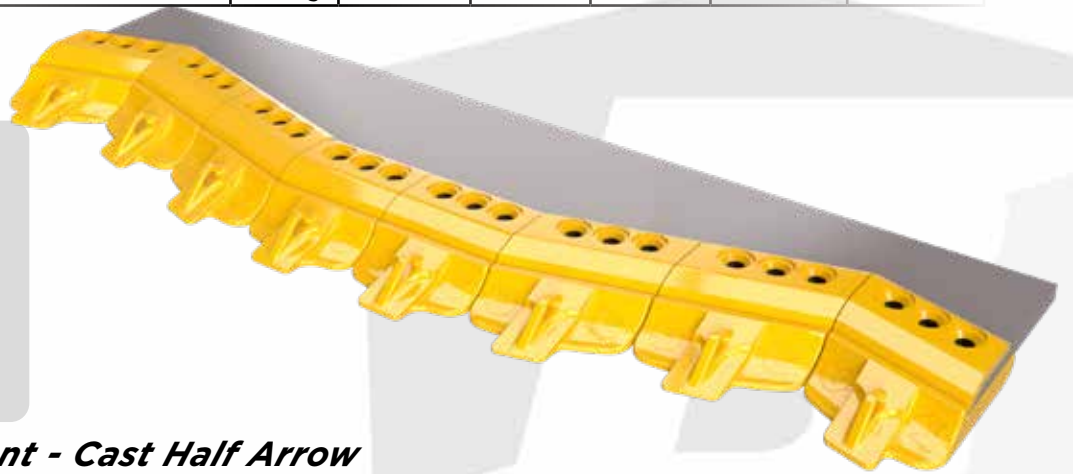
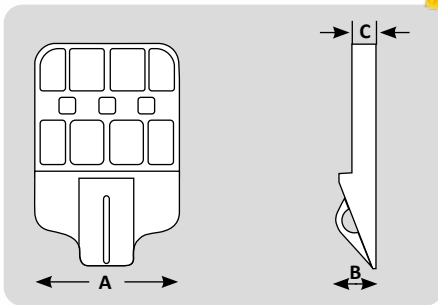

BCWP Toothed Segment - Cast Half Arrow

Part #	Description	Weight	A	B	C	Hole Qty	Bolt Diameter
1099080	HALF ARROW SEGMENT	44.5 Kg	342 mm	79 mm	51 mm	3	1.25"
1099081	HALF ARROW SEGMENT RIGHT END	45.7 Kg	342 mm	79 mm	51 mm	3	1.25"
1099082	HALF ARROW SEGMENT LEFT END	46.4 Kg	342 mm	79 mm	51 mm	3	1.25"
1167460	HALF ARROW SEGMENT	42.5 Kg	312 mm	79 mm	51 mm	3	1.25"
1167461	HALF ARROW SEGMENT RIGHT END	44.4 Kg	312 mm	79 mm	51 mm	3	1.25"
1167462	HALF ARROW SEGMENT LEFT END	44.9 Kg	312 mm	79 mm	51 mm	3	1.25"
1957180	TOP COVER PLATE 1099080	11.3 Kg	342 mm	-	25 mm	3	1.25"
1957181	TOP COVER PLATE 1099081	11.7 Kg	408 mm	-	25 mm	3	1.25"
1957182	TOP COVER PLATE 1099082	11.7 Kg	408 mm	-	25 mm	3	1.25"
2862141	TOP COVER PLATE RH 1167461	10.5 Kg	377 mm	-	25 mm	3	1.25"
2862142	TOP COVER PLATE LH 1167462	10.6 Kg	377 mm	-	25 mm	3	1.25"
2862143	TOP COVER PLATE CTR 1167460	10.1 Kg	312 mm	-	25 mm	3	1.25"

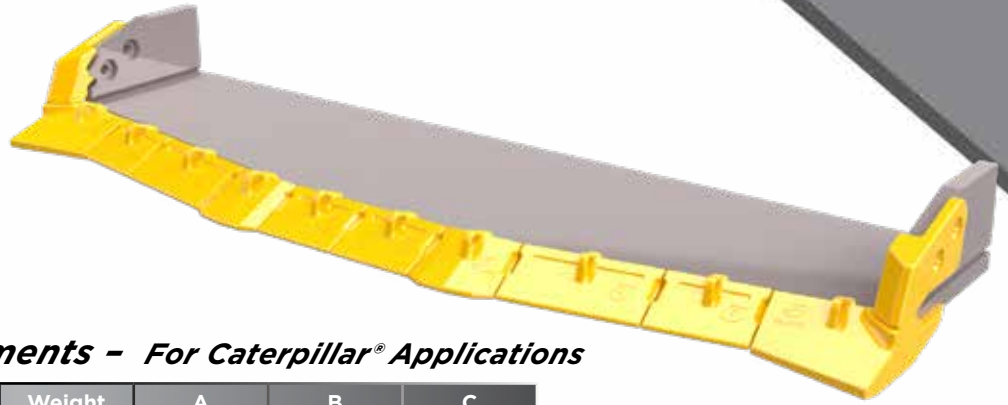
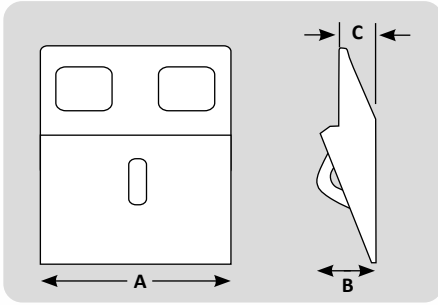

Cast Weld On Modular Segments - For Caterpillar® Applications

Part #	Description	Weight	A	B	C
5816906	LHD HALF ARROW RH	35.8 Kg	384 mm	131 mm	85 mm
5816907	LHD HALF ARROW LH	35.8 Kg	384 mm	131 mm	85 mm
5816908	LHD HALF ARROW TRANSITION	16.7 Kg	273 mm	109 mm	60 mm
5816909	LHD HALF ARROW 280	16.7 Kg	280 mm	109 mm	60 mm
5816910	LHD HALF ARROW 320	19.0 Kg	320 mm	109 mm	60 mm
5816911	LHD HALF ARROW 405	24.0 Kg	405 mm	109 mm	60 mm

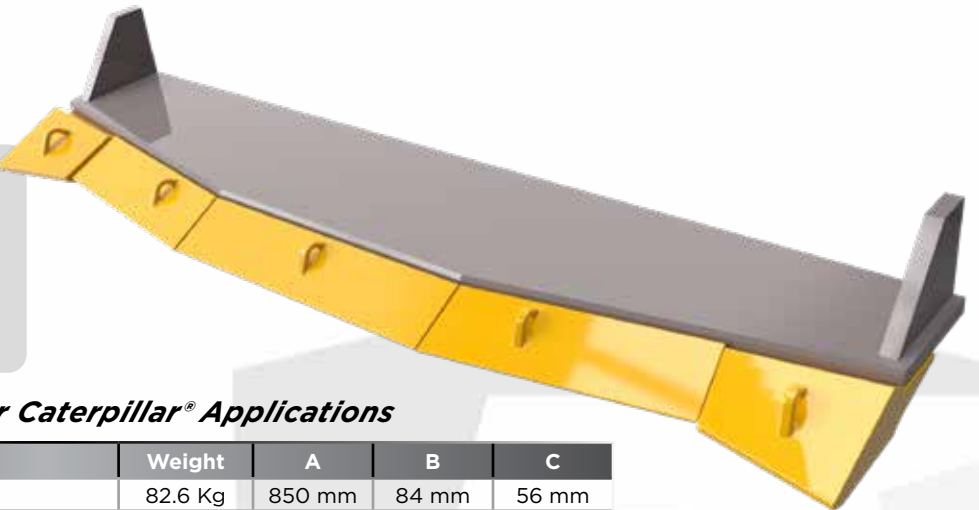
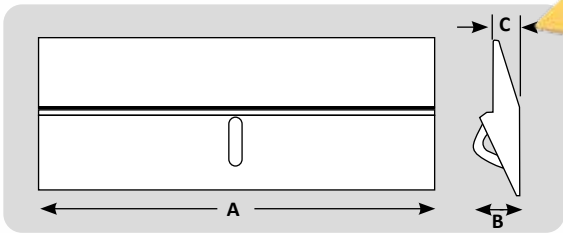

Cast Weld On - Half Arrow For Caterpillar® Applications

Part #	Description	Weight	A	B	C
4160254	HALF ARROW SEGMENT	82.6 Kg	850 mm	84 mm	56 mm
4160255	HALF ARROW SEGMENT	118.6 Kg	1150 mm	84 mm	56 mm
4160253	HALF ARROW SEGMENT LEFT END	61.7 Kg	371 mm	84 mm	56 mm
4160252	HALF ARROW SEGMENT RIGHT END	61.7 Kg	371 mm	84 mm	56 mm

Cast Weld On - For Komatsu® Applications

Part #	Description	Weight	A	B	C
R207	200 CENTER	37.7 Kg	279 mm	105 mm	27 mm
R206-4	200 INTERMEDIATE 18.75"	56.2 Kg	476 mm	79 mm	
R203-RH	200 RH CORNER	82.5 Kg	565 mm	87 mm	
R203-LH	200 LH CORNER	82.5 Kg	565 mm	87 mm	
R802	800 CENTER	69.7 Kg	381 mm	128 mm	40 mm
R802W	800 CENTER W/WING	99.5 Kg	597 mm	128 mm	
R801-4-5-8	800 INTERMEDIATE 22.5"	68.9 Kg	572 mm	92 mm	
R801-7	800 INTERMEDIATE 28.5"	88.9 Kg	724 mm	92 mm	
R810-RH	800 RH CORNER	113.3 Kg	648 mm	111 mm	
R810-LH	800 LH CORNER	113.3 Kg	648 mm	111 mm	

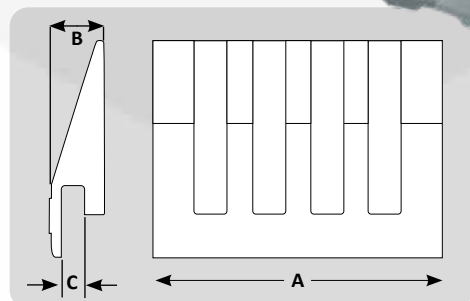

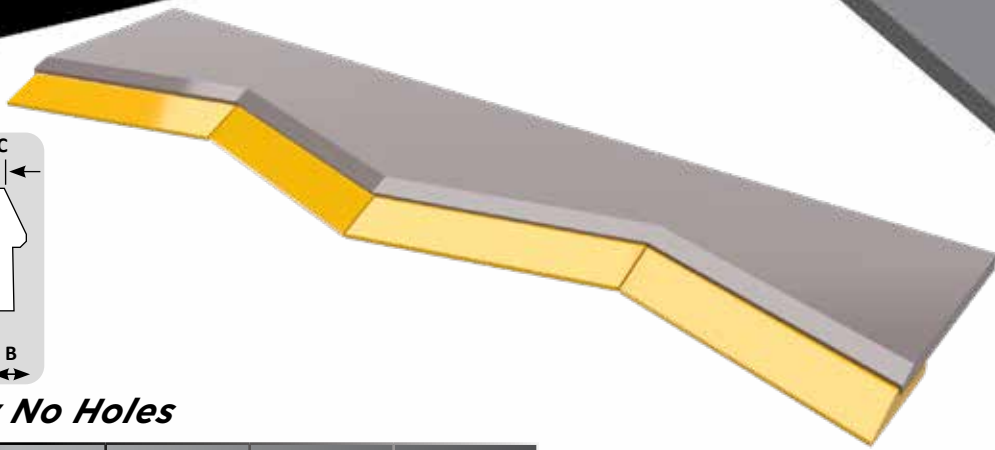
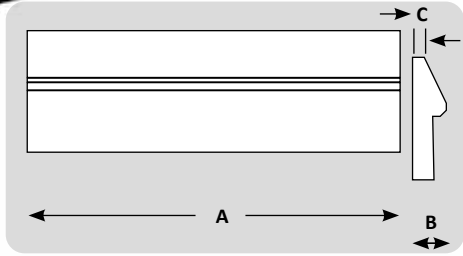

Rolled Weld On - Half Arrow No Holes

Part #	Description	Weight	A	B	C
HA28254-096	HALF ARROW NO HOLES	160.1 Kg	2438 mm	57 mm	28 mm
HA28254-120	HALF ARROW NO HOLES	199.3 Kg	3048 mm	57 mm	28 mm
HA28254-144	HALF ARROW NO HOLES	240.3 Kg	3658 mm	57 mm	28 mm
HA28254-168	HALF ARROW NO HOLES	280.3 Kg	4267 mm	57 mm	28 mm
HA40254-096	HALF ARROW NO HOLES	216.3 Kg	2438 mm	68 mm	40 mm
HA40254-120	HALF ARROW NO HOLES	267.6 Kg	3048 mm	68 mm	40 mm
HA40254-144	HALF ARROW NO HOLES	321.1 Kg	3658 mm	68 mm	40 mm
HA40254-168	HALF ARROW NO HOLES	378.2 Kg	4267 mm	68 mm	40 mm

***Note:** Custom fit pieces for any machine, lengths for cutting in field or from factory available if information is provided.

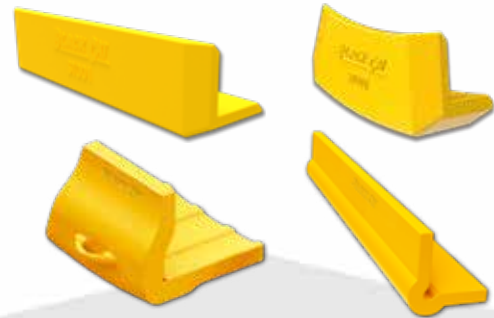
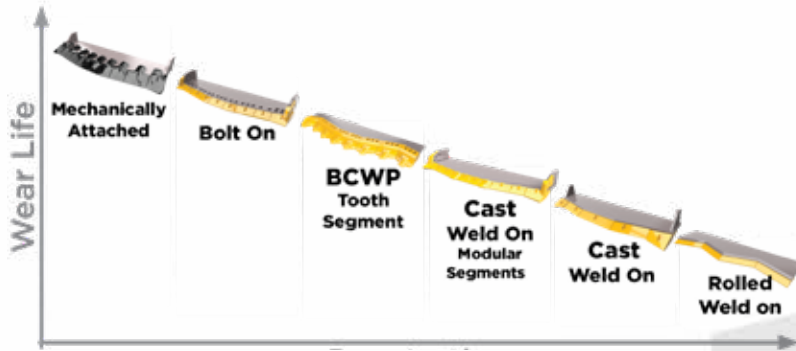

Corner Protectors

Part #	Description	Weight	Length	A	B	C
CG24-5	Round Edge	14.2 Kg	610 mm	99 mm	89 mm	16 mm
CG36-6	Square Edge	30.7 Kg	914 mm	105 mm	92 mm	19 mm
ST001	Straight Shroud	15.1 Kg	457 mm	101 mm	76 mm	25 mm
ST002	Curved Shroud	13.2 Kg	298 mm	119 mm	76 mm	43 mm

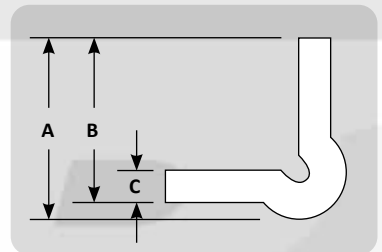

Weld On Heel Shrouds

Part #	Description	Weight	A	B	C	D
138 6551	Heel Shroud - Curved	12.2 Kg	175 mm	207 mm	150 mm	25 mm
138 6529	Heel Shroud - Straight	13.4 Kg	175 mm	207 mm	150 mm	25 mm
157 1027	Heel Shroud - Curved	26.8 Kg	249 mm	270 mm	200 mm	30 mm
157 1019	Heel Shroud	29.5 Kg	249 mm	270 mm	200 mm	30 mm
280 4078	Heel Shroud - Straight	4.9 Kg	119 mm	150 mm	109 mm	20 mm
280 4079	Heel Shroud - Curved	4.2 Kg	119 mm	150 mm	109 mm	20 mm
ES6697-2	Heel Shroud - Curved	20.8 Kg	190 mm	252 mm	152 mm	58 mm
ES6697-3	Heel Shroud - Curved	13.5 Kg	190 mm	178 mm	102 mm	32 mm
ES6697-4	Heel Shroud - Curved	10.1 Kg	190 mm	178 mm	102 mm	32 mm
ES6697-5	Heel Shroud - Curved	39.6 Kg	254 mm	305 mm	203 mm	51 mm
ES6697-7	Heel Shroud	85.9 Kg	250 mm	345 mm	251 mm	100 mm

