

SR-2828 Single Zone RF Wireless LED Dimmer Full Touch User Manual

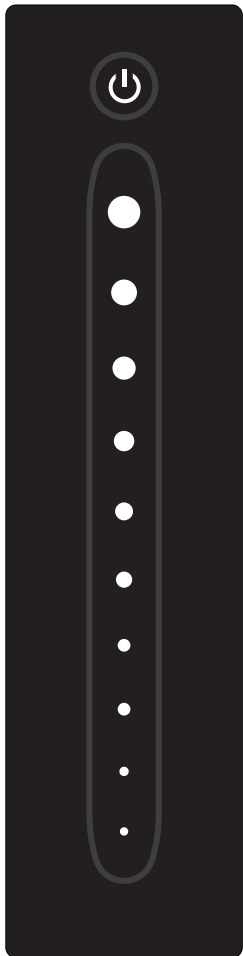

1. Product introduction

The SR-2828 and its receiver is a Single Zone RF Wireless LED Dimmer. It lets you individually control multiple receivers in sync in single zone.

One remote can control endless of receivers in sync; One receiver can be controlled by max 8 remotes.

2. Performance Parameter

2.1 RF Remote: (SR -2828)

Operation voltage: 3VDC Cr2025 Battery

Operation frequency: 434MHZ / 868MHZ

RF Wireless Control distance: 20M

2.2 RF Receiver (all receivers below have Push Dim function, which can be controlled by unlocked push switch):

SR-2501: 12-36VDC input, 4 channels x 5A, constant voltage, 4 channels x (60-180)W

SR-2501EA: 12-24VDC input, 4 channels x 8A, constant voltage, 4 channels x (96-192)W

SR-2502: 12-36VDC input, 4 channels x 350mA, constant current, 4 channels x (4.2-12.6)W

SR-2503: 12-36VDC input, 4 channels x 700mA, constant current, 4 channels x (8.4-25.2)W

Remote: SR-2828

SR-2501TC: 12-36VDC input, 2 channels x 5A, constant voltage, 2 channels x (60-180)W

SR-2502TC: 12-36VDC input, 2 channels x 350mA, constant current, 2 channels x (4.2-12.6)W

SR-2503TC: 12-36VDC input, 2 channels x 700mA, constant current, 2 channels x (8.4-25.2)W

SR-2501S: 12-36VDC input, 1 channel x 8A, constant voltage, 1 channel x (96-288)W

SR-2502S: 12-36VDC input, 1 channel x 350mA, constant current, 1 channel x (4.2-12.6)W

SR-2503S: 12-36VDC input, 1 channel x 700mA, constant current, 1 channel x (8.4-25.2)W



Receiver: SR-2501

3.Wiring diagram

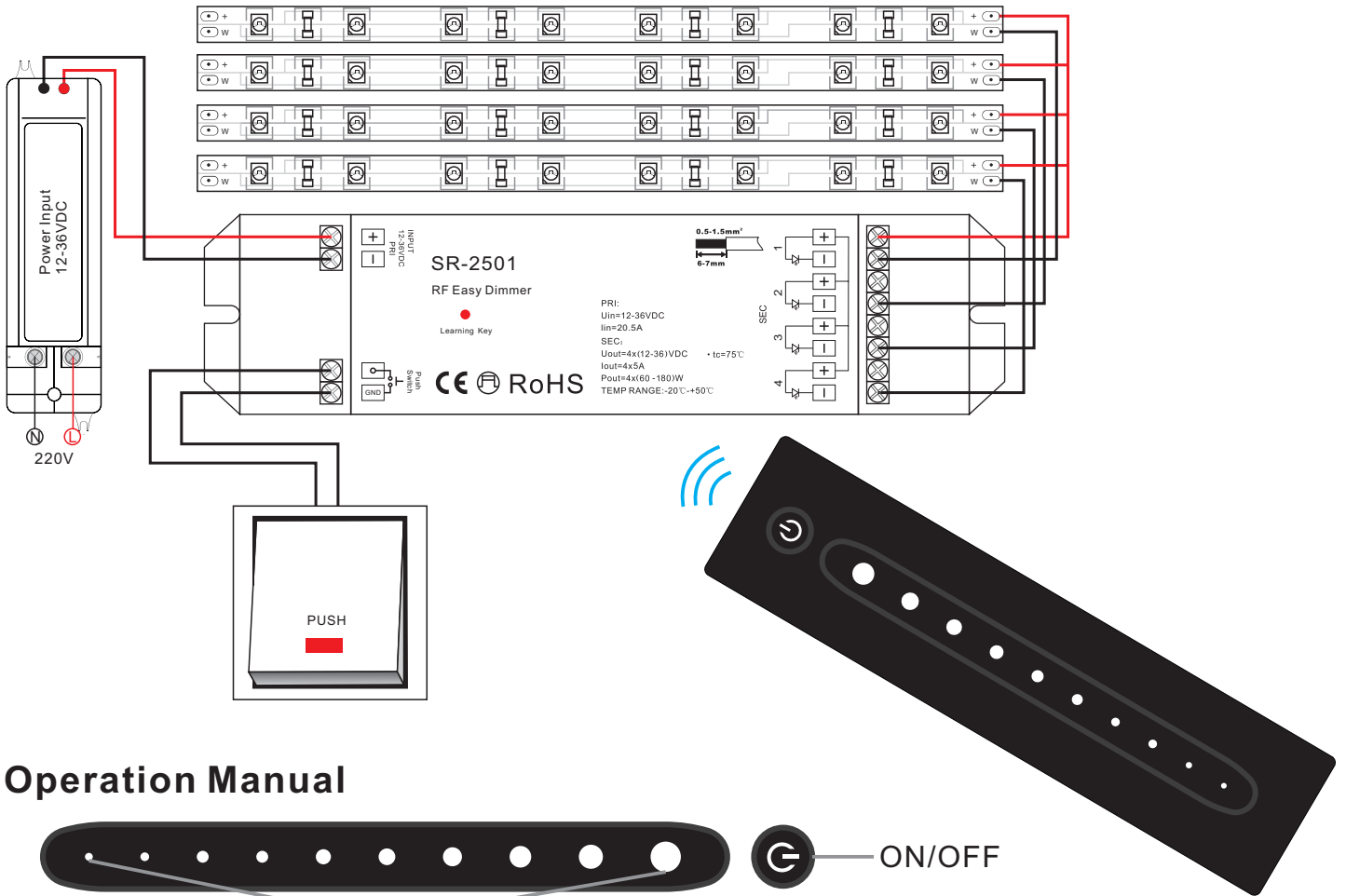

4.Operation Manual



1-100% 256 levers smooth dimming range

After you have wired all the receivers according to Figure illustration you need to do the following:

- 4.1 Pull off the plastic film cover of the battery at the back of remote.
- 4.2 Pair remote with receiver: short press the Learning Key on the receiver, then immediately short press any one of the keys on the remote . Once you do that, the LED lights will blink once. Now your remote and receiver are paired!
- 4.3 Do the same for the other receivers if you use them. The receiver has a special "Learning Key". You can add as many optional receivers as you wish, you can have an endless number of receivers to be controlled in sync, which will let you escalate any installation from small to super-size.

Memory Reset:

In case you want to reset the memory of the receiver, press "Learning Key" for 10 seconds while the unit is being powered. The unit will then reset to factory defaults.

Re assigning the receiver to a different remote is easy, just repeat Step 2 as above.

