



Reset Scala Aperta o Chiusa mono e multi frequenza (Soffitta-Parete-Terrazza-Soppalco-Thermo)

Reset mono and multi frequency with open or closed ladder (Loft-Wall-Terrace-Mezzanine-Thermo)

Apertura - Opening
Chiusura - Closing
Led ON/OFF

1A Verificare la carica del radiocomando.

1A Check the charge of the remote control.

1 - Cavo LED
1 - LED Cable
2 - Motore Grande
2 - Big Engine
3 - Motore Piccolo
3 - Small Engine
4 - Ricevente WI FI
4 - WI FI Receiver

2.1A Verificare la posizione corretta dei plug nella centralina.

2.1A Verify the correct position of the plugs inserted in the control unit.

1 - Motore
1 - Engine
2 - Cavo LED
2 - LED Cable
3 - Pulsantiera
3 - Keypad

2.2A Verificare la posizione corretta dei plug nella centralina.

2.2A Verify the correct position of the plugs inserted in the control unit.

2020 ➡

3A Procedura idonea per lotti prodotti dal 2020, tutti altri lotti sono esclusi.

3A The procedure is suitable for batches produced from 2020, all other batches are excluded.

Laccio sblocco manuale
Quick release string

4A Ad ogni uso del laccio di sblocco manuale, obbligatorio reset scala.

4A For any use of the quick release string, you must reset the ladder.

5A Non stazionare sulla scala e assicurarsi di non ostacolarla.

5A Do not stand on the ladder and do not obstruct it.

6A Prendere il radiocomando e dirigerlo al centro botola.

6A Take the remote control and point it at the centre hatch.

7A Azionare e garantire la pressione dei tasti a simbolo simultaneamente, escludendo altri eventuali.

7A Operate the symbol keys and ensure they are pressed simultaneously, excluding any others.

8A Mantenere la pressione sui tasti, la scala potrà chiudersi a step.

8A Maintain the keys pressed, the ladder may close in jerky movements.

9A Ad ogni eventuale blocco di step, ripetere il punto 7A.

9A If jerky movements do not happen, repeat point 7a.

10A A raggiungimento della botola chiusa lasciare i due tasti a simbolo. (11A inizio a scala chiusa)

10A Once the hatch has been closed, release the two symbol keys. (procedure 11A starts with the closed ladder).

11A Azionare e garantire la pressione dei tasti a simbolo simultaneamente per 60 secondi, escludendo altri eventuali.

11A Operate the symbol keys and ensure they are pressed simultaneously for 60 seconds, excluding any others.

12A Procedura terminata, la Vostra scala è pronta all'uso.

12A The procedure is ended, your ladder is ready to be used.

13A 1- A procedura fallita, ripeterla.
1- If the procedure fails, repeat it.

2- A ulteriore fallimento, verificare accensione led su alimentatore.
2- If the procedure fails again, check the LEDs ignition on the power supply.

3- Rimuovere pannello.
3- Remove the panel.

4- Sfilare il perno motore con estrema attenzione.
4- Remove the steel pin very carefully.

5- Adagiare la scala al pavimento.
5- Lay the ladder on the floor.

6- Verificare accensione led su alimentatore.
6- Check the LEDs ignition on the power supply.

7- Ripristinare il perno motore.
7- Restore the steel pin.

8- Procedura terminata, la Vostra scala è pronta all'uso.
8- The procedure is ended, your ladder is ready to be used.

9- Nel caso di nuovo fallimento, contattare il fornitore.
9- If the procedure continues to fail, contact the supplier.



Abbinamento radiocomando multifrequenza a Scala Aperta (Soffitta-Terrazza-Soppalco-Thermo)

Multi-frequency remote control synchronisation with open ladder (Loft-Wall-Terrace-Mezzanine-Thermo)

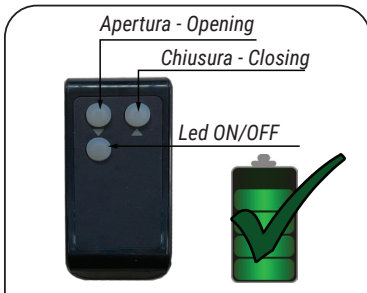

1B Verificare la carica del radiocomando.

1B Check the charge of the remote control.

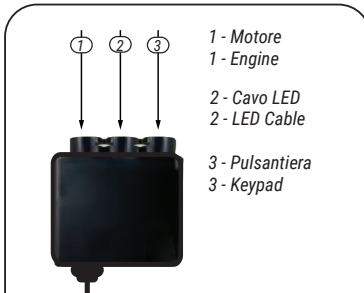

2B Verificare la posizione corretta dei plug nella centralina.

2B Verify the correct position of the plugs inserted in the control unit.



3B Procedura idonea per lotti prodotti dal 2020, tutti altri lotti sono esclusi.

3B The procedure is suitable for batches produced from 2020, all other batches are excluded.

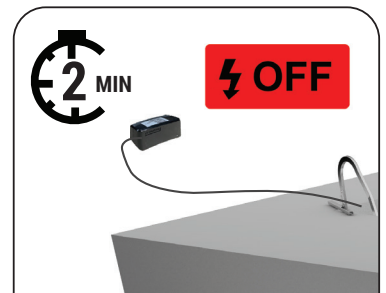

4B Togliere la corrente alla scala o all'immobile, attendere 2 minuti.

4B Turn off the power supply to the ladder or building, wait for 2 minutes.



5B Prendere il radiocomando e direzionarlo al centro botola.

5B Take the remote control and point it to the centre hatch.

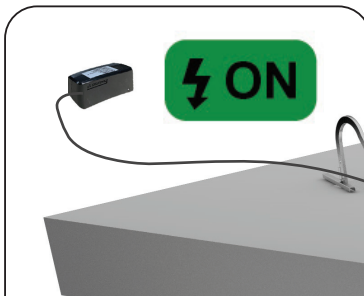

6B Ripristinare la corrente.

6B Restore the power supply.



7B Azionare e garantire la pressione sul tasto a simbolo per 10 secondi, escludendo altri eventuali.

7B Operate the symbol key and ensure it is pressed simultaneously for 10 seconds, excluding any others.



8B Lasciare il tasto a simbolo, attendere 10 secondi.

8B Release the symbol key, wait for 10 seconds.



9B Non stazionare sulla scala e accertarsi di non ostacolarla.

9B Do not stand on the ladder and do not obstruct it.



10B Azionare e garantire la pressione dei tasti a simbolo simultaneamente escludendo altri eventuali.

10B Operate the symbol keys and ensure they are pressed simultaneously, excluding any others.

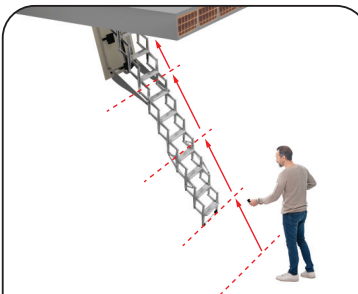

11B Mantenere la pressione sui tasti, la scala potrà chiudersi a step.

11B Maintain the keys pressed, the ladder may close in jerky movements.

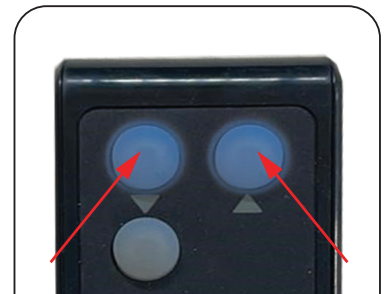

12B Ad ogni eventuale blocco di step, ripetere il punto 10B.

12B If jerky movements do not happen, repeat point 10B.



13B A botola chiusa mantenere la pressione sui tasti per 60 secondi.

13B Once the hatch is closed, maintain the keys pressed for 60 seconds.

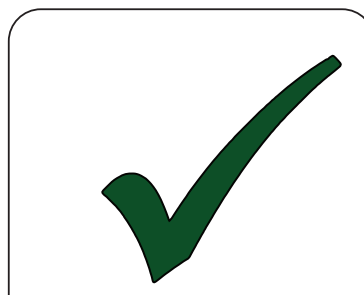

14B Procedura terminata, la Vostra scala è pronta all'uso.

14B The procedure is ended, your ladder is ready to be used.



Abbinamento radiocomando multifrequenza a Scala Chiusa (Soffitta- Terrazza-Soppalco-Thermo)

Multi-frequency remote control synchronisation with open ladder (Loft-Wall-Terrace-Mezzanine-Thermo)

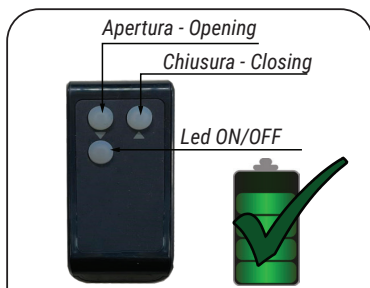

1C Verificare la carica del radiocomando.

1C Check the charge of the remote control.

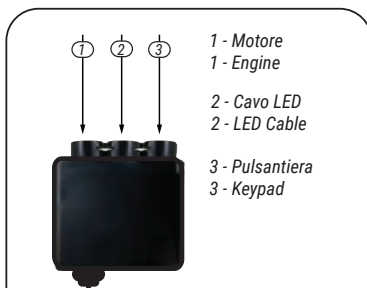

2.C Verificare la posizione corretta dei plug nella centralina.

2.C Verify the correct position of the plugs inserted in the control unit.



3C Procedura idonea per lotti prodotti dal 2020, tutti gli altri lotti sono esclusi.

3C The procedure is suitable for batches produced from 2020, all other batches are excluded.

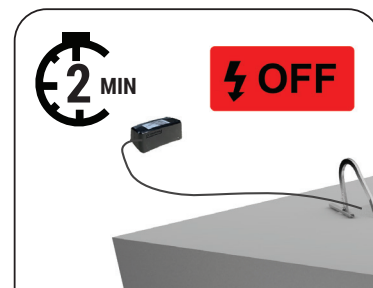

4C Togliere la corrente alla scala o all'immobile, attendere 2 minuti.

4C Turn off the power supply to the ladder or building, wait for 2 minutes.

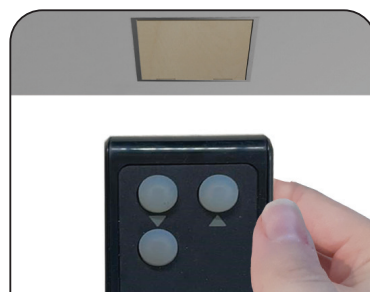

5C Prendere il radiocomando e direzionarlo al centro botola.

5C Take the remote control and point it to the centre hatch.

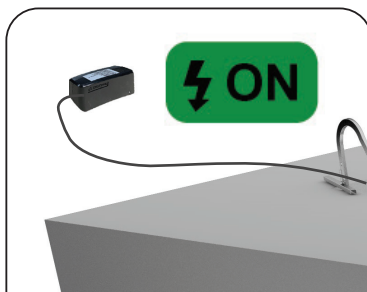

6C Ripristinare la corrente.

6C Restore the power supply.



7C Azionare e garantire la pressione sul tasto a simbolo per 10 secondi, escludendo altri eventuali.

7C Operate the symbol key and ensure it is pressed simultaneously for 10 seconds, excluding any others.



8C Lasciare il tasto a simbolo, attendere 10 secondi.

8C Release the symbol key, wait for 10 seconds



9C Non stazionare sulla scala e accertarsi di non ostacolarla.

9C Do not stand on the ladder and do not obstruct it.



10C Azionare e garantire la pressione dei tasti a simbolo simultaneamente per 60 secondi, escludendo altri eventuali.

10C Operate the symbol keys and ensure they are pressed simultaneously for 60 seconds, excluding any others.



11C Procedura terminata, la Vostra scala è pronta all'uso.

11C The procedure is ended, your ladder is ready to be used.

12C 1- A procedura fallita, ripeterla. 1- If the procedure fails, repeat it.		5- Adagiare la scala al pavimento. 5- Lay the ladder on the floor.	
2- A ulteriore fallimento, verificare accensione led su alimentatore. 2- If the procedure fails again, check the LEDs ignition on the power supply.		6- Verificare accensione led su alimentatore. 6- Check the LEDs ignition on the power supply.	
3- Rimuovere pannello. 3- Remove the panel.		7- Ripristinare il perno motore. 7- Restore the steel pin.	
4- Sfilare il perno motore con estrema attenzione. 4- Remove the steel pin very carefully.		8- Procedura terminata, la Vostra scala è pronta all'uso. 8- The procedure is ended, your ladder is ready to be used.	
		9- Nel caso di nuovo fallimento, contattare il fornitore. 9- If the procedure continues to fail, contact the supplier.	

		5- Adagiare la scala al pavimento. 5- Lay the ladder on the floor.	
		6- Verificare accensione led su alimentatore. 6- Check the LEDs ignition on the power supply.	
		7- Ripristinare il perno motore. 7- Restore the steel pin.	
		8- Procedura terminata, la Vostra scala è pronta all'uso. 8- The procedure is ended, your ladder is ready to be used.	
		9- Nel caso di nuovo fallimento, contattare il fornitore. 9- If the procedure continues to fail, contact the supplier.	

		5- Adagiare la scala al pavimento. 5- Lay the ladder on the floor.	
		6- Verificare accensione led su alimentatore. 6- Check the LEDs ignition on the power supply.	
		7- Ripristinare il perno motore. 7- Restore the steel pin.	
		8- Procedura terminata, la Vostra scala è pronta all'uso. 8- The procedure is ended, your ladder is ready to be used.	
		9- Nel caso di nuovo fallimento, contattare il fornitore. 9- If the procedure continues to fail, contact the supplier.	



Cambio canale radiocomando multifrequenza (Soffitta- Terrazza-Soppalco-Thermo)

Multi-frequency remote control channel change (Loft-Wall-Terrace-Mezzanine-Thermo)

Apertura - Opening
Chiusura - Closing
Led ON/OFF



1D Verificare la carica del radiocomando.

1D Check the charge of the remote control.

1 - Motore
1 - Engine
2 - Cavo LED
2 - LED Cable
3 - Pulsantiera
3 - Keypad



2.D Verificare la posizione corretta dei plug nella centralina.

2.D Verify the correct position of the plugs inserted in the control unit.

2020 >>

3D Procedura idonea per lotti prodotti dal 2020, tutti gli altri lotti sono esclusi.

3D The procedure is suitable for batches produced from 2020, all other batches are excluded.

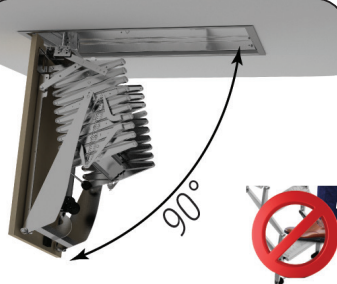

4D Aprire la botola a 90° non stazionare sulla scala e accertarsi di non ostacolarla.

4D Open the hatch at 90°, do not stand on the ladder and do not obstruct it.



5D Posizionare tutti i canali frequenza 1-2-3-4-5-6 nella posizione OFF sul radiocomando nella zona batteria.

5D Place all the 1-2-3-4-5-6 frequency channel in the OFF position on the remote control in the battery area.

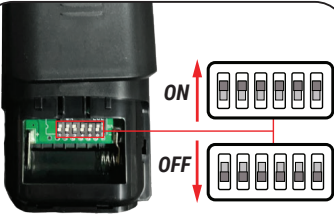

6D Scegliere il canale di frequenza desiderato, posizionarlo nella posizione ON.

6D Select the desired frequency channel and place it in the ON position.



7D Azionare e garantire la pressione dei tasti a simbolo simultaneamente escludendo altri eventuali.

7D Operate the symbol keys and ensure they are pressed simultaneously for 60 seconds, excluding any others.



8D Procedura terminata, la Vostra scala è pronta all'uso.

8D The procedure is ended, your ladder is ready to be used.



Sincronizzazione radiocomando mono frequenza a Scala Aperta o Chiusa (Soffitta-Parete-Terrazza-Soppalco-Thermo)

Mono-frequency remote control synchronisation with open-closed ladder (Loft-Wall-Terrace-Mezzanine-Thermo)

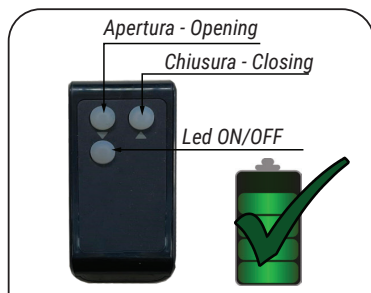

1E Verificare la carica del radiocomando.

1E Check the charge of the remote control.

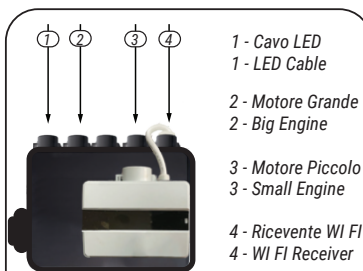

- 1 - Cavo LED
1 - LED Cable
- 2 - Motore Grande
2 - Big Engine
- 3 - Motore Piccolo
3 - Small Engine
- 4 - Ricevente WI FI
4 - WI FI Receiver

2.E Verificare la posizione corretta dei plug nella centralina.

2E Verify the correct position of the plugs inserted in the control unit.

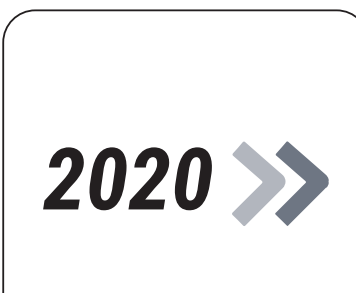

3E Procedura idonea per lotti prodotti dal 2020, tutti altri lotti sono esclusi.

3E The procedure is suitable for batches produced from 2020, all other batches are excluded.

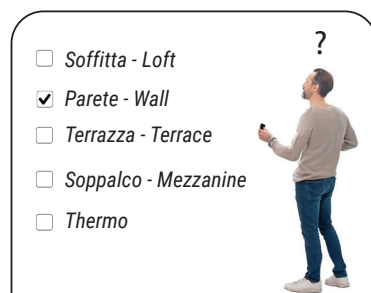

- Soffitta - Loft
- Parete - Wall
- Terrazza - Terrace
- Soppalco - Mezzanine
- Thermo

4E Individuare modello con pannello o senza pannello.

4E Identify the model with panel or without panel.

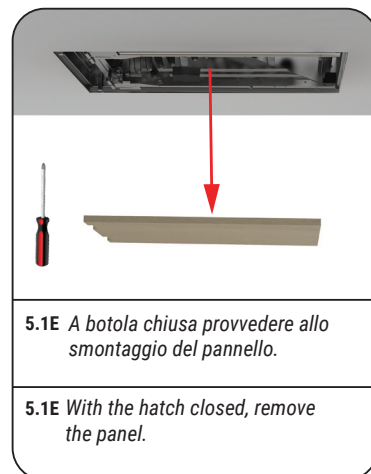

5.1E A botola chiusa provvedere allo smontaggio del pannello.

5.1E With the hatch closed, remove the panel.

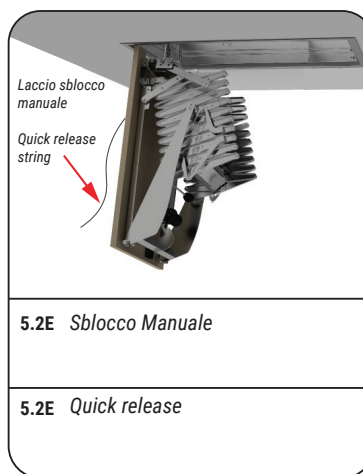

5.2E Sblocco Manuale

5.2E Quick release

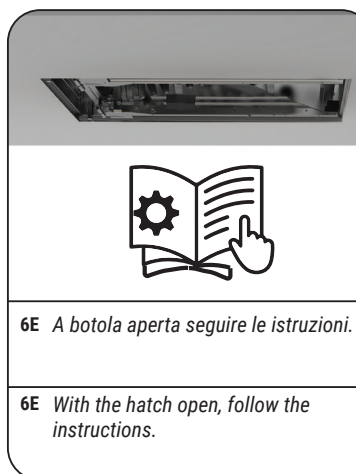

6E A botola aperta seguire le istruzioni.

6E With the hatch open, follow the instructions.



7E Non stazionare sulla scala e accertarsi di non ostacolarla.

7E Do not stand on the ladder and do not obstruct it.

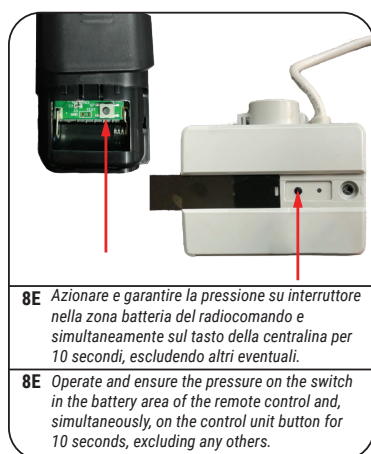

8E Azionare e garantire la pressione su interruttore nella zona batteria del radiocomando e simultaneamente sul tasto della centralina per 10 secondi, escludendo altri eventuali.

8E Operate and ensure the pressure on the switch in the battery area of the remote control and, simultaneously, on the control unit button for 10 seconds, excluding any others.

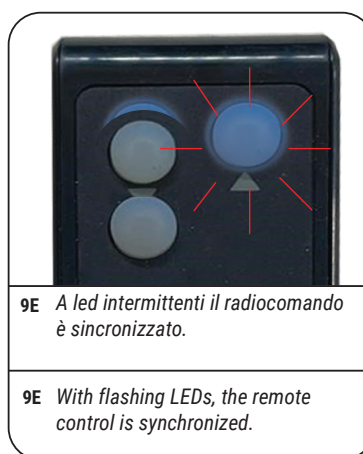

9E A led intermittenti il radiocomando è sincronizzato.

9E With flashing LEDs, the remote control is synchronized.

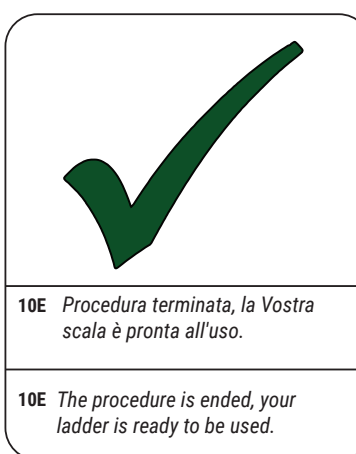

10E Procedura terminata, la Vostra scala è pronta all'uso.

10E The procedure is ended, your ladder is ready to be used.

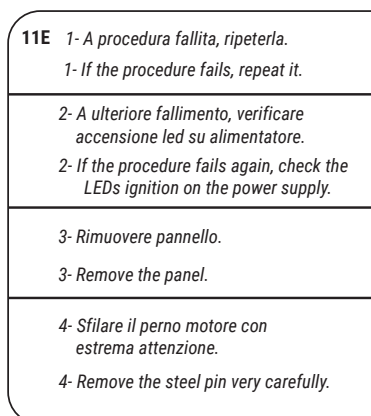

11E 1- A procedura fallita, ripeterla.
1- If the procedure fails, repeat it.

2- A ulteriore fallimento, verificare accensione led su alimentatore.
2- If the procedure fails again, check the LEDs ignition on the power supply.

3- Rimuovere pannello.
3- Remove the panel.

4- Sfilare il perno motore con estrema attenzione.
4- Remove the steel pin very carefully.

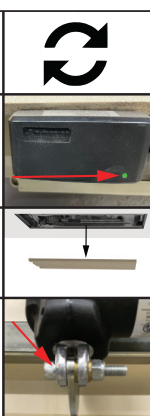

5- Adagiare la scala al pavimento.
5- Lay the ladder on the floor.

6- Verificare accensione led su alimentatore.
6- Check the LEDs ignition on the power supply.

7- Ripristinare il perno motore.
7- Restore the steel pin.

8- Procedura terminata, la Vostra scala è pronta all'uso.
8- The procedure is ended, your ladder is ready to be used.

9- Nel caso di nuovo fallimento, contattare il fornitore.
9- If the procedure continues to fail, contact the supplier.

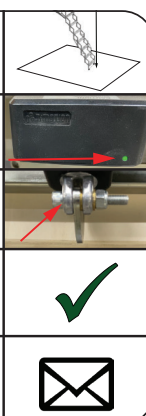



Regolazione fine corsa attuatore apertura-chiusura botola (Soffitta-Parete-Terrazza-Soppalco-Thermo)

Limit switch adjustment of the opening-closing hatch actuator (Loft-Wall-Terrace-Mezzanine-Thermo)

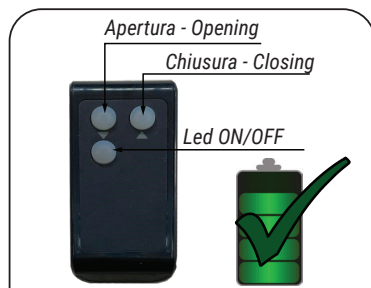

1F Verificare la carica del radiocomando.

1F Check the charge of the remote control.

2020 >>

2F Procedura idonea per lotti prodotti dal 2020, tutti altri lotti sono esclusi.

2F The procedure is suitable for batches produced from 2020, all other batches are excluded.



3F Non stazionare sulla scala e accertarsi di non ostacolarla.

3F Do not stand on the ladder and do not obstruct it.

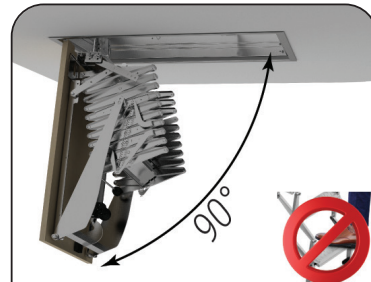

4F Aprire la botola a 90° non stazionare sulla scala e accertarsi di non ostacolarla.

4F Open the hatch at 90°, do not stand on the ladder and do not obstruct it.



5F Procurarsi un giravite a stella

5F Get a Phillips screwdriver.

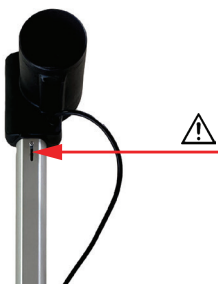

6F Prestare attenzione, applicare mini spostamenti del fine corsa.

6F Pay attention, apply small movements to the limit switch.

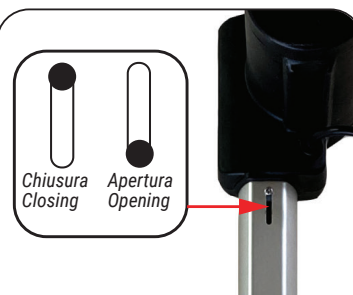

7F Lo spostamento millimetrico del fine corsa motore regola apertura o chiusura botola.

7F The millimeter movement of the motor limit switch adjusts the opening or closing hatch.



8F Azionare e garantire la pressione sul tasto a simbolo, escludendo altri eventuali.

8F Operate the symbol key and ensure it is pressed, excluding any others.

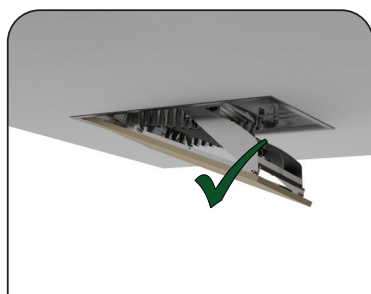

9F Verificare la variazione della apertura-chiusura botola ottenuta.

9F Check the variation of the opening-closing hatch obtained.



10F Procedura terminata, la Vostra scala è pronta all'uso.

10F The procedure is ended, your ladder is ready to be used.



Scala Retrattile Pantografo AutoAttic Vip® Soffitta Pantograph AutoAttic Vip® Loft Ladder

① Contenuto del pacco - Packaging content

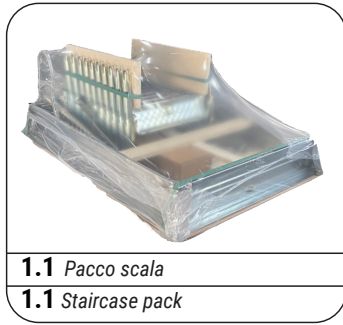

1.1 Pacco scala
1.1 Staircase pack

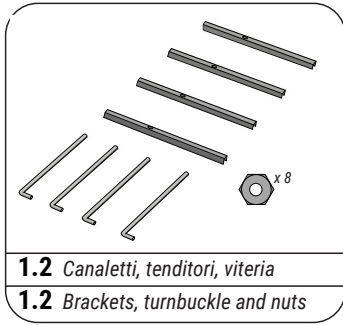

1.2 Canaletti, tenditori, viteria
1.2 Brackets, turnbuckle and nuts

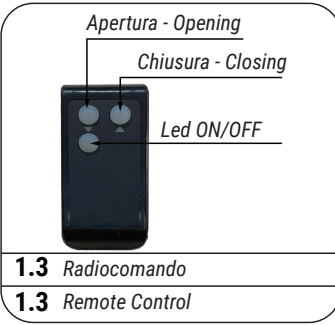

1.3 Radiocomando
1.3 Remote Control

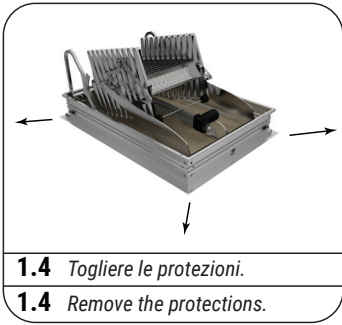

1.4 Togliere le protezioni.
1.4 Remove the protections.

② Installazione scala - Staircase installation

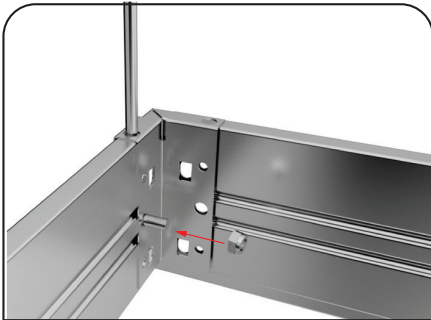

2.1 Avvitare i quattro tenditori di sostegno al nervo-telaio.

2.1 Screw the filetted bars to teh staircase frame.

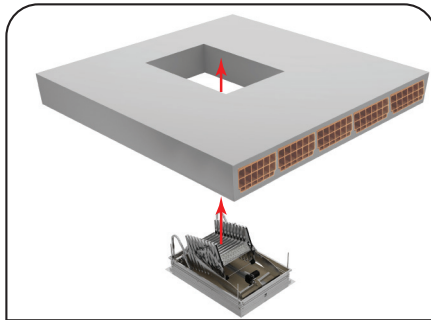

2.2 Inserire dal basso verso l'alto il pacco scala nel foro solaio.

2.2 From the bottom to the top, insert the staircase pack in the opening of the ceiling.

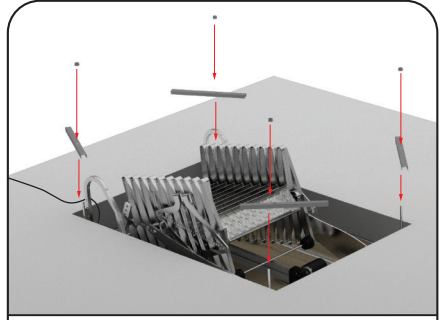

2.3 Bloccare la scala al telaio inserendo i quattro canaletti di sostegno nei tenditori e bloccarli con gli appositi dadi.

2.3 Block the staircase to the ceiling by inserting the four support brackets into the turnbuckles and block them with the appropriate nuts.

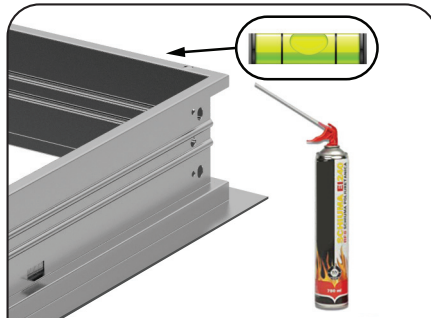

2.4 Assicurarsi che il nervo-telaio sia in bolla! Utilizzare schiuma poliuretana.

2.4 Make sure that the staircase frame is leveled! Use polyurethane foam.

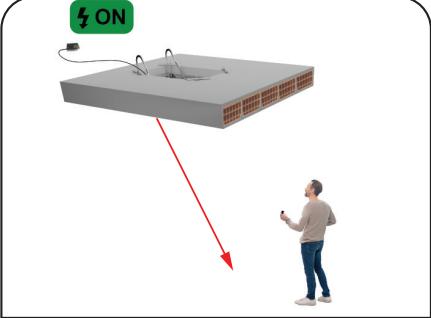

2.5 Premere il pulsante di apertura posto sul radiocomando per far aprire la scala.

2.5 Press the opening switch of the remote to open the ladder.

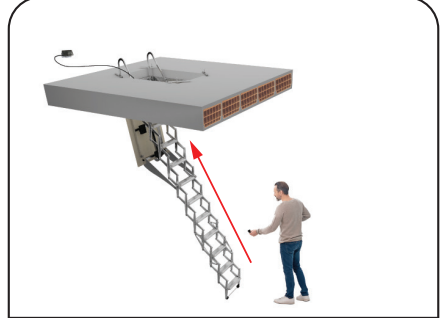

2.6 Premere il pulsante di chiusura posto sul radiocomando per far chiudere la scala.

2.6 Press the closing switch of the remote to close the ladder.



2.7 Si consiglia la lubrificazione con olio singer o similari ogni 12 mesi.

2.7 Lubrication with singer or similar oils is recommended every 12 months.

Grazie per aver scelto un prodotto ITALIANO!
Thank you for buying a product Made in ITALY!





Scala Retrattile Pantografo AutoAttic Soffitta Pantograph AutoAttic Loft Ladder

① Contenuto del pacco - Packaging content

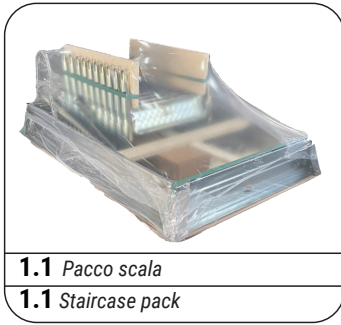

1.1 Pacco scala
1.1 Staircase pack

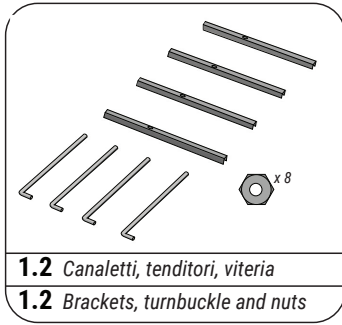

1.2 Canaletti, tenditori, viteria
1.2 Brackets, turnbuckle and nuts

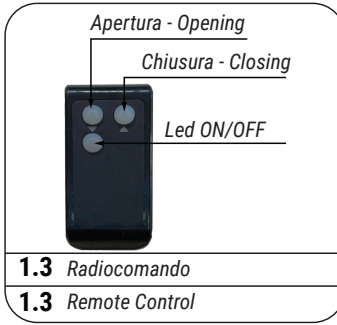

1.3 Radiocomando
1.3 Remote Control

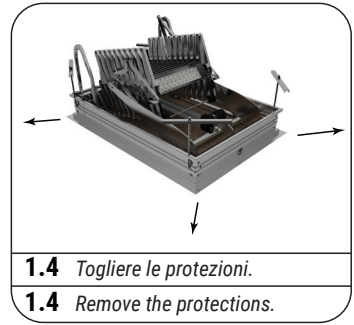

1.4 Togliere le protezioni.
1.4 Remove the protections.

② Installazione scala - Staircase installation

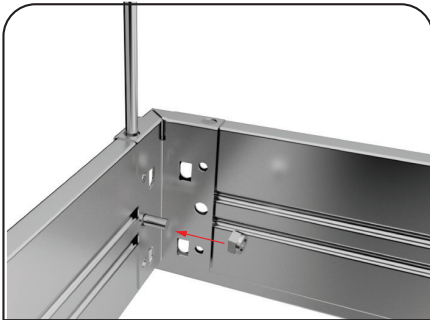

2.1 Avvitare i quattro tenditori di sostegno al nervo-telaio.

2.1 Screw the filetted bars to teh staircase frame.

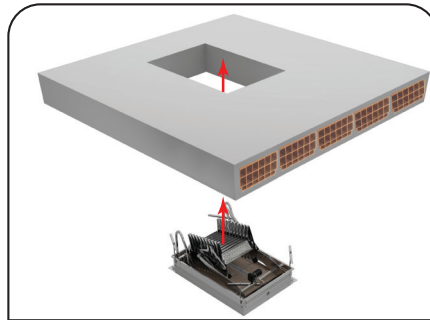

2.2 Inserire dal basso verso l'alto il pacco scala nel foro solaio.

2.2 From the bottom to the top, insert the staircase pack in the opening of the ceiling.

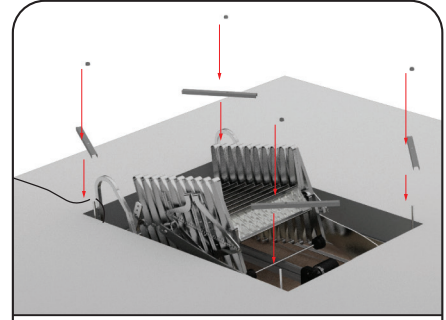

2.3 Bloccare la scala al telaio inserendo i quattro canaletti di sostegno nei tenditori e bloccarli con gli appositi dadi.

2.3 Block the staircase to the ceiling by inserting the four support brackets into the turnbuckles and block them with the appropriate nuts.

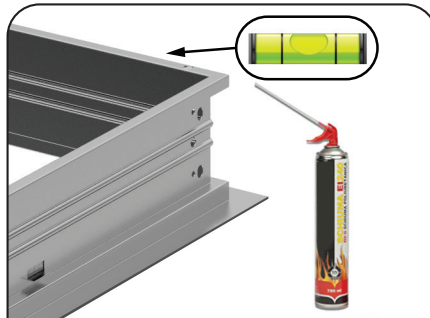

2.4 Assicurarsi che il nervo-telaio sia in bolla! Utilizzare schiuma poliuretana.

2.4 Make sure that the staircase frame is leveled! Use polyurethane foam.

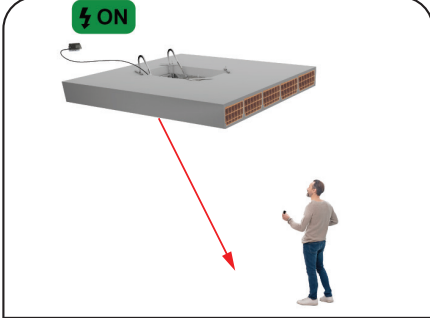

2.5 Premere il pulsante di apertura posto sul radiocomando per far aprire la scala.

2.5 Press the opening switch of the remote to open the ladder.

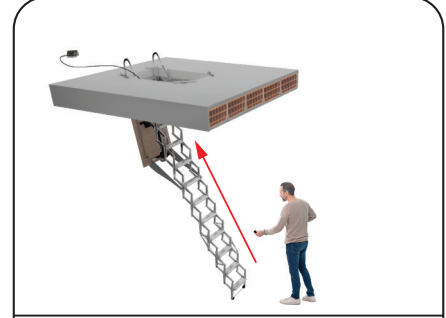

2.6 Premere il pulsante di chiusura posto sul radiocomando per far chiudere la scala.

2.6 Press the closing switch of the remote to close the ladder.



2.7 Si consiglia la lubrificazione con olio singer o similari ogni 12 mesi.

2.7 Lubrication with singer or similar oils is recommended every 12 months.

Grazie per aver scelto un prodotto ITALIANO!
Thank you for buying a product Made in ITALY!





Scala Retrattile Pantografo AutoAttic Vip® Thermo Soffitta Pantograph AutoAttic Vip® Thermo Ladder Loft

1 Contenuto del pacco - Packaging content

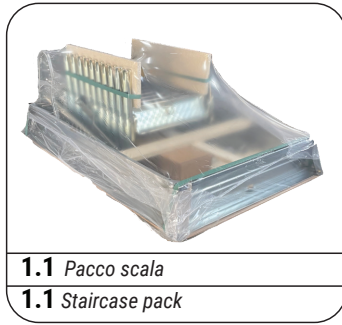

1.1 Pacco scala
1.1 Staircase pack

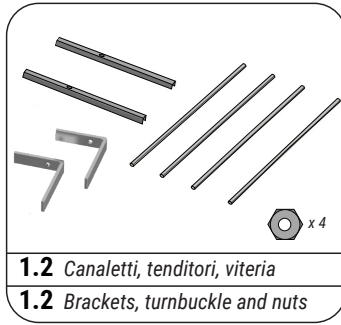

1.2 Canaletti, tenditori, viteria
1.2 Brackets, turnbuckle and nuts

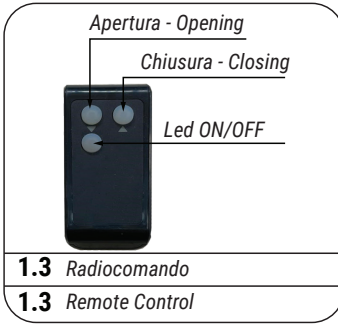

1.3 Radiocomando
1.3 Remote Control

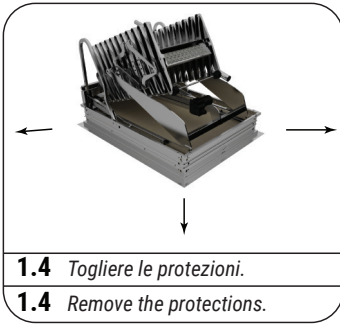

1.4 Togliere le protezioni.
1.4 Remove the protections.

2 Installazione scala - Staircase installation

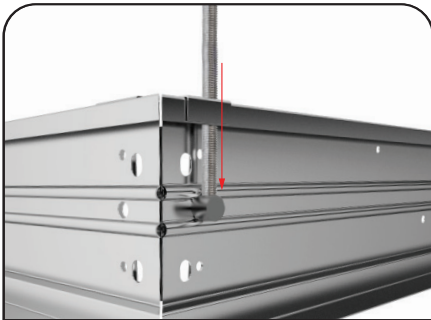

2.1 Avvitare i quattro tenditori di sostegno al nervo-telaio.

2.1 Screw the filetted bars to teh staircase frame.

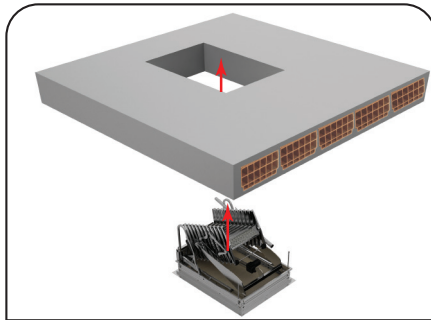

2.2 Inserire dal basso verso l'alto il pacco scala nel foro solaio.

2.2 From the bottom to the top, insert the staircase pack in the opening of the ceiling.

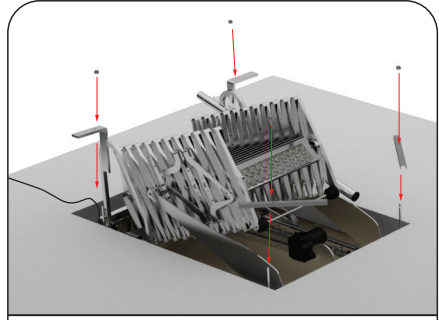

2.3 Bloccare la scala al telaio inserendo i quattro canaletti di sostegno nei tenditori e bloccarli con gli appositi dadi.

2.3 Block the staircase to the ceiling by inserting the four support brackets into the turnbuckles and block them with the appropriate nuts.



2.4 Assicurarsi che il nervo-telaio sia in bolla! Utilizzare schiuma poliuretana.

2.4 Make sure that the staircase frame is leveled! Use polyurethane foam.

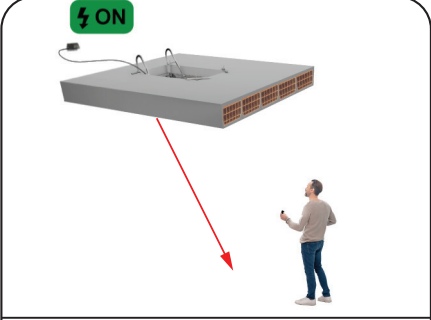

2.5 Premere il pulsante di apertura posto sul radiocomando per far aprire la scala.

2.5 Press the opening switch of the remote to open the ladder.

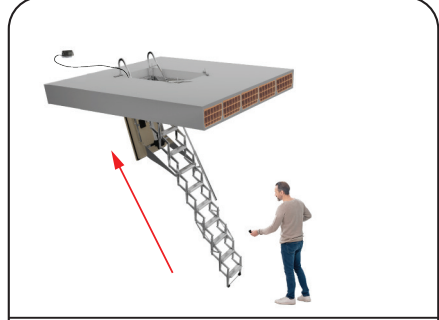

2.6 Premere il pulsante di chiusura posto sul radiocomando per far chiudere la scala.

2.6 Press the closing switch of the remote to close the ladder.



2.7 Si consiglia la lubrificazione con olio singer o similari ogni 12 mesi.

2.7 Lubrication with singer or similar oils is recommended every 12 months.

Grazie per aver scelto un prodotto ITALIANO!
Thank you for buying a product Made in ITALY!





Scala Retrattile Pantografo AutoAttic Vip® Terrazza Pantograph AutoAttic Vip® Terrace Ladder

1 Contenuto del pacco - Packaging content

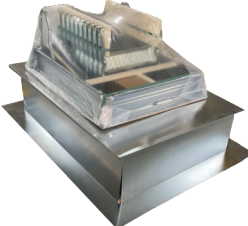

1.1 Pacco scala
1.1 Staircase pack



1.2 Tenditori, viteria
1.2 Turnbuckle and nuts

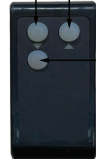

Apertura - Opening
Chiusura - Closing
Led ON/OFF

1.3 Radiocomando
1.3 Remote Control

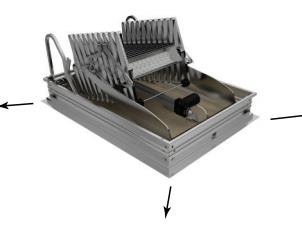

1.4 Togliere le protezioni.
1.4 Remove the protections.

2 Installazione scala - Staircase installation



2.1 Avvitare i quattro tenditori di sostegno al nervo-telaio.
2.1 Screw the filetted bars to teh staircase frame.

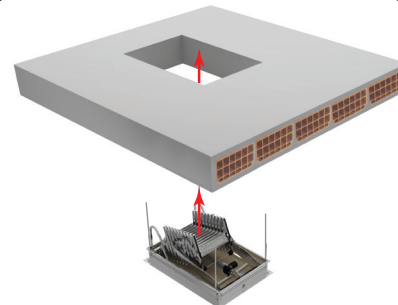

2.2 Inserire dal basso verso l'alto il pacco scala nel foro solaio.
2.2 From the bottom to the top, insert the staircase pack in the opening of the ceiling.

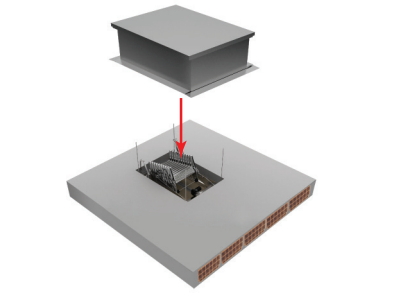

2.3 Salire sul tetto e posizionare il cappello terrazza sulle 4 barre filettate che fuoriescono dal solaio.
2.3 Go up to the roof and position the terrace hat on the filetted bars that come out of the ceeling.

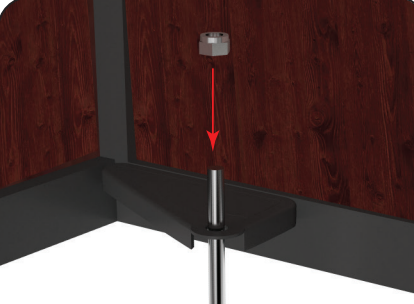

2.4 Bloccare la scala con i 4 dadi alla base del cappello terrazza.
2.4 Block the staircase with the 4 nuts to the base of the terrace.

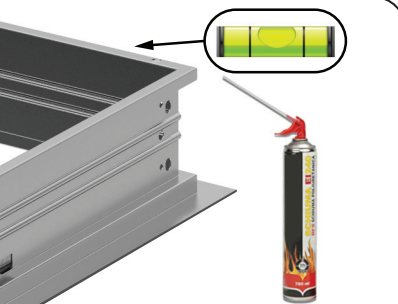

2.5 Assicurarsi che il nervo-telaio sia in bolla! Utilizzare schiuma poliuretanic.
2.5 Make sure that the staircase frame is leveled! Use polyurethane foam.

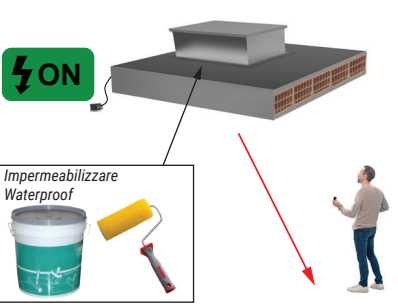

2.6 Premere il pulsante di apertura posto sul radiocomando per far aprire la scala.
2.6 Press the opening switch of the remote to open the ladder.

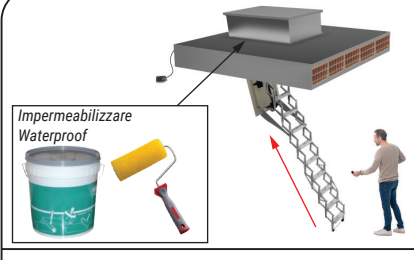

2.7 Premere il pulsante di chiusura posto sul radiocomando per far chiudere la scala.
2.7 Press the closing switch of the remote to close the ladder.



2.8 Si consiglia la lubrificazione con olio singer o similari ogni 12 mesi.
2.8 Lubrication with singer or similar oils is recommended every 12 months.

Grazie per aver scelto un prodotto ITALIANO!
Thank you for buying a product Made in ITALY!





Scala Retrattile Pantografo AutoAttic Vip® Thermo Terrazza Pantograph AutoAttic Vip® Thermo Terrace Ladder

1 Contenuto del pacco - Packaging content

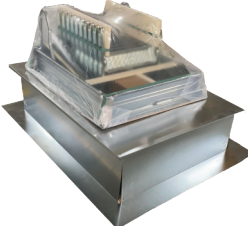

1.1 Pacco scala
1.1 Staircase pack



1.2 Tenditori, viteria
1.2 Turnbuckle and nuts

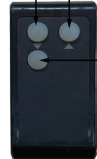

Apertura - Opening
Chiusura - Closing
Led ON/OFF

1.3 Radiocomando
1.3 Remote Control

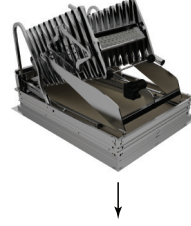

1.4 Togliere le protezioni.
1.4 Remove the protections.

2 Installazione scala - Staircase installation



2.1 Avvitare i quattro tenditori di sostegno al nervo-telaio.
2.1 Screw the filetted bars to teh staircase frame.

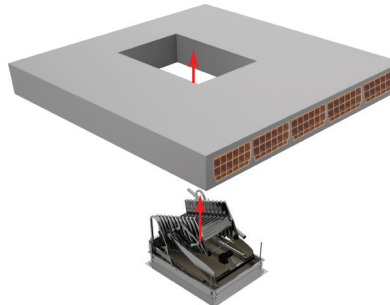

2.2 Inserire dal basso verso l'alto il pacco scala nel foro solaio.
2.2 From the bottom to the top, insert the staircase pack in the opening of the ceiling.

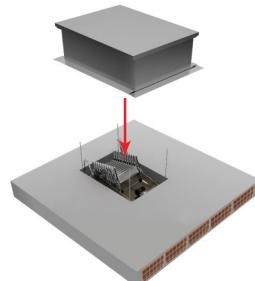

2.3 Salire sul tetto e posizionare il cappello terrazza sulle 4 barre filettate che fuoriescono dal solaio.
2.3 Go up to the roof and position the terrace hat on the filetted bars that come out of the ceeling.

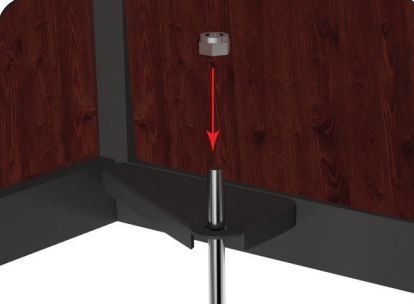

2.4 Bloccare la scala con i 4 dadi alla base del cappello terrazza.
2.4 Block the staircase with the 4 nuts to the base of the terrace.



2.5 Assicurarsi che il nervo-telaio sia in bolla! Utilizzare schiuma poliuretanic.
2.5 Make sure that the staircase frame is leveled! Use polyurethane foam.

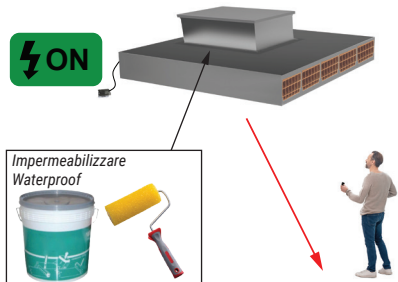

2.6 Premere il pulsante di apertura posto sul radiocomando per far aprire la scala.
2.6 Press the opening switch of the remote to open the ladder.

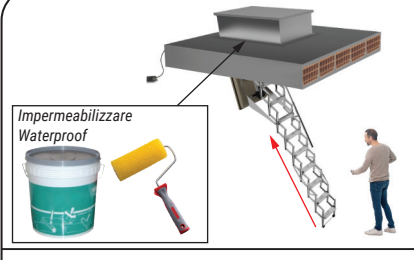

2.7 Premere il pulsante di chiusura posto sul radiocomando per far chiudere la scala.
2.7 Press the closing switch of the remote to close the ladder.



2.8 Si consiglia la lubrificazione con olio singer o similari ogni 12 mesi.
2.8 Lubrication with singer or similar oils is recommended every 12 months.

Grazie per aver scelto un prodotto ITALIANO!
Thank you for buying a product Made in ITALY!





Scala Retrattile Pantografo AutoAttic Vip® Parete Pantograph AutoAttic Vip® Wall Ladder

① Contenuto del pacco - Packaging content

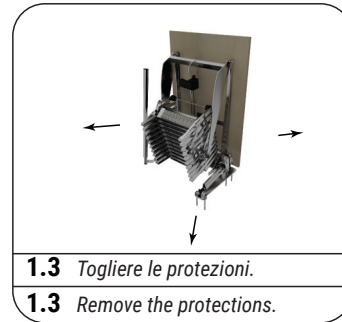
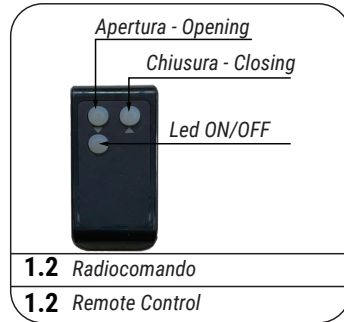

② Installazione scala - Staircase installation

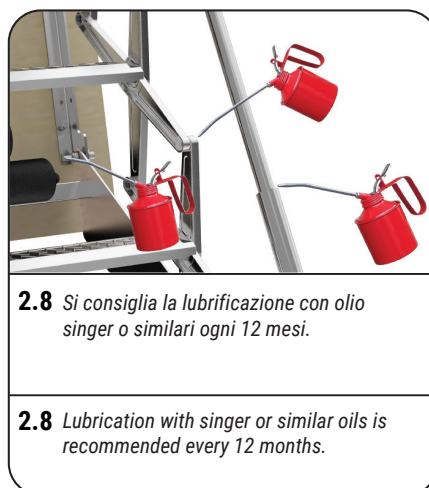
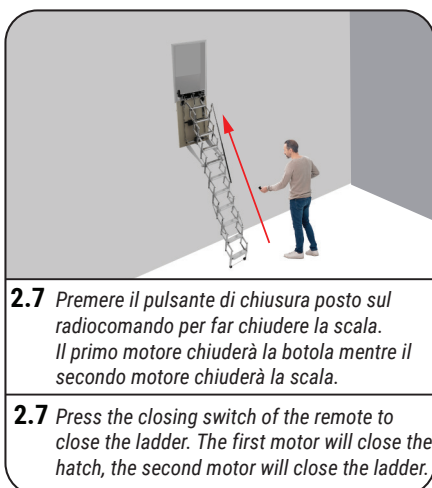
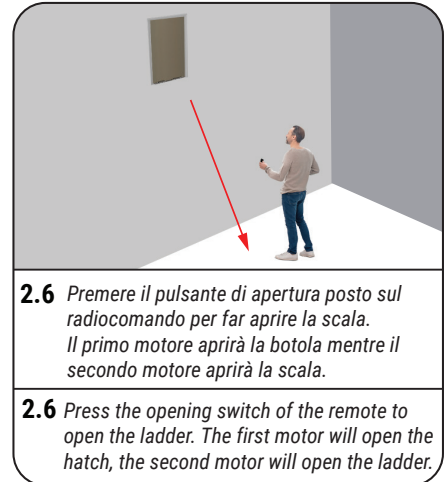
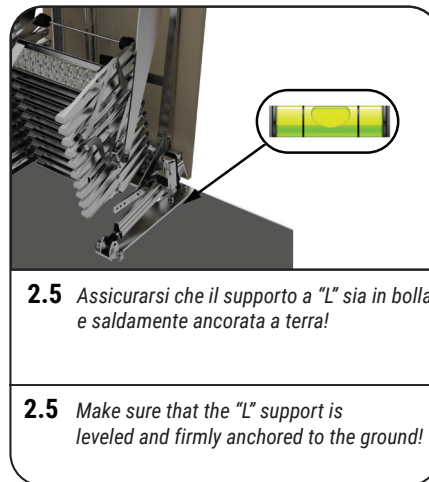
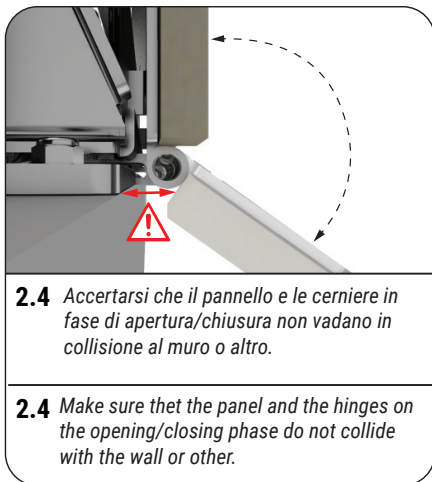
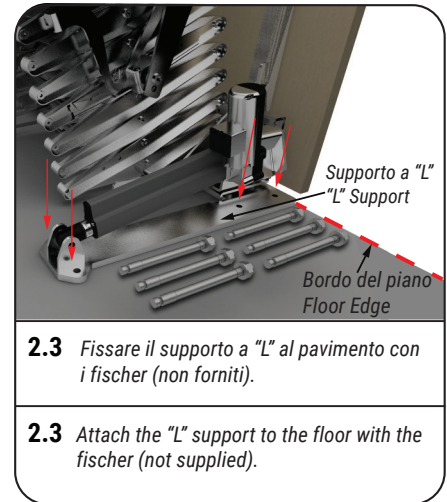
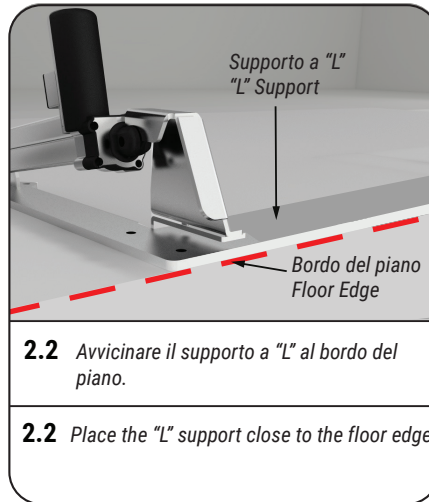
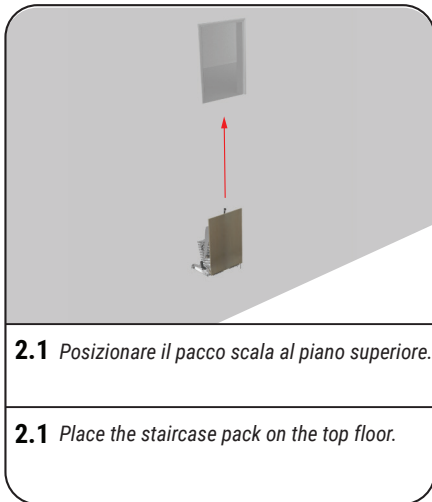

Grazie per aver scelto un prodotto ITALIANO!
Thank you for buying a product Made in ITALY!





Scala Retrattile Pantografo AutoAttic Vip® Ghost Pantograph AutoAttic Vip® Ghost Ladder

① Contenuto del pacco - Packaging content

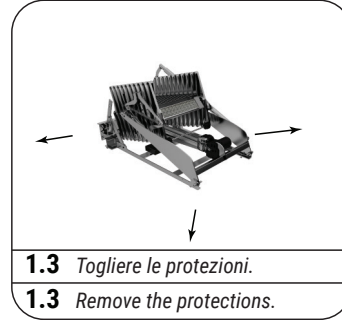
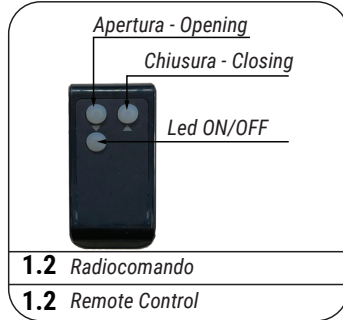

② Installazione scala - Staircase installation

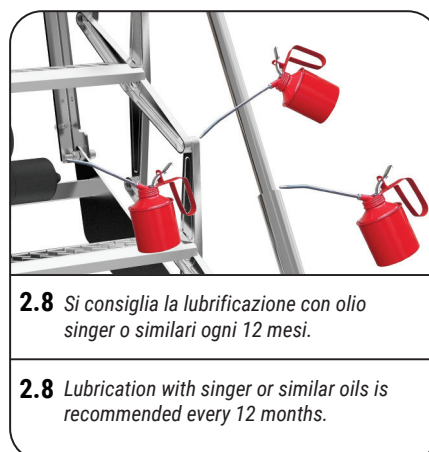
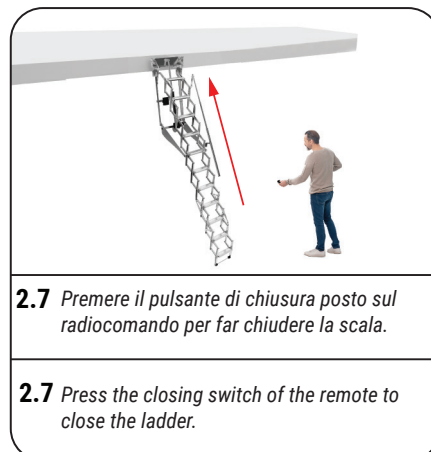
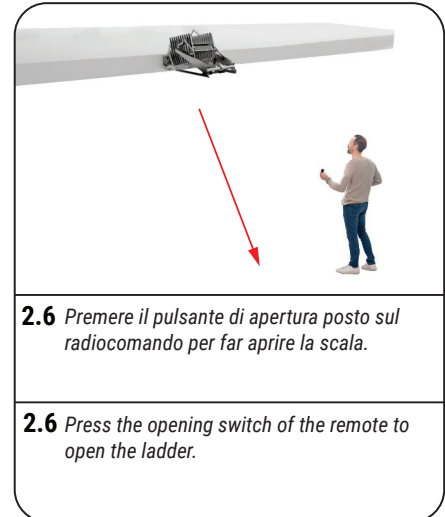
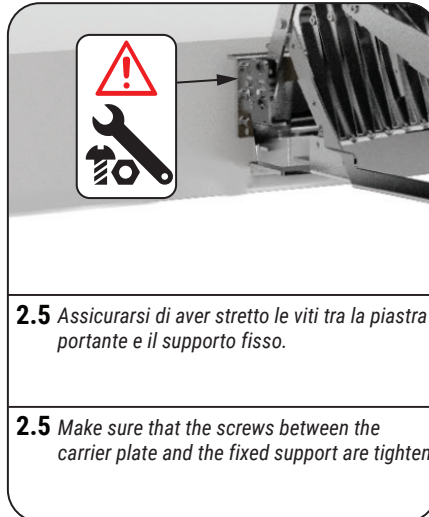
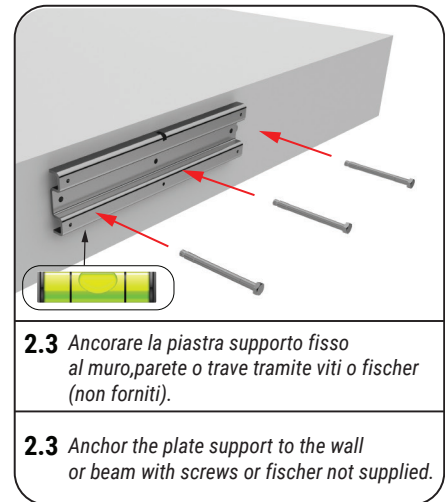
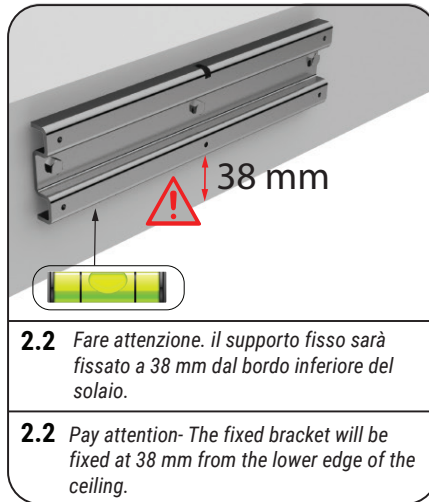
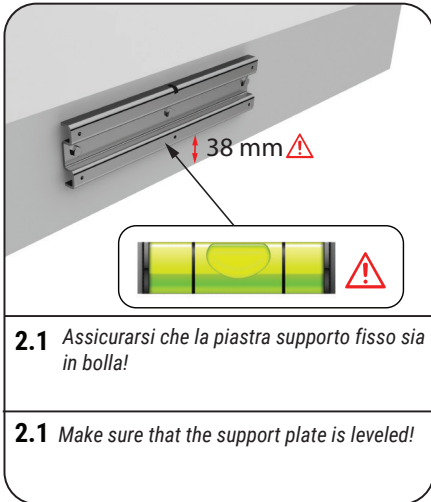

Grazie per aver scelto un prodotto ITALIANO!
Thank you for buying a product Made in ITALY!



Scala Retrattile Pantografo AutoAttic® Ghost Pantograph AutoAttic® Ghost Ladder

① Contenuto del pacco - Packaging content

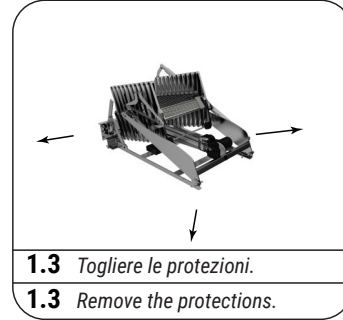
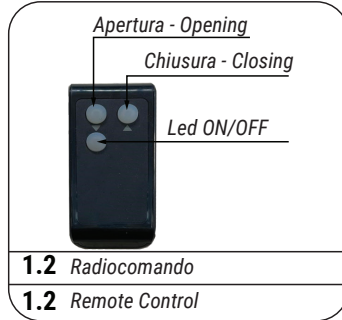

② Installazione scala - Staircase installation

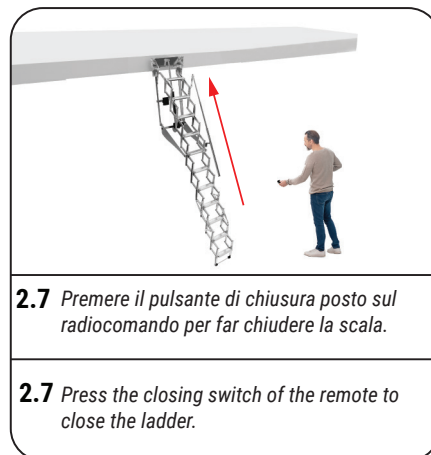
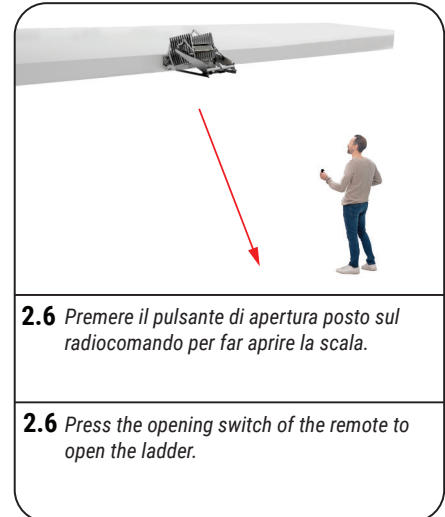
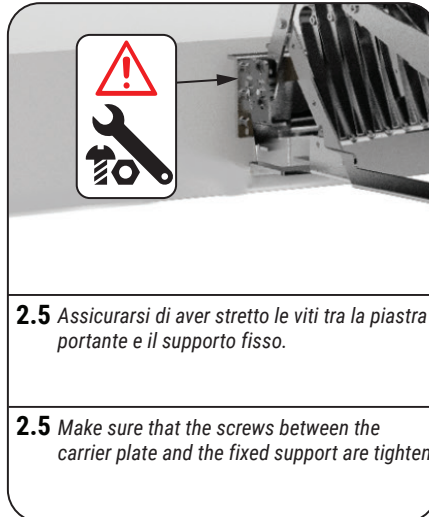
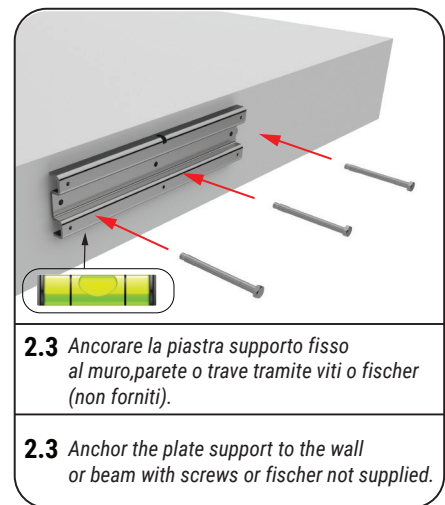
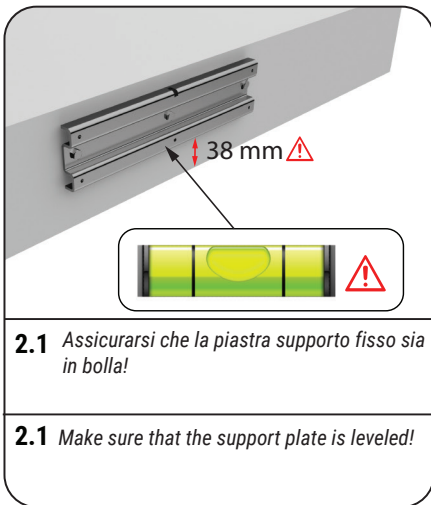

Grazie per aver scelto un prodotto ITALIANO!
Thank you for buying a product Made in ITALY!





Cavo Arancione - Orange Cable (GND)

Cavo Marrone - Brown Cable (GND)

Chiusura Scala
Closing Ladder



A - Ricevente WI FI
A - WI FI Receiver

A



Apertura Scala
Opening Ladder

Cavo Rosso - Red Cable (GND)

Cavo Marrone - Brown Cable (GND)



