









ERGO CUT A 101

CE EN60974-7

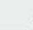

CODE	↔		🔌
PAA206M-000-BA3	6 m	19.7'	 1/4 GAS
PAA206M-082-BA3	6 m	19.7'	 M14x1
PAA206M-004-BA3	6 m	19.7'	 CENTRAL 004
PAA206M-304-BA3	6 m	19.7'	 TRAFIMECTOR® 304

TECHNICAL DATA		
 HF	ERGO CUT A 101	
 1m	0,8 kg	1.76 lb
 PEAK	500	
	5 bar	
	180 l/min	
 60%	100A	
 100%	75A	
	25-30 mm	1"-1"3/16

For Central 004 and Trafimector 304 pin connection scheme see page 114

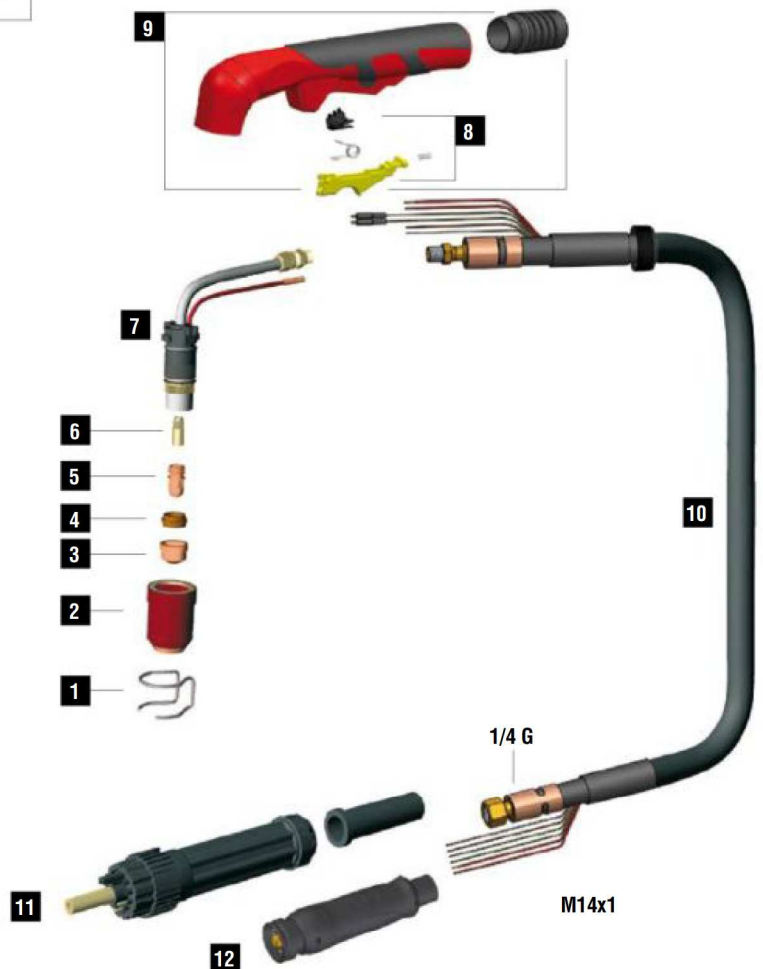
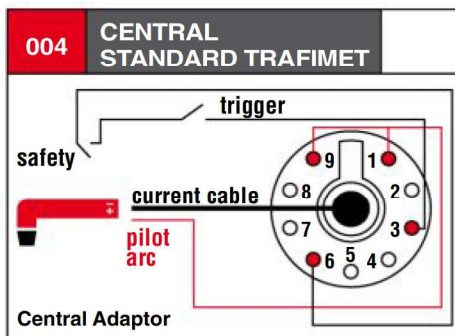

	CODE		Description	Ø	↔	CONTACT		DRAG		GOUGING	REF			
1	CV0008		stand off guide		32,5 mm						51957	10		
1	CV0009		stand off guide		38,6 mm							10		
1	CV0011		stand off guide		23 mm						1386	10		
1	CV0012		stand off guide		30 mm						1408	2		
1	CV0014		stand off guide		30 mm							2		
1	CV0021		stand off guide	32,8 mm	40,6 mm							1		
1	CV0023		stand off guide		17,6 mm							10		
1	CV0039		stand off guide		18,5 mm							2		
2	FH0297		insulator for CV0039/ CV0023									10		
2	PC0109		nozzle		44,1 mm							2		
2	PC0111		long life nozzle		44,1 mm							2		
2	PC0113		nozzle		42,3 mm							2		
2	PC0130		long life		42,9 mm							2		
3	PD0101-08		30 A	0,8 mm	.030"	13,7 mm						-	10	
3	PD0101-11		60 A	1,1 mm	.043"	13,7 mm							-	10
3	PD0101-14		100 A	1,4 mm	.055"	13,7 mm							-	10
3	PD0101-17		130 A	1,7 mm	.066"	13,7 mm							-	10
3	PD0101-19		140 A	1,9 mm	.075"	13,7 mm							-	10
3	PD0101-30		gouging tip	3,0 mm	1/8"	13,7 mm							-	10
3	PD0111-12		80 A	1,2 mm	.047"	35,8 mm						-	10	
3	PD0117-14		100 A	1,4 mm	.055"	34,8 mm						-	10	
3	PD0117-17		130 A	1,7 mm	.066"	34,8 mm						-	10	
3	PD0117-19		140 A	1,9 mm	.075"	34,8 mm						-	10	
4	PE0101		diffuser		7,8 mm							-	2	
4	PE0103		diffuser		7,8 mm							-	2	
5	PR0101		electrode		22 mm	7/8"						10		
5	PR0116		electrode		43,1 mm							10		
6	FH0562		air tube		21 mm							1		

	CODE		Description	
7	EA0131		O-ring Ø 19x2 mm	10
7	PF0145		Ergocut A 101 torch head	1
8	TP0400		trigger kit	1
9	TP0402		handle kit	1
10	PH4008		coaxial cable - 6 m / 19.7' - 1/4 G (no pin)	1
10	PH4063		coaxial cable - 6 m / 19.7' - M14X1	1

	CODE		Description	
11	BW0147		cable support	10
11	FY0023		plasma central adaptor - 5 pins	1
12	FY0090		TRAFIMECTOR® central adaptor - torch side	1
	EA0254		pin extractor for central adaptor	1
	PT0202		male spring pins kit (5 pcs)	1

STANDARD

CONTACT SHORT CONTACT LONG DRAG SHORT DRAG LONG GOUGING