

---

EN



---

Vitrum Satellite Wireless

---

**INSTALLATION AND OPERATION**

DESIGNED AND PRODUCED  
ENTIRELY IN ITALY

The Italian flag is represented by three vertical rectangles of equal height and width, colored green, white, and red from left to right.

## DEFINITION

A **Vitrum Satellite** differs from Dimmer and On-Off devices for this reason: there is **no exit** used for directly control a load. It's used in all the situations in which you need to control a load that is connected to another Vitrum from a different position. Being without dimmer or relè onboard, it costs less than Vitrum Dimmer Wireless or Vitrum On-Off Wireless.

## INDEX

0. Before starting . . . . .	3
1. Electrical connections . . . . .	4
2. Positioning the glass decor panel . . . . .	6
3. Vitrum is intelligent . . . . .	8
4. Advanced functions . . . . .	11
5. Setting functions . . . . .	16
6. Disabling Eco Mode . . . . .	19
7. Factory Reset . . . . .	22
8. Supervision . . . . .	24
9. Compatibility . . . . .	25
10. Compliance with ec directives . . . . .	25
MAIN TECHNICAL SPECIFICATIONS . . . . .	26

---

## 0. BEFORE STARTING

The Vitrum system that you have purchased is designed for connection to your existing 240V power supply circuit. Before commencing installation, ensure that the mains power supply had been disconnected by setting the main switch on your electricity meter to **OFF**. Do not re-connect the power supply and start using Vitrum until all connections have been correctly completed and the Vitrum unit has been inserted into the wall-mounting box.

**Vitrum must be installed by a professional electrician who is qualified to operate on electrical power circuits in full compliance with all current safety legislation.**

For each device, connect the power supply and the return wire from the actuators as shown in the circuit diagrams printed on the rear of the boxes in the vicinity of the terminal block. Refer exclusively to the circuit diagrams contained in this manual, especially if connecting the system without an earth wire.

**Carefully check that the wires and connectors are securely fastened. After securing the unit to the wall-mounting box, temporarily use the plastic cover for protection until the glass décor plate is fitted.** Do not install Vitrum in the vicinity of sources of heat or in conditions of high humidity.

---

## 1. ELECTRICAL CONNECTIONS

Electrical connections with neutral wire: connect the Live wire to the terminal marked "L", the Neutral wire to the terminal marked "N".

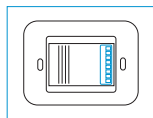
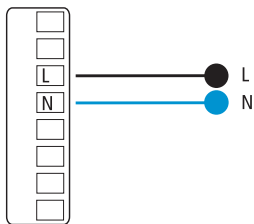

---

## IMPORTANT

**After connecting, check that the wires are correctly positioned inside the wall-mounting box.**

When securing Vitrum to the wall-mounting box, use the screws supplied and note that the **maximum torque** to be used when tightening the screws in the embedding box is 0.8 Nm. In addition, the surface of the wall for at least 2 cm surrounding the embedding box **must be** as flat and smooth as possible, and must not have any rough patches and/or bumps that protrude more than 1 mm.

**If the screws are not tightened with the torque specified, or if the embedding box is installed on unsuitable surfaces, the correct operation of the device cannot be guaranteed.**

Think Simple Spa accepts no liability if the device is not correctly installed as described above.

---

## 2. POSITIONING THE GLASS DECOR PANEL

In order to refit the glass panel correctly, ensure that the four plastic tabs on the panel are in perfect alignment with the anchor holes. When the glass panel tabs are aligned with the holes, press the four corners of the glass panel evenly until it is fully inserted into the wall-mounting box.

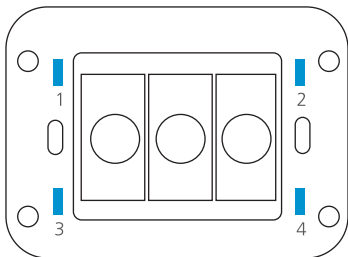

Anchor holes on electronic section

---

After fitting the glass panel, the buttons remain inoperative for about 10 seconds. An acoustic signal sounds three times to indicate that the sensors have been recalibrated, after which they resume normal operation. To remove the glass panel from the wall-mounting box, gently lever the upper or lower edge away.

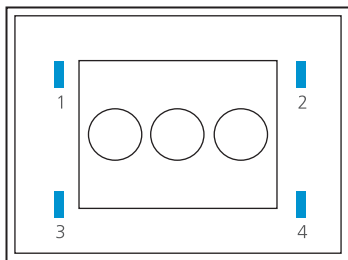

Anchor tabs on décor panel

---

### 3. VITRUM IS INTELLIGENT

The product that you have purchased functions when included in a **Z-Wave** wireless net. Thanks to “Z-Wave” Wireless technology, each Vitrum Wireless unit offers numerous advantages if connected as part of a network: it is possible to associate multiple Vitrum units, to construct scenarios, and to control lights using a remote control unit. If you connect Vitrum into a pre-existing z-wave net working with third parts devices, please refer to instruction and procedure of your remote control. Otherwise proceed as follows **to include** Vitrum to your Home Wireless Network:

- Open the rear panel of the **HOME MASTER** remote handset.

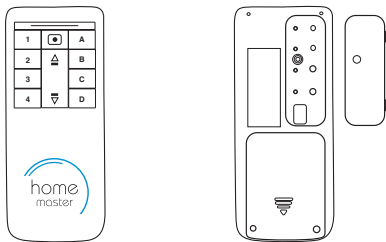



- 
- Press and hold down **"INC"** until the corresponding LED turns yellow, then release the button.

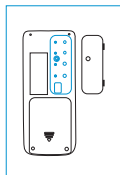
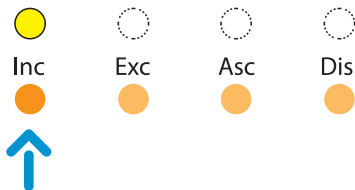

- Place the HOME MASTER remote handset near the Vitrum unit to be included in the network. Touch any of the keys on Vitrum to include the unit in the home wireless network.

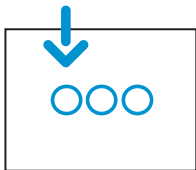

**Vitrum indicates that it has been connected** to the network by flashing the yellow LEDs three times and switching on all the lights connected to the unit.

- 
- When all the Vitrum units have been added to the network, press the **“INC”** key again until the LED switches off. Now you will see that the illuminated rings around the Vitrum touch keys no longer light red when changing from one status to the next.

#### **NOTE**

A Vitrum unit cannot be added to the network if it has already been included in a different network. In this case, it is necessary to perform the factory reset procedure (see Paragraph 7)..

---

## 4. ADVANCED FUNCTIONS: CREATION OF CONTROL LOGIC

On all Vitrum Wireless units, it is possible to create control logic processes that associate the button on one Vitrum module to other buttons on **OTHER** Vitrum modules (up to a maximum of five). Every Vitrum Wireless Satellite supports a number of groups equal to the number of the device's channels (=device's buttons); every single button/channel of a Vitrum has its own association group.

For creating a control logic, the modules must first be included in the home wireless network (see paragraph 3). Then proceed as follows:

- Set the HOME MASTER remote handset to **association mode** by pressing and holding down the **"ASC"** button until the **YELLOW** LED lights. Then release the "ASC" button.

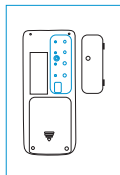
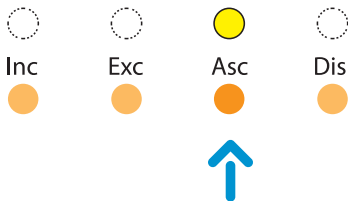

- 
- Press the button corresponding to the button/channel of the Vitrum unit to which the lights to be controlled are physically connected. The LED corresponding to the selected button/channel will flash magenta until the 'association' process has been completed.

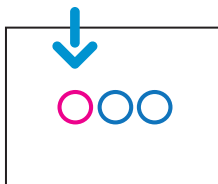

- On the HOME MASTER remote handset, press the 'association' touch key briefly. The LED will light red.

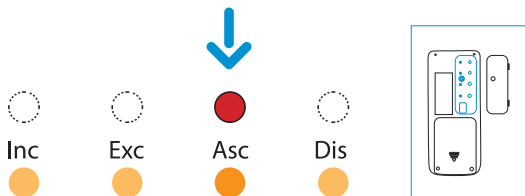

- Press the touch key on the Vitrum unit from which to control the lights connected to the buttons/channels of the Vitrum device(s) that have been selected previously. In this case, too, the corresponding LED will light magenta.

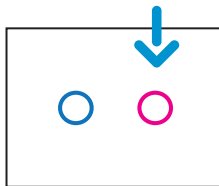

When carrying out these operations, it is necessary to position the remote handset in the vicinity of the wall units.

---

## IMPORTANT

Associations are possible only between separate Vitrum modules. It is not possible to control more than one channel of a Vitrum device using a single touch key on the same Vitrum unit. A touch key on a Vitrum device can be associated with a maximum of other devices as below indicated. So the total number of touch keys that you can control is variable and depend on kind of association you make. For example: associating a touch key to 10 Vitrum I means that you can control up to 10 other touch keys; but associating a touch key to 10 Vitrum IV means that you will be able to control up to 40 other touch keys. Vitrum touch key will lamp with red color if limit is exceeded.

In order to cancel associations that have been entered, simply perform the same procedure, though pressing the **"DIS"** key on the HOME MASTER remote handset instead of **"ASC"**.

Model	EU 1	EU 2	EU 3	EU 4	BS 1	BS 2	BS 4
Max. nr of Associations*	10	7	8	7	10	10	7

\* If you are using a Router Home master, you have to decrease numbers of one unit.

---

**NOTE:** Vitrum Satellite must have the same configuration of the channel to which is associated. Factory setting is for association with Vitrum Dimmer Wireless. To change this setting read next chapter.

---

## 5. SETTING FUNCTIONS

Each channel of Vitrum Satellite has to be configured with the same characteristic of the channel to which is associated. Possible situation are as below:

- Association with a channel of a Vitrum Dimmer Wireless.
- Association with a channel of a Vitrum On-Off Wireless in switch mode.
- Association with a channel of a Vitrum On-Off Wireless in push button mode.

To change configuration act as follow:

- Remove the glass décor panel.
- Press and hold down the two service touch keys for at least 8 seconds and wait until the BEEP sounds twice to indicate that the system has entered the configuration **MENU**. The LEDs in the touch keys will begin to flash either green, blue or red, depending on the setting entered. The default setting for the flashing light is green since the factory setting is for association with dimmer.



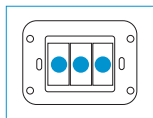
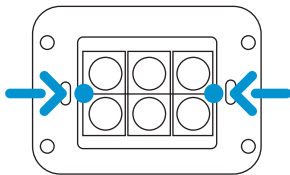
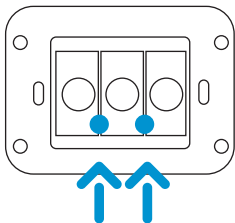

- Briefly press each of the buttons on the Vitrum unit to select the correct operating mode for the type of lamp connected.

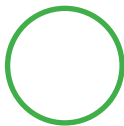

**FLASHING GREEN**

dimmer association

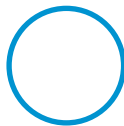

**FLASHING BLUE**

on-off switch association

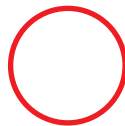

**FLASHING RED**

on-off push button association

Each time the touch key is pressed, the cyclic status is "toggled":

**Dimmer -> Switch -> Push Button ...**

---

Vitrum returns to normal operation after 12 seconds of inactivity or if the two service touch keys indicated by the yellow arrows in the figure below are pressed briefly (0.5 seconds).

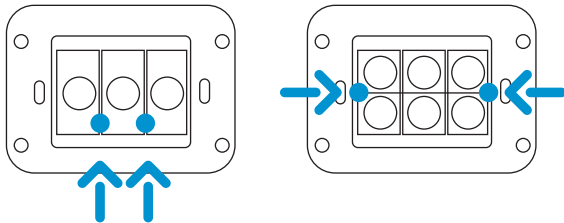

**IMPORTANT**

The default factory setting is for association with Dimmer.

---

## 6. DISABLING “ECO” MODE

All Vitrum Wireless Satellite units are supplied with the ECO function activated. If preferred, for Vitrum with 1 and 2 channel, proceed as follows to disable this function:

- Remove the glass décor panel.
- Press and hold down the **one of the two** service touch keys for at least 8 seconds and wait until the BEEP sounds twice to indicate that the system has entered the configuration MENU. The LEDs in the touch keys will begin to flash either green or blue, depending on the setting entered. The default setting for the flashing light is green since the factory setting is **Eco-Mode**.

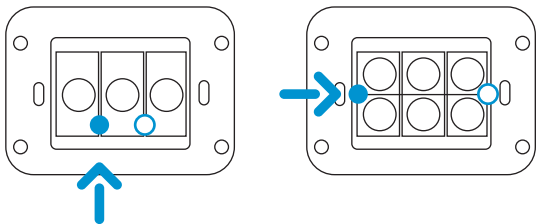

- 
- Briefly press the touch key corresponding to the channels/ outputs on which to disable the ECO function.

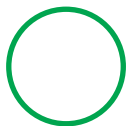
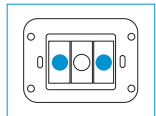

**FLASHING GREEN**

Eco Mode enabled

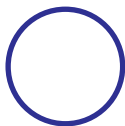

**FLASHING BLUE**

Eco Mode disabled

Each time the touch key is pressed, the cyclic status is 'toggled':

**Enabled** -> **Disabled** -> **Enabled**...

---

Vitrum returns to normal operation after 12 seconds of inactivity or if one of the two service touch keys indicated by the yellow arrows in the figure below is pressed briefly (0.5 seconds).

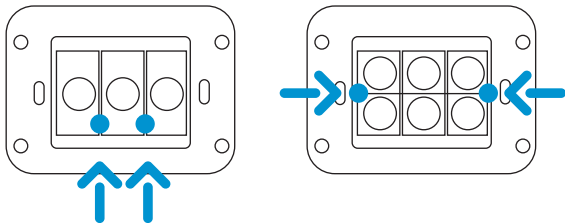

#### NOTE

When **"Eco-Mode" is disabled**, the last light level to which the light was set before being switched off is stored in memory. When the light is switched on again, it will be set to the last level of brightness.

---

## 7. FACTORY RESET

Proceed as follows to reset the Vitrum unit to the original factory settings:

A. **EXCLUSION** from the home network using the HOME MASTER remote handset:

- Press **"EXC"** on the HOME MASTER remote handset and wait until the yellow LED lights.
- Press and hold down the leftmost touch key on the multi-channel Vitrum unit (**EU Standard**), or the topmost key (**BS Standard**), or the central key on single-channel units, for at least 8 seconds.

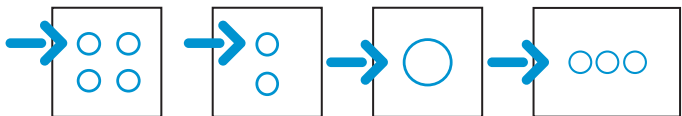

- 
- Vitrum will flash red three times and sound an acoustic signal to indicate that the original factory setting has been restored.

**B. FACTORY RESET** a.using the hidden button

- Remove the Vitrum unit from the wall-mounting box.
- Press the hidden Factory Reset button and hold down for at least 3 seconds. Vitrum will flash red three times and sound an acoustic signal to indicate that the original factory setting has been restored.

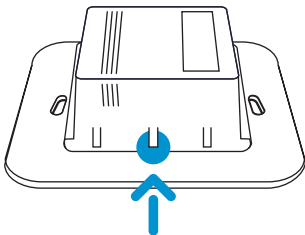

---

## 8. SUPERVISION



If you have decided to activate the **HOME MASTER** supervision apps for iPhone® or iPad®, you will find that the **“identification”** function featured by every Vitrum unit is extremely useful. **“Identification”** status is indicated when all the illuminated rings light Magenta and begin to flash. This functional status is created directly by the supervision app as soon as the corresponding command is entered.

Download free **Home Master App** for your iPad® from the **Apple Store**.





---

## 9. COMPATIBILITY



All Vitrum Wireless devices are tested and certified to **Z-Wave** specifications and are designed to interact with certified Z-Wave products marketed by other manufacturers. Certified Z-Wave devices of different types or designed for other applications may be added to your home network; if these support the functions, they can also be used as repeaters to communicate with your Vitrum wireless units. In this way, your system can easily be extended to operate with different applications and thus to adapt to your specific needs.

---

## 10. COMPLIANCE WITH EC DIRECTIVES

All Vitrum Wireless units are built in compliance with the following European directives: E.M.C.:2004/108/CE, R&TTE:1999/5/CE

The manufacturer assumes no responsibility for any use not indicated in this manual. Think Simple reserves the right to modify its products at any time and without notice in order to better their quality and functionality.

Therefore, all the information given in this datasheet is to be considered subject to possible modifications. For this reason we invite you to check for update of Vitrum users guide at [www.vitrum.com/eng/content/download](http://www.vitrum.com/eng/content/download)

---

## MAIN TECHNICAL SPECIFICATIONS

### Vitrum Satellite Wireless

	Vitrum 1 channel	Vitrum 2 channels	Vitrum 3 channels	Vitrum 4 channels
Power supply	240V/50hz	240V/50hz	240V/50hz	240V/50hz
Energy consumption	<1 w	<1 w	<1 w	<1 w
Operating temperature	0-40° C	0-40° C	0-40° C	0-40° C
Wireless Z-wave modem frequency	868,4 MHz	868,4 MHz	868,4 MHz	868,4 MHz
Z-Wave modem open air range of communication	20 mt	20 mt	20 mt	20 mt
Protection Rating	IP 40	IP 40	IP 40	IP 40

---

To discover further functions and products by  
VITRUM please visit our site:  
**[www.vitrum.com](http://www.vitrum.com)**



by  
T H I N K  S I M P L E <sup>TM</sup>

---

**Think Simple SpA**  
**Head Office**

viale Lino Zanussi, 3  
33170 Pordenone

Tel +39 0434 516 216  
Fax +39 0434 516 230

**Sales Office**

corso Garibaldi, 86  
20121 Milano

Tel +39 02 655 600 29  
Fax +39 02 454 982 95

**[www.thinksimple.it](http://www.thinksimple.it)**

[info@thinksimple.it](mailto:info@thinksimple.it)