

# SHS-P910

## Instruction Manual

### Samsung SMART Doorlock

#### Convenient Opening of the Door

Simple PUSH PULL motion

#### Welcome Feature

When user approaches to the doorlock, its status is automatically changed to standby for recognition

#### Manner Feature

Temporarily blocking the sound of pressing key buttons and opening door when going in and out

#### Automatic Card Recognition Feature

Easily open the door by card key

#### Dual-Authentication Feature

Dual-Authentication Feature with fingerprints and passcode

#### Dual lock Feature

Automatically blocking every recognition attempt when the owner is at home.

#### Fire Detection Feature

Built-in fire detection sensor

#### Crime Prevention Feature

When going out and at the attempt of criming, prevention alarm will be on.

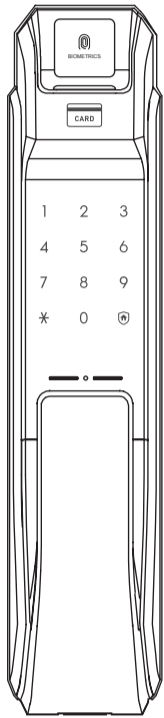

GC68-02024A ED:01

### Precautions for Safety



Precautions for safety protect the user's safety and prevent damages and inconvenience due to accidents. Please read this and use the product properly.

- Do not install or repair the product randomly as you want.
- Do not install the product in a location where the gap between the door and doorframe is more than 5mm.
- Cautiously manage the passcode so that other people cannot know it, and regularly change the number.
- Do not operate the product when your hand is wet, and be careful to not let water, beverages, and other liquid to get inside the product.
- Do not forcibly press or use a sharp tool to hit the button.
- When you are going out, always check the ensure that the door was fully locked.
- Properly fit the battery into the product onto its accurate (+/-) terminals. When the battery is incorrectly placed in its direction or charge as displayed into the battery room, leakage and breakage may occur, so please be careful.
- When the battery life is ended, replace all the batteries at once, and avoid using new and used batteries at the same time.
- When cleaning the product, do not wipe it with water, benzene, or alcohol, and instead, use a dry cloth.
- Replace the batteries to new ones within one week of first hearing the battery replacement notification alarm.

### Product Components

Product components may be changed depending on the installation environment.

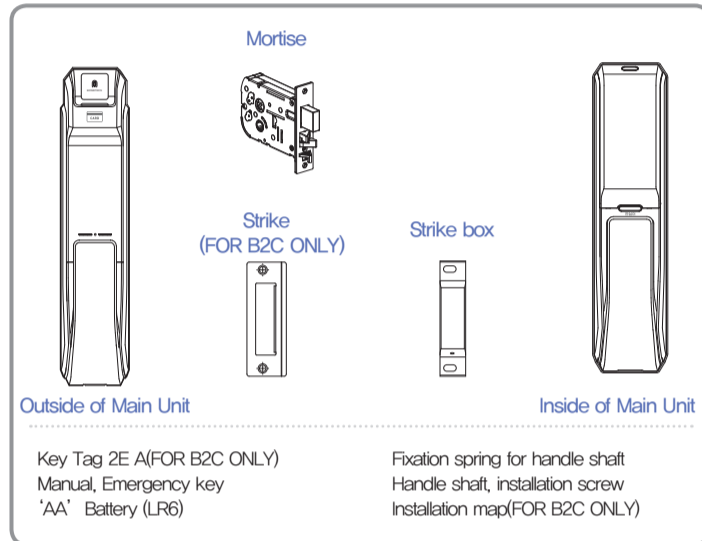

**Warning**  
You must carry or keep at least one emergency key outside.

### Names and Features (Outside)

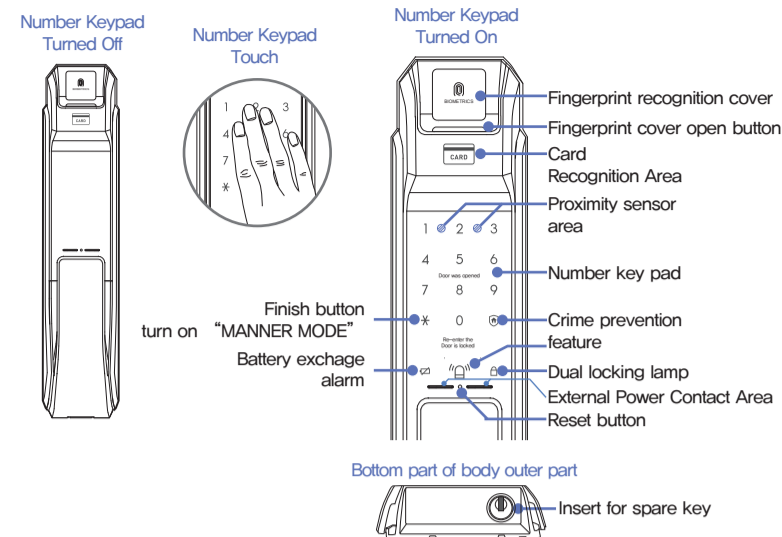

### Names and Features (Inside)

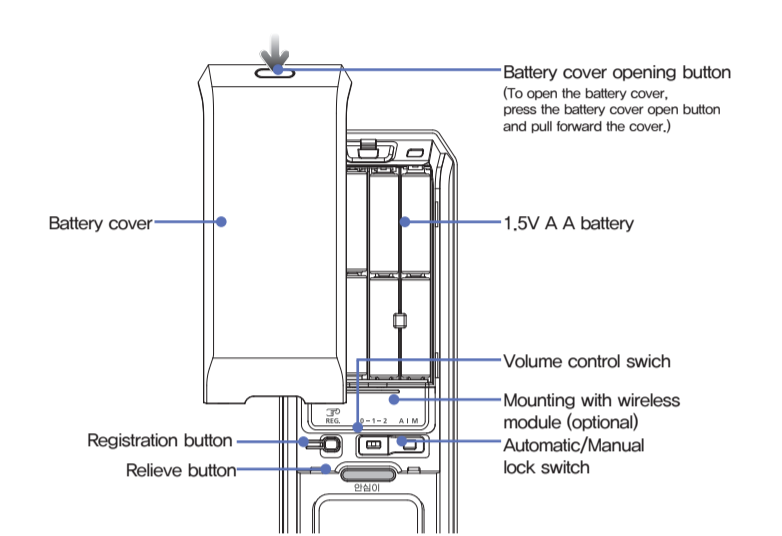

### Names and Features (Mortise)

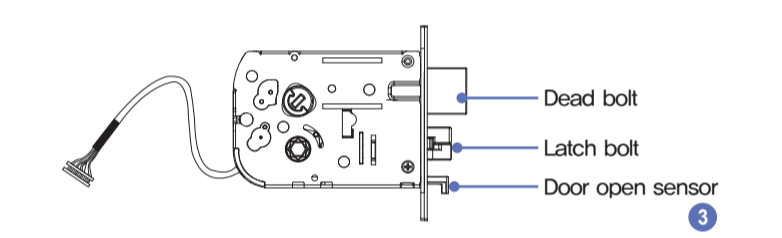

### Opening the door from the outside (passcode)

When the product is purchased, it is set up as the dual security mode. If you want to change to the normal mode, refer to 'Dual security mode setting'.

#### ※ Manner Mode

The sound of pressing key button or door opening does not come out if you press [\*] button first before entering passcode. This function is useful when you enter home silently at night.

#### 1. Dual-security mode

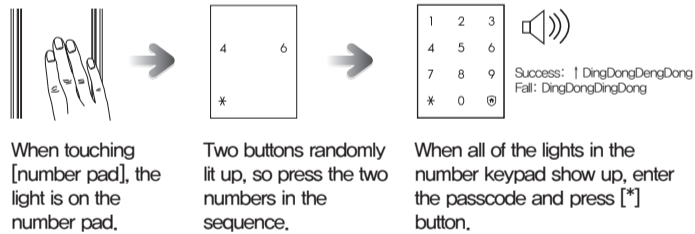

#### 2. Normal Mode

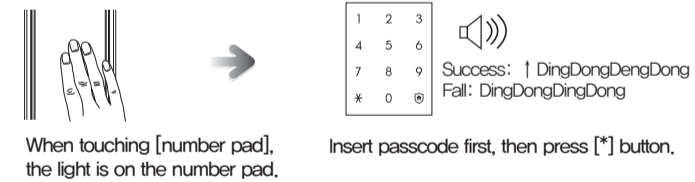

**Reference**

- Passcode must be entered when the number keypad is lit up, so if the lights are not on, then touch the [number keypad] and then re-enter the passcode.
- When the passcode is incorrectly entered to cancel the input, press the [0] button and start from the beginning.
- If the passcode is incorrectly entered for five times in a row, alarm sound is played 20 times and the operation of doorlock is paused for 3 minutes. During the operation pause status, "ding" sound is played every 10 seconds and after 3 minutes a long "ding" sound is played. And then the pause status is automatically disabled.

### Opening the door from the outside (Fingerprint)

Open the locked door from the outside with fingerprints. Please correctly contact the registered fingerprint to the fingerprint recognition area.

- Press [Fingerprint Cover Open] button.
- Fingerprint is recognized.

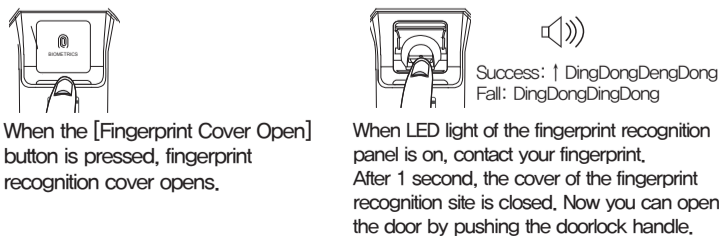

When the [Fingerprint Cover Open] button is pressed, fingerprint recognition cover opens. When LED light of the fingerprint recognition panel is on, contact your fingerprint. After 1 second, the cover of the fingerprint recognition site is closed. Now you can open the door by pushing the doorlock handle.

### Opening the door from the outside (card, key tag)

Open the door from outside by using a card and a key tag. Correctly place the card or the key tag that registered on the card recognition section.

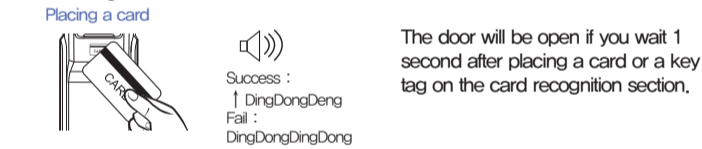

**Reference**

- If card key and key tag is not automatically recognized by doorlock, touch the key pad and try again. The door will open.

### Opening a door from inside

Opening a door by pushing the inner knob

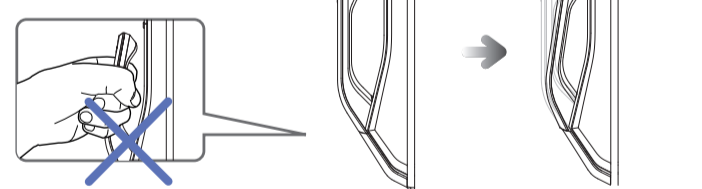

**Caution**

- Be careful of jamming your hand in use.

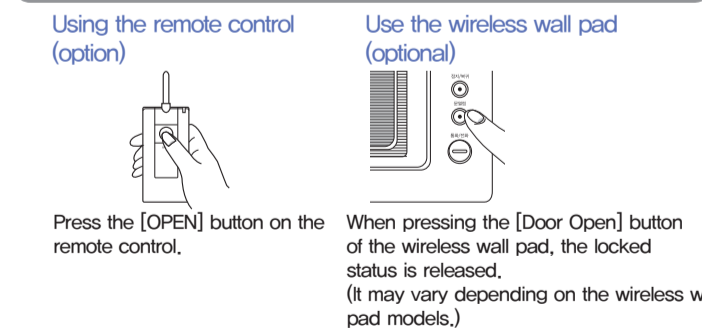

### Closing a door from indoor

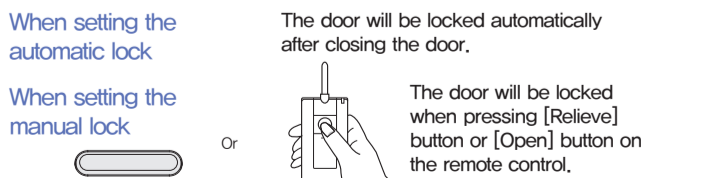

**Reference**

- In the case of you want to check if the door is locked at home, push the relieve button shortly. If the door is locked, red LED light will be on. Otherwise, you will see blue LED light is on.

### Initialization (password, card, key tag, remote controller)

Remove all the information stored. Once it is initialized, password will be set as '1234'. Your need to register your card and a password again after its initialization.

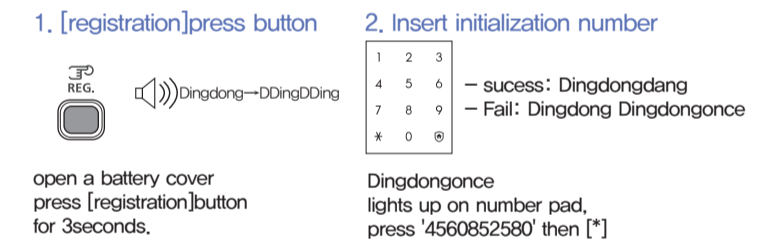

### Passcode Registration

Passcode can be registered in 4~12 digits, and only one can be registered to use.

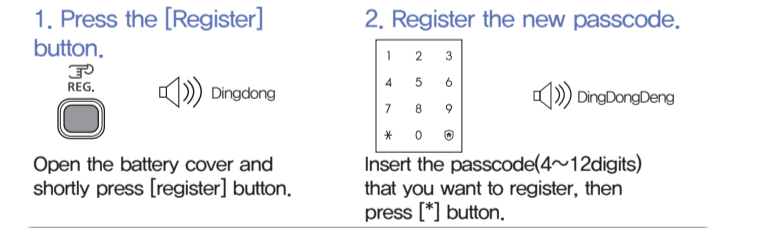

**Caution**

- To prevent theft accidents, it is recommended to use the passcode that is 6 digits or longer (only 0~9 numbers are usable).
- Please be careful to manage the passcode so that other people will not know. Using the same passcode for a long period of time may lead to its exposure, so regularly change the passcode for use.
- Registered passcode cannot be deleted, so register a new passcode to use.

### Fingerprint Registration

Maximum of 100 fingerprints can be registered for use.

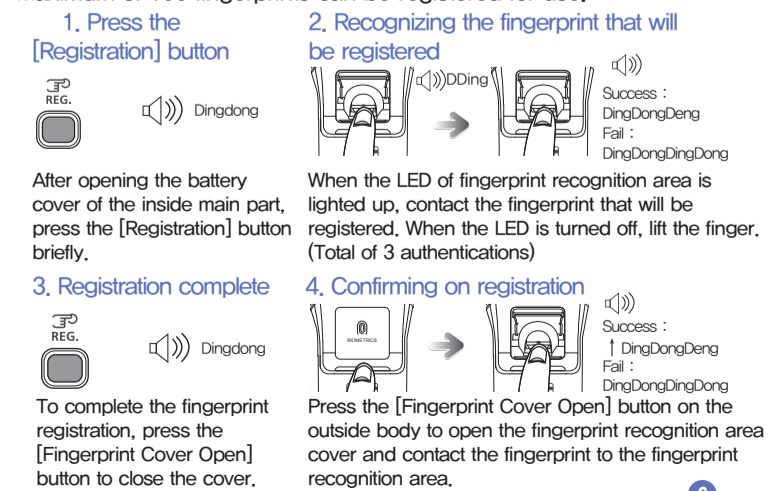

## Fingerprint Deletion

You can delete the registered fingerprint.

1. Press the [Registration] button
2. Recognizing fingerprint that will be deleted

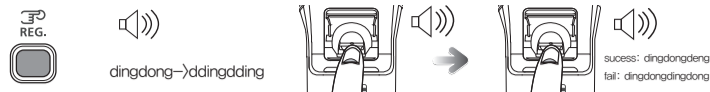

After opening the battery cover of the inside main part, press the [Registration] button briefly.

As the LED is lighted up with the opening of fingerprint recognition area cover, contact the fingerprint that will be deleted to [Fingerprint Recognition Area].

3. Fingerprint Deletion Complete (from the outside)



To complete the fingerprint deletion, press [registration] button to finish.

Reference: In the case of you want to check if the door is locked at home, push the relieve button shortly. If the door is locked, red LED light will be on. Otherwise, you will see blue LED light is on.

## Card and Key Tag Registration

When card or key tag is registered, previously registered card and key tag information are all deleted, so try to register all cards and key tags at once. Total of 20 card keys and key tags can be registered (ISO 14443 Type A support)

1. Press the [Register] button.
2. Contact card and key tag.
3. End card key registration



Caution: To register various cards and key tags continuously, register the card or key tag, and contact another card or key tag within 10 seconds. If another card or key tag is not registered within 10 seconds, the registration automatically ends. To check if the card or key tag is normally registered, check the card and key tag, and then close the door. "Samsung SNS Doorlock" abides to the "ISO 14 443 Type A standards, and the cards, key tags, and NFC-use smartphones that completed certification from "Samsung SNS Doorlock" are able to be registered on the doorlock for use.

## Setting and Disabling Dual-Authentication Mode

Dual-Authentication Mode is a mode with enhanced security that only opens the door when both passcode and fingerprint are recognized. Setting dual-authentication mode is possible when more than 1 fingerprint is already registered.

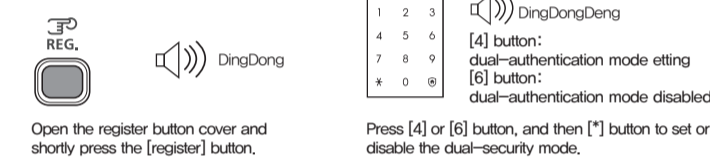

### How to work Dual-Authentication Mode

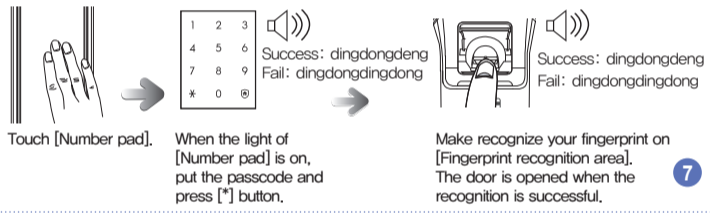

## Setting door locking time feature

This feature is to set the deadbolt locking time after door opening sensor catches. In the condition of door closing slowly, if you set door locking time with this feature, deadbolt jamming problem will be resolved.

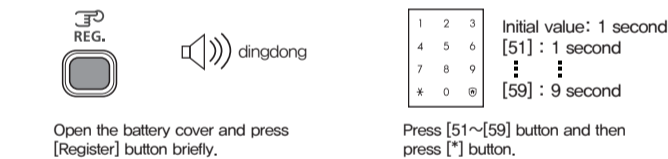

## Intrusion Prevention Feature

This feature rings the alarm when the door is forcibly opened from inside or outside. (You cannot separately turn on/off with the default setting.) If the door is forcibly opened when the door is closed, the door opening sensor detects this and rings the alarm for 5 minutes.

## Battery Replacement

### When the battery replacement notification alarm sounds

If opening the door with passcode, card, or key tag triggers "Fur Elise" melody, then it is time to replace the batteries. (When the battery replacement alarm sounds, the battery replacement alarm LED mark is turned on underside of number pad.)

### Replacing the battery

All 8 batteries must be replaced to new ones within 1 week of first sounding of the alarm. - The doorlock will eventually stop to work if you use it without battery change.

Caution: Battery life for use may vary depending on its manufacturer, manufactured date, and user environment. (With 8 AA-type alkaline 1.5V batteries, about 12 months of use based on 10 uses per day is possible.) Liquid coming from batteries can damage the product, so please check on this in regular basis (about once in 6 months). After the battery replacement notification alarm is sounded, passcode /fingerprint registration, changes, or feature setting cannot be made until the batteries are replaced.

## Use of Emergency Batteries

Not changing the batteries and continuing to use them when it is time to replace the batteries will cause them to discharge, preventing the doorlock from properly operating.

### Open the door by using emergency battery

Purchase the emergency battery (9V) from nearby convenience store or electronics store. - Rather than regular manganese battery or rechargeable battery, it is best to use alkaline battery, which has longer operation life.

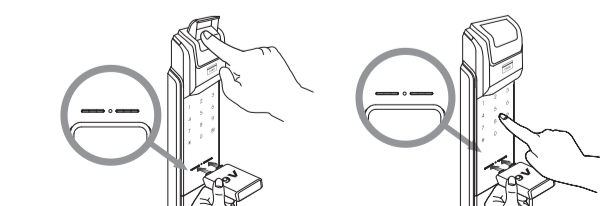

With the 9V battery contacting the outside power (emergency battery) contact area on the outer side of the main unit, contact the fingerprint or enter the passcode.

## Setting and Disabling Dual-Security Mode

Dual-Security Mode is a mode for prevention of passcode exposure by first pressing two random numbers and then entering the actual passcode.

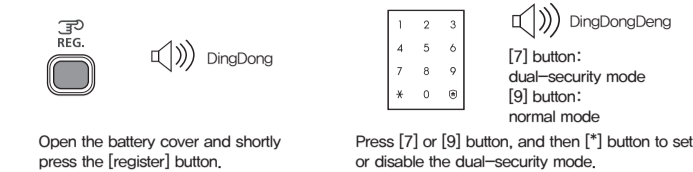

Open the battery cover and shortly press the [register] button.

Press [7] or [9] button, and then [\*] button to set or disable the dual-security mode.

## Automatic/Manual Lock Feature

It is possible to set the automatic lock feature that automatically locks the door when it is closed.

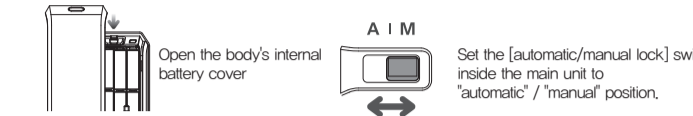

- Automatic: When the door is closed, it is automatically locked 2 seconds later. - Manual: Even when the door is closed, it does not get locked automatically, so pressing [Safety] button on the inside body, [OPEN] button on the remote control, or [Number Input] button on the outside body will lock the door.

## Setting/Disabling Dual-Lock

Dual-Lock Feature is a feature to prevent the door from opening from the outside.

### Setting Dual-Lock Feature



### Disabling Dual-Lock Feature

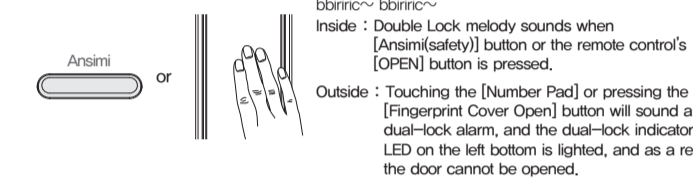

Caution: When the Double Lock feature is turned on, the door can only be opened from outside with an emergency key, so please be aware of the fact when using it. In particular, please caution so children do not accidentally turn it on from the inside.

## Disabling Alarm Sound/Emergency Sound

After open the registerbutton cover of inside part of body, push [register] button or take out batteries. Insert registered fingerprint or register card or insert passcode, and then press [\*] button.

## Prank Prevention Feature

When the doorlock is erroneously operated from the outside, this feature sounds an alarm as well as prevents the doorlock from working. Trying to open the door with unregistered card or key tag, or incorrectly entering the passcode for five times or more, an alarm is sounded and the doorlock does not operate for 3 minutes.

## Sound Setting/Disabling

The sound from entering the passcode, locking the door, or opening the locked door can be adjusted. When the product is first purchased, the default setting is to play all the sounds.

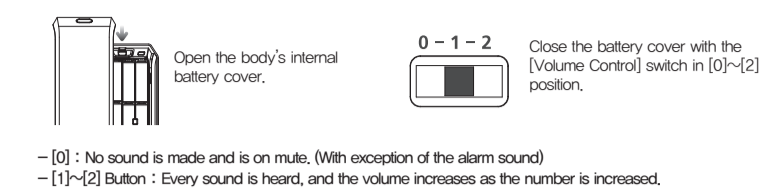

- [0] : No sound is made and is on mute. (With exception of the alarm sound) - [1]-[2] Button : Every sound is heard, and the volume increases as the number is increased.

## Crime Prevention Feature On/Off

This feature prevents theft when leaving the house unattended and in case of when operating the door lock from inside, alarm sound is to sound. With the crime prevention feature on, if the [Ansimi(safety)] button in the interior body is pressed or the door opens with the handle, "beep~beep~" alarm sound rings for 5 minutes.

### Setting Crime Prevention Feature

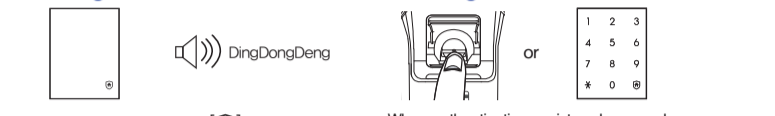

When the door is locked, [Ansimi] button on the number keypad on the outside lights up. Pressing [Ansimi] button within 3 seconds sets the crime prevention feature.

### Disabling Crime Prevention Feature

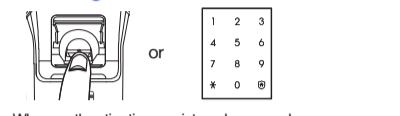

When authenticating registered passcode, or entering the passcode, press the [\*] button.

## Setting/Disabling Welcome Feature

Welcome feature is a convenience feature that the doorlock status is changed automatically to recognition standby when user approaches to doorlock without touching number pad or fingerprint cover opening button.

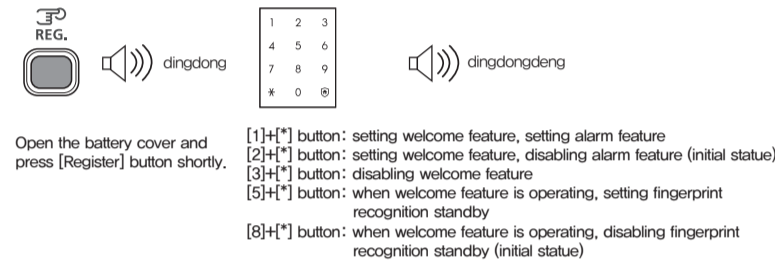

Open the battery cover and press [Register] button shortly. [1]+[\*] button: setting welcome feature, setting alarm feature [2]+[\*] button: setting welcome feature, disabling alarm feature (initial status) [3]+[\*] button: disabling welcome feature [5]+[\*] button: when welcome feature is operating, setting fingerprint recognition standby [8]+[\*] button: when welcome feature is operating, disabling fingerprint recognition standby (initial status)

### Setting and disabling / feature explanation

-Welcome feature setting: the mode that the doorlock status is changed to recognition standby automatically when user approaches to doorlock -Welcome feature disabling: the mode that doorlock status is NOT changed to recognition standby automatically even when user approaches to doorlock. The doorlock only opens by touching number pad or fingerprint. -Setting/disabling alarm: Prank prevention feature is turned on when someone is standing in front of the doorlock more than 1 minutes.

Caution: Initially the doorlock's welcome feature is on and alarm feature is off. infrared rays sensor operation distance can be changed by being exposed to sunlight directly. Use limitedly welcome feature when it is in the house or apartment where always exposed to sunlights or any lights because alarm might sounds.