

SS7/LP-1E

cylindrical photosensors



Micro Detectors

Italian Sensors Technology



Indicative image

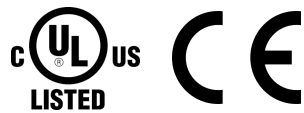
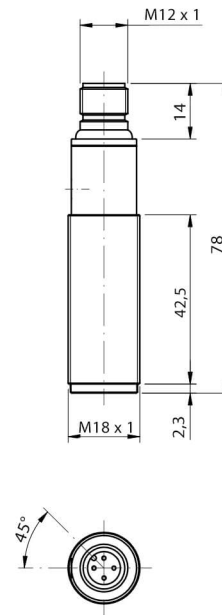

Detection properties

Nominal sensing distance	400mm
Thermal drift of Sr	≤10% Sr
Repeat Accuracy	5%
Sensitivity adjustment	Trimmer

Application

Function Principle	Diffuse reflection (medium distance, ≤600mm)
Notes	white target 90% Kodak 200x200mm
Optic position	Axial

Outputs

Output type	PNP
Output Function	LO

Switching frequency 250Hz

Electrical data

Operating Voltage 10...30Vdc

No-Load supply current $\leq 30\text{mA}$

Load current $\leq 100\text{mA}$

Leakage current $\leq 10\mu\text{A}$

Output voltage drop 1,2V max. $I_L = 100\text{ mA}$

Max ripple content 10%

LED indicators Yellow (output state)

Time delay before availability $\leq 200\text{ms}$

Short-circuit protection Yes

Reverse Polarity Protection Yes

Emission Infrared (880 nm)

Interference to external light 3000lux (incandescent lamp), 10000lux (sunlight)

Impulsive Overvoltage Protection Yes

Mechanical data

Dimensions M18 x 1 / L =78mm

Weight 100g

Housing Material Nickel plated brass / PC plug

Connections M12 plug

Active Head Material PMMA

Tightening torque 25Nm

Operating temperature - 25°C...+ 70° C (Without freeze)

Diameter/Dimension M18

Test/Approvals

Approvals CE, cULus

EMC compatibility EN 60947-5-2

Shocks and vibrations Vibration IEC 60068-2-6 / Shock IEC 60068-2-27

Degree of protection IP67

Accessories

Supplied Accessories nuts M18 x 1, screwdriver

ELECTRICAL DIAGRAMS OF THE CONNECTIONS

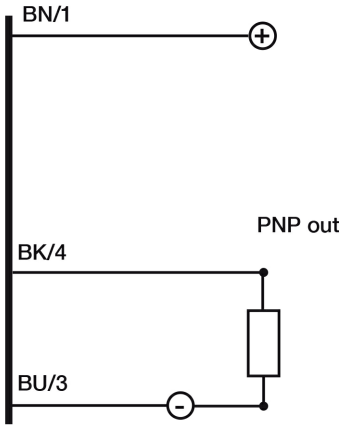

CONNECTOR

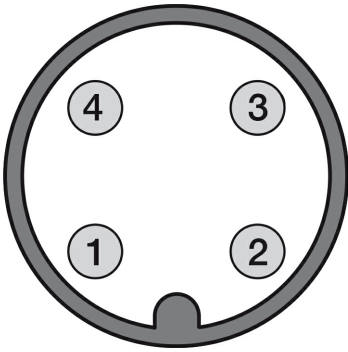

RESPONSE CURVES

Dimensione Spot

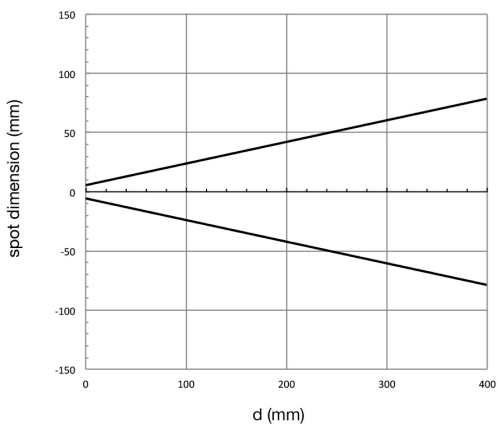

Disassamento Parallelo

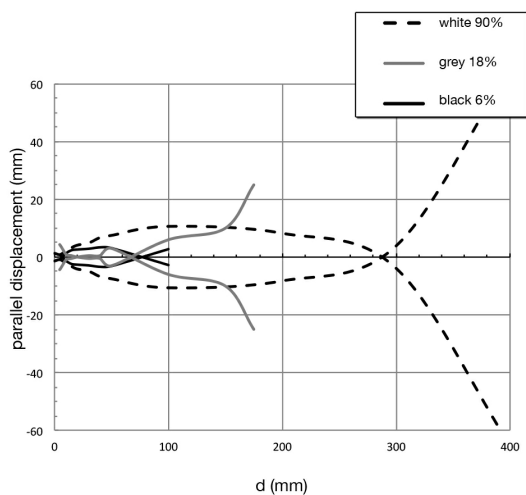

Eccesso di Guadagno

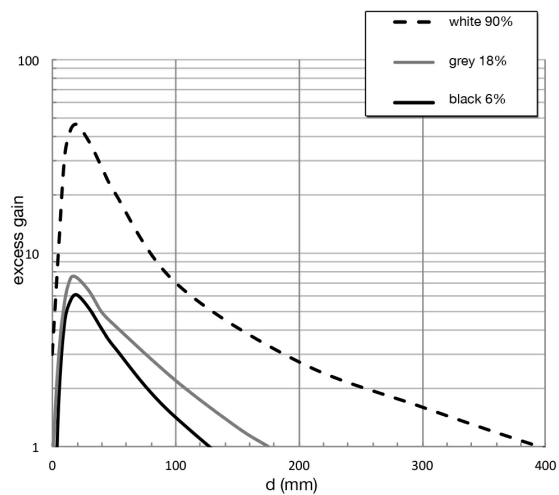

M.D.Micro Detectors S.p.A.

Strada S.Caterina, 235

41122 Modena (MO)

Tel. 059 420411

Fax 059 253973

E-mail info@microdetectors.com

date of printing

25/01/2021 14:06:58