

- Extra reinforced aluminium cast body through the heat treatment and industrial design
- Light and powerful design
- %100 Holding Negative-Acting Hydraulic brake system.
- Standard Pressure Roller and Roller Failed.
- Easy assembly, High rope capacity and High torque hydromotor
- Standard manual rope unloading system

## Specifications

HMW 5.0 PHT/P Air Clutch  
HMW 5.0 PHT Manual Clutch

<b>Max.pulling capacity (kg / lbs)</b>	: 5000 kg (11022)
<b>Max.rope length (mt / ft)</b>	: 45 m (148 ft)
<b>Recommended wire rope (mm / in)</b>	: 12 mm (1/2")
<b>Hydromotor (cc / in<sup>3</sup>) :</b>	: 315 cc (19 in <sup>3</sup> )
<b>Max. pump flow (l / min - gal / min)</b>	: 60 lt (15.8 gal)
<b>Gear ratio:</b>	: 5,6 : 1
<b>Oil types and capacity</b>	: 85W 90 - 0,75 lt.
<b>Max. working pressure (bar / psi)</b>	: 165 bar (2392 psi)

### Winch : (kg / lbs )

44 kg (96,8 lbs)

### Roller Fairlead : ( kg / lbs )

6 kg (13,22 lbs)

### Cable Tensioner

2,5 kg (5,51 lbs)

### Mounting Bolts

8 pieces M14 8,8

### Standards

Cable tensioner  
Roller Fairlead

### Optinal

Air Clutch  
IP67 - IP 68

### Hydraulic Inlets

G 1/2"

Rope Winding Layer	Pulling Capacity kg / lbs	Rope Speed m / min- ft / min	Rope Length m / ft
1	5000 / 11022	11 / 37	6 / 21
2	4203 / 9264	13 / 44	14 / 46
3	3625 / 7990	15 / 51	23 / 77
4	3187 / 7024	17 / 58	33 / 109
5	2843 / 6267	20 / 65	45 / 148

### Warning !!

- Before operate the winch, A-B lines must be open to T line (tank line) of the control valve in center position.
- This winch is desingd and manufactured for pulling, don't lift person or metarial.
- Always keep last 5 wrap on the drum.
- The technical details given above just for infarmation. HAMMER WINCH keeps the to change the technical. details
- Pneumatic Working Pressure: Min - Max 9 – 12 bar (130 - 174 psi)

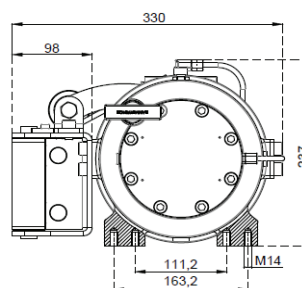
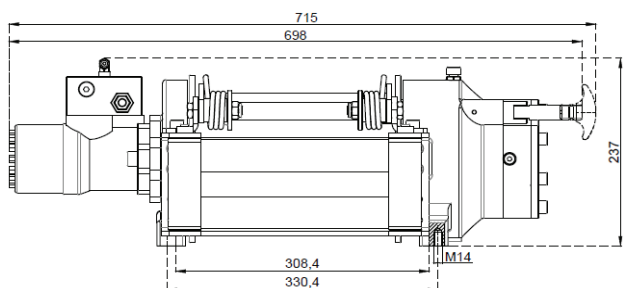

Manual

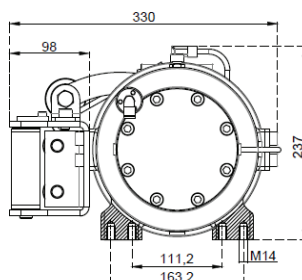
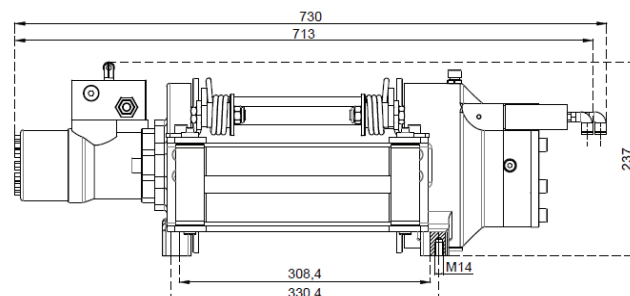
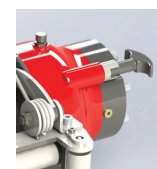

Air Clutch

