

# SC18FTX Tropical Compressor R134a 220-240V 50/60Hz

Data Sheet (Replaces CG.44.E1.02)

## General

Compressor	<b>SC18FTX</b>
Code number	104G8805

## Application

Application		LBP
Evaporating temperature range	°C	-35 to -5
Voltage range	V/Hz	LBP: 187 - 254 /50
		LBP: 198 - 254 /60
Motor type		CSIR
Max. ambient temperature	°C	43
Comp. cooling at ambient temp.	32°C	LBP: F <sub>2</sub>
	38°C	LBP: F <sub>2</sub>
	43°C	LBP: F <sub>2</sub>

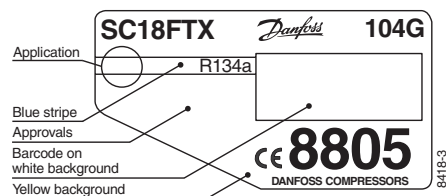

- S = Static cooling normally sufficient
- O = Oil cooling
- F<sub>1</sub> = Fan cooling 1.5 m/s  
(compressor compartment temperature equal to ambient temperature)
- F<sub>2</sub> = Fan cooling 3.0 m/s necessary

## Design

Displacement	cm <sup>3</sup>	17.69
Oil quantity	cm <sup>3</sup>	550
Maximum refrigerant charge	g	1300
Free gas vol. in compressor	cm <sup>3</sup>	1460
Weight without electrical equipment	kg	13.7

## Motor

Motor size	watt	495
LRA (rated after 4 sec. UL984) HST	A	18.6
Cut-in current HST	A	18.6
Resistance, main and start winding (25°C)	Ω	3.7/14.1
Approvals		EN 60335-2-34

## Dimensions

Height	mm	A	219
		B	213
		B1	193
		B2	110
Suction connector	location/I.D. mm	C	10.2 ±0.09
Process connector	location/I.D. mm	D	6.2 ±0.09
Discharge connector	location/I.D. mm	E	6.2 ±0.09
Compressors on a pallet	pcs.		80

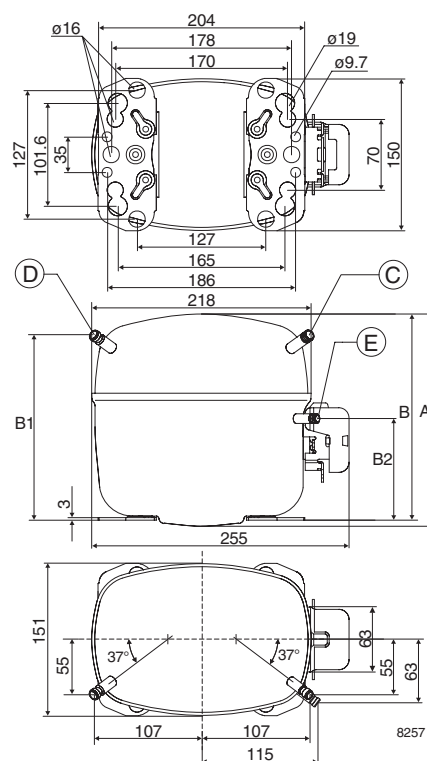

**Capacity (EN 12900/CECOMAF)**
**watt**

Evap. temp in °C	-35	-30	-25	-23.3	-20	-15	-10	-5
SC18FTX, 50Hz	144	229	325	361	437	567	719	896
SC18FTX, 60Hz	187	280	390	432	520	675	857	1071

**Capacity (ASHRAE)**
**watt**

Evap. temp in °C	-35	-30	-25	-23.3	-20	-15	-10	-5
SC18FTX, 50Hz	178	282	401	445	539	700	889	1108
SC18FTX, 60Hz	230	345	481	532	642	834	1060	1326

**Power consumption**
**watt**

Evap. temp in °C	-35	-30	-25	-23.3	-20	-15	-10	-5
SC18FTX, 50Hz	257	313	365	383	416	466	517	571
SC18FTX, 60Hz	274	348	420	444	489	557	622	686

**Current consumption**
**A**

Evap. temp in °C	-35	-30	-25	-23.3	-20	-15	-10	-5
SC18FTX, 50Hz	2.52	2.69	2.87	2.94	3.07	3.27	3.49	3.72
SC18FTX, 60Hz	2.05	2.36	2.66	2.77	2.97	3.28	3.59	3.90

**COP (EN 12900/CECOMAF)**
**W/W**

Evap. temp in °C	-35	-30	-25	-23.3	-20	-15	-10	-5
SC18FTX, 50Hz	0.56	0.73	0.89	0.94	1.05	1.22	1.39	1.57
SC18FTX, 60Hz	0.68	0.80	0.93	0.97	1.06	1.21	1.38	1.56

**COP (ASHRAE)**
**W/W**

Evap. temp in °C	-35	-30	-25	-23.3	-20	-15	-10	-5
SC18FTX, 50Hz	0.69	0.90	1.10	1.16	1.30	1.50	1.72	1.94
SC18FTX, 60Hz	0.84	0.99	1.15	1.20	1.31	1.50	1.70	1.93

Test conditions	EN 12900/CECOMAF	ASHRAE
Condensing temperature	55°C	55°C
Ambient and suction gas temp.	32°C	32°C
Liquid temperature	55°C	32°C
50Hz: Fan cooling F <sub>2</sub> , 220V		
60Hz: Fan cooling F <sub>2</sub> , 220V		

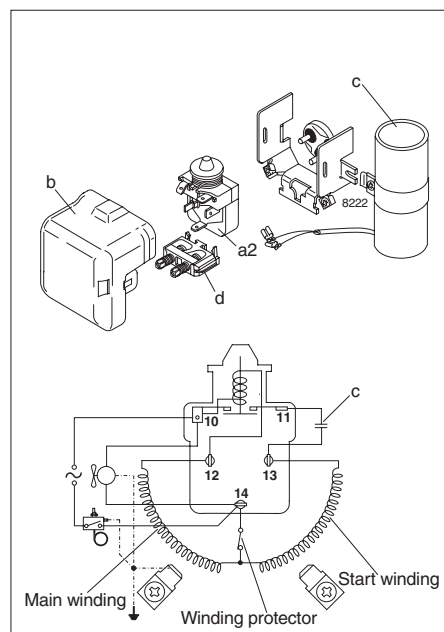
**Accessories**

Devices	Fig.	SC18FTX
Starting relay	a2	117U6019
Cover	b	103N2009
Starting capacitor 80 µF	c	117U5017
Cord relief	d	103N1004
Mounting accessories		
Bolt joint for one compressor		118-1917
Bolt joint in quantities		118-1918
Snap-on in quantities		118-1919