

# GT series pneumatic turbine vibrator(aluminum)

## Characters

- Large power, without lubrication, very quiet.
- Nominal frequency 5800~46000 rmps.
- Centrifugal force 135~10600N.
- Parameter adjustable( air pressure).
- Maximum working temperature:150°C .
- 200°C is available upon requests.
- Suitable for extreme bad environment.

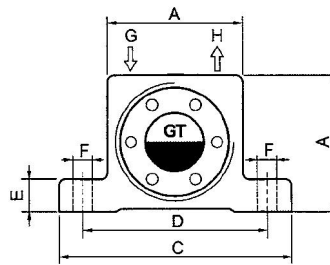

Overall dimensions



[ Patent No: ZL2010 2 0172618.3 ]  
[ Patent No: ZL2010 3 0150717.7 ]

## Typical application

- Vibrating table.
- Filter sieve.
- Storage bin emptying.
- Material conveying.
- Prevent hanging on the wall in pipeline of storage bin.

## Structure

Creating the vibration force by the positive and negative unbalanced torque on the wheel, the wheel is supported by the fully enclosed ball shaft which is pre-lubricated, the bearing contains special lubrication grease which ensure long life and adapt to different situations.

## Performance parameters

Mode	Vibration times/min.			Centrifugal force(N)			Air consumed L/ min.		
	0.2MPa	0.4MPa	0.6MPa	0.2MPa	0.4MPa	0.6MPa	0.2MPa	0.4MPa	0.6MPa
GT-04	14100	15100	16100	135	160	200	30	40	50
GT-06	11500	12500	13500	130	165	210	30	40	50
GT-08	35850	43000	45900	980	2100	2950	48	75	152
GT-10	26950	34800	37600	850	1400	2450	48	75	152
GT-13	25950	30050	39800	1450	2450	3700	125	210	280
GT-16	16950	21800	24100	1250	2100	3150	125	210	280
GT-20	16950	19800	23100	2180	4050	5500	188	315	465
GT-25	11980	15600	17100	2150	3550	5600	188	315	465
GT-30	12990	14010	16100	3400	5450	7550	335	520	755
GT-36	7990	10100	13000	3300	5380	7180	335	520	755
GT-40	7650	8850	9550	4350	7350	9850	428	680	960
GT-48	5800	7550	9750	4950	7750	10600	428	680	960

Remark: The data in above form taken from Kistler triaxial dynamometer on heavy test platform, when the installation rigidity is poor, the frequency and force will become lower.

## Dimension

Mode	A	Thickness	C	D	E	F	G	H	Weight
	mm	mm	mm	mm	mm	mm	G thread	G thread	kg
GT-04	40	28	70	56	10	6	G1/8	G1/8	0.15
GT-06	40	28	70	56	10	6	G1/8	G1/8	0.15
GT-08	50	33	86	68	12	7	G1/8	G1/8	0.30
GT-10	50	33	86	68	12	7	G1/8	G1/8	0.32
GT-13	65	42	113	90	16	9	G1/4	G1/4	0.60
GT-16	65	42	113	90	16	9	G1/4	G1/4	0.63
GT-20	80	56	128	104	16	9	G1/4	G1/4	1.10
GT-25	80	56	128	104	16	9	G1/4	G1/4	1.13
GT-30	100	73	160	130	20	11	G3/8	G3/8	2.25
GT-36	100	73	160	130	20	11	G3/8	G3/8	2.28
GT-40	120	83	194	152	24	17	G3/8	G3/8	3.50
GT-48	120	83	194	152	24	17	G3/8	G3/8	3.60