

● Features:

Output current in excess of 150 mA No external components required Internal short circuit current limiting
 Internal thermal overload protection Available in either 5% selections

● Electrical Characteristics (Ta=25°C)

Parameter	Symbol	Ratings	Unit
Input voltage (Ta=25°C)	V _I	35	V
Output current	I _O	0.15	A
Power dissipation (Ta=25°C)	P _D	0.5	W
Ambient temperature	T _{OP}	-40~85	°C
Storage Temperature	T _{stg}	-55~150	°C

Three-terminal fixed output voltage regulator
 0.5W, 0.15A, 5V

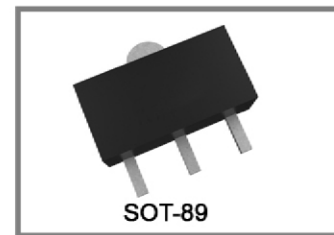

Main purposes:

the role of regulator and protection for a variety of electrical appliances, electronic equipment, regulator circuit

● Electrical characteristics (Unless otherwise specified) V_I=10V, I_O=40mA, C_I=0.33μF, C_O=0.1μF

Parameter	Symbol	Test Conditions	Min	Typ	Max	Unit	
Output voltage	V _O	T _J =25°C	4.75	5	5.25	V	
		1mA ≤ I _O ≤ 40mA, 7V ≤ V _I ≤ 20V	4.65	5	5.35		
Voltage Regulation	S _V	T _J =25°C	7V ≤ V _I ≤ 20V	—	—	150	mV
			8V ≤ V _I ≤ 20V	—	—	100	
Current Regulation	S _I	T _J =25°C, 1mA ≤ I _O ≤ 100mA	—	—	60	mV	
Quiescent Current	I _Q	T _J =25°C	—	—	6	mA	
Quiescent Current Change	ΔI _Q	1mA ≤ I _O ≤ 40mA	—	—	0.1	mA	
		8V ≤ V _I ≤ 20V	—	—	1.5		
Input - output differential pressure	V _I - V _O	T _J =25°C	—	1.7	—	V	
Ripple Rejection Ratio	S _{rip}	T _J =25°C, 8V ≤ V _I ≤ 18V, f=120Hz	—	49	—	dB	

SOT-89 Dimensions

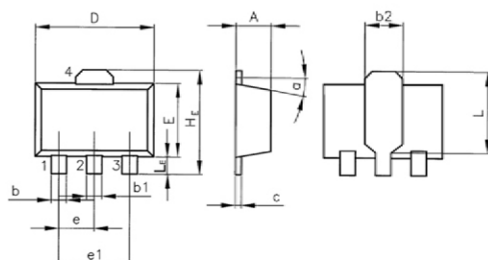

1 OUT 2 GND 3 IN 4 GND

Unit: mm

Size Symbol	SOT-89			Size Symbol	SOT-89		
	min	typ	max		min	typ	max
A		1.5		e		1.5	
b			0.65	e1		3	
b1			0.65	H _E			4.25
b2		1.6		L	2.6		2.95
c	0.25			L _E	0.8		1.2
D		4.5		α			10°
E			2.6				

SK MAKE CONSCIOUS PRODUCT

CONSCIOUS PRODUCTS BEGIN WITH CONSCIOUS PEOPLE

