



CONNECTOR SOLUTIONS



Turkey
Discover
the potential

CONNECTOR SOLUTIONS



TTAF Elektronik Ltd was founded in Istanbul /Turkey in 2003, providing interconnect solutions for defense, aerospace, automotive, industrial, telecom and led lighting applications including: Wiring harnesses, Cable Assemblies, Optical Fiber, Power, RF, Molded, Electromechanical Assemblies, Lighting Systems and IP rated outdoor solutions.

Servicing our diverse customers worldwide from our state of the art manufacturing facilities in Istanbul(6000sqm closed area) and Ankara(4000sqm closed area), TTAF is now a global interconnect solutions and cable assembly leader always valuing customer satisfaction.

After more than 30 years in the connector marketplace, TTAF capitalized to create own wire harness and cable assembly business offering wiring harness assemblies using optimum grade wire and other material with the help of cutting-edge machines in adherence to set electronic industry norms.

TTAF is ISO9001:2015, AS9100D, TSE, IPC/WHMA-A-620B, UL, CE, ATEX, ETL & 3P certified to meet even the most demanding quality standards.



WPD Connectors and Electrical Splitters

Table of Contents		
	2 Pin Pluggable, Screw Connection, Field Assembly Connectors	6
	3 Pin Pluggable, Screw Connection, Field Assembly Connectors	7
	4 Pin Pluggable, Screw Connection, Field Assembly Connectors	8
	3 Pin I Type, Screw Connection, Field Assembly Connector	9
	3 Pin I Type, Screw Connection, Field Assembly Connectors	10
	3 Pin I Type, Push in Wire, Field Assembly Connector	11
	3 Pin Panel Type, Screw Connection, Field Assembly Connector	12
	3 Pin T Type, Screw Connection, Field Assembly Connector	13
	6 Pin I Type, Screw Connection, Field Assembly Connector	14
	3 Power +6 Data I Type, Screw Connection, Field Assembly Connector	15
	3 Power + Fiber LC Duplex I Type, Screw Connection, Field Assembly Connector	16
	6 Pin T Type, Screw Connection, Field Assembly Connector	17
	2 Pin Pluggable, Field Assembly 1 in 3 out Electrical Splitters	18
	3 Pin Pluggable, Field Assembly 1 in 3 out Electrical Splitters	19
	4 Pin Pluggable, Field Assembly 1 in 3 out Electrical Splitters	20
	3 Pin Screw Connection, Field Assembly 1 in 3 out Electrical Splitter	21
	3 Pin Screw Connection, Field Assembly 1 in 5 out Electrical Splitter	22
	IP Box Electrical Splitter	23

PRODUCTION, DESIGN AND TOOLING...

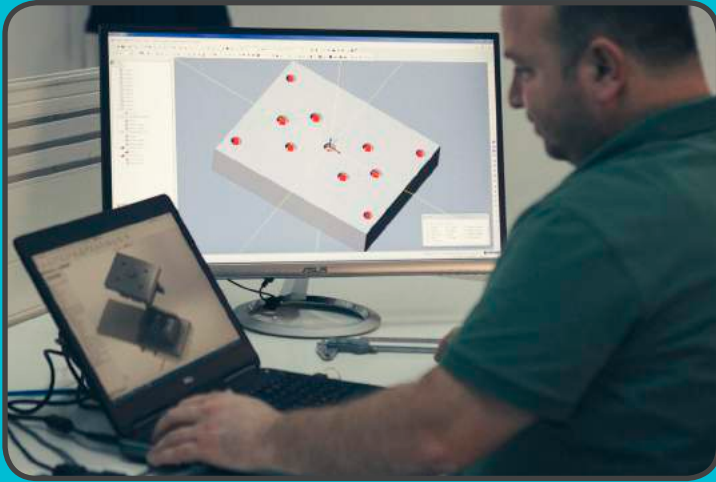

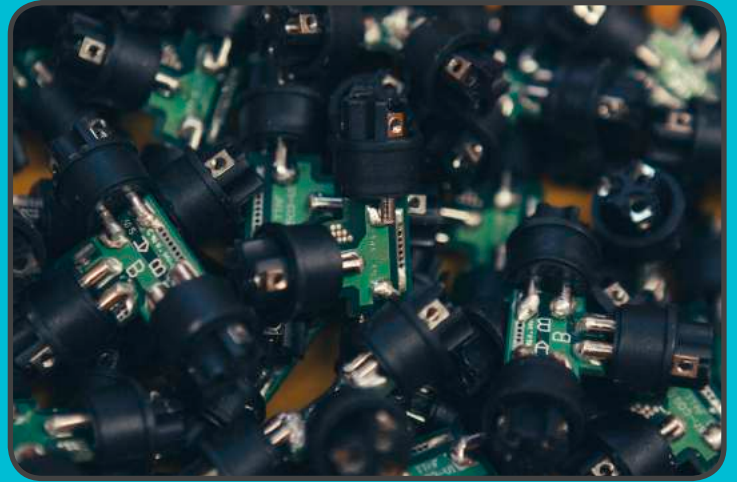

2 Pin Pluggable
Screw Connection
Field Assembly

Connectors

WPF-WPM-WPP Series

2 pin
300 VAC
35A



WPM-0200M35

2 Pin Male Cable Type



WPF-0200M35

2 Pin Female Cable Type



WPP-0200M35

2 Pin Male Panel Type

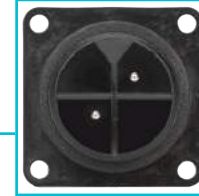

GONTUANA[®]
Waterproof Connector Series

Technical Specifications

Number of Poles
Voltage Rating
Current Rating
Cable Cross Section Area
Durability Voltage
Insulation Structure
Contact Resistance
Min Wire Size OD
Max Wire Size OD
Temperature Rating
IP Class
Mold Material
Contact/Terminal Material
Seal Material

Product Codes

WPM-0200M35
WPF-0200M35
WPP-0200M35

2
300VAC max.
35A max.
0,5mm² ~ 2,5mm²
3000VAC@60s.
500 MΩ at 500VDC
30 mΩ max.
5,5mm
8,5mm
-40°C ~ +85°C
IP67
PA6
Nickel-Plated Brass
Silicone

WPP-0200M35

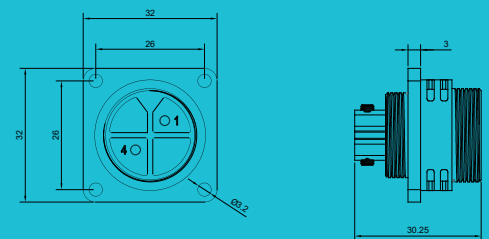

WPF-0200M35

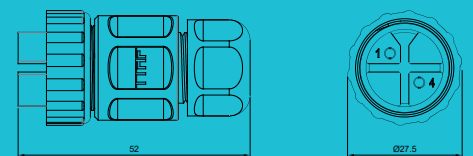

WPM-0200M35

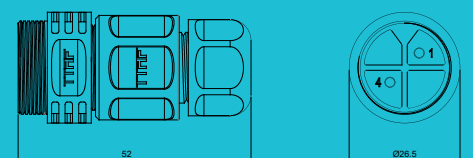

3 Pin Pluggable
Screw Connection
Field Assembly

Connectors

WPF-WPM-WPP Series

3 pin
300 VAC
25A



WPM-0300M25

3 Pin Male Cable Type

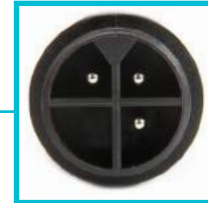

WPF-0300M25

3 Pin Female Cable Type



WPP-0300M25

3 Pin Male Panel Type

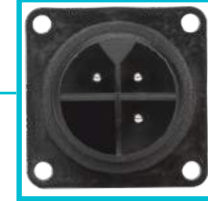

GONTUANA[®]
Waterproof Connector Series

Technical Specifications

Number of Poles
Voltage Rating
Current Rating
Cable Cross Section Area
Durability Voltage
Insulation Structure
Contact Resistance
Min Wire Size OD
Max Wire Size OD
Temperature Rating
IP Class
Mold Material
Contact/Terminal Material
Seal Material

Product Codes

WPM-0300M25
WPF-0300M25
WPP-0300M25

3
300VAC max.
25A max.
0,5mm² ~ 2,5mm²
3000VAC@60s.
500 MΩ at 500VDC
30 mΩ max.
5,5mm
8,5mm
-40°C ~ +85°C
IP67
PA6
Nickel-Plated Brass
Silicone

WPP-0300M25

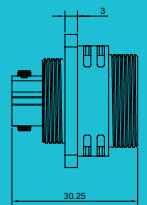
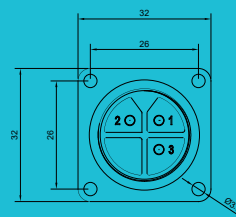

WPF-0300M25

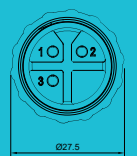
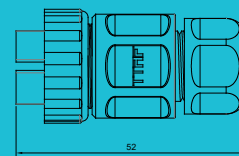

WPM-0300M25

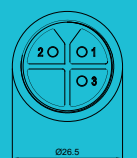
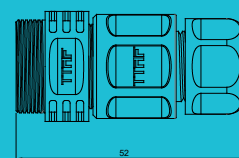

4 Pin Pluggable Screw Connection Field Assembly

Connectors

WPF-WPM-WPP Series

4 pin
300 VAC
25A



WPM-0400M25

4 Pin Male Cable Type

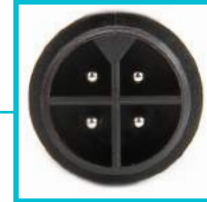

WPF-0400M25

4 Pin Female Cable Type



WPP-0400M25

4 Pin Male Panel Type

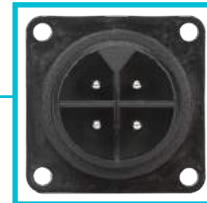

GONTUANA®

Waterproof Connector Series

Technical Specifications

Number of Poles
Voltage Rating
Current Rating
Cable Cross Section Area
Durability Voltage
Insulation Structure
Contact Resistance
Min Wire Size OD
Max Wire Size OD
Temperature Rating
IP Class
Mold Material
Contact/Terminal Material
Seal Material

Product Codes

WPM-0400M25
WPF-0400M25
WPP-0400M25

4
300VAC max.
25A max.
0,5mm² ~ 2,5mm²
3000VAC@60s.
500 MΩ at 500VDC
30 mΩ max.
5,5mm
8,5mm
-40°C ~ +85°C
IP67
PA6
Nickel-Plated Brass
Silicone

WPP-0400M25

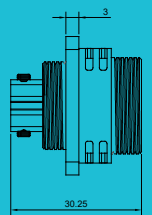
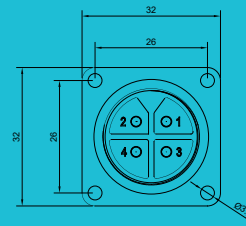

WPF-0400M25

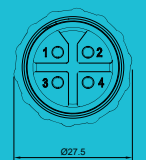
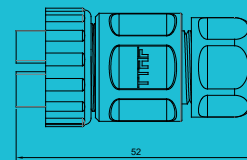

WPM-0400M25

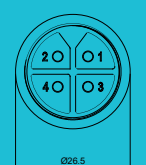
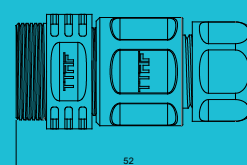

3 Pin I Type
Screw Connection
Field Assembly

Connector

3 pin
250 VAC
16A

WPI Series

CE EN 60309-1
EN 60695-2
EN 61984-2009



GONTUANA[®]
Waterproof Connector Series

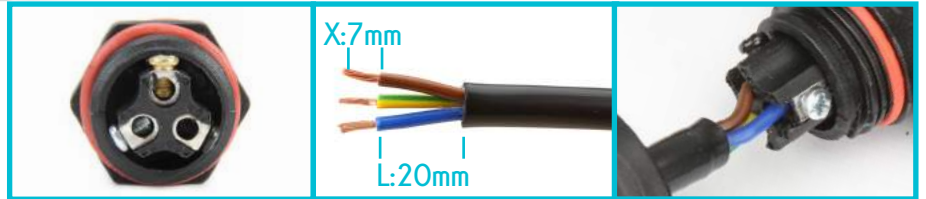

Technical Specifications

Number of Poles
Voltage Rating
Current Rating
Cable Cross Section Area
Durability Voltage
Insulation Structure
Contact Resistance
Min Wire Size OD
Max Wire Size OD
Temperature Rating
IP Class
Mold Material
Contact/Terminal Material
Seal Material

Product Code

WPI-0302M16

3
250VAC max.
16A max.
0,5mm² ~ 2.5mm²
1500VAC@60s.
500 MΩ at 500VDC
10 mΩ max.
5,5mm
8,5mm
-40°C ~ +85°C
IP68
PA6
Nickel-Plated Brass
Silicone

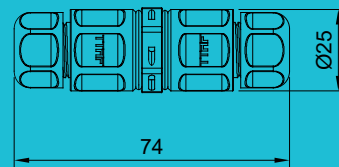
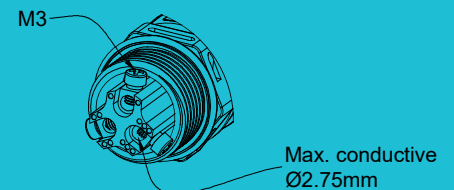

3 Pin I Type
Screw Connection
Field Assembly

Connectors

WPI Series

3 pin
250 VAC
16A



GONTUANA[®]
Waterproof Connector Series

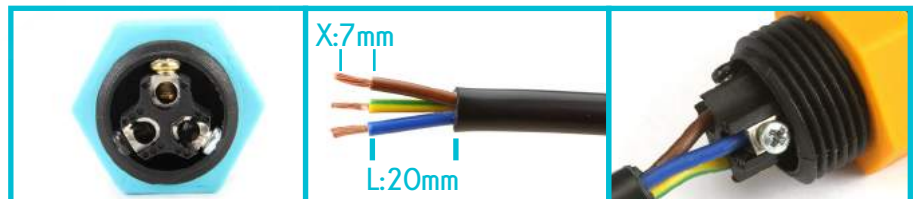

Technical Specifications

Number of Poles
Voltage Rating
Current Rating
Cable Cross Section Area
Durability Voltage
Insulation Structure
Contact Resistance
Min Wire Size OD
Max Wire Size OD
Temperature Rating
IP Class
Mold Material
Contact/Terminal Material

Product Codes

WPI-0302M16/U2 - Turquoise
WPI-0302M16/O2 - Orange

3
250VAC max.
16A max.
0,5mm² ~ 2,5mm²
1500VAC@60s.
500 MΩ at 500VDC
10 mΩ max.
5,5mm
8,5mm
-40°C ~ +85°C
IP68
PA6
Nickel-Plated Brass

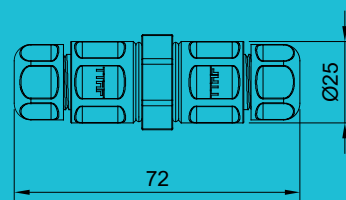
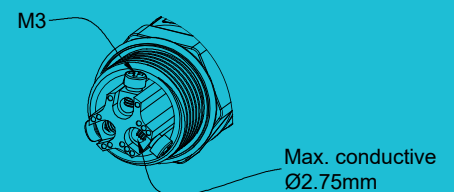

3 Pin I Type
Push in Wire
Field Assembly

Connector

WPK Series

3 pin
250 VAC
6A



GONTUANA[®]
Waterproof Connector Series

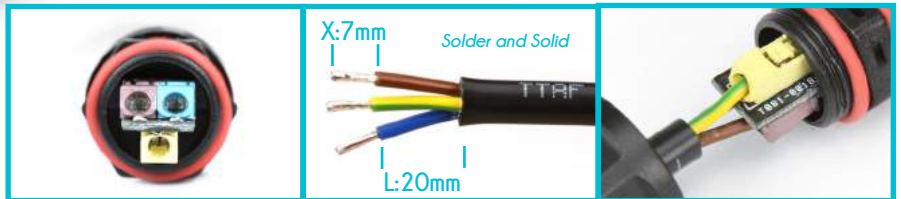

Technical Specifications

Product Code WPK-0302M6

Number of Poles	3
Voltage Rating	250VAC max.
Current Rating	6A max.
Cable Cross Section Area	0,5mm ² ~ 1,5mm ²
Durability Voltage	1250VAC@60s.
Insulation Structure	1000 MΩ@1000V
Contact Resistance	12 mΩ
Min. Wire Size OD	5.5 mm
Max. Wire Size OD	8.5 mm
Operating Temperature	-40°C ~ +85°C
IP Class	IP68
Mold Material	PA6
Terminal Type	Push Button Screwless Terminal
Contact Material	Phosphor Bronze, Tin-Plated
Seal Material	Silicone

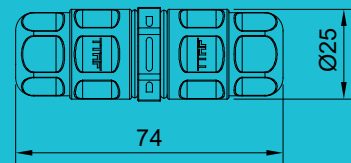
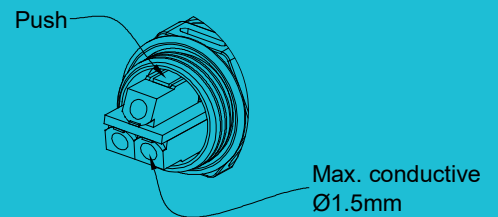

3 Pin Panel Type
Screw Connection
Field Assembly

Connector

WPP Series

3 pin
250 VAC
16A



GONTUANA[®]
Waterproof Connector Series

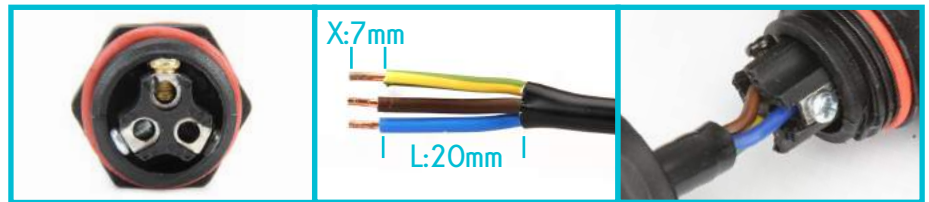

Technical Specifications

Product Code WPP-0302M16

Number of Poles	3
Voltage Rating	250VAC max.
Current Rating	16A max.
Cable Cross Section Area	0,5mm ² ~ 2,5mm ²
Durability Voltage	1500VAC@60s.
Contact Resistance	10 mΩ max.
Insulation Structure	500 MΩ at 500VDC
Min Wire Size OD	5,5mm
Max Wire Size OD	8,5mm
Temperature Rating	-40°C ~ +85°C
IP Class	IP68
Mold Material	PA6
Contact/Terminal Material	Nickel-Plated Brass
Seal Material	Silicone
Chasis Hole Dia	Ø16mm
Chasis max. Thickness	3,5mm

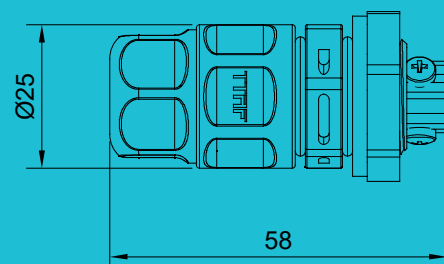
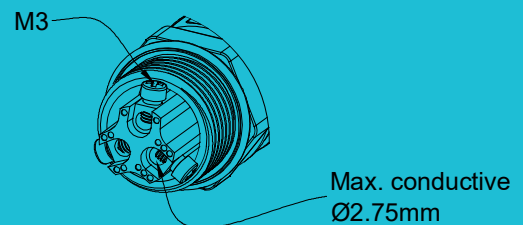

3 Pin T Type
Screw Connection
Field Assembly

Connector

3 pin
250 VAC
16A

WPT Series



EN 60309-1
EN 60695-2
EN 61984-2009



GONTUANA[®]
Waterproof Connector Series

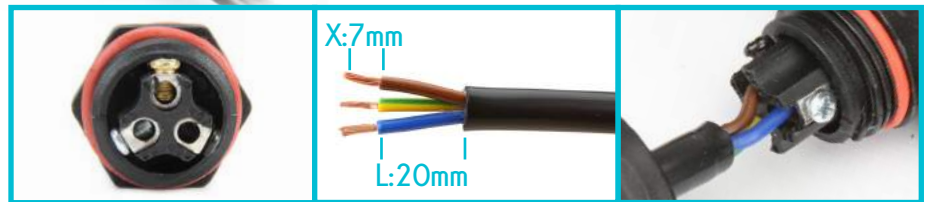

Technical Specifications

Product Code WPT-0303M16

Number of Poles	3
Voltage Rating	250VAC max.
Current Rating	16A max.
Cable Cross Section Area	0,5mm ² ~ 2,5mm ²
Durability Voltage	1500VAC@60s.
Insulation Structure	500 MΩ at 500VDC
Contact Resistance	10 mΩ max.
Min Wire Size OD	5,5mm
Max Wire Size OD	8,5mm
Temperature Rating	-40°C ~ +85°C
IP Class	IP68
Mold Material	PA6
Contact/Terminal Material	Nickel-Plated Brass
Seal Material	Silicone

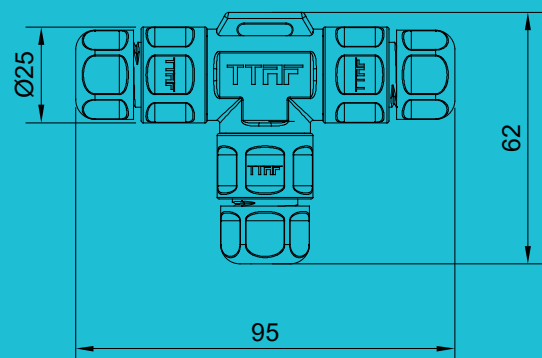
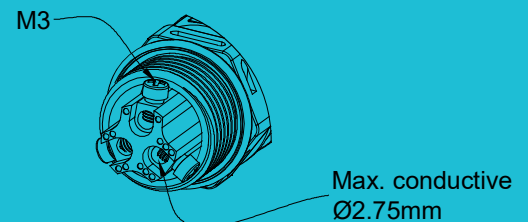

6 Pin I Type
Screw Connection
Field Assembly

Connector

WPI Series

6 pin
250 VAC
25A



GONTUANA[®]
Waterproof Connector Series

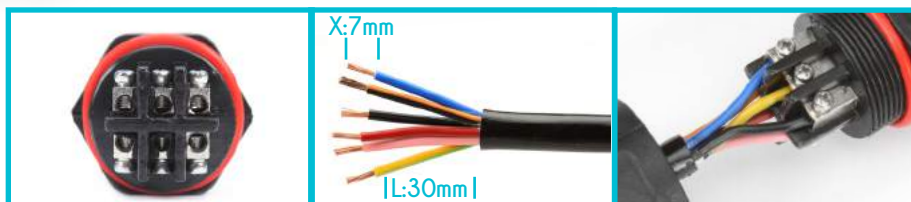

Technical Specifications

Product Code WPI-0602M25

Number of Poles	6
Voltage Rating	250VAC max.
Current Rating	25A max.
Cable Cross Section Area	0,75mm ² ~ 4mm ²
Durability Voltage	1500VAC@60s.
Insulation Structure	1000 MΩ at 1000VDC
Contact Resistance	1 mΩ max.
Min Wire Size OD	1.0mm
Max Wire Size OD	1.4mm
Temperature Rating	-40°C ~ +85°C
IP Class	IP68
Mold Material	PA6
Contact/Terminal Material	Nickel-Plated Brass
Seal Material	Silicone

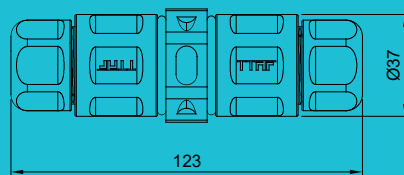
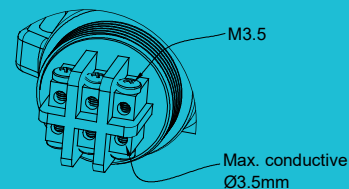

3 Power + 6 Data I Type
Screw Connection
Field Assembly

Connector

WPI Series

3 Power + 6 Data
250 VAC Power, 50 VDC Data
25A Power + 1A Data



Cable Code : KBL-9144

GONTUANA[®]
Waterproof Connector Series

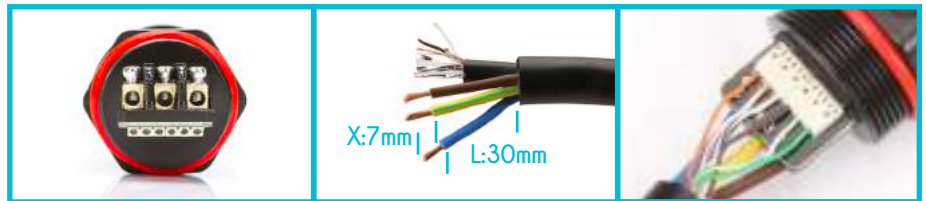

Technical Specifications

Product Code WPI-3602M25

Number of Poles	3 Power + 6 Data
Voltage Rating	Power: 250VAC max. + Data: 50 VDC/VAC
Current Rating	Power: 25A max. + Data: 1 Amper
Cable Cross Section Area	Power: 2.5mm ² - Data: 0,2mm ²
Durability Voltage	1500VAC@60s.
Insulation Structure	1000 MΩ at 1000VDC
Contact Resistance	1 mΩ max.
Min Wire Size OD	10mm
Max Wire Size OD	14mm
Temperature Rating	-40°C ~ +85°C
IP Class	IP68
Mold Material	PA6
Contact/Terminal Material	Nickel-Plated Brass
Seal Material	Silicon

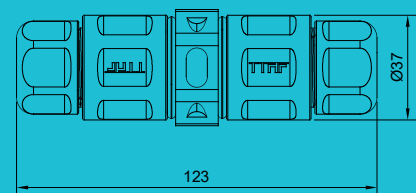
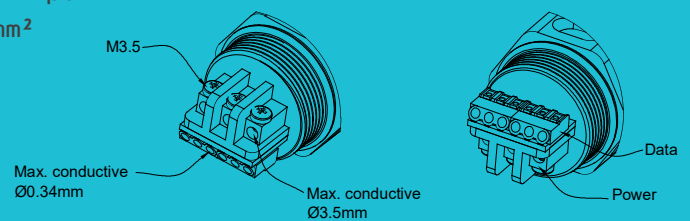

3 Power + Fiber LC Dublex I Type Screw Connection Field Assembly Connector

WPP Series

3 pin
250 VAC
25A Power + LC Dublex



Cable Code : KBL-9137

GONTUANA[®]
Waterproof Connector Series

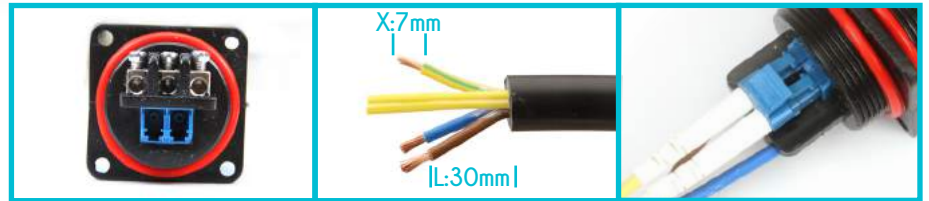

Technical Specifications

Product Code WPP-0302M25F

Number of Poles	3 Power + LC Dublex
Voltage Rating	Power: 250VAC max.
Current Rating	Power: 25A max.
Cable Cross Section Area	0,75mm ² ~ 4mm ²
Durability Voltage	1500VAC@60s.
Insulation Structure	1000 MΩ at 1000VDC
Contact Resistance	1 mΩ max.
Min Wire Size OD	10mm
Max Wire Size OD	14mm
Temperature Rating	-40°C ~ +85°C
IP Class	IP68
Mold Material	PA6
Contact/Terminal Material	Nickel-Plated Brass
Seal Material	Silicone

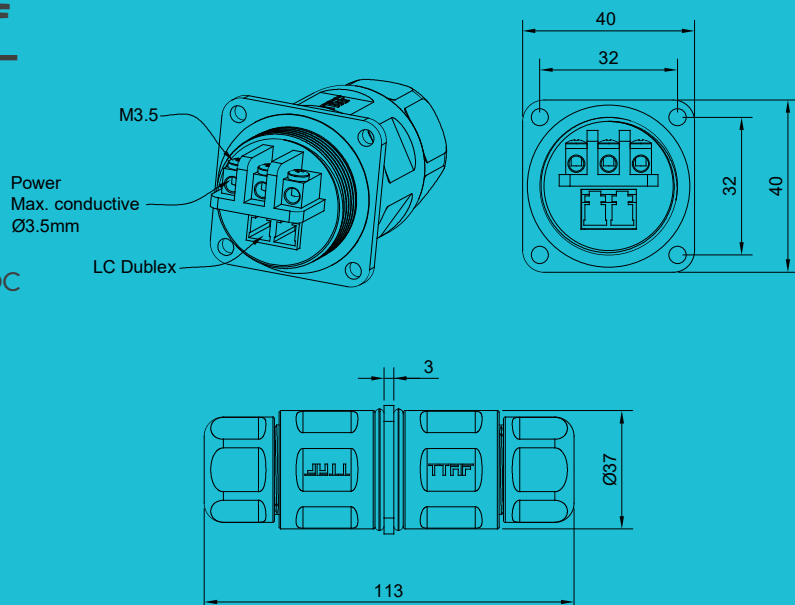

6 Pin T Type Screw Connection Field Assembly

Connector

WPT Series

6 pin
250 VAC
25A



GONTUANA®
Waterproof Connector Series

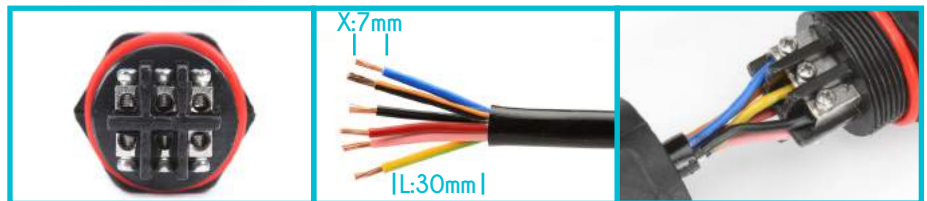

Technical Specifications

Product Code WPT-0603M25

Number of Poles	6
Voltage Rating	250VAC max.
Current Rating	25A max.
Cable Cross Section Area	0,75mm ² ~ 4mm ²
Durability Voltage	1500VAC@60s.
Insulation Structure	1000 MΩ at 1000VDC
Contact Resistance	10 mΩ max.
Min Wire Size OD	10mm
Max Wire Size OD	14mm
Temperature Rating	-40°C ~ +85°C
IP Class	IP68
Mold Material	PA6
Contact/Terminal Material	Nickel-Plated Brass
Seal Material	Silicone

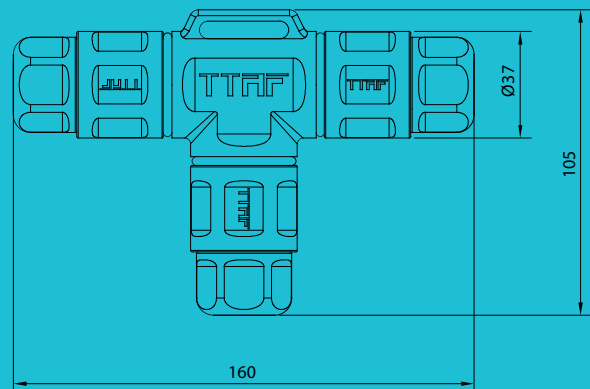
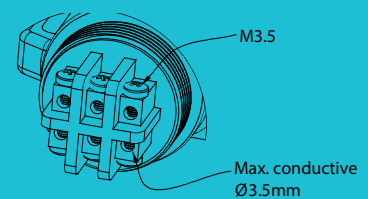

2 Pin Male Pluggable
Field Assembly 1in 3 out

WPS Series

2 pin
250 VAC
16A



Electrical Splitter

1x3
1in 3 out

2 Pin

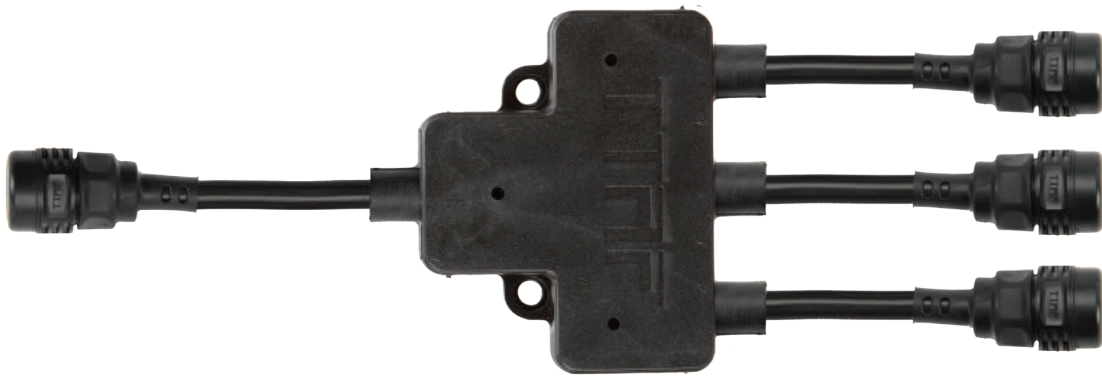

FOBOS[®]
Waterproof Electrical Splitter Series



Technical Specifications

Number of Poles
Voltage Rating
Current Rating
Durability Voltage
Insulation Structure
Contact Resistance
Temperature Rating
IP Class
Mold Material
Contact/Terminal Material
Seal Material

Product Code WPS-0204N16M

2
250VAC max.
16A max.
3000VAC@60s.
500 MΩ at 500VDC
30 mΩ max.
-40°C ~ +85°C
IP68
PA6
Nickel-Plated Brass
Silicone

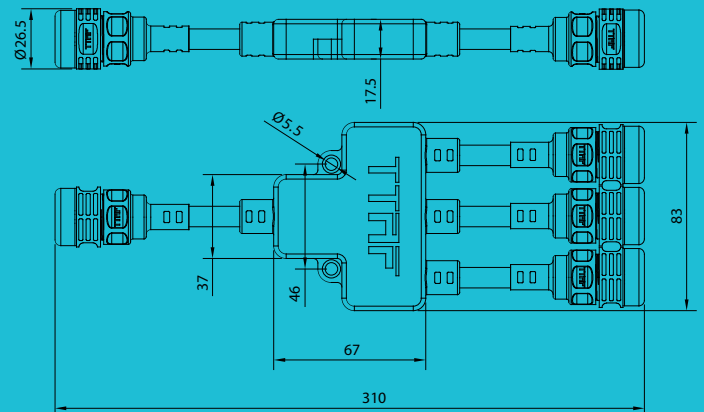

2 Pin Female Pluggable
Field Assembly 1in 3 out

Electrical Splitter

WPS Series

2 pin
250 VAC
16A



1x3
1in 3 out

2 Pin



FOBOS®
Waterproof Electrical Splitter Series



Technical Specifications

Number of Poles
Voltage Rating
Current Rating
Durability Voltage
Insulation Structure
Contact Resistance
Temperature Rating
IP Class
Mold Material
Contact/Terminal Material
Seal Material

Product Code WPS-0204N16F

2
250VAC max.
16A max.
3000VAC@60s.
500 MΩ at 500VDC
30 mΩ max.
-40°C ~ +85°C
IP68
PA6
Nickel-Plated Brass
Silicone

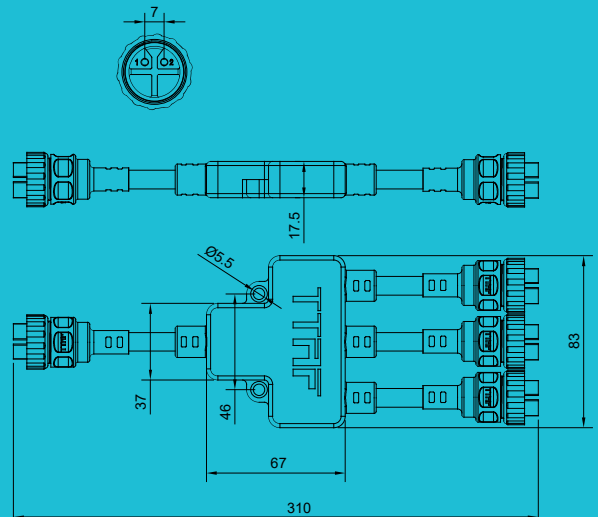

3 Pin Male Pluggable
Field Assembly 1in 3 out

Electrical Splitter

WPS Series

3 pin
250 VAC
16A



1x3
1in 3 out

3 Pin

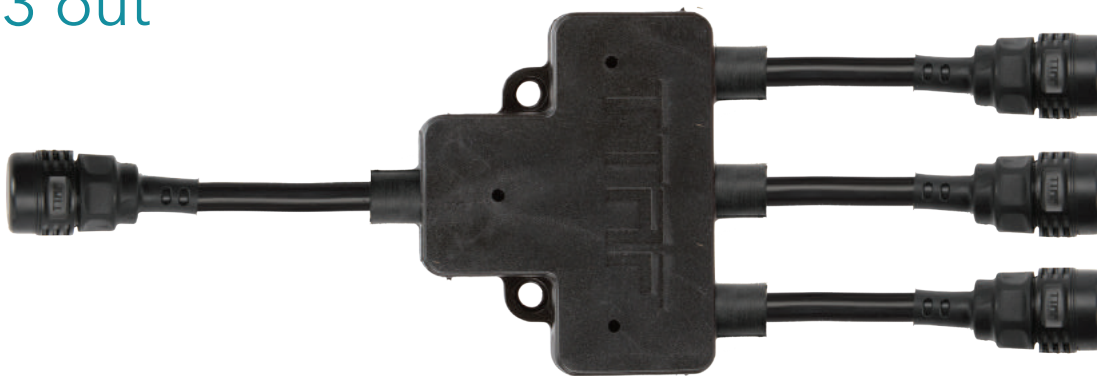

FOBOS®
Waterproof Electrical Splitter Series



Technical Specifications

Number of Poles
Voltage Rating
Current Rating
Durability Voltage
Insulation Structure
Contact Resistance
Temperature Rating
IP Class
Mold Material
Contact/Terminal Material
Seal Material

Product Code WPS-0304N16M

3
250VAC max.
16A max.
3000VAC@60s.
500 MΩ at 500VDC
30 mΩ max.
-40°C ~ +85°C
IP68
PA6
Nickel-Plated Brass
Silicone

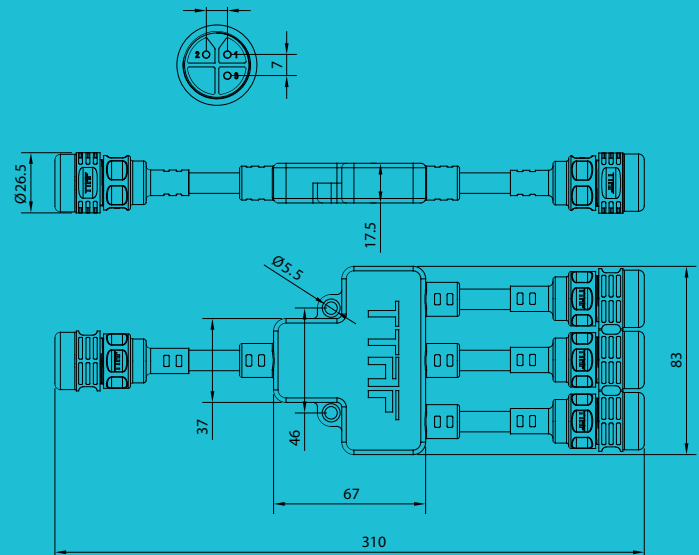

3 Pin Female Pluggable
Field Assembly 1in 3 out

Electrical Splitter

WPS Series

3 pin
250 VAC
16A



1x3
1in 3 out

3 Pin



FOBOS[®]
Waterproof Electrical Splitter Series



Technical Specifications

Number of Poles
Voltage Rating
Current Rating
Durability Voltage
Insulation Structure
Contact Resistance
Temperature Rating
IP Class
Mold Material
Contact/Terminal Material
Seal Material

Product Code WPS-0304N16F

3
250VAC max.
16A max.
3000VAC@60s.
500 MΩ at 500VDC
30 mΩ max.
-40°C ~ +85°C
IP68
PA6
Nickel-Plated Brass
Silicone

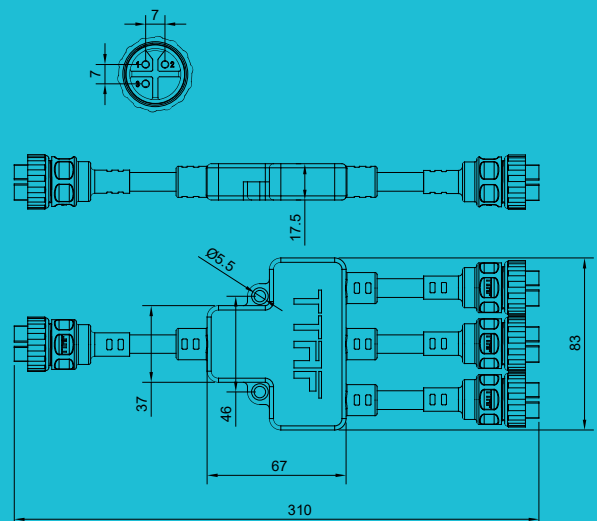

4 Pin Male Pluggable
Field Assembly 1in 3 out

WPS Series

4 pin
250 VAC
16A



Electrical Splitter

1x3
1in 3 out

4 Pin

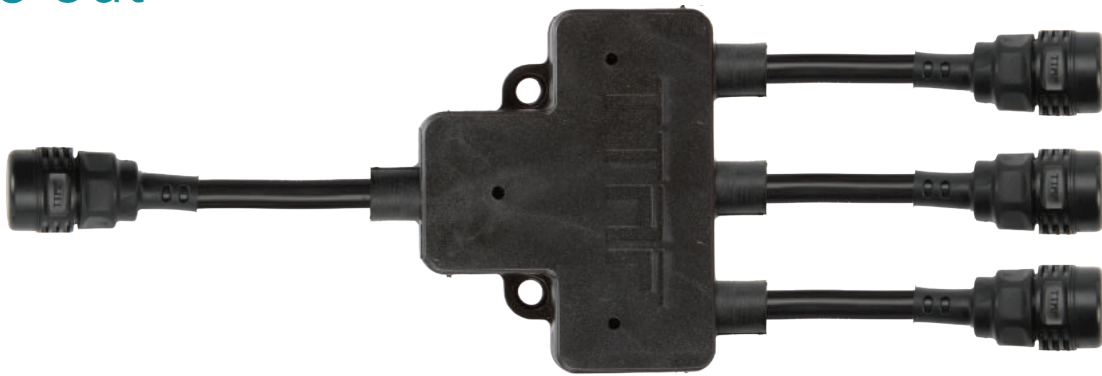

FOBOS[®]

Waterproof Electrical Splitter Series



Technical Specifications

Number of Poles
Voltage Rating
Current Rating
Durability Voltage
Insulation Structure
Contact Resistance
Temperature Rating
IP Class
Mold Material
Contact/Terminal Material
Seal Material

Product Code WPS-0404N16M

4
250VAC max.
16A max.
3000VAC@60s.
500 MΩ at 500VDC
30 mΩ max.
-40°C ~ +85°C
IP68
PA6
Nickel-Plated Brass
Silicone

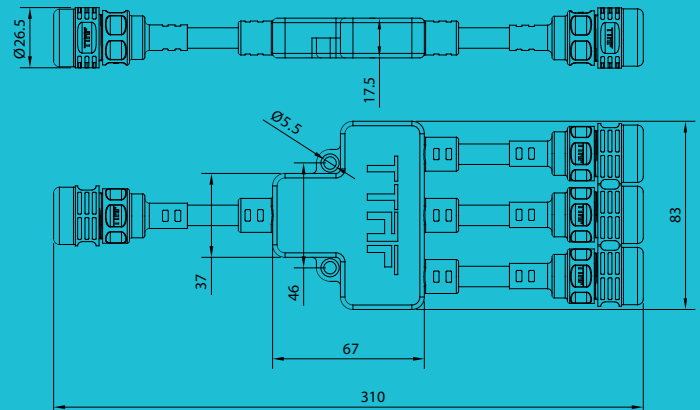
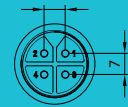

4 Pin Female Pluggable
Field Assembly 1in 3 out

Electrical Splitter

WPS Series

4 pin
250 VAC
16A



1x3
1in 3 out

4 Pin



FOBOS[®]
Waterproof Electrical Splitter Series



Technical Specifications

Number of Poles
Voltage Rating
Current Rating
Durability Voltage
Insulation Structure
Contact Resistance
Temperature Rating
IP Class
Mold Material
Contact/Terminal Material
Seal Material

Product Code WPS-0404N16F

4
250VAC max.
16A max.
3000VAC@60s.
500 MΩ at 500VDC
30 mΩ max.
-40°C ~ +85°C
IP68
PA6
Nickel-Plated Brass
Silicone

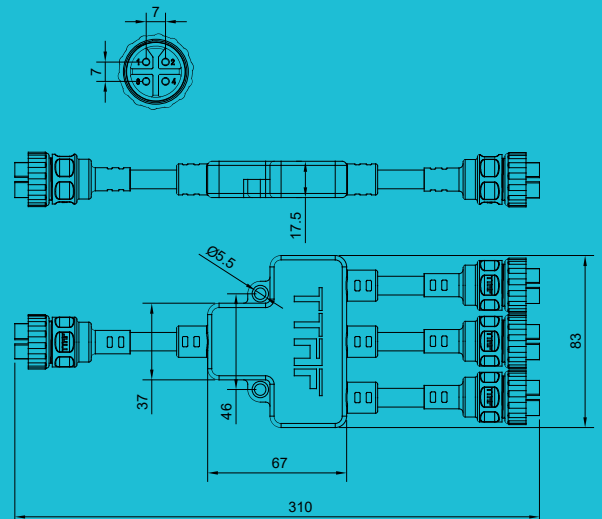

3 Pin Screw Connection
Field Assembly 1in 3 out

Electrical Splitter

WPA Series

3 pin
250 VAC
16A



1x3
1in 3 out

3 Pin

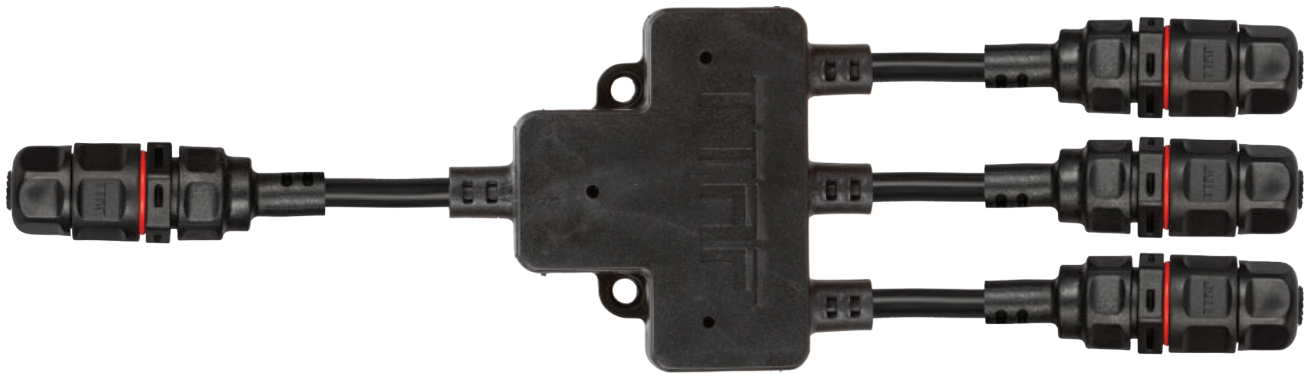

FOBOS[®]

Waterproof Electrical Splitter Series



Technical Specifications

Number of Poles
Voltage Rating
Current Rating
Cable Cross Section Area
Durability Voltage
Insulation Structure
Contact Resistance
Min Wire Size OD
Max Wire Size OD
Temperature Rating
IP Class
Mold Material
Contact/Terminal Material
Seal Material

Product Code

WPA-0304N16

3
250VAC max.
16A max.
0,5mm² ~ 2,5mm²
1000VAC@60s.
500 MΩ at 500VDC
10 mΩ max
5,5mm
8,5mm
-40°C ~ +85°C
IP68
PA6
Nickel-Plated Brass
Silicone

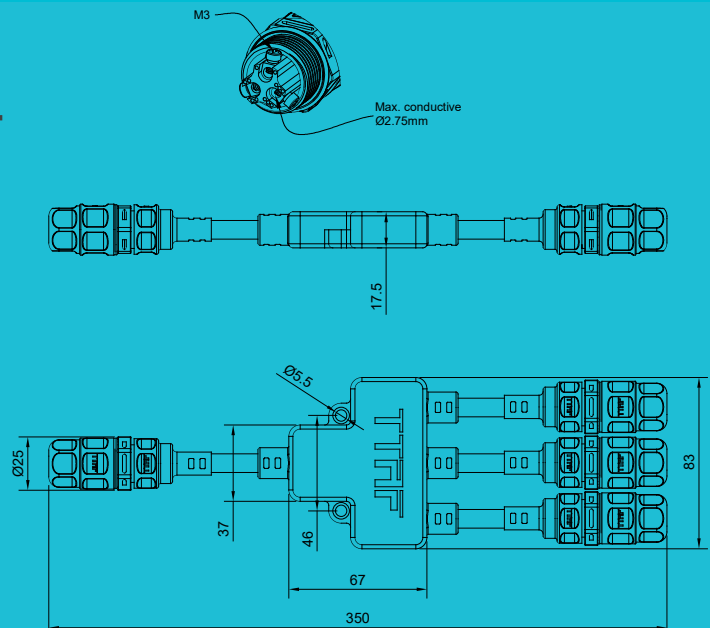

3 Pin Screw Connection
Field Assembly 1in 5 out

Electrical Splitter

WPA Series

3 pin
250 VAC
16A



1x5
1in 5 out

3 Pin



FOBOS[®]
Waterproof Electrical Splitter Series



Technical Specifications

Number of Poles	3
Voltage Rating	250VAC max.
Current Rating	16A max.
Cable Cross Section Area	0,5mm ² ~ 2,5mm ²
Durability Voltage	1000VAC@60s.
Insulation Structure	500 MΩ at 500VDC
Min Wire Size OD	5,5mm
Max Wire Size OD	8,5mm
Temperature Rating	-40°C ~ +85°C
IP Class	IP68
Mold Material	PA6
Contact/Terminal Material	Nickel-Plated Brass
Seal Material	Silicone

Product Code WPA-0306N16

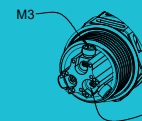

Max. conductive
Ø2.75mm

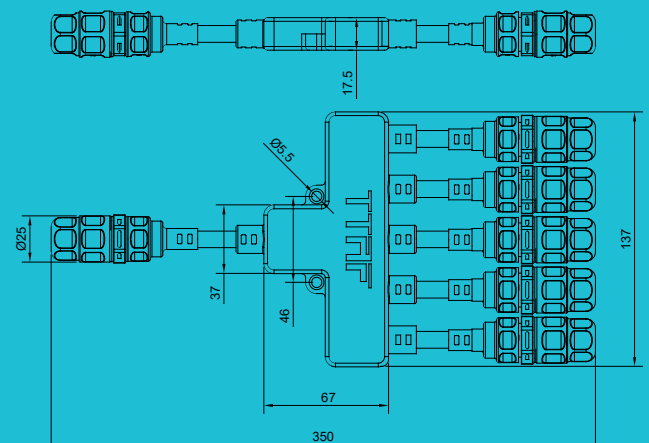

IP BOX

WP BOX Series

Electrical Splitter

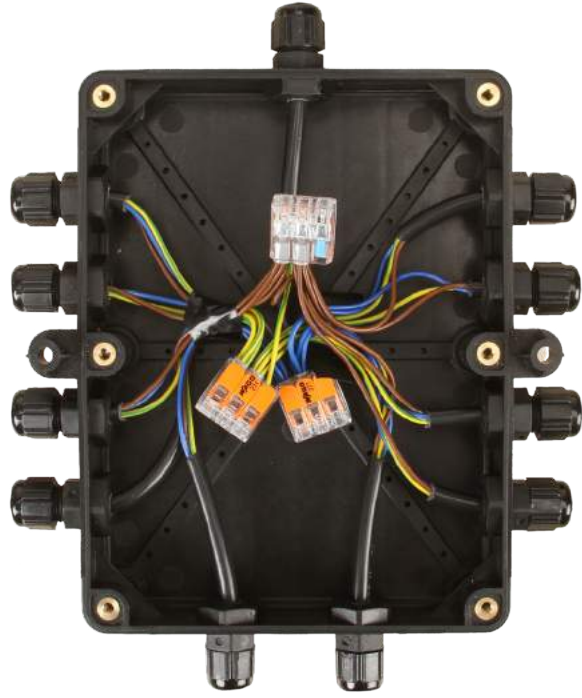

Technical Specifications

Product Code WP BOX-04

Temperature Rating
IP Class
Mold Material
Dimensions

-40°C ~ +85°C
IP68
ABS, PP
170x130x40mm

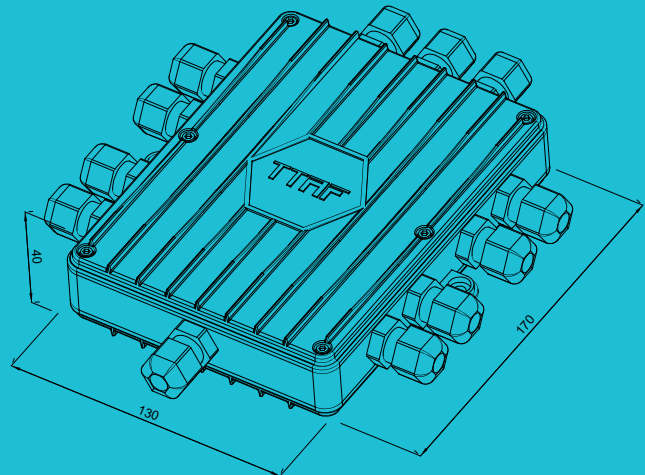

Cable Joiner



RF Connectors

Some connector samples you will use with IPJ50 and IPJ24 Series



Data Connectors



Sensor Connectors



Terminal Blocks



Splice Connectors

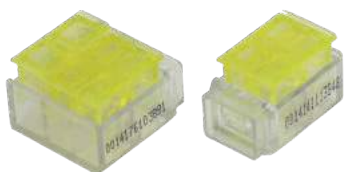

D-Sub Connectors



Cable Joiner



IPJ50 is a cable joiner with IP68 sealing feature when it is closed and **inner diameter of 50mm**.

You can connect two cables with any connector without sealing feature inside IPJ50. There is no need for a chemical as in case of equivalent connectors.



Epoxy



Product Code	Cable Gland Size	Length (L) mm	Handtool Size	Cable OD Ømin-max mm
IPJ50-3	M 12 x 1,5	204	14	3 - 6,5
IPJ50-4	M 16 x 1,5	206	17 - 18	4 - 8
IPJ50-6	M 20 x 1,5	213	22	6 - 12
IPJ50-10	M 25 x 1,5	216	24 - 27	10 - 14
IPJ50-13	M 32 x 1,5	223	30 - 34	13 - 18
IPJ50-18	M 40 x 1,5	236	40 - 43	18 - 25

Technical Specifications

Body Material	Cast Polyamide
IP Class	IP68
Operating Temperature	-40°C ~ +100°C
Inner Diameter	50mm
Sealing Ring	Silicone
Outer Diameter	58mm
Cap nut & Gland Body	Brass With Nickel Plated
Clamping Insert	PA6 V2
Gland Sealing Ring	TPV
Gland O-ring	NBR

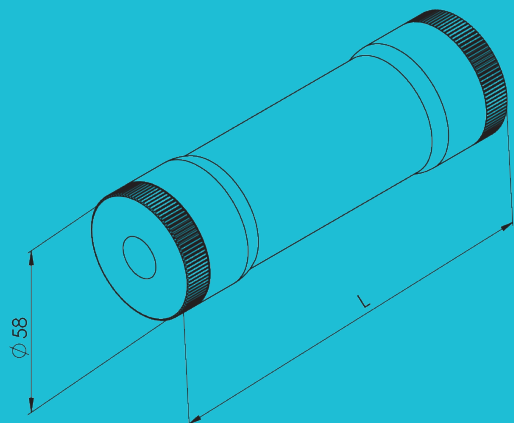



Cable Joiner



IPJ24 is a cable joiner with IP68 sealing feature when it is closed and **inner diameter of 24mm**.

You can connect two cables with any connector without sealing feature inside IPJ24. There is no need for a chemical as in case of equivalent connectors.

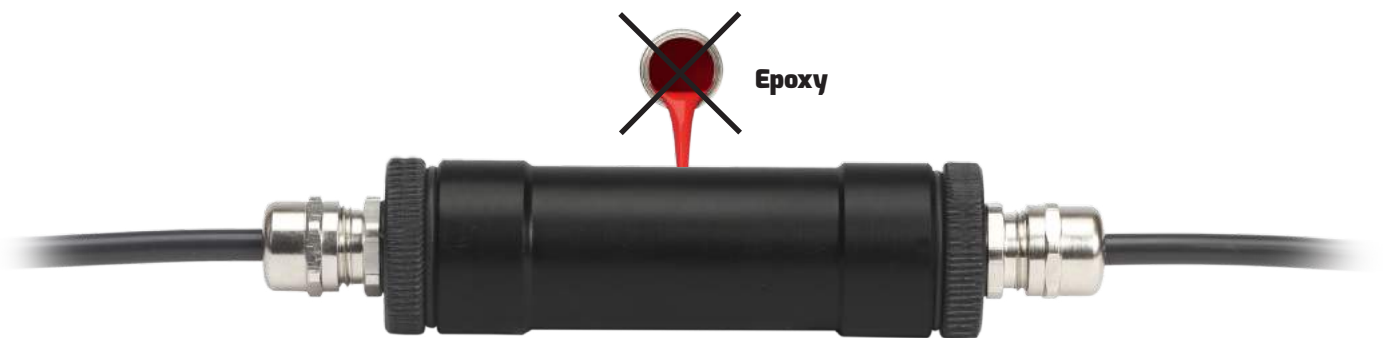

Product Code	Cable Gland Size	Length (L) mm	Handtool Size	Cable OD Ømin-max mm
IPJ24-3	M 12 x 1,5	154	14	3 - 6,5
IPJ24-4	M 16 x 1,5	156	17 - 18	4 - 8
IPJ24-6	M 20 x 1,5	163	22	6 - 12

Technical Specifications

Body Material	Cast Polyamide
IP Class	IP68
Operating Temperature	-40°C ~ +100°C
Inner Diameter	24mm
Sealing Ring	Silicone
Outer Diameter	32mm
Cap nut & Gland Body	Brass With Nickel Plated
Clamping Insert	PA6 V2
Gland Sealing Ring	TPV
Gland O-ring	NBR

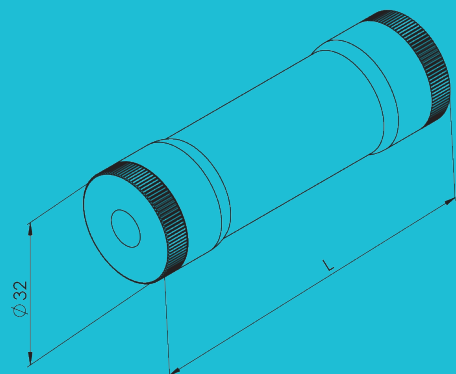

Maxi Blade Fuse Type



The WFH-M overMolded ,heavy-Duty & waterproof Inline Fuse Holder for maxi Blade fuses lwith protective cover for harsh environments.

20 to 35 amps. Supplied 6mm² (AWG10) cable

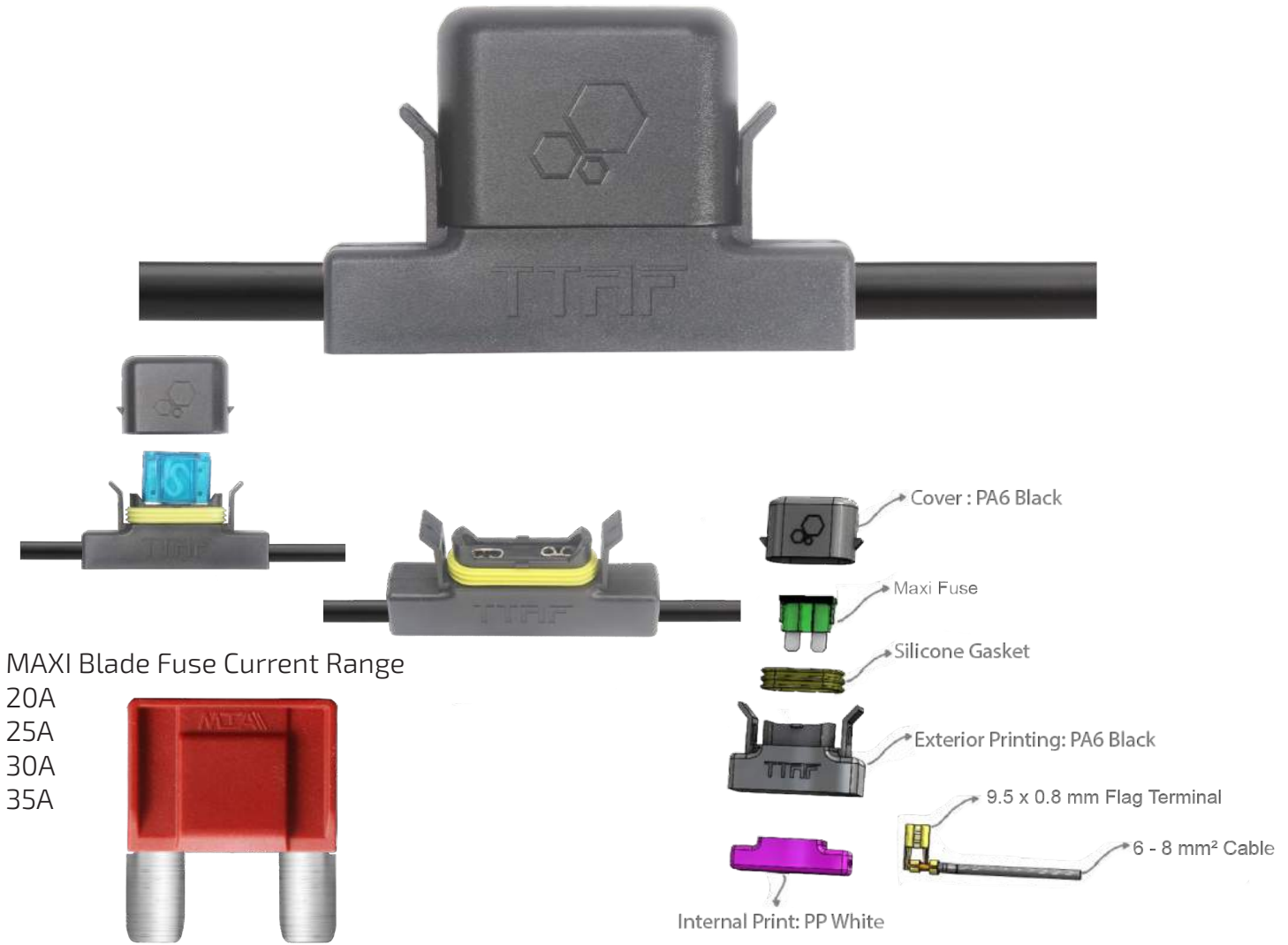

MAXI Blade Fuse Current Range

- 20A
- 25A
- 30A
- 35A



Technical Specifications

Body Material	PA6
IP Class	IP68
Operating Temperature	-40°C ~ +100°C
Contact Material	Brass With Nickel Plated
Sealing Ring	Silicone
Max. Current Range	35A

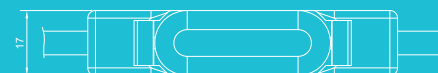
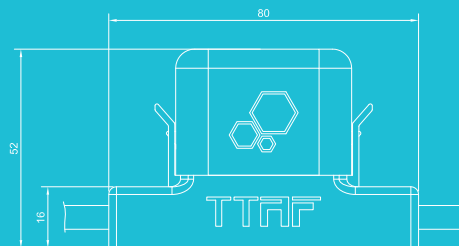

Waterproof Fuse Holder

WFH-K Series



Mini Blade Fuse Type

The WFH-K overMolded ,heavy-Duty & waterproof Inline Fuse Holder for mini Blade fuses with protective cover for harsh environments.

2 to 25 amps. Supplied 2.5mm² (AWG14) cable

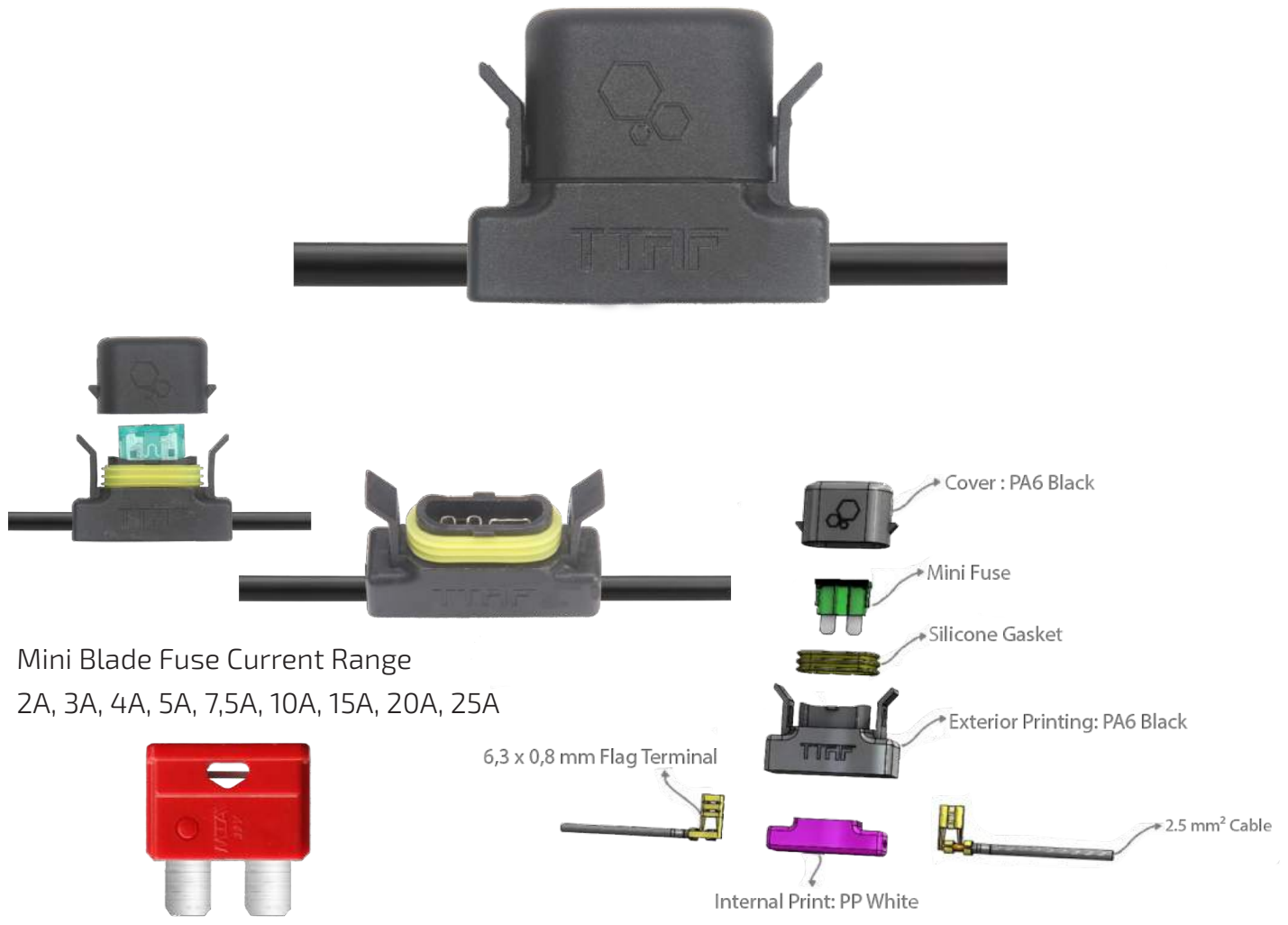

Mini Blade Fuse Current Range

2A, 3A, 4A, 5A, 7,5A, 10A, 15A, 20A, 25A

Technical Specifications

Body Material	PA6
IP Class	IP68
Operating Temperature	-40°C ~ +100°C
Contact Material	Brass With Nickel Plated
Sealing Ring	Silicone
Max. Current Range	25A

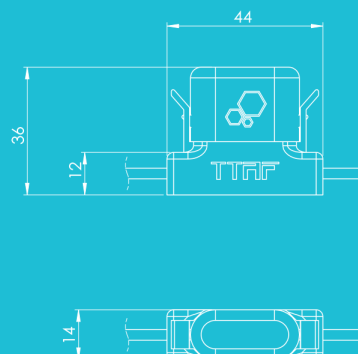

Turkey
Discover
the potential



TTAF®

www.ttaf.com.tr | info@ttaf.com.tr

  [ttafelectronic](https://www.youtube.com/ttafelectronic)

Kavakli Mahallesi, Istanbul Caddesi, No:21 Beylikduzu - Istanbul / TURKEY
Tel ; +90 212 855 82 20
Fax ; +90 212 855 82 21