



## **Biovac™**

### Closed Wound Drainage Systems

During surgery and afterwards, during recovery, it is often necessary to remove fluid and wound secretions from the site of the surgery. When tissue is damaged, the natural immune response of the body drives blood, fluid and immune cells to the site to attempt to repair the tissue. Such fluids can potentially interfere with wound healing and often promote infection.

The drains are used for both prophylactic and therapeutic purposes in a variety of clinical situations including mastectomies, breast augmentations, plastic and reconstructive procedures, urologic, orthopedics, general surgery, and more. They are placed at the end of the surgery at the sight/area where the surgeon would like to drain the excess fluids from. Type of operation and the site will influence the number and kind of drains used.

Biometrix offers a total solution for wound drainage, offering an array of sizes and types of drains and evacuators, thus supplying the physicians with the perfect solution. Customized sets are available.

## Wound drainage

Plays a vital role in the process of post-surgical wound healing, designed to enhance drainage, facilitate wound healing and reduce infection.

Biovac™ – the Biometrix complete wound drainage system consists of flat and fluted drains (with/without trocar) as well as various types of evacuators and drainage bags.



## 200ml/400ml Silicone Bulbs

The Biometrix 200ml/400ml silicone bulbs are intended for various surgical procedures such as, femoral fracture, hip/knee replacement, extremity amputations, colon/rectum surgery, spine surgery, general surgery, prostatectomy, mastectomy, and all other high bleeding procedures.

## Benefits



- Drainage ports with an option of use of only one.
- Inlets including 1-way valve in order to avoid backflow of fluid to the patient.
- Ergonomic easy hanging clip.
- Large/medium drainage capacity.
- A relatively simple procedure and set-up.

## 100ml Silicone Bulbs

The Biometrix Biovac 100ml bulb is a closed drainage system, intended for procedures of a smaller capacity such as hand surgery, plastic surgery, neurosurgery and minimal post-surgical bleeding procedures.

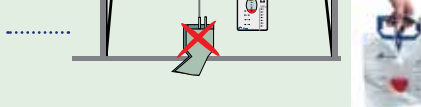

## The Closed System Advantages

- Portable and ergonomic; simple and easy to carry, or hang on bed. 
- Designed to protect against blood born pathogens, especially in post-operative management of surgical drainage systems. 
- Non-reflux return valve for eliminating the risk of blood secretion reflux.
- Complies with OSHA (occupational safety and health administration) regulations and CDC (center for disease control) guidelines.

## The Closed System Concept

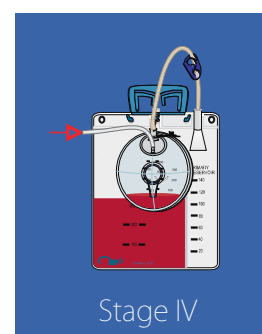
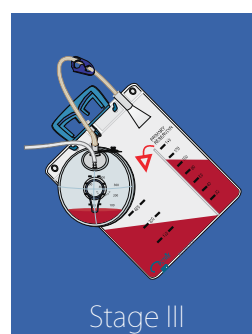
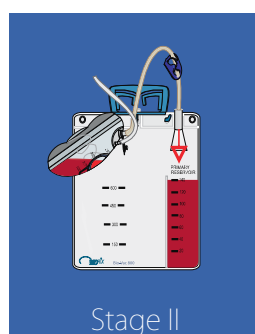
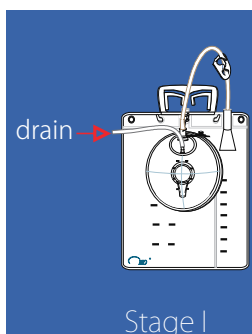

# Biovac™ 450ml Silicone Evacuator



## 450ml Silicone Evacuator

Biometrix 450ml evacuator is a flat drainage system intended for procedures of larger capacity such as femoral fractures, hip joints, knee joints, extremity amputations, colon/rectum surgery, spine surgery, prostatectomy, mastectomy, and all other high bleeding procedures.



## Advantages

- Low constant suction level reduces tissue damage and prevents accumulation of excess fluid, thus facilitating wound healing
- Non-return valve for eliminating the risk of blood/secretion reflux

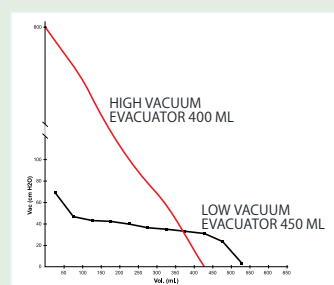





## Fluted Silicone Drains

The Biometrix Fluted Silicone Drains:

- Open channels for increasing flow rate and minimizing blood clotting.
- 100% silicone drain provides tensile strength and flexibility
- Increased comfort for the patient.
- Improved contact with affected tissues.

### Suitable for:

- Plastic Surgery
- Head & Neck Surgery
- Cardio & Thoracic Surgery
- General Surgery
- Orthopedic Surgery
- Gynecology

The Biometrix fluted drain system are available in flat & round profiles:  Round Profile  Flat Profile



## The Flat Drain Advantages:

- Subcutaneous position prevents sliding out and reduces trauma of drain removal
- Cross section is designed to prevent drain occlusion

Round Drains 10-18Fr Silicone/PVC Drains Flat Drains 4, 7, 10mm Silicone Drains  
Multi-Lumen Drains Silicone irrigation - drainage drains



## 450ml Spring Type Evacuator

Evacuator/Bulb only

Code	Bag	Trocar
MJ-0000	+	+
ML-0000	-	+

Qty/Box: 20

## Sets with Round Silicone Drains

Code	Bag	Drain	Trocar
MJ-2100	+	10Fr	-
ML-2100	-	10Fr	-
MJ-2105	+	10Fr	+
ML-2105	-	10Fr	+
MJ-2120	+	12Fr	-
ML-2120	-	12Fr	-
MJ-2125	+	12Fr	+
ML-2125	-	12Fr	+
MJ-2140	+	14Fr	-
ML-2140	-	14Fr	-
MJ-2145	+	14Fr	+
ML-2145	-	14Fr	+
MJ-2160	+	16Fr	-
ML-2160	-	16Fr	-
MJ-2165	+	16Fr	+
ML-2165	-	16Fr	+
MJ-2180	+	18Fr	-
ML-2180	-	18Fr	-
MJ-2185	+	18Fr	+
ML-2185	-	18Fr	+

Qty/Box: 20

## Sets with Flat Fluted Silicone Drains

Code	Bag	Drain
MI-1075	-	7mm Full Fluted
MM-1075	+	7mm Full Fluted
MI-1105	-	10mm Full Fluted
MM-1105	+	10mm Full Fluted

Qty/Box: 20



## 50ml Minivac

Code	Drain	Needle
MH-1170	6FrPVC-Round	-
MH-1175	6FrPVC-Round	+
MH-1070	8FrPVC-Round	-
MH-1075	8FrPVC-Round	+

Qty/Box: 20

## Sets with Flat Silicone Drains

Code	Bag	Drain	Trocar
MJ-1070	+	7mm	-
ML-1070	-	7mm	-
MJ-1075	+	7mm	+
ML-1075	-	7mm	+
MJ-1100	+	10mm	-
ML-1100	-	10mm	-
MJ-1105	+	10mm	+
ML-1105	-	10mm	+

Qty/Box: 20

## Sets with Round Fluted Silicone Drains

Code	Bag	Drain	Trocar
MI-3105	-	10Fr Full Fluted	+
MM-3105	+	10Fr Full Fluted	+
MI-1155	-	15Fr Full Fluted	+
MM-1155	+	15Fr Full Fluted	+
MI-1195	-	19Fr Full Fluted	+
MM-1195	+	19Fr Full Fluted	+

Qty/Box: 20

## Sets with Round PVC Drains

Code	Bag	Drain	Trocar
MJ-5105	+	10Fr	+
ML-5105	-	10Fr	+
MJ-5125	+	12Fr	+
ML-5125	-	12Fr	+
MJ-5145	+	14Fr	+
ML-5145	-	14Fr	+
MJ-5165	+	16Fr	+
ML-5165	-	16Fr	+
MJ-5185	+	18Fr	+
ML-5185	-	18Fr	+

Qty/Box: 20



## 100ml Bulb Systems

### Sets without Drains

Code	Bag	Drain
MD-0000	+	25
MF-000	-	20

### Sets with Round Silicone Drains

Code	Bag	Drain	Trocar
MD-2100	+	10Fr	-
MF-2100	-	10Fr	-
MD-2105	+	10Fr	+
MF-2105	-	10Fr	+
MD-2140	+	14Fr	-
MF-2140	-	14Fr	-
MD-2145	+	14Fr	+
MF-2145	-	14Fr	+
MD-2180	+	18Fr	-
MF-2180	-	18Fr	-
MD-2185	+	18Fr	+
MF-2185	-	18Fr	+

Qty/Box: MF-XXXX: 20, MD-XXXX: 25

### Sets with Round Fluted Drains

Code	Bag	Drain	Trocar
MA-3105	-	10Fr Full Fluted	+
MK-3105	+	10Fr Full Fluted	+
MA-1155	-	15Fr Full Fluted	+
MK-1155	+	15Fr Full Fluted	+
MA-1195	-	19Fr Full Fluted	+
MK-1195	+	19Fr Full Fluted	+

Qty/Box: MA-XXXX: 20, MK-XXXX: 25

## 200ml/400ml Silicone Bulbs

### Bulbs Only

Code	Drain
MP-0000	200ml Bulb
MS-0000	400ml Bulb

Qty/Box: 20

### Sets with Flat Silicone Drains

Code	Bag	Drain	Trocar
MD-1070	+	7mm	-
MF-1070	-	7mm	-
MD-1075	+	7mm	+
MF-1075	-	7mm	+
MD-1100	+	10mm	-
MF-1100	-	10mm	-
MD-1105	+	10mm	+
MF-1105	-	10mm	+

Qty/Box: MF-XXXX: 20, MD-XXXX: 25

### Sets with Flat Fluted Drains

Code	Bag	Drain	Trocar
MA-1075	-	7mm Full Fluted	+
MK-1075	+	7mm Full Fluted	+
MA-1105	-	10mm Full Fluted	+
MK-1105	+	10mm Full Fluted	+

Qty/Box: MA-XXXX: 20, MK-XXXX: 25

Customized sets available with various drains, trocar needles and bags





## Gravitational Drainage Sets

Code	Drain
NR-1620	16Fr round drain set
NR-1820	18Fr round drain set
NR-2020	20Fr round drain set
NR-2420	24Fr round drain set
NR-2820	28Fr round drain set
NR-3220	32Fr round drain set
NR-3620	36Fr round drain set
NR-4007	7mm flat drain set
NR-4010	10mm flat drain set

Qty/Box: 25



## Pre-vac Wound Drainage Sets

Code	Drain
MQ-0000	400ml Biovac P.V.
MQ-5105	400ml Biovac P.V., 10Fr PVC Drain, Trocar Needle
MQ-5125	400ml Biovac P.V., 12Fr PVC Drain, Trocar Needle
MQ-5145	400ml Biovac P.V., 14Fr PVC Drain, Trocar Needle
MQ-5165	400ml Biovac P.V.' 16Fr PVC Drain, Trocar Needle



## Silicone Drains

### Round Silicone Drains

Code	Drain	Length
MV-2105	10Fr	60cm
MV-2125	12Fr	60cm
MV-2145	14Fr	60cm
MV-2165	16Fr	60cm
MV-2185	18Fr	60cm
MV-9400	10Fr	120cm
MV-9420	12Fr	120cm
MV-9440	14Fr	120cm
MV-9460	16Fr	120cm
MV-9480	18Fr	120cm

Qty/Box: 50

### Round Silicone Drains with Trocar

Code	Drain	Length
MV-9205	10Fr	60cm
MV-9225	12Fr	60cm
MV-9245	14Fr	60cm
MV-9265	16Fr	60cm
MV-9285	18Fr	60cm
MV-9405	10Fr	120cm
MV-9425	12Fr	120cm
MV-9445	14Fr	120cm
MV-9465	16Fr	120cm
MV-9485	18Fr	120cm

Qty/Box: 50

### Flat Silicone Drains

Code	Drain	Length
MV-1040	4mm	65cm
MV-1070	7mm	125cm
MV-1100	10mm	102cm



## Fluted Silicone Drains

### Round Drains

Code	Description	Drain	Trocar
MW-3100	Round Full Fluted	10Fr	-
MW-3105	Round Full Fluted	10Fr	+
MW-J3105	Round Full Fluted	10Fr	Bendable
MW-3150	Round Full Fluted	15Fr	-
MW-3155	Round Full Fluted	15Fr	+
MW-J3155	Round Full Fluted	15Fr	Bendable
MW-3190	Round Full Fluted	19Fr	-
MW-3195	Round Full Fluted	19Fr	+
MW-J3195	Round Full Fluted	19Fr	Bendable
MW-3240	Round Full Fluted	24Fr	-

Qty/Box: MW-XXX0: 25, MW-XXX5: 20

### Flat Drains

Code	Description	Drains
MW-1070	Flat Full Fluted	7mm
MW-1075	Flat Full Fluted	7mm
MW-J1075	Flat Full Fluted	7mm
MW-1100	Flat Full Fluted	10mm
MW-1105	Flat Full Fluted	10mm
MW-J1105	Flat Full Fluted	10mm

Qty/Box: MW-XXX0: 25, MW-XXX5: 20



## Flat Tissue Drains (Penrose)

Code	Drain	Length
ME-0006	6mm	300mm
ME-0008	8mm	300mm
ME-0010	10mm	300mm
ME-0012	12mm	300mm
ME-0040	40mm	300mm

Qty/Box: 50